

1

## UNPACK CONTENTS

Locate watch and charging cable in box.

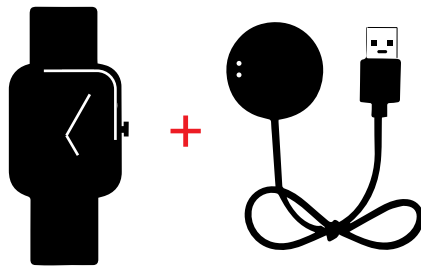

2

## CHARGING

Insert cable into a computer USB port or UL-certified wall charger.

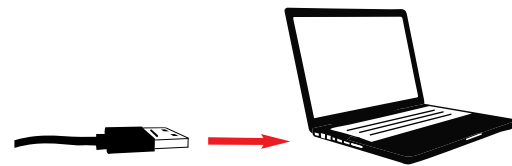

*Note: avoid using fast-chargers*

3

## FULLY CHARGE WATCH

Line up metal pins on charging cable with contacts on back of watch and lower until it snaps into place.  
Charge for 2-3 hours.

Magnetic charging cable snaps into place.

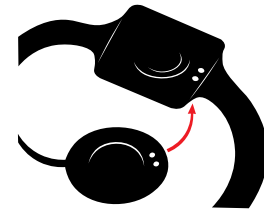

A charging screen will appear to confirm your watch is charging.

*Flip over guide for next steps*

4

## DOWNLOAD APP

Scan QR code with your smartphone camera to download our free mobile app.



5

## PAIR YOUR WATCH

Power on watch (press and hold button for 5 seconds), open the mobile app, create an account, then tap watch icon to begin pairing. Pairing sets time and date on your watch.

*Note: enable Bluetooth on your phone but only pair your watch using mobile app.*

6

## VISIT US ONLINE

For full user manual, help, our warranty policy, and answers to many common questions, visit us online:

**[support.xfivewearables.com](https://support.xfivewearables.com)**

*Enjoy your watch!*



**SMARTWATCH**

**Powered by X-FIVE**

## **FCC Statement**

This equipment has been tested and found to comply with the limits for a Class B digital device, pursuant to part 15 of the FCC rules. These limits are designed to provide reasonable protection against harmful interference in a residential installation. This equipment generates, uses and can radiate radio frequency energy and, if not installed and used in accordance with the instructions, may cause harmful interference to radio communications. However, there is no guarantee that interference will not occur in a particular installation. If this equipment does cause harmful interference to radio or television reception, which can be determined by turning the equipment off and on, the user is encouraged to try to correct the interference by one or more of the following measures:

- Reorient or relocate the receiving antenna.
- Increase the separation between the equipment and receiver.
- Connect the equipment into an outlet on a circuit different from that to which the receiver is connected.
- Consult the dealer or an experienced radio/TV technician for help.

To assure continued compliance, any changes or modifications not expressly approved by the party.

Responsible for compliance could void the user's authority to operate this equipment. (Example- use only shielded interface cables when connecting to computer or peripheral devices).

This equipment complies with Part 15 of the FCC Rules. Operation is subject to the following two conditions:

- (1) This device may not cause harmful interference, and
- (2) This device must accept any interference received, including interference that may cause undesired operation.

RF warning statement:

The device has been evaluated to meet general RF exposure requirement.  
The device can be used in portable exposure condition without restriction.