

Insta360 GO 2

1. 部件介绍

■ GO 2 相机

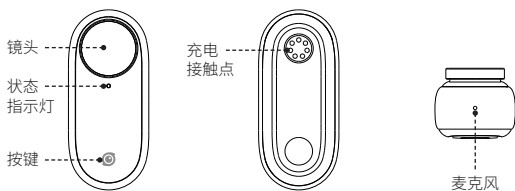

■ GO 2 充电盒

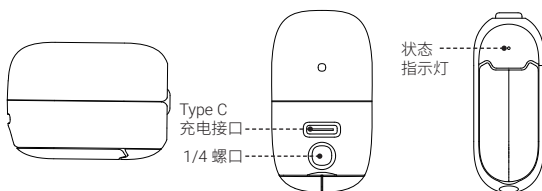

打开充电盒：

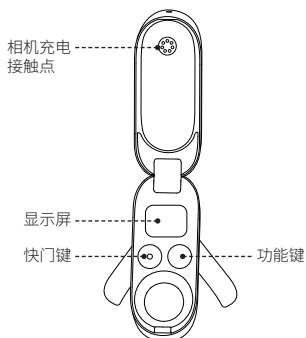

2. 充电

使用前，请先将相机和充电盒充满电。

■ GO 2 相机置入充电盒，进行充电

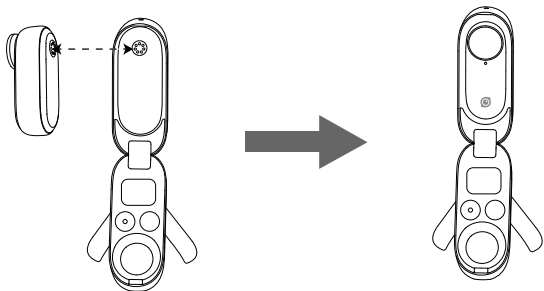

■ 使用随附的充电线连接充电盒一侧的 USB Type C 接口，对充电盒进行充电。

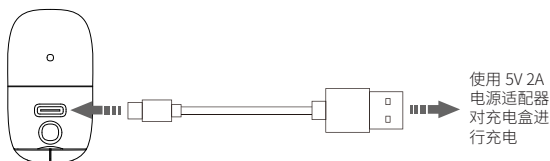

3. 使用

按住相机按键，相机短震两次，相机开机，进入待机模式。

长按相机按键 2 秒，相机关机。

长按相机按键 6 秒，相机强制关机。

相机待机状态下，默认单机按键，开始录像。

相机待机状态下，默认快速双击按键可进行拍照。

* 文档如有更新，恕不另行通知。更多产品功能使用，请查看 GO App 内教程或访问 <https://www.insta360.com/support/product-support>

1. Names of Parts

■ GO 2 Camera

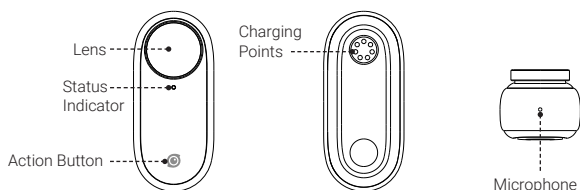

■ GO 2 Charge Case

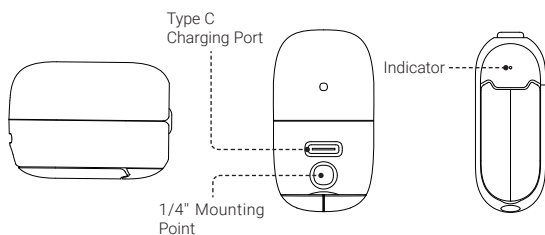

Open the Charge Case:

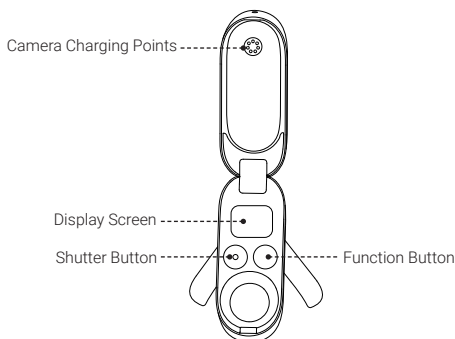

2. Charging

■ Place GO 2 into its Charge Case for charging

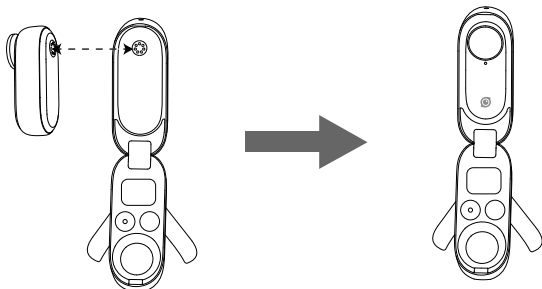

■ Connect the included charge cable to GO 2 for charging

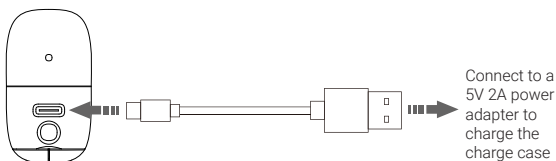

3. How to Use

Press and hold the Action Button to power on GO 2, indicated with two short vibrations.

Press and hold the Action Button for 2 seconds to power off.

Press and hold the Action Button for 6 seconds to force shutdown.

When the camera is powered on, press the Action Button to start recording (by default).

When the camera is powered on, press the Action Button to start recording (by default).

When the camera is powered on, press the Action Button twice in quick succession to take a photo.

* This document is subject to change without notice. For more information, visit <https://www.insta360.com/support/product-support>

FCC Statement

This equipment has been tested and found to comply with the limits for a Class B digital device, pursuant to Part 15 of the FCC Rules. These limits are designed to provide reasonable protection against harmful interference in a residential installation. This equipment generates uses and can radiate radio frequency energy and, if not installed and used in accordance with the instructions, may cause harmful interference to radio communications. However, there is no guarantee that interference will not occur in a particular installation. If this equipment does cause harmful interference to radio or television reception, which can be determined by turning the equipment off and on, the user is encouraged to try to correct the interference by one or more of the following measures:

- Reorient or relocate the receiving antenna.
- Increase the separation between the equipment and receiver.
- Connect the equipment into an outlet on a circuit different from that to which the receiver is connected.
- Consult the dealer or an experienced radio/TV technician for help.

This device complies with part 15 of the FCC Rules. Operation is subject to the following two conditions:

- (1) This device may not cause harmful interference, and
- (2) this device must accept any interference received, including interference that may cause undesired operation.

Changes or modifications not expressly approved by the party responsible for compliance could void the user's authority to operate the equipment

IC STATEMENT

This device complies with Industry Canada's licence-exempt RSSs. Operation is subject to the following two conditions:

- (1) This device may not cause interference; and
- (2) This device must accept any interference, including interference that may cause undesired operation of the device.

Le présent appareil est conforme aux CNR d'Industrie Canada applicables aux appareils radio exempts de licence. L'exploitation est autorisée aux deux conditions suivantes :

- (1) l'appareil ne doit pas produire de brouillage, et
- (2) l'utilisateur de l'appareil doit accepter tout brouillage radioélectrique subi, même si le brouillage est susceptible d'en compromettre le fonctionnement.

5.2 GHz band is restricted to indoor use only

**The device has been evaluated to meet general RF exposure requirement.
The device can be used in portable exposure condition without restriction.**

1. 部件介紹

■ GO 2 相機

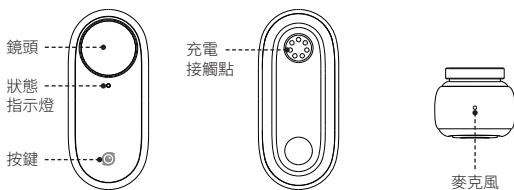

■ GO 2 充電盒

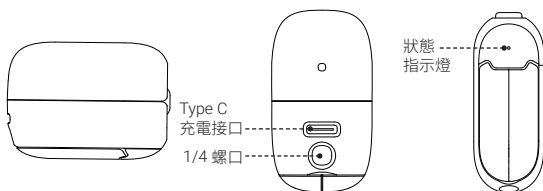

打開充電盒：

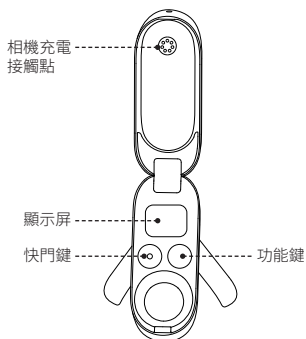

2. 充電

使用前，請先將相機和充電盒充滿電

■ GO 2 相機置入充電盒，進行充電

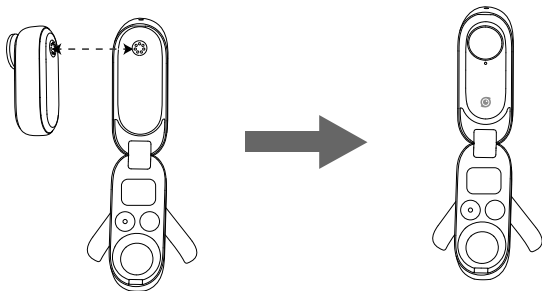

■ 使用隨附的充電線連接充電盒一側的 USB Type C 接口，對充電盒進行充電

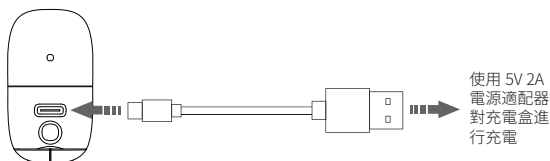

3. 使用

按住相機按鍵，相機短震兩次，相機開機，進入待機模式。

長按相機按鍵 2 秒，相機關機。

長按相機按鍵 6 秒，相機強制關機。

相機待機狀態下，默認單機按鍵，開始錄像。

相機待機狀態下，默認快速雙擊按鍵可進行拍照。

* 文檔如有更新，恕不另行通知。更多產品功能使用，請查看 GO 2 APP 內教程或訪問 <https://www.insta360.com/support/product.support>

1. 부품 소개

■ GO 2 카메라

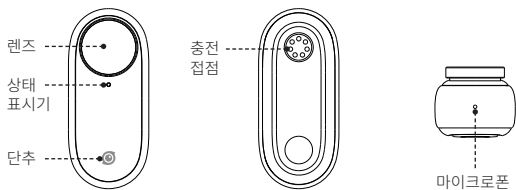

■ GO 2 충전 케이스

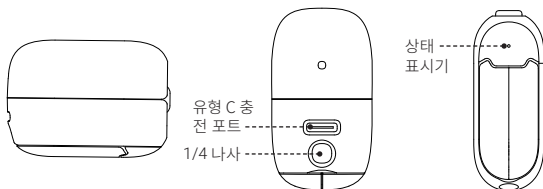

충전 케이스 열기:

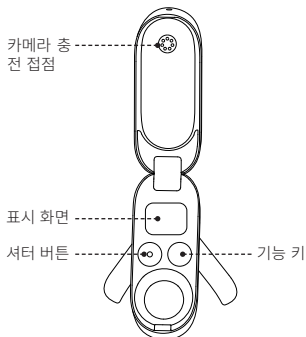

2. 충전

사용하기 전에 카메라와 충전 케이스를 완전히 충전하십시오 .

■ GO 2 카메라는 충전을 위해 충전 케이스에 배치됩니다 .

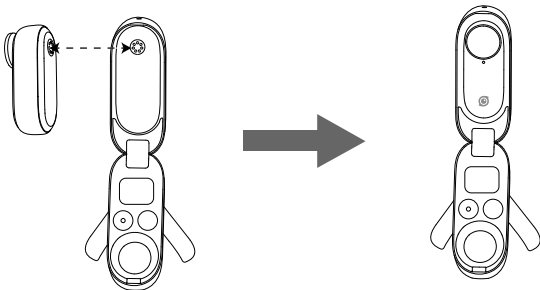

■ 제공된 충전 케이블을 사용하여 충전 상자 측면의 USB Type C 포트에 연결하여 충전 상자를 충전합니다 .

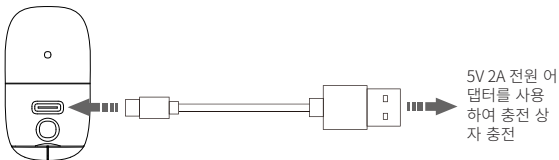

3. 사용

카메라 버튼을 길게 누르면 카메라가 잠시 두 번 흔들리고 카메라가 켜지고 대기 모드로 들어갑니다 .

카메라 버튼을 2 초간 길게 누르면 카메라가 꺼집니다 .

카메라 버튼을 6 초 동안 길게 누르면 카메라가 강제 종료됩니다 .

카메라가 대기 모드에 있으면 기본 독립 실행 형 버튼이 녹화를 시작합니다 .

카메라가 대기 모드에있을 때 기본적으로 버튼을 빠르게 두 번 클릭하여 사진을 찍을 수 있습니다 .

* 이 문서는 예고없이 변경 될 수 있습니다 . 더 많은 제품 기능을 보려면 GO APP 의 자습서를 확인하거나 <https://www.insta360.com/support/product.support> 를 방문하십시오 .