

HOSMART® HY-6 16B  
Digital Wireless Intercom  
Real-time Two-way Talk

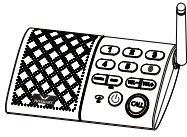

User Guide

then you can select a ringtone that you like, you have 8 melodies to choose from. You can press the VOL+ and VOL- Buttons to select different ringtones.

**Pairing**

The intercom system is ready to use. If you would add extra unit(s), or you want to pair anew all your units, you can follow the steps below.

Eg. You have already 4 units in your intercom system, you want to add one more unit.

- 1). Choose any unit of your intercom system (Unit A).
- 2). Press and hold the Group Button of the Unit A, you will hear 1 beep, then press the Channel Button that you would distribute to the add-on unit. When the Channel Button starts to blink, the Unit A is ready to pair.
- 3). Press and hold the Group Button of the add-on unit (Unit B), you will hear 1 beep. When you hear two more beeps, the Unit B is successfully connected to the system.

**ATTENTION:** If you distribute one channel to multiple units, it may cause system failure.

**Technical Specifications**

Power Supply:

Power Adapter: 5V/1A

Wireless Transmission Distance: 1/4 mile (400 meters) in open area.

Thank you for purchasing this Hosmart® product. This user manual will help you to familiarize yourself with all the features of your newly purchased product. If you have any questions about the product, please contact us by navigating to [www.hosmart.com](http://www.hosmart.com), then click Warranty, and fill out the form, we will assist you as quickly as possible

✉ [service@hosmartmail.com](mailto:service@hosmartmail.com)

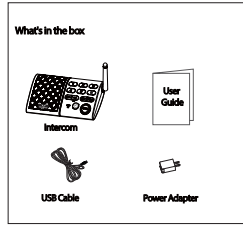

1

Wireless Transmission Power: ≤0.5W  
Work Temperature: -4°F to 140°F (-20°C to +60°C)

**Troubleshooting**

- 1) Intercom cannot power on Are AC Adapter and USB cable connected properly?
  - a. Check the intercom if it is successful pair.
  - b. Check the receiving distance between the intercoms if it is out of range.
- 2) Cannot talk to other intercoms.
  - a. Make sure the volume of the intercom has been increased enough.
  - b. Try to be closer to the MIC during the talk.
- 3) The sound of the intercom is too low.
  - a. Make sure the volume of the intercom has been increased enough.
  - b. Try to be closer to the MIC during the talk.
- 4) Intercom is not getting the expected transmission range Keep the intercom away from metal objects and interference sources.
- 5) Static noise and howling noise can be heard from the intercom
  - a. Maybe the two intercoms are too close, please try to move away.
  - b. Some electrical equipment will also interfere with the intercom to cause the static, e.g. Microwave Oven, cell phone, or other radio devices, please try to adjust the position of the intercom.

5

**Overview**

HY-616B is a wireless portable full duplex real-time intercom system providing clear sound, added reliability, and secure communication. The intercom has a range of 1/4 mile (400 meters) in open area.

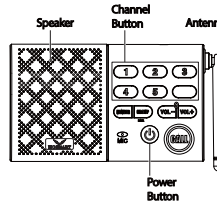

2

the position of the intercom.  
c. If the problem has not been solved, please contact us for technical support.

**Cautions**

The following will help you maintain your wireless intercom for years to come.

- \*Keep stations from getting wet, as they are not waterproof.
- \*Keep stations in a controlled environment. Avoid extreme temperatures.
- \*Handle the stations with care. Do not drop, throw, or mishandle the stations.
- \*Keep stations clean from dust and dirt as this can damage sensitive electronics.
- \*Do not use chemicals or cleaning solvent. Use a damp cloth to clean the station.
- \*Modifying or tampering with the station's internal components can cause it to malfunction, and will also void your warranty.

**Limited 24 Months Warranty**

EXCEPT AS PROVIDED HEREIN, SELLER MAKES NO EXPRESS WARRANTIES AND ANY IMPLIED WARRANTIES, INCLUDING THOSE OF MERCHANTABILITY AND FITNESS FOR A PARTICULAR PURPOSE, ARE LIMITED IN DURATION TO THE DURATION OF THE WRITTEN LIMITED WARRANTIES CONTAINED

6

**Making a call in 3 methods**

- 1). Press the Channel Button, then press the Call Button.
- 2). Press the Call Button, then press the Channel Button.
- 3). Press and hold the Channel Button for 1 second.

Press and hold the Call Button for three seconds to enter the group function mode. If one of the intercoms answers, only the two intercoms can talk to each other.

**Monitoring**

Eg. If you want to use Unit A to monitor Unit B. On Unit B, press the Monitor Button then press the Channel Button corresponding to Unit A.

**Making a group broadcast**

Press Group Button, then you can make a broadcast.

**Power Button**

- 1). To turn on the device, press and hold the button for 1 second, you will hear 1 beep.
- 2). To turn off the device, press and hold the button for 3 seconds, you will hear 3 beeps.
- 3). To exit from any mode, press simply the button.

**Volume Button**

- 1). You can press VOL+ or VOL- to adjust the volume.
- 2). To change the ringtone, you should press and hold the VOL+ and VOL- at the same time,

3

HEREIN, EXCEPT AS PROVIDED HEREIN, SELLER SHALL HAVE NO LIABILITY OR RESPONSIBILITY TO CUSTOMER OR ANY OTHER PERSON OR ENTITY CONCERNING ANY LIABILITY, LOSS OR DAMAGE CAUSED DIRECTLY OR INDIRECTLY BY USE OR PERFORMANCE OF THE PRODUCT OR ARISING OUT OF ANY BREACH OF THIS WARRANTY, INCLUDING, BUT NOT LIMITED TO ANY DAMAGES RESULTING FROM INCONVENIENCE, LOSS OF TIME, DATA, PROPERTY, REVENUE, OR PROFIT OR ANY INDIRECT, SPECIAL, INCIDENTAL, OR CONSEQUENTIAL DAMAGES, EVEN IF SELLER HAS BEEN ADVISED OF THE POSSIBILITY OF SUCH DAMAGES.

In the event of a product defect during the warranty period, contact the Seller to return the product, along with the sales receipt as proof of purchase date, to the Seller. The Seller will, at its option either correct the defect by product repair without charge for parts and labor; replace the product with one of the same or similar designs, or refund the purchase price. All replaced parts and products and refunded products become the property of the Seller. New or reconditioned parts and products may be used in the performance of warranty service. Repaired or replaced parts and products are warranted for the remainder of the original warranty period. You will be charged for repairs on products no longer covered by warranty.

For all returns, please let us know the purchasing chan-

7

nel and order number. This will speed up the process of handling your return and issuing a refund or providing you with a replacement. Refunds are not issued for products any longer covered by a warranty. The warranty will not cover replacements in cases where damage or failure is caused by, or attributable to:

- (a) acts of God, abuse, accident, misuse, improper abnormal usage, failure to follow instructions, improper installation or maintenance, alteration, lightning or other instance of excess voltage or current,
- (b) any repairs other than those provided by the Seller,
- (c) consumables such as fuses or batteries, cosmetic damage,
- (d) transportation, shipping or insurance costs,
- (e) or costs of product removal, installation, set-up, service adjustment or reinstallation.

Our goal is for you to have the best possible experience with Hosmart®. We appreciate receiving comments on any aspect of your experience with Hosmart or our products. Please contact us with any problems, before leaving any online feedback, so that we may address your concern.

**FCC Statement**

This equipment has been tested and found to comply

8

with the limits for a Class B digital device, according to Part 15 of the FCC Rules. These limits are designed to provide reasonable protection against harmful interference in a residential installation. This equipment generates uses and can radiate radio frequency energy and, if not installed and used by the instructions, may cause harmful interference to radio communications. However, there is no guarantee that interference will not occur in a particular installation. Suppose this equipment does cause harmful interference to radio or television reception, which can be determined by turning the equipment off and on. The user is encouraged to try to correct the interference by one or more of the following measures:

- Reorient or relocate the receiving antenna.
- Increase the separation between the equipment and receiver.
- Connect the equipment into an outlet on a circuit different from that to which the receiver is connected.
- Consult the dealer or an experienced radio/TV technician for help. This device complies with part 15 of the FCC Rules. Operation is subject to the following two conditions:
  - (1) This device may not cause harmful interference, and
  - (2) This device must accept any interference received, including interference that may cause undesired operation. Changes or modifications not expressly approved by the party responsible for compliance

9

could void the user's authority to operate the equipment.

**FCC RF Radiation Exposure Statement:**

1. This Transmitter must not be co-located or operating in conjunction with any other antenna or transmitter.
2. This equipment complies with RF radiation exposure limits set forth for an uncontrolled environment.
3. This equipment should be installed and operated with minimum distance 20cm between the radiator& your body.

**The FCC wants you to know**

Your intercom may cause TV or radio interference. To be a certain turn off your intercom and check your TV or radio on its performance. If still receiving interference, rest a sure it is not your intercom. You may try to eliminate interference by:  
\*Moving your stations further away from the receiver.  
\*Moving your stations further away from your TV or radio. If these options do not solve your problem the FCC requires you to stop using your intercom. Changes or modifications not approved by the party responsible for compliance could void the user's authority to operate the equipment.

**IC Statement**

This device contains licence-exempt transmitter(s)/ receiver(s) that comply with Innovation, Science

10

and Economic Development Canada's licence-exempt RSS(s). Operation is subject to the following two conditions:

- (1) This device may not cause interference.
- (2) This device must accept any interference, including interference that may cause undesired operation of the device.

L'émetteur/récepteur exempt de licence contenu dans le présent appareil est conforme aux CNR d'Innovation, Sciences et Développement économique Canada applicables aux appareils radio exempts de licence. L'exploitation est autorisée aux deux conditions suivantes :

1. L'appareil ne doit pas produire de brouillage;
2. L'appareil doit accepter tout brouillage radioélectrique subi, même si le brouillage est susceptible d'en compromettre le fonctionnement.

This product manufactured by:

**Macross Microelectronics (HK) Limited**

RM1102, HANG SENG CASTLE PEAK RD BLDG. 339  
Castle Peak Rd, Cheung Sha Wan, KL, Hong Kong

11

12

13

14

15