

# COBAK

Wireless Charger

KB24LE

*Thank you*



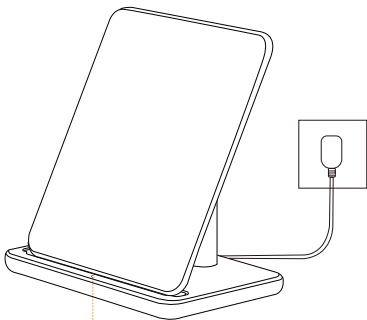

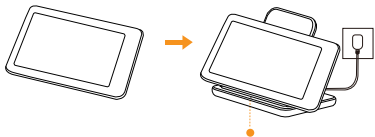
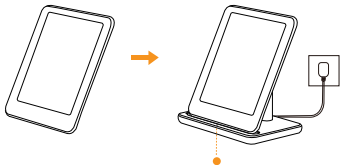

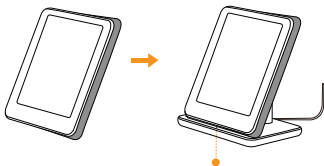
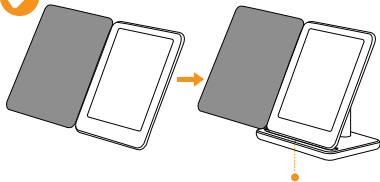

LED Indicator	Status
White on for 3 seconds	Power on (turns off 3 seconds after power-on indication)
Solid White	Charging status (remains on during charging)
Flashing White	Foreign object detected (e.g., non-wireless charging device)
Flashing Red	Overvoltage, undervoltage, or overheating detected



- Your device is compatible with an eBook cover. Please ensure that the eBook cover is placed on the stand in a way that it does not fold backwards.
- It is not recommended to use a protective case thicker than 5mm, as this may interfere with wireless charging functionality

## Important Safety Instructions

Before installing or operating this product, please refer to the electrical safety information below:

- Avoid dropping the product.
- Do not disassemble the product.
- Keep liquids away from the product.
- Do not use the product in environments where the temperature exceeds 40°C (104°F).
- Do not place any fire sources (such as candles) on the product.
- Only use a dry cloth or a digital cleaning device to clean the product.

**WARNING:** Only use attachments/accessories specified or provided by the manufacturer.



Indoor use only



This symbol indicates that this product should not be treated as household waste. Please dispose of it at an appropriate electronic waste collection point for recycling and proper disposal

Adapter Output	5V, 9V, 12V
Wireless Output	5W, 7.5W, 10W, 15W
Transmission/Reception Frequency Range	2400MHz - 2483.5MHz



This device complies with part 15 of the FCC Rules. Operation is subject to the following two conditions: (1) This device may not cause harmful interference, and (2) this device must accept any interference received, including interference that may cause undesired operation.

Any Changes or modifications not expressly approved by the party responsible for compliance could void the user's authority to operate the equipment.

**Note:** This equipment has been tested and found to comply with the limits for a Class B digital device, pursuant to part 15 of the FCC Rules. These limits are designed to provide reasonable protection against harmful interference in a residential installation. This equipment generates uses and can radiate radio frequency energy and, if not installed and used in accordance with the instructions, may cause harmful interference to radio communications. However, there is no guarantee that interference will not occur in a particular installation. If this equipment does cause harmful interference to radio or television reception, which can be determined by turning the equipment off and on, the user is encouraged to try to correct the interference by one or more of the following measures:

- Reorient or relocate the receiving antenna.
- Increase the separation between the equipment and receiver.
- Connect the equipment into an outlet on a circuit different from that to which the receiver is connected.
- Consult the dealer or an experienced radio/TV technician for help.
- This equipment complies with FCC radiation exposure limits set forth for an uncontrolled environment. This equipment should be installed and operated with minimum distance 20cm between the radiator & your body.