

**QUALITY PRODUCT    QUALITY LIFE**

## **Premium Quality Superior Design**

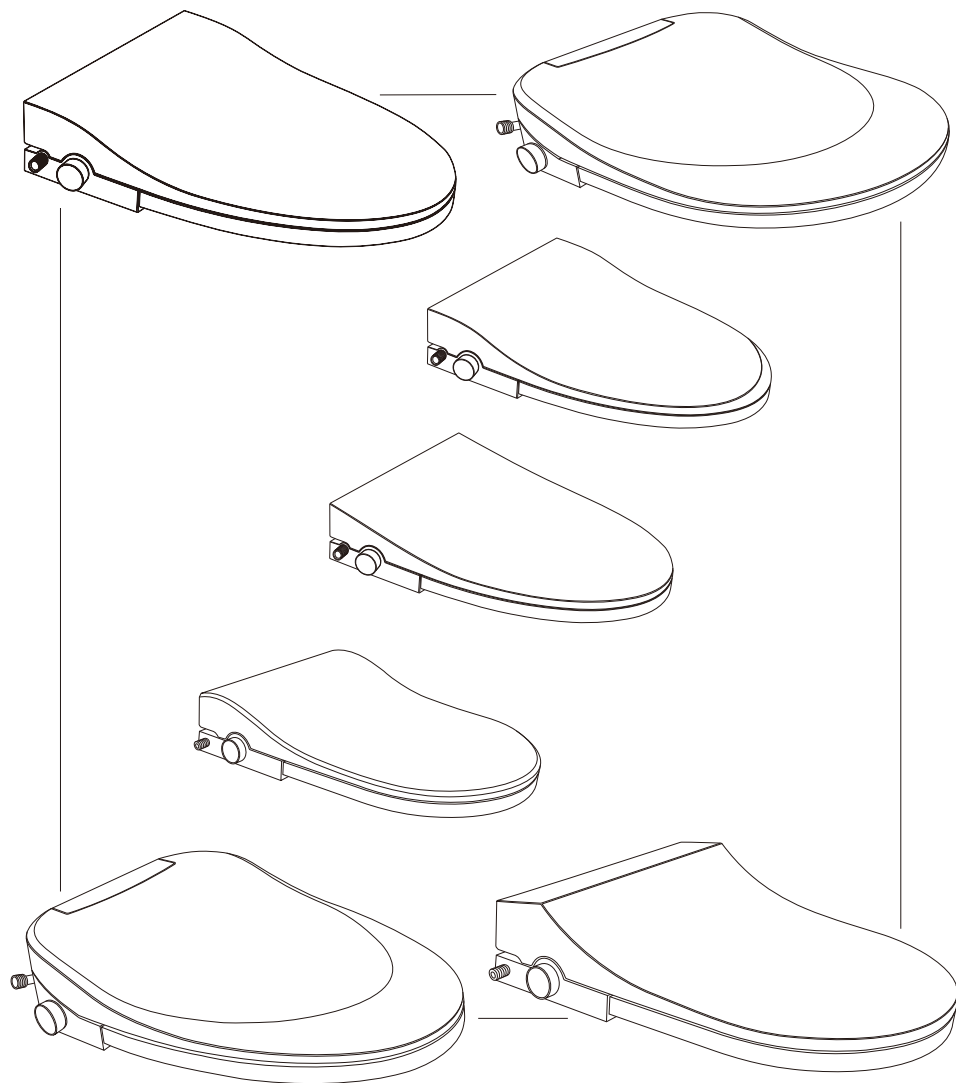

# 1. Bill of Package Materials

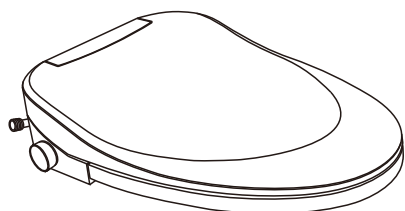

1 Main Unit

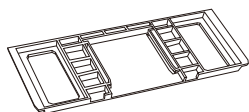

3 Fixing Plate

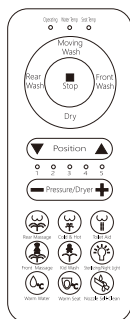

4 Remote Controller

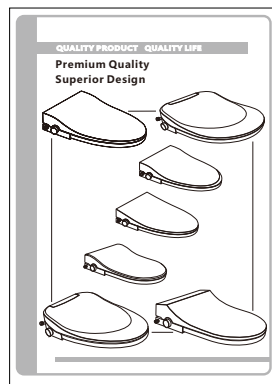

2 User Manual

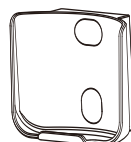

5 Bracket for Controller

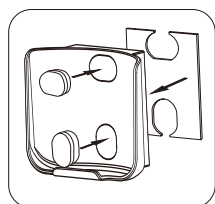

Paste Together

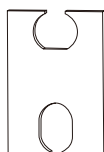

6 Double Side Tape

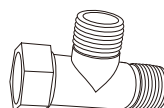

7 T-Valve

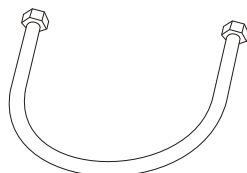

8 Water Pipe

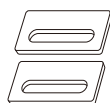

9 Adjustment Plates

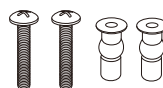

10 Expansion Screws

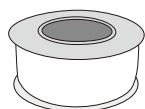

11 PTFE Thread Sealing Tape

## 2. Installation



### CAUTION



DO NOT CONNECT TO A POWER SOURCE UNTIL THE INSTALLATION HAS BEEN COMPLETED.

- Before you unpack and install this product, please recheck whether you have purchased the right bidet shape.
- The **ELONGATED** item is for longer V-shaped toilet, and the **ROUND** item is for shorter U-shaped toilet. 
- If you find you didn't make right shape choice to fit your toilet, please keep it packed in box and contact us to require a replacement service.

### 2.1. Open the package, you can remove the fixing plate as below

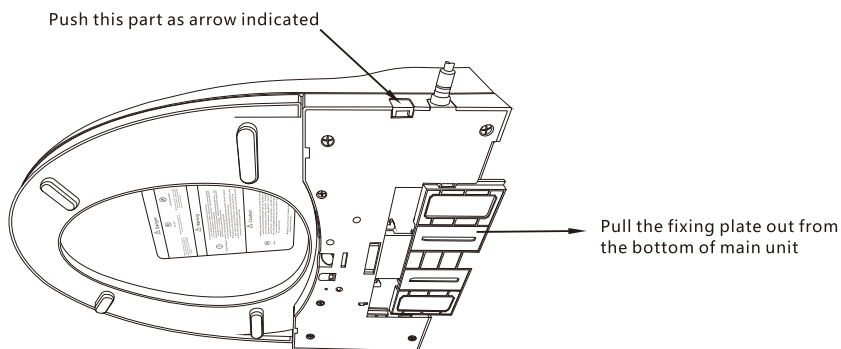

The fixing plate is installed at the bottom of our product, you need to pull it out before installing our product upon the toilet.

### 2.2. Installation Steps

#### First Step:

- Press the rubber expansion screws firmly into the bolt holes.
- Move the fixing plate back and forth to select the distance for aligning the bidet with the front of the toilet.
- Screw the adjustment plates and fixing plate together tightly.

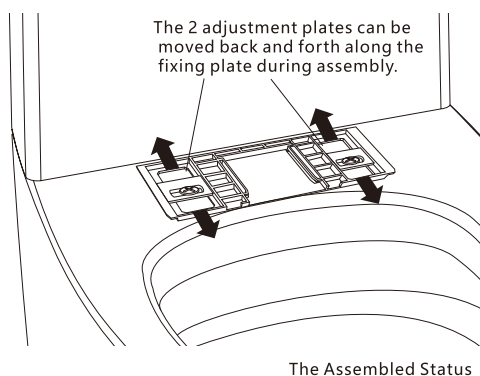
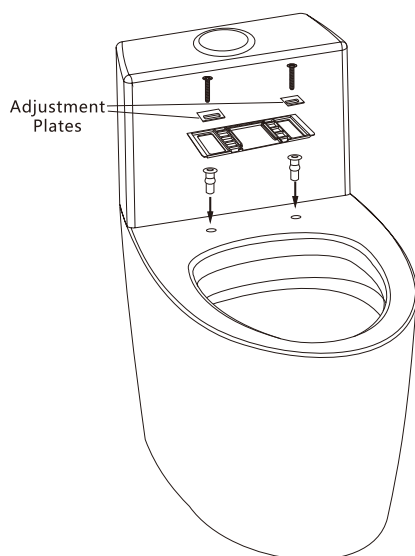

**The second step:**

Push the main unit into the fixing plate according to the arrow direction, the main unit will be inserted into the plate tightly.

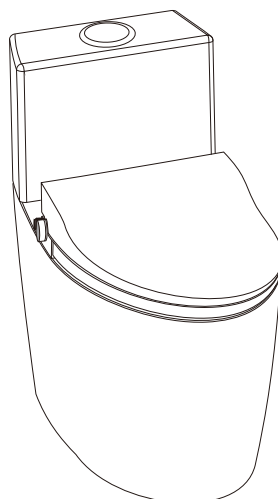
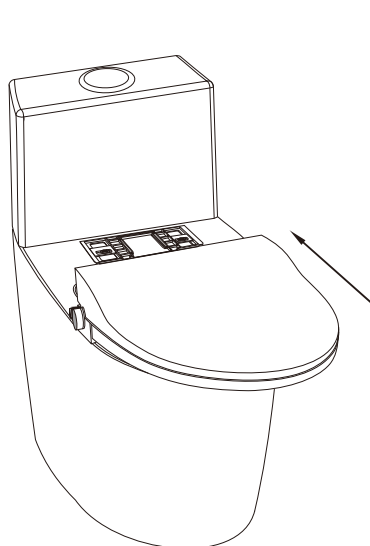

The Assembled Status

### 3rd step:

\*Before installing the T-valve, please wrap the attached PTFE thread sealing tape around the three places(a & b & c) several times.

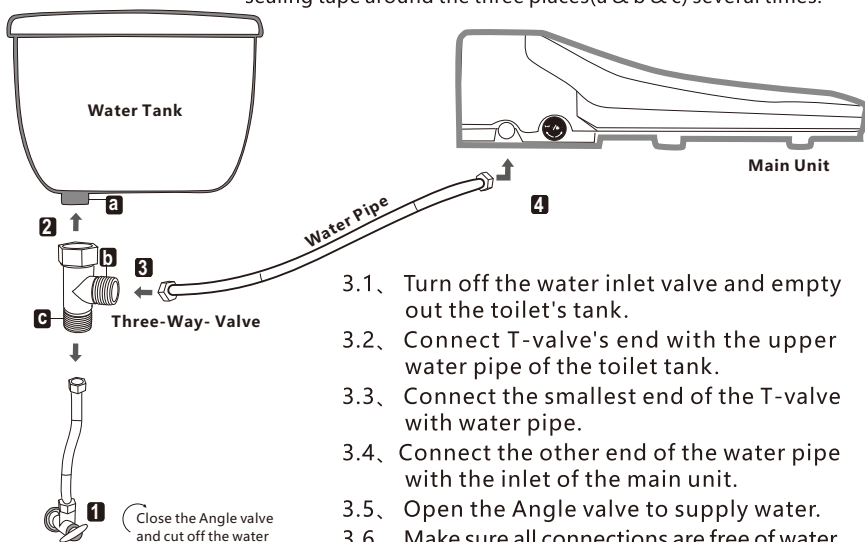

- 3.1、 Turn off the water inlet valve and empty out the toilet's tank.
- 3.2、 Connect T-valve's end with the upper water pipe of the toilet tank.
- 3.3、 Connect the smallest end of the T-valve with water pipe.
- 3.4、 Connect the other end of the water pipe with the inlet of the main unit.
- 3.5、 Open the Angle valve to supply water.
- 3.6、 Make sure all connections are free of water by using the PTFE thread sealing tape.

### 4th step:

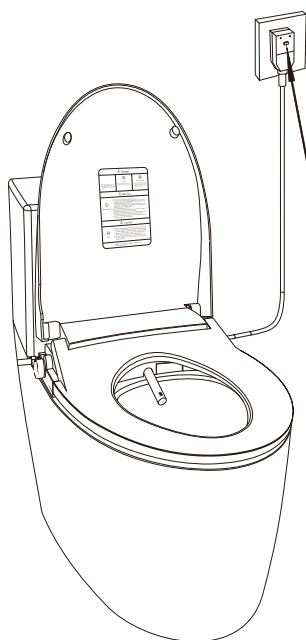

⚠ AC socket should connect with ground, otherwise the power plug won't operate correctly.

- 4.1、 Insert the power plug into the AC socket;
- 4.2、 Press the Red button to get power on, the light will turn on;
- 4.3、 If the bidet seat will not be used for a while, press the Test button to get power off.

### 2.3、If you want to remove the main unit from toilet, please do it as below:

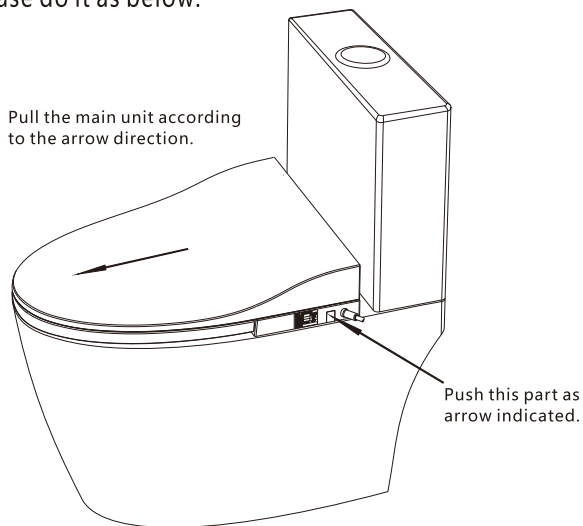

If you need to remove the main unit, please do it based on the 2 actions as above.

### 2.4、 Technical Parameter

Rating Voltage	Cap: AC 120V 60Hz Remote Control: DC 3.0V AA*2
Maximum Power	1000W
Water Proof Class	IPX4
Operating Temperature	3-40°C/37-104°F
Inlet Water Temperature	4-35°C/39-95°F
Water Pressure	0.07~0.7MPa
Warm Water Temperature	34-40°C/93-104°F
Maximum Power for Instant Heater	950W
Warm Seat Temperature	35-42°C/95-108°F
Warm Seat Power	50W
Dry Temperature	40-50°C/104-122°F
Dryer Power	250W
Package Dimension	58*53*18 cm/22.6x20.8x7.1 inch
Weight	Approx. 3.78kg/8.33lb
The Length of AC Wire	1.4M/4.59FT

## Product Function

Function	Elongated Version	Round Version
Rear Wash	√	√
Front Wash	√	√
Toilet Aid	√	√
Cold & Hot	√	√
Massage Wash	√	√
Dry	√	√
Nozzle Position Change	√	√
Nozzle Moving Wash	√	√
Water Pressure/Dry Temperature Change	√	√
Warm Water Temperature Change	√	√
Warm Seat Temperature	√	√
Easy Operating for Side Knob	√	√
Sterilization	√	√
Nozzle Self-Cleaning	√	√
Human Sense	√	√
Remote Control	√	√
Night Light	√	√

## 3. Main Part of Unit

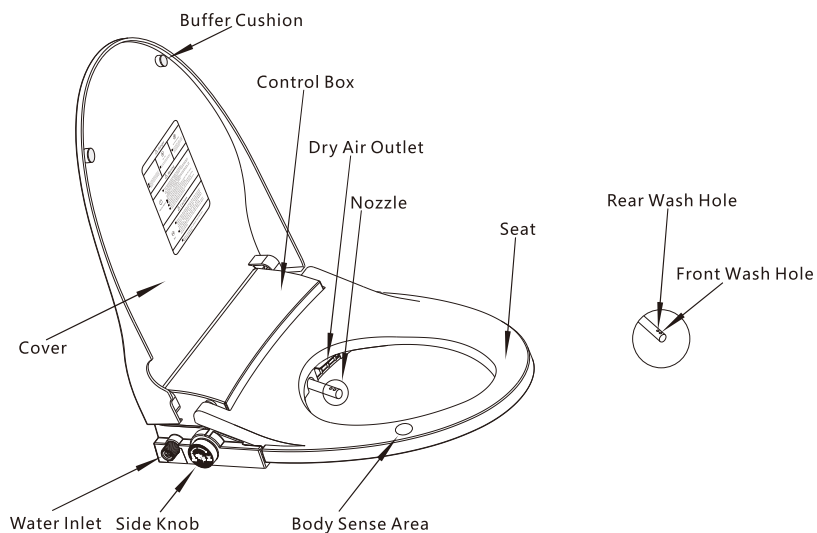

## 4. Operating

### 4.1、Side Knob

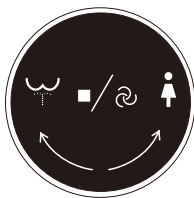

- Rotate this knob toward different arrow directions for choosing Rear Wash or Front Wash.
- Short press the middle key of Knob, it can stop the wash and dry function.
- Long press the middle key of Knob, and then enter the dry function.

**Warm tip:** After setting up levels for “Warm water” & “Warm seat” & “Dry level” with Remote controller during usage, you can easily operate the same level as last time by using this knob with memory function.

### 4.2、Function Guide of the Remote

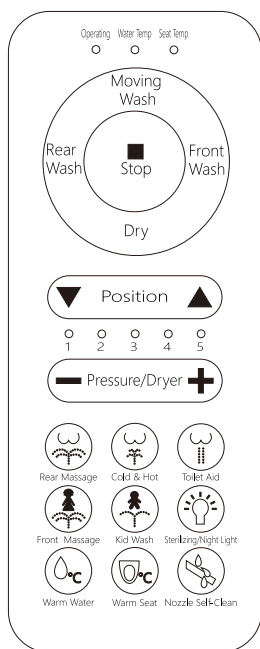

**NOTE:** Batteries are not included. 2 AAA batteries required, please use the correct battery type. Do not use old and new batteries together.

- Remote Connection Setup
- Note: The Remote has already been connected with the bidet seat during manufacturing process, you just need to install the batteries to make it work. But if you found the remote doesn't work, you can reconnect the remote easily manually by following the steps as below:

- 1、Short-press the side knob for 3 times quickly and continuously to turn the yellow light on.
- 2、Long-press the Stop button on the remote.
- 3、When you hear "bee bee" sound, it means the remote is connected with the bidet seat and the yellow light will turn to blue.

**Note :** The nozzle extends out for different washing modes ONLY when somebody is sitting on the bidet seat.

The nozzle can do self cleaning automatically before and after each toilet usage. At this time, there will be the sound of water droplets, which is a normal phenomenon.



- 4.2.1、 **Stop**: When you press **Stop** button, the operation you are performing will be stopped.
- 4.2.2、 **Rear Wash**: When you press **Rear Wash** button, the Rear Wash Hole will begin to spray.  
**Note** : The rear washing function will run for 2 minutes, and water temperature can be adjusted during this process.
- 4.2.3、 **Front Wash**: When you press the **Front Wash** button, the Front Wash Hole will begin to spray.  
**Note** : The front washing function will run for 2 minutes, and water temperature can be adjusted during this process.
- 4.2.4、 **Cold & Hot**: When you press the **Cold & Hot** button, you can enjoy warm water and cold water for 10 seconds each.  
**Note** : This function will run for 2 minutes, and temperature of warm water can be adjusted during this process.
- 4.2.5、 **Rear Massage & Front Massage**: Press the **Rear Massage** or **Front Massage** button, after the nozzle sprays water for 20 seconds, the mode 4 of water pressure will run for 5 seconds, then the mode 1 of water pressure will run for 5 seconds.
- 4.2.6、 **Kid Wash**: When you press **Kid Wash** button, the setting of water temperature will be Low. The nozzle will wash in the set position for 15 seconds; then the nozzle will move back and forth to wash for 30 seconds; the nozzle will finally turn into the set position to wash for another 15 seconds.
- 4.2.7、 **Dry**: Press **Dry** button to start warm air drying.  
This function will run for 3 minutes and the temperature of the air flow can be adjusted during this process.
- 4.2.8、 **Toilet Aid**: Press **Toilet Aid**, the nozzle will spray from the Rear Wash Hole for 1 minutes, and water temperature can be adjusted during this process.
- 4.2.9、 **▲ Position ▼**: Change the nozzle position by using the ▼ and ▲; When the nozzle extends out and starts to wash, you can press the “▲” or “▼” to change the washing position of nozzle.  
**Note** : Position of nozzle can be adjusted to 1.18-3.94inch/30-100mm when washing in the set position; the center position can be adjusted to 1.77-3.35inch/45-85mm when it is in the Moving Wash mode.  
**Press** the “▲” button, the nozzle will move back. When the nozzle is in the shortest position, you will hear “beep” sound if press the button again.  
**Press** the “▼” button, the nozzle will move forward. When the nozzle is in the longest position, you will hear “beep” sound if press the button again.
- 4.2.10、 **Moving Wash**: The nozzle will move back and forth to 0.59inch/15mm according to the center position when washing.

- 4.2.11、 **Water Pressure Adjustment:** There are 6 water pressure modes: 0,1,2,3,4, and 5.  
**When** washing, water pressure can be adjusted from 0 to other 5 modes by pressing “-/+” of **Pressure/Dryer** button.  
**When** No additional water pressure, the indicator light of the 5 modes (1-2-3-4-5) will not be on.  
**Mode** 1-2-3-4-5: Press the “-/+” of **Pressure/Dryer** button, the corresponding indicator light of the 5 modes will be turned on.  
**Note:** The higher mode you choose, the greater the water pressure you will enjoy.
- 4.2.12、 **Dryer Temperature Adjustment:** There are 6 air dry temperature modes: 0,1,2,3,4, and 5.  
**While** the air dry mode is operating, you can adjust the temperature of the air flow by using the “-/+” of **Pressure/Dryer** button.  
**When** the air temperature will not be heated, the indicator light of the 5 modes (1-2-3-4-5) will not be on.  
**Mode** 1-2-3-4-5: When you press the “-/+” of **Pressure/Dryer** button, the corresponding indicator light of the 5 modes will be turned on.  
**Note:** The higher mode you choose, the higher the dry temperature you will enjoy.
- 4.2.13、 **Water Temperature:** Press **Warm Water** button to adjust water temperature. Four temperature settings for choosing: Room Temperature, Low, Medium, and High.  
**Room Temperature:** Water will not be heated, the Water Temp indicator flashes white light one time.  
**Low:** The Water Temp indicator flashes green light one time when adjusting. The water temperature will be 86°F/34 °C.  
**Medium:** The Water Temp indicator flashes blue light one time when adjusting. The water temperature will be 98.6°F/37 °C.  
**High:** The Water Temp indicator flashes red light one time when adjusting. The water temperature will be 102.2°F/39 °C.  
**Note:** Water temperature can be adjusted circularly from Room Temperature to Low, Medium, High by pressing the button continuously.
- 4.2.14、 **Seat Temperature:** Press **Warm Seat** button to adjust seat temperature. Four Temperature settings for choosing: Room Temperature, Low, Medium, and High.  
**Room Temperature:** Seat will not be heated, the Seat Temp indicator flashes white light one time.  
**Low:** The Seat Temp indicator flashes green light one time when adjusting. The seat temperature will be 91.4°F/33°C.  
**Medium:** The Seat Temp indicator flashes blue light one time when adjusting. The seat temperature will be 95°F/35°C.  
**High:** The Seat Temp indicator flashes red light one time when adjusting. The seat temperature will be 98.6°F/37 °C.  
**Note:** Seat temperature can be adjusted circularly from Room Temperature to Low, Medium, High by pressing the button continuously.
- 4.2.15、 **Sterilizing/Night Light:** When the blue light at the bottom of toilet seat stays on, it is **Night Light** Function; When the blue light flashes, it is **Sterilization Function**; **Sterilization Function** will be turned on automatically when you leave the seat; **Night Light Function:** On or Off by short press.  
**Sterilization Function:** On or Off by long press.

4.2.16、 **Nozzle Self-clean:** The nozzle can do self cleaning automatically before and after each toilet usage. But when nobody is on the seat and the button is pressed, water will flow out to clean the Nozzle and you can press **Stop** button to stop it.

4.2. 17、 Long-press the Nozzle sel-Clean button to turn off/on the "Bee, Bee" sound

### 4.3、 Installation of the remote holder

- Clean the wall surface in the area in which the remote control holder will be located.

Dry fully before attempting the installation

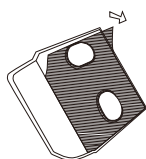
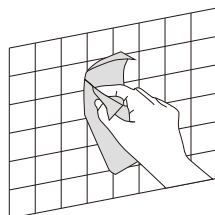

- From the rear of the double side tape, peel off the adhesive strip cover.

- Place the bracket with the adhesive side to the wall, ensuring this is level, press to the wall firmly and hold for a couple of seconds.

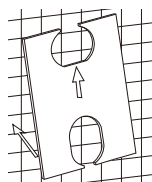

- Once located and secure, place the remote control against the bracket. The magnet within the holder will retain the remote in position.

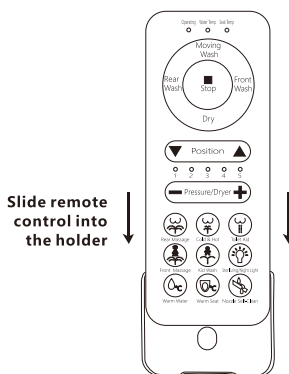
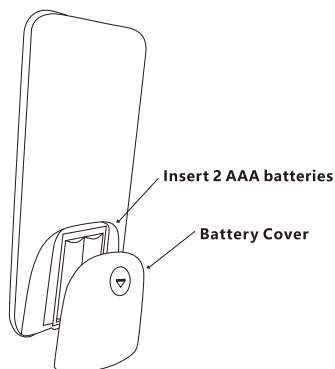

### Caution

1. The unit only can be powered by 120V/60HZ AC Mains.
2. The AC socket should be fixed in the wall, and the distance should be least 50CM/20 in higher than the floor, the safe ground connection should be guaranteed.
3. To avoid the electric shock accident, please don't install the unit at the place where will be easily splashed by water or conducting liquid.
4. Socket or wiring should be withstand the maximum power load of the unit, independent socket or wiring is suggested.
5. In order to avoid the electric shock accident, the power code shouldn't be damaged by weight or sharp instrument crushed.
6. Don't touch the socket or power plug with wet thing, or flush the socket with liquid, otherwise, the electric shock accident will happen. Please clean the power plug with dry and clean cloth, and insert the power plug into the socket tightly.
7. To avoid damaging the unit, the inlet liquid or clean liquid should exclude the industry water/waste water/sea water or other chemical liquid.
8. The power plug should be pulled out when thunder occur.
9. The suggested operating ambient temperature is 3-40°C/37-104°F, if it is below 3°C/37°F, the inlet ice water may damage the unit.
10. It will cause the unit deteriorating or fading or unreliable function if the unit is put on the sunshine.
11. If you want to clean the unit, please pull out the power plug first, then you can clean the unit with clean cloth(dip in water, and wring dry).
12. To avoid damaging or fire, Please put the unit far away from the heating appliance or object in flames.
13. To avoid damaging, please don't lean against the toilet.
14. When the nozzle stretches out, please don't pull it in case of damaging.
15. Try to avoid the pee or shit dipping on the nozzle, otherwise, the bacteria will easily grow on it; If some dirty is on the nozzle, please clean it.
16. Do not tilt the unit 45° or upside down the unit during shipping/storage/installation; otherwise, the unit may be damaged.
17. Do not insert the slender object into the unit, otherwise, it will cause the unit to be damaged or electric shock accident.
18. When installing or disassembling or repairing the unit, the professional people is suggested.
19. To ensure the water flow smoothly, the inlet pipe shouldn't be bent or twisted; otherwise, the wash function will be affected.

20. Do not leave the kid or intellectually disabled people alone in the room when install the unit; Do not let them play with the unit. If they need use the unit, It should be supervised by adult.
21. Select low temperature for children, the elderly and the disabled.
22. Do not use the unit if there is shower nozzle spraying nearby.
23. The seat and cover are slow closing. Do not lower them by force.
24. Unplug the appliance if it will not be in use for several weeks. For longer periods, drain out the water as well.

#### FCC Statement

This device complies with Part 15 of the FCC rules. Operation is subject to the following two conditions: 1) this device may not cause harmful interference, and 2) this device must accept any interference received, including interference that may cause undesired operation.

Note: This equipment has been tested and found to comply with the limits for a Class B digital device, pursuant to part 15 of the FCC Rules. These limits are designed to provide reasonable protection against harmful interference in a residential installation. This equipment generates uses and can radiate radio frequency energy and, if not installed and used in accordance with the instructions, may cause harmful interference to radio communications. However, there is no guarantee that interference will not occur in particular installation. If this equipment does cause harmful interference to radio or television reception, which can be determined by turning the equipment off and on, the user is encouraged to try to correct the interference by one or more of the following measures:

- Reorient or relocate the receiving antenna.
- Increase the separation between the equipment and receiver.
- Connect the equipment into an outlet on a circuit different from that to which the receiver is connected.
- Consult the dealer or an experienced radio/TV technician for help.

Changes or modifications not expressly approved by the party responsible for compliance could void the user's authority to operate the equipment.

#### Radiation Exposure Statement

This device complies with RF radiation exposure limits set forth for an uncontrolled environment. The device can be used in portable exposure condition without restriction.