

AWNASWS020 Overflow usage Instructions

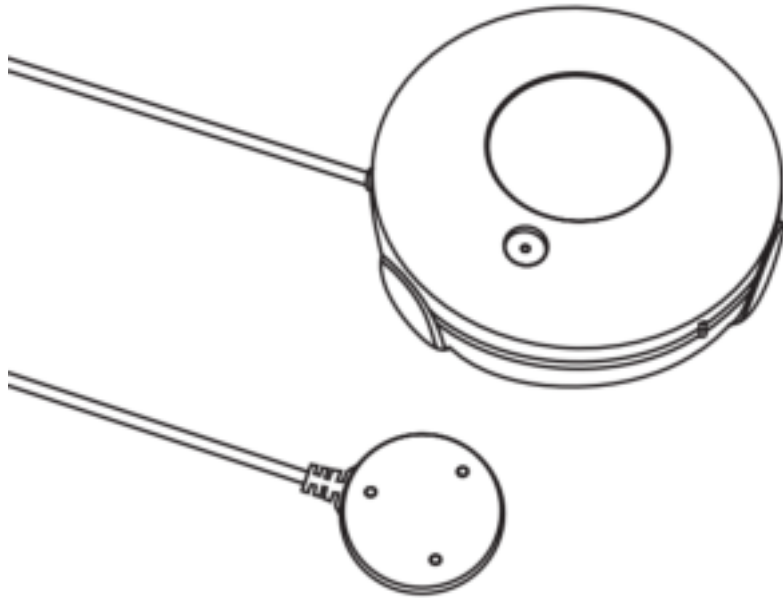

underlying parameter

Product Name: Auto Water Turn-Off System

Battery model: CR123A 3V *1

Sleep current: 1.8uA

Wi-Fi distance: 45M

Wi-Fi frequency: 2.4GHz

Wi-Fi standard: IEEE 802.11b/g/n

Bluetooth version: Bluetooth 5.0

Operating temperature: 0°C to 50°C (32° F to 122° F)

Working humidity: 1% - 95%RH(non-condensing)

Product size: 68mm x 68mm x 34mm

The indicator light corresponds to the status of the device

Equipment status	Indicator light status
Smart Wi-Fi network configuration, Bluetooth network configuration	The indicator light flashes twice per second
AP mode network distribution, Bluetooth network distribution	The indicator light flashes once every two seconds
Reset	Press and hold the reset button for 6 seconds, and the buzzer will soun

产品配置

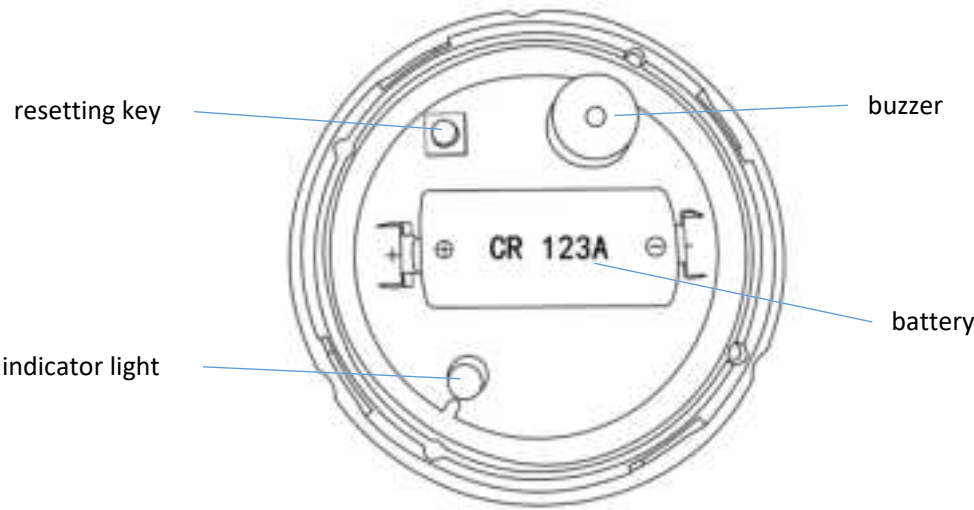

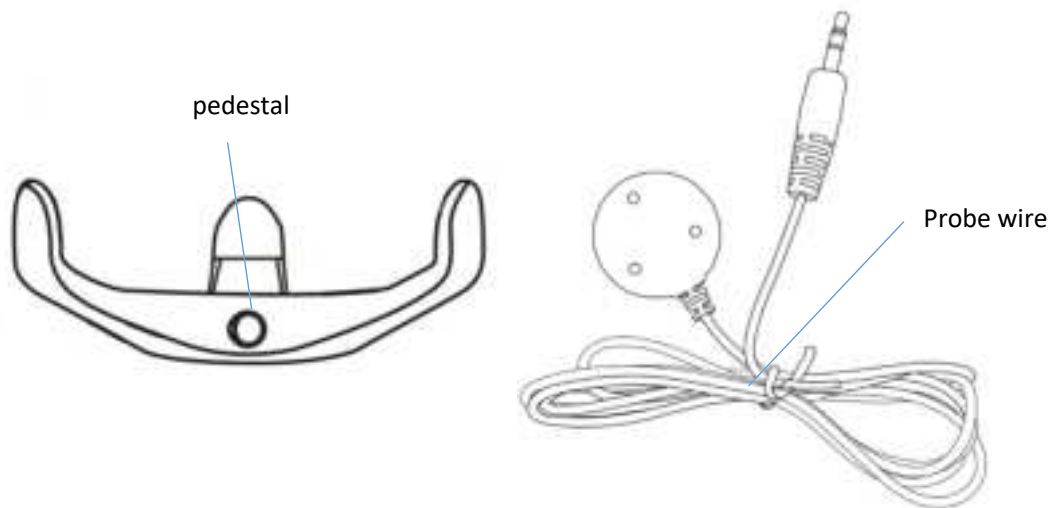

install and use

1. Power on the equipment and add

- (1) Rotate counterclockwise to remove the upper cover
- (2) Remove the battery insulation sheet
- (3) Reset the added device

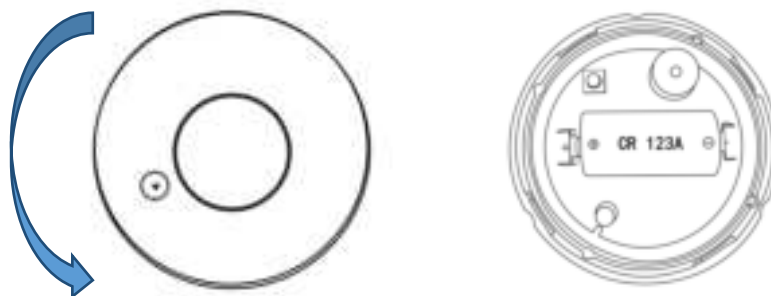

Installation and use

- ① Fix the base of the equipment to the wall with 3M glue or screws
- ② Connect the probe wire to the base
- ③ Install the overflow device into the base and the installation is complete

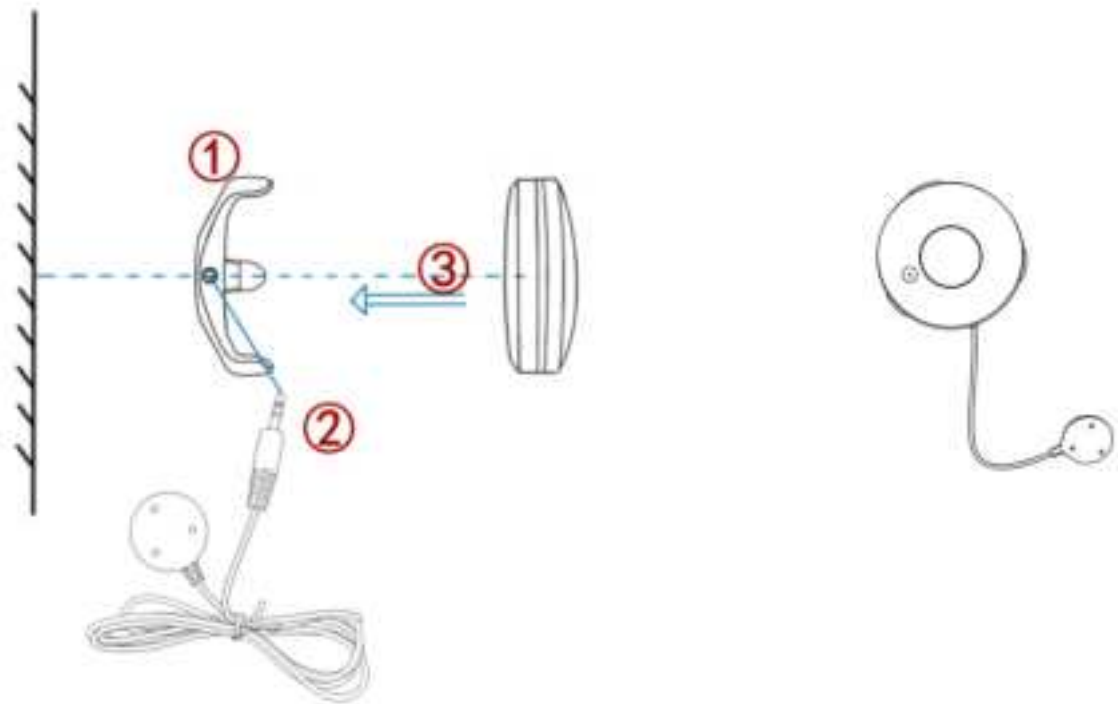

Download the APP

1. Android system: Download the "Smart Life" APP on GooglePlay;

IOS system: Download the "Smart Life" APP from the AppStore;



2.Run the APP, register and log in to your account



add equipments

When the device is powered on, it defaults to the standby mode (with the indicator light flashing). If the reset key indicator light is not on, please hold down the reset key for 6 seconds before adding the device

Note: All Wi-Fi products can add any Wi-Fi option. The device only supports 2.4GHz Wi-Fi signals. This instruction manual takes sockets as an example

1. Select the device type for addition

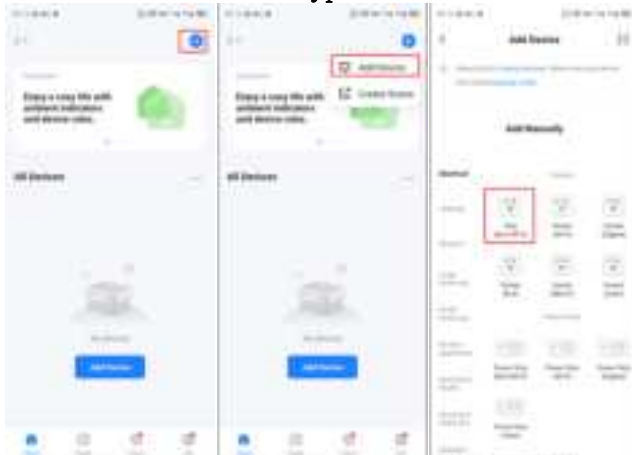

2.

2. Bluetooth addition (It is recommended to use this method for addition

1).Method One: Turn on Bluetooth on your mobile phone and add the device through Bluetooth mode (you can add it via Bluetooth in the standby mode).



2).Method Two (After turning on Bluetooth, enter the APP interface. The device will be automatically searched by Bluetooth. Then click "Add" again.)

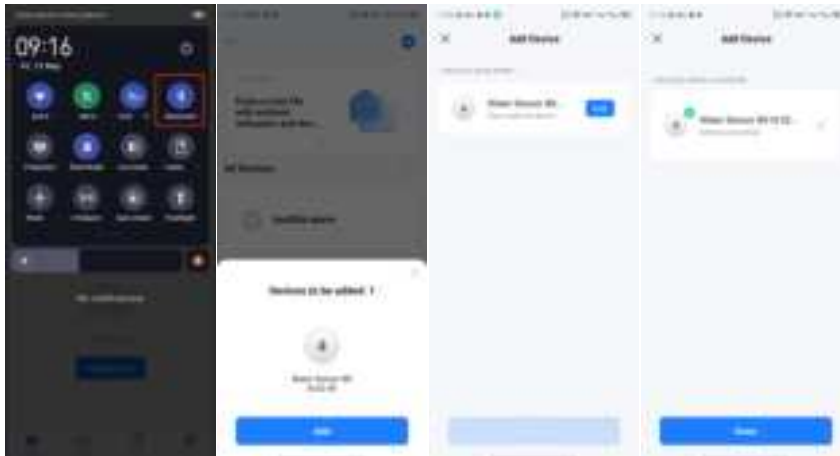

3. Smart Wi-Fi addition

Press the reset button until the device changes to the flashing indicator light (standby mode), and then add (please follow the APP prompts to operate).

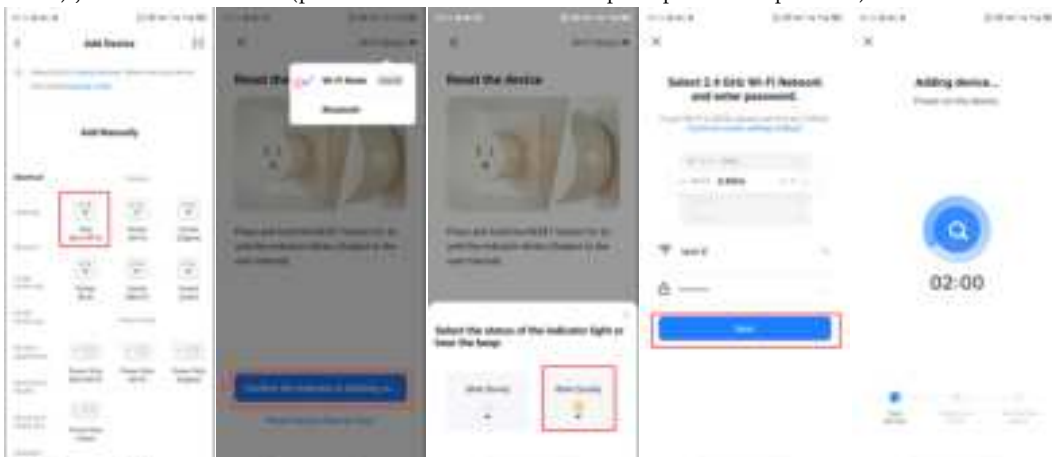

4. AP compatibility mode added

Press the reset button until the device changes the indicator light to flash slowly (standby mode), and then add (please follow the APP prompts to operate).

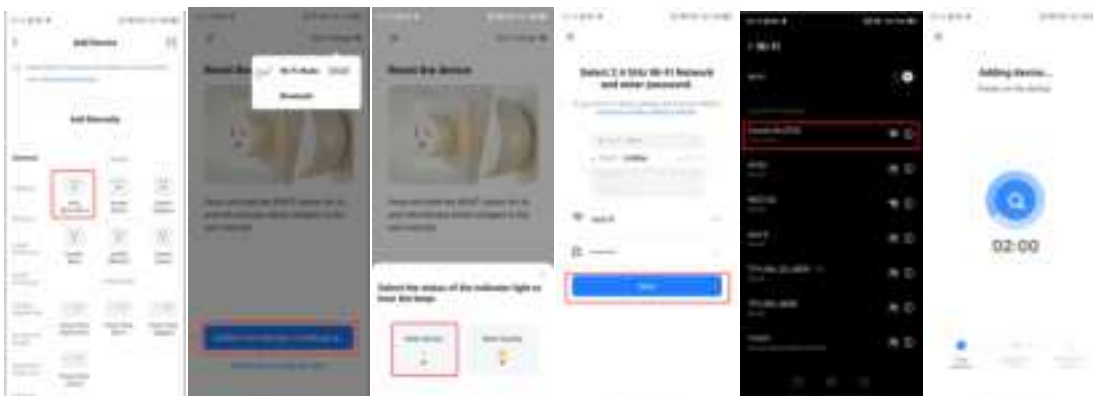

Main functions, working status and record Settings

I. Main Interface of the APP

order

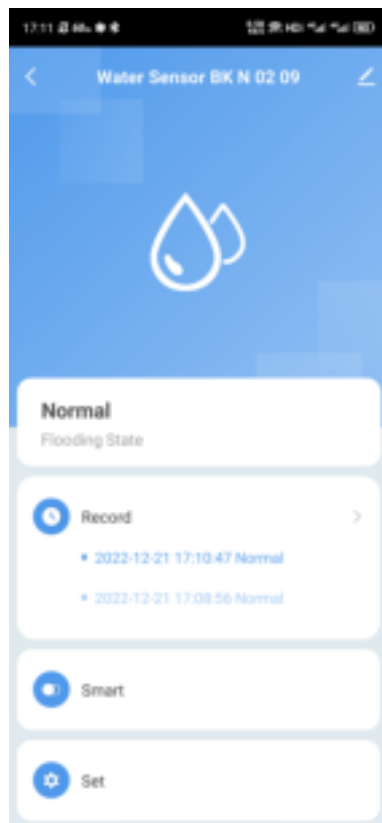

Alarm status

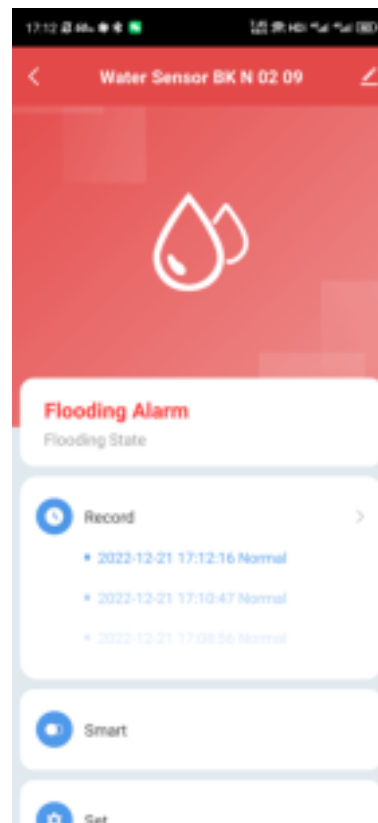

Ii. Equipment Functions

1. Historical records

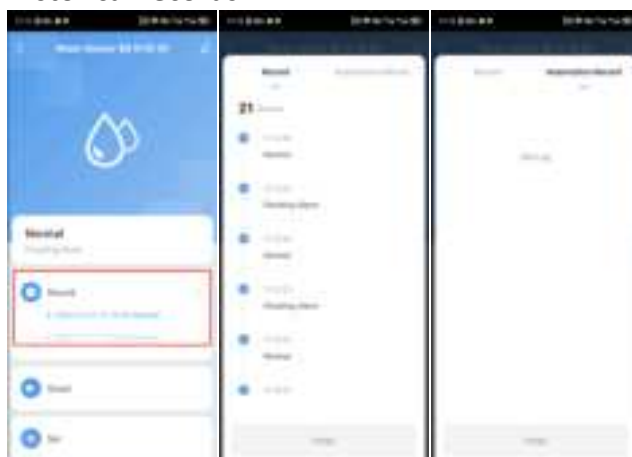

2.

1. Settings

2. battery status



(1) When the alarm is turned off, no alarm push will be received after it is turned off, and it will not affect the alarm of the device itself



other functions

- (1) 1. Shared devices
- (2) Single-device sharing

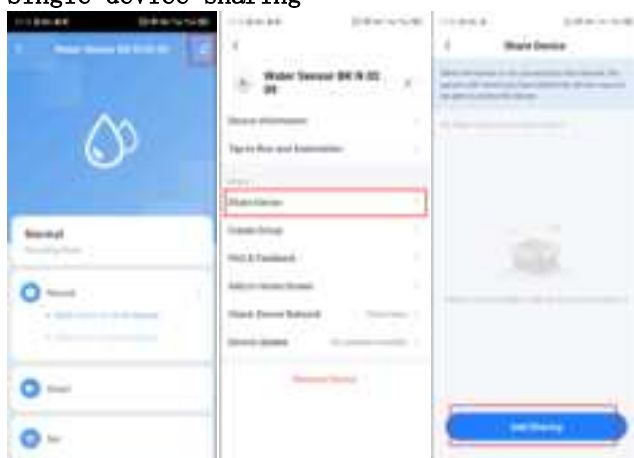

- (3) Shared by family groups

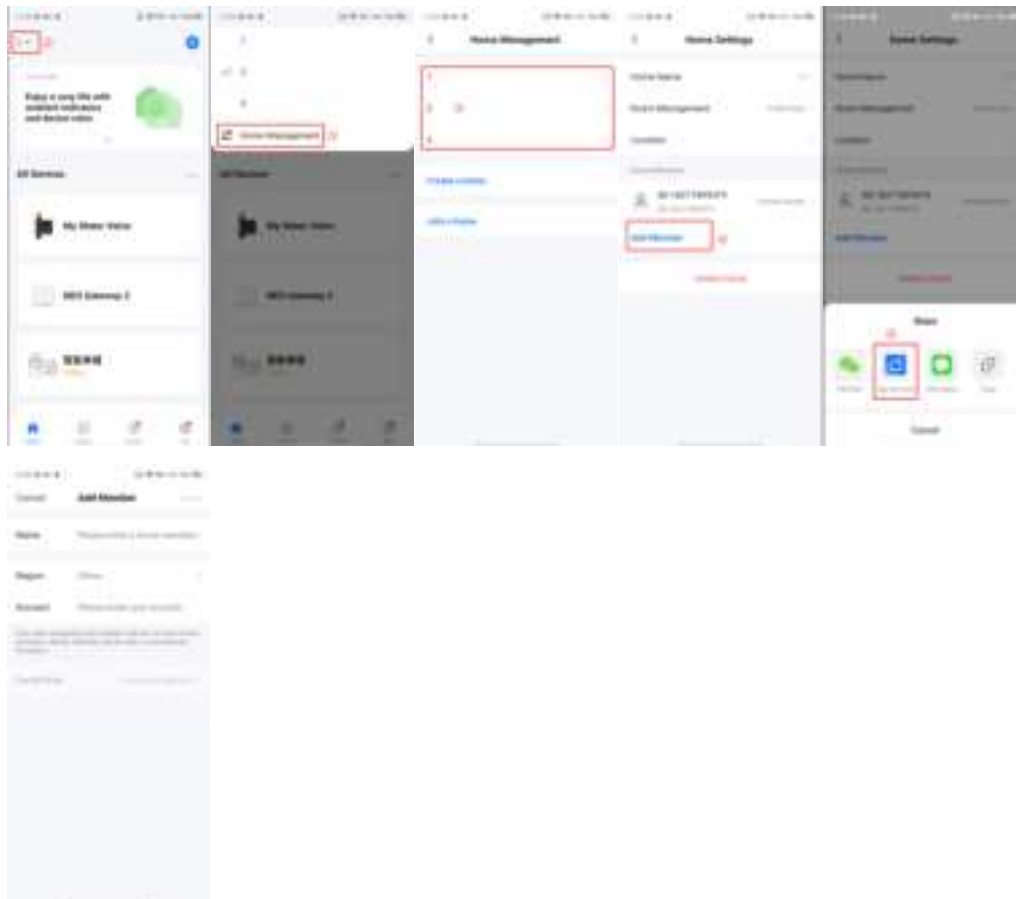

2. Product linkage



3. Push Management

All push notifications of the APP; Turn off the push here. All devices in the APP will not receive the push, but it will not affect the message record.

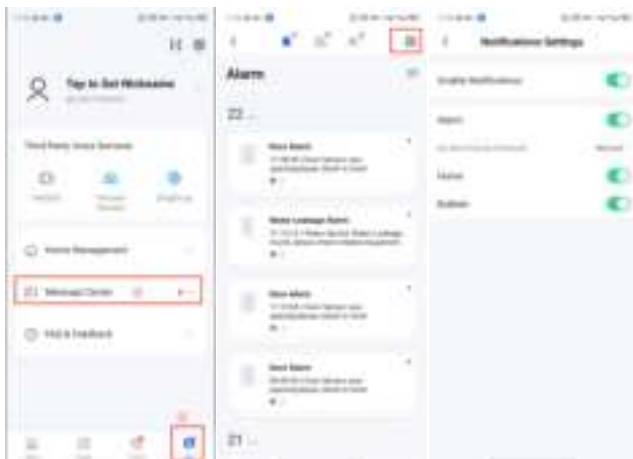

4. Restore the default

Deleting a device through the APP and adding it again will clear the data and restore the default value

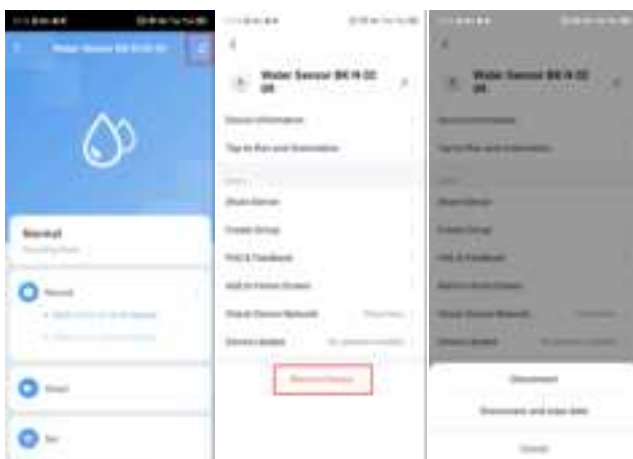

FCC Statement

This device complies with Part 15 of the FCC rules. Operation is subject to the following two conditions: 1) this device may not cause harmful interference, and 2) this device must accept any interference received, including interference that may cause undesired operation.

Note: This equipment has been tested and found to comply with the limits for a Class B digital device, pursuant to part 15 of the FCC Rules. These limits are designed to provide reasonable protection against harmful interference in a residential installation. This equipment generates uses and can radiate radio frequency energy and, if not installed and used in accordance with the instructions, may cause harmful interference to radio communications. However, there is no guarantee that interference will not occur in particular installation. If this equipment does cause harmful interference to radio or television reception, which can be determined by turning the equipment off and on, the user is encouraged to try to correct the interference by one or more of the following measures:

- Reorient or relocate the receiving antenna.
- Increase the separation between the equipment and receiver.
- Connect the equipment into an outlet on a circuit different from that to which the receiver is connected.
- Consult the dealer or an experienced radio/TV technician for help.

Changes or modifications not expressly approved by the party responsible for compliance could void the user's authority to operate the equipment.

FCC Radiation Exposure Statement

This device complies with FCC RF radiation exposure limits set forth for an uncontrolled environment. This transmitter must not be co-located or operating in conjunction with any other antenna or transmitter.

This device must operate with a minimum distance of 20 cm between the radiator and user body.



Make Your Home Smarter