

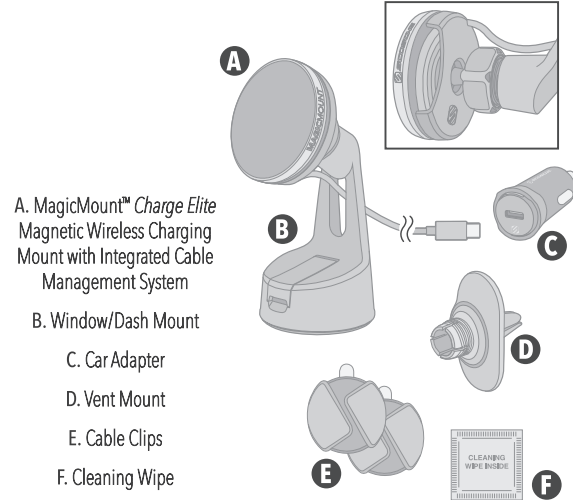

## INCLUDED ELEMENTS



## DEVICE SETUP

SECTION **A** - iPhone® Setup

SECTION **B** - Window/Dash Mount

SECTION **C** - Vent Mount

SECTION **D** - Integrated Cable Management System

SECTION **E** - Connection & Charging

SECTION **F** - Charging Head Adjustment

## SECTION A

**A. With Case**  
 For iPhone 12 and later, cases must include embedded magnets that are designed to work with MagSafe™ accessories for secure attachment.

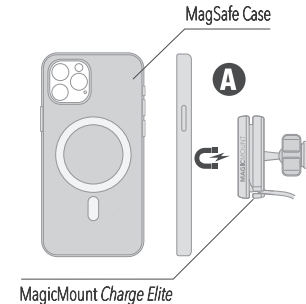

**B. Without Case**  
 iPhone 12 and later without a case can be directly attached to the MagicMount Charge Elite.

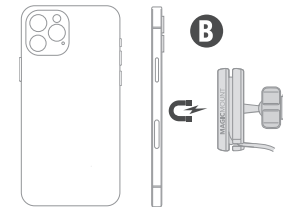

## SECTION B

Window/Dash Mount

1. Clean the mounting surface using supplied wipe\*.
2. Remove protective film from the StickGrip™ suction cup base\*\*.
3. With the lever in the UP position, place the mount on surface\*\* and press the lever down to lock in place.

\*Supplied cleaning wipe may cause discoloration of certain plastics, vinyls and painted surfaces. It is recommended to test in an inconspicuous area first. After wiping surface, allow surface to dry before mounting.

\*\*Note: StickGrip™ suction cup may leave residue or discoloration on some surfaces. It may also leave a ring of residue when mounted to the dash.

4. To renew and reuse StickGrip mounting base, rinse under warm water and allow to air dry.

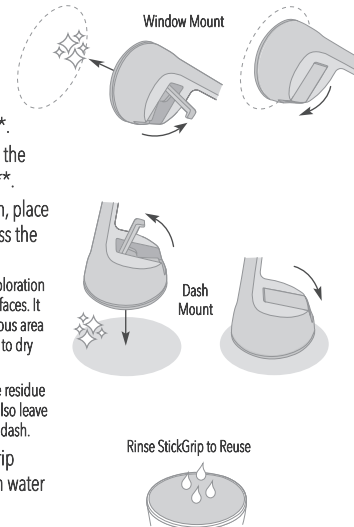

## SECTION C

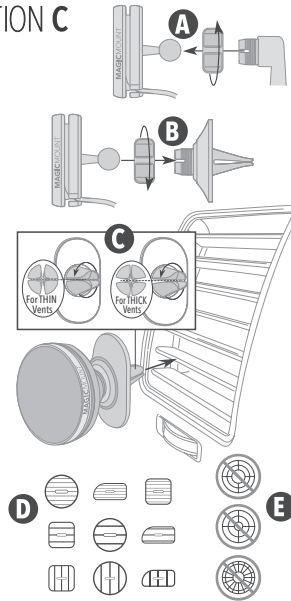

### Vent Mount

1. Remove the charge head from the window/dash mount (A) and reassemble with the vent mount (B).
2. Rotate vent clips on vent mount to align with vent louvers (C).  
Note: Works with many vent designs (D). Not compatible with curved or circular vents (E).

## SECTION D

### Integrated Cable Management System

1. Release the cable from the output slot (A).
2. Manually unwind the cable from the internal storage reel (B), or wind the cable onto the storage reel (C) to adjust the length of exposed cable.  
Minimum Length: 1 ft  
Maximum Length: 4 ft.
3. At the desired length, replace the cable in the output slot (D).

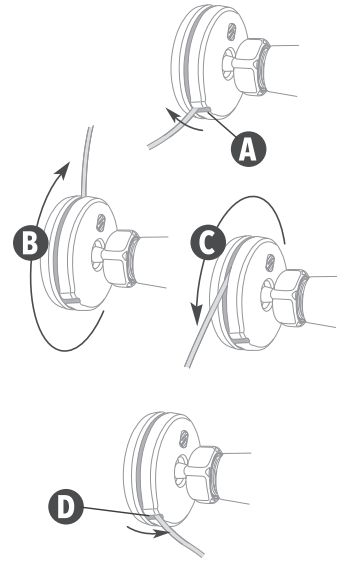

## SECTION E

Plug included car adapter into vehicle's 12V socket, and route wireless charger's USB-C power cable to car adapter.

Qi2 Wireless Charging Head\*  
Input (USB-C PD): 5V=== 3A / 9V=== 2.22A  
Output: 15W/10W/7.5W/5W

\*Actual charge rates may vary depending on device software and environmental conditions.

Car Adapter  
Input: 12-24V=== 3.5A  
Output: 5V=== 3A / 9V=== 2.22A

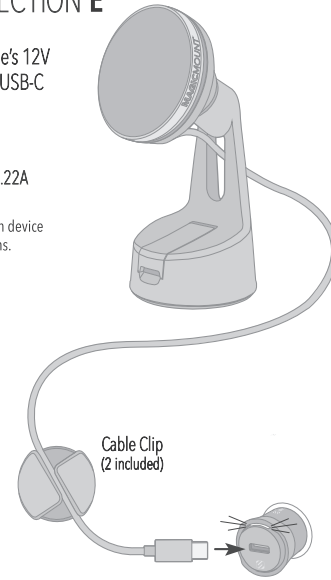

## SECTION F

Loosen ball-joint collar (A) to adjust charging head angle (B) or rotate device 360° (C).

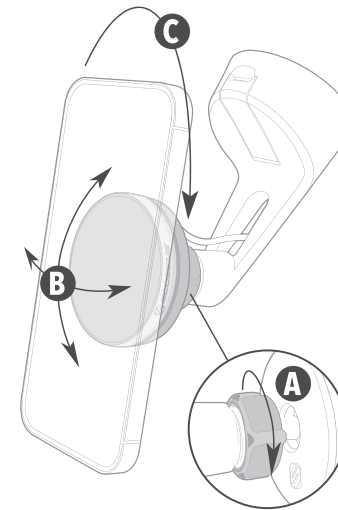

MagicMount Charge Elite How-To Video...



**SCOSCHE**

Scosche Industries  
1550 Pacific Avenue  
Oxnard, California 93033  
Phone: 800-363-4490 x1 / 805-486-4450 x1  
[www.scosche.com](http://www.scosche.com)  
©2024 Scosche Industries

Scosche, MagicMount & StickGrip are all trademarks of Scosche Industries.  
Other marks or brands are the property of their respective owners.  
Devices and or appearance may vary.

Designed in Oxnard, California

SI MEQMRWDV 5/24