

LANYARD HOLE

SCALE 1.000

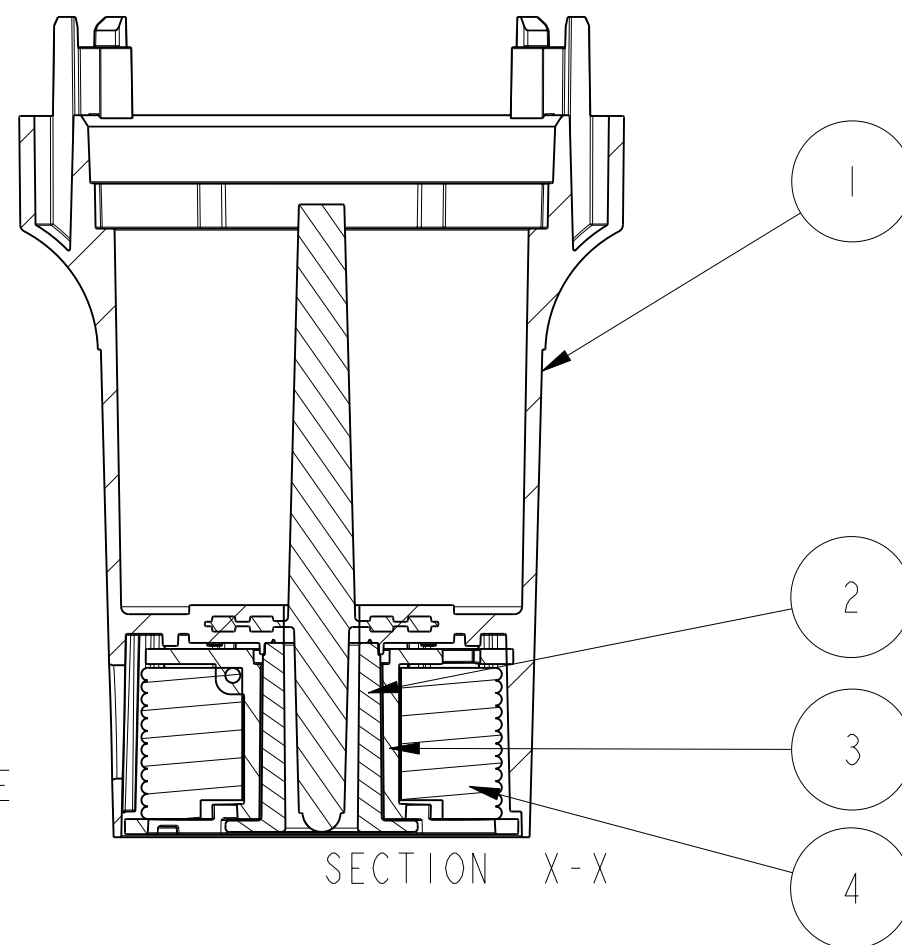

SECTION X-X

NOTES;

1. LANYARD (ITEM 4) TO BE 10M MIN. WOUND ON TO LANYARD REEL (ITEM 3) USING A WINDING JIG. NOTE DIRECTION OF WINDING, AS SHOWN BY ARROW MOULDED INTO UNDERSIDE OF LANYARD REEL.
2. PLACE WOUND LANYARD REEL INTO BATTERY CASE. FEED APPROXIMATELY 100MM OF LANYARD THROUGH THE LANYARD HOLE (SEE NOTE ON DRAWING), AND TIE A KNOT IN THE LANYARD APPROXIMATELY 30MM FROM THE END. WIND THE EXCESS LANYARD BACK IN UNTIL THE KNOT PREVENTS IT FROM BEING WOUND ANY FURTHER.
3. INSERT REEL BRACE (ITEM 2) INTO THE CENTRE OF THE LANYARD REEL (ITEM3) AS SHOWN ON THE SECTION VIEW. REEL BRACE IS ULTRASONICALLY WELDED IN PLACE, SECURING THE LANYARD REEL.

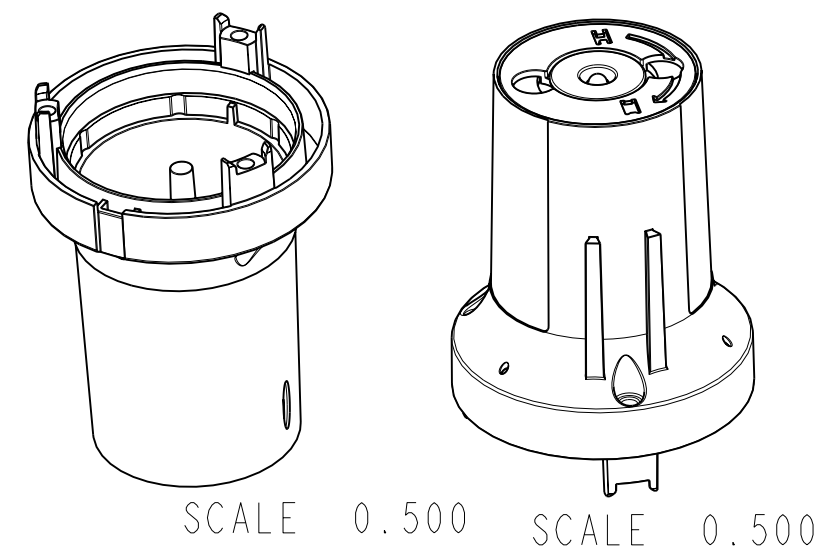

ITEM No.	QTY.	PART No.	DESCRIPTION
1	1	86-434	BATTERY CASE
2	1	86-431	REEL BRACE
3	1	86-432	LANYARD REEL
4	10m*	81-8081	LANYARD

* LANYARD (ITEM 4) TO BE 10m MINIMUM.

				2	C2690	28/10/2003	BQS
				1	C2662	30/09/2003	BQS
ISSUE	CHG.No.	DATE	APPD	ISSUE	CHG.No.	DATE	APPD

USED ON

TOLERANCES UNLESS OTHERWISE STATED
WHOLE No. ± 0.5 ANGULAR DIMS \pm
1 DEC PLACE ± 0.1
2 DEC PLACE ± 0.05 DRILLED HOLES \pm

THIS DOCUMENT IS MCMURDO LIMITED COPYRIGHT AND CONTAINS PROPRIETARY OWNED INTELLECTUAL PROPERTY RIGHTS AND CONFIDENTIAL DATA. ALL RIGHTS ARE STRICTLY RESERVED. THE INFORMATION MUST NOT BE USED EXCEPT FOR THE AGREED PURPOSE. UNAUTHORIZED USE, REPRODUCTION, OR ISSUE TO ANY THIRD PARTY IS NOT PERMITTED WITHOUT THE PRIOR WRITTEN AUTHORITY OF MCMURDO LIMITED. THIS DOCUMENT IS TO BE RETURNED TO MCMURDO LIMITED WHEN THE AGREED PURPOSE IS FULFILLED.

THIS DOCUMENT IS UNCONTROLLED, UNLESS OTHERWISE STATED

MATERIAL :-

FINISH :-

DIMENSIONS IN :- mm

3RD ANGLE PROJECTION
B.S.8888

DRAWN BY:
NJB

RELEASED
JU

APPROVED
BQS

SCALE
1.000

TITLE:
BATTERY CASE WITH LANYARD ASSY

MCMURDO LIMITED

PORTSMOUTH - HAMPSHIRE - ENGLAND

DRAWING NO.

86-439A

SHT. 1
OF
SHT. 1

A3