

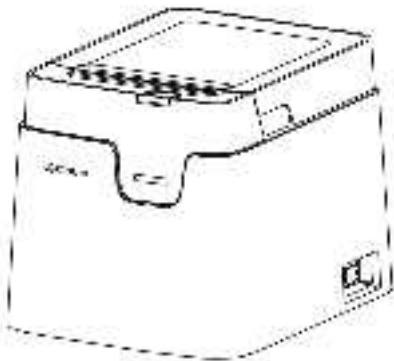

CTD210

# Lable Printer Quick Installation Guide





# UNPACKING CHECKLIST

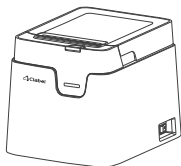

Printer

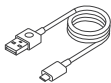

Data cable



Installation Guide

# 2 COMPONENTS

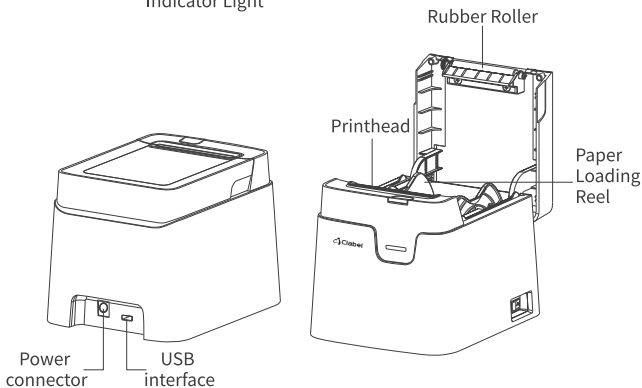
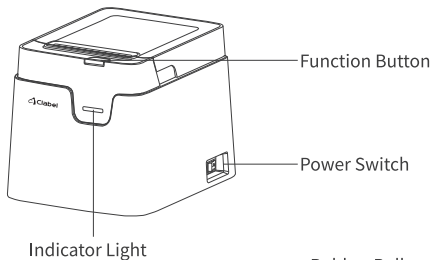

# 3 INSTALLATION GUIDELINES

1. Make sure the printer is powered on and toggle the power switch to "I"

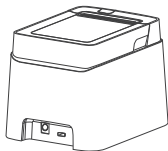

2. Pull up the finger positions on both sides of the machine to open the paper compartment cover

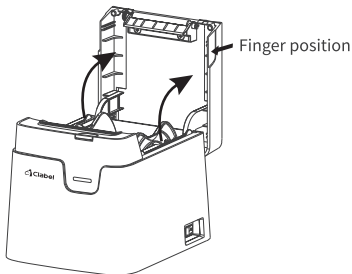

### 3. Remove the label spindle and stopper, and put the paper roll into the label spindle

- Remove the label spool and stopper from the paper compartment

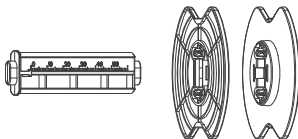

When loading 1.5" (40mm) paper cores, turn the tabs of the baffle inward and make sure that both tabs are inserted into the paper core, as shown below

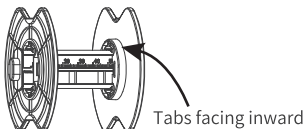

When loading 1" (25mm) paper cores, the tabs of the baffle will face outward, as shown below

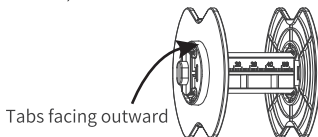

- Step-by-step demonstration of paper roll loading

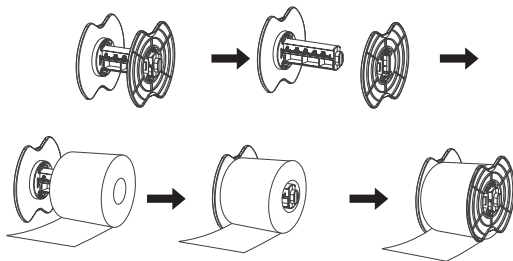

Remove the label shaft stopper, move the left side stopper to the leftmost side first, then set the paper roll into the label shaft against the leftmost side. Finally, put on the right side baffle and tighten it properly. Load the paper roll as shown in the figure below.

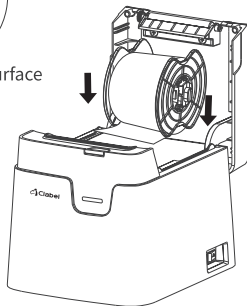

Load the paper roll  
set from top to bottom  
Load into the printer

# KEY FUNCTION

## 1. Label mode (gap paper)

Button	Function	Operation method
Power Switch	Start Up	Toggle to "I"
	Shutdown	Toggle to "O"
Function Button	Paper output	Click the "Function button" once
	Pause printing	In the print state, click the "Function button" once
	Continue printing	In the pause state, click the "function button" once
	Print self-test page	When ready, double-click on the "Function button"
	Switching working mode	Press and hold the function button in the off state, then toggle the power switch to "I"

## 2. Label mode (continuous paper) and ticket mode (continuous paper)

Button	Function	Operation method
Power Switch	Start Up	Toggle to "I"
	Shutdown	Toggle to "O"
Function Button	The paper 10 mm	In the ready state, click the "Function button" once
	Continued Paper	In the ready state, press and hold the Function button
	Print self-test page	In the ready state, double-click the Function button.
	Switching working mode	Press and hold the function key in the shutdown state, and then flip the power switch to "I".



# INDICATOR LIGHT DESCRIPTION

## The standard version

Indicator light	state	State that
Blue light	Slow flashing	Has been turned on
Red light	Slow flashing	Pause to print
Red light	Normally on	Paper bin is short of paper. Top cover is open
Blue light + Red light	flashing	The printing head is under overtemperature protection

## Bluetooth version

Indicator light	state	State that
Blue light	Slow flashing	Bluetooth is not connected
Blue light	Normally on	Bluetooth connected
Red light	Slow flashing	Pause to print
Red light	Normally on	Paper bin is short of paper. Top cover is open
Blue light + Red light	flashing	The printing head is under overtemperature protection



# SOFTWARE DOWNLOAD

iOS / Android

Scan the QR code below with a mobile phone to download “Clabel trade”.

Please operate the software following the software guidance.



Clabel trade



Download label editing app "Clabel trade" from Google Play Store or Apple APP Store and install it.

Windows

Visit <https://ga.ctaiot.com/pc>

Download “Clabel trade” and driver.

---

Please check the software usage in the software help center

# PRECAUTIONS

## Usage precautions

- (1) Install the printer on a stable surface. Do not place the printer in areas exposed to vibration or impact.
- (2) Do not use or store the printer in areas exposed to high temperatures, high humidity, or excessive dust.
- (3) No water or conductive substance (i.e., metal) is allowed into the printer. In case of such condition, turn off the power immediately.
- (4) Do not allow the printer to start printing when there is no recording paper installed, otherwise the printhead and rubber roller will be damaged.
- (5) Users shall not disassemble the printer for maintenance or modification.
- (6) Use only the power adapter certified in accordance with national standards
- (7) To ensure print quality and normal lifetime, use recommended or good quality paper.
- (8) Shut down the printer when connecting or disconnecting interface connectors.
- (9) This product is intended to be used at altitudes not exceeding 5,000 m in tropical climates.

## Printer cleaning

**The printhead should be cleaned promptly if:**

- (1) The Print is not clear;
- (2) The Vertical column of print is not clear;
- (3) A Grinding noise is heard while feeding the paper;

### **Cleaning Steps:**

- (1) Switch the printer power off, open the cover and remove any paper;
- (2) Allow the printhead to cool if you had just finished printing;
- (3) Using a soft cotton cloth dipped in absolute ethyl alcohol, gently wipe the dust and particles off the thermal printhead surface;
- (4) Only use the printer for printing until the cleaning alcohol evaporates completely and the cover is closed;

### **Note**

- (1) Make sure to turn off the printer before any maintenance.
- (2) Do not touch the printhead surface with the fingers or metallic objects. Do not abrade the printhead, rubber roller, and sensor surface with tweezers or other tools. Abrasion could damage the printhead.
- (3) Do not use gasoline, acetone, or any other organic solvents for cleaning.
- (4) Only use the printer for printing until the cleaning alcohol evaporates completely.

## FCC Warning

This device complies with Part 15 of the FCC Rules. Operation is subject to the following two conditions:

(1) This device may not cause harmful interference, and (2) this device must accept any interference received, including interference that may cause undesired operation.

**NOTE 1:** This equipment has been tested and found to comply with the limits for a Class B digital device, pursuant to part 15 of the FCC Rules. These limits are designed to provide reasonable protection against harmful interference in a residential installation. This equipment generates, uses and can radiate radio frequency energy and, if not installed and used in accordance with the instructions, may cause harmful interference to radio communications. However, there is no guarantee that interference will not occur in a particular installation. If this equipment does cause harmful interference to radio or television reception, which can be determined by turning the equipment off and on, the user is encouraged to try to correct the interference by one or more of the following measures:

- Repoint or relocate the receiving antenna.
- Increase the separation between the equipment and receiver.
- Connect the equipment into an outlet on a circuit different from that to which the receiver is connected.
- Consult the dealer or an experienced radio/TV technician for help.

**NOTE 2:** Any changes or modifications to this unit not expressly approved by the party responsible for compliance could void the user's authority to operate the equipment.

The device has been evaluated to meet general RF exposure requirements.

The device can be used in portable exposure condition without restriction.