

## 11: Wi-Fi Connection Setup Using a Windows PC or Mac

Page 14

### For PC or Mac users:

If you cannot connect using the DTS Play-Fi APP, or you need to do some high-level option such as setting the static IP configuration, you can setup the Audiolab 6000A Play using a web browser from your Windows PC or a Mac.

Set the 6000A Play to Standard Setup mode, then follow these steps:

- (1) Connect your computer to the wireless Wi-Fi of the 6000A Play - it will show as 'PlayFiDeviceXXXXX' or similar name. After connecting your computer may show 'No Internet Connection' - this is normal.
- (2) Open your Internet Browser and type: 192.168.0.1/index.html in the address bar.
- (3) Click the Enter key or click 'Continue' option in your Internet Browser.
- (4) This will open the Play-Fi configuration.
- (5) Select the 'Set Up' button.

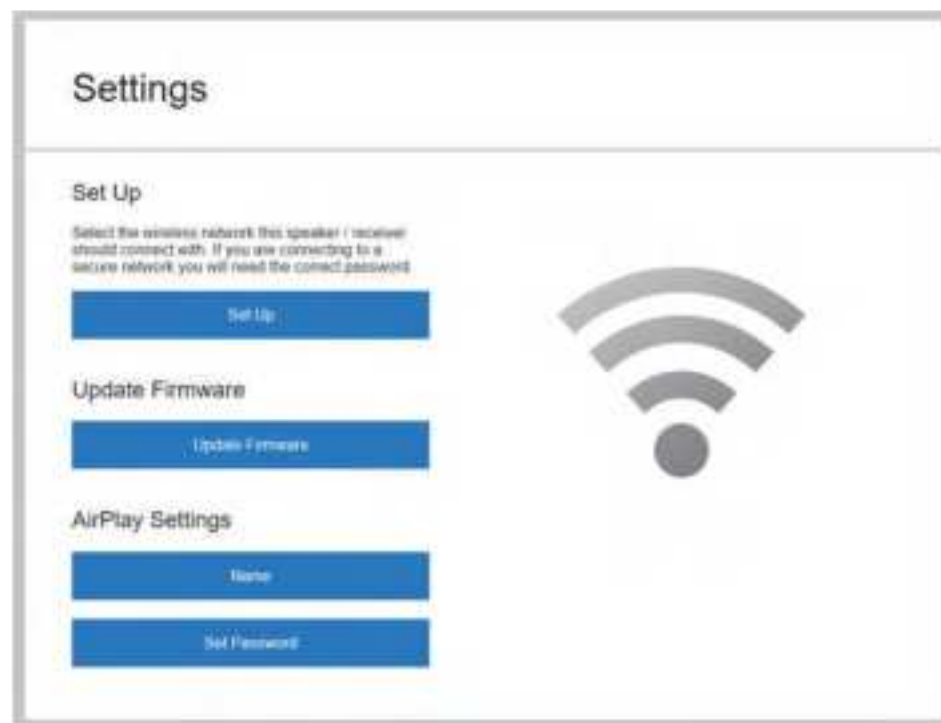

- (6) Select your wireless router Wi-Fi network.



- (7) Enter the password for your wireless network. Then click the 'NEXT' button.



- (8) You can then name your 6000A Play Device and click 'NEXT'. The Wi-Fi connection will be made and you can use the device.

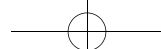

## 12.APP Operations - 1

Page 15

### Device Selection

The DTS Play-Fi APP allows you to control and direct streaming music to a variety of Devices throughout your home that use the DTS Play-Fi system. You can set each Device to have a unique name. You can also group Devices into an Area, where each Device will play the same music.

To select a Device and Area using the APP, click the '+' icon on the upper right corner of the APP display. Select an Area to add, then select a Device on which to play the music. If you wish to play high-resolution audio files, the icon 'Hi-Res AUDIO' should be selected.

### Music Services

DTS Play-Fi supports the world's most popular and exciting streaming music services, so you can enjoy your favorites at home just as easily as you do in the gym. See below for more information of streaming music service platforms. Please feel free to choose one you like. (Note: some streaming music service platforms probably need to be registered.)

#### Amazon Music

Amazon Prime members can use Amazon's popular music service for free. A growing selection of over 2 million songs is always ad-free and on-demand, with curated playlists, personalized stations and unlimited skips. Upgrade to Prime Music Unlimited, and enjoy 10 million songs, weekly new releases, and more.



#### Deezer

With 43 million tracks, 100 million playlists, and a presence in 182 countries, Deezer literally covers the globe for its subscribers. Subscriptions start at \$9.99/month, and include ad-free playback, premium audio quality, and more.



#### iHeartRadio

iHeartRadio combines access to over 1,500 of the most popular live terrestrial and internet radio stations with unique live events and compelling custom features, like artist radio, personalized radio, and on-demand podcasts for FREE. Their new Plus and All-Access subscriptions allow you to pause, rewind, skip and save live radio content, stream on-demand music, and more.



### Internet Radio

DTS Play-Fi has a built-in Internet Radio service that gives you access to thousands of radio stations and podcasts from around the globe. Instantly see your local favorites, or tune into the BBC, ESPN, Radio Disney, the Wall Street Journal, and more. Browsing is a snap, and if you find a station you love, just give it a star and it'll be ready to stream whenever you are. Free, no subscription required.



### Juke

With more than 20 million tracks and a dedicated base of music fans, Juke's streaming service includes popular features like on-the-go playlists, new music discovery, and ad-free listening. DTS Play-Fi is the only multi-room audio platform to offer the Juke service.



### KKBox

KKBox is Asia's leading streaming music service, with over 30 million tracks from 500 local and major labels, and the most comprehensive collection of Asia-Pop in the world. Featuring both free and premium options, the service also includes mood-based programming and supplemental content including music news, videos, concert updates and more.



### On Device Music

DTS Play-Fi puts your mobile music collection at your fingertips, automatically finding and indexing the songs stored on your device. You can browse and stream by album, artist or genre, and even use your existing playlists. DTS Play-Fi supports local files in multiple formats, from MP3 all the way up to premium CD and lossless quality encoding. Free, with no subscription required.



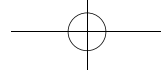

## 13.APP Operations - 2

Page 16

### Media Server

Got a hard drive full of music? Avid digital collectors can access and stream from media servers using DTS Play-Fi. The system automatically discovers and indexes music from DLNA and UPnP servers on your network. You can select and stream files in multiple formats via DTS Play-Fi, including premium tracks encoded at CD quality or even 24-bit/192kHz lossless content. No subscription required.



### Napster

Napster integrates the heritage of streaming market pioneer Rhapsody into its premium, ad-free on-demand service. With 30 million tracks, instant playlist creation, and anytime, anywhere access, Napster is justifiably popular on multiple continents with millions of subscribers.



### Pandora

Listen free to music you'll love, as Pandora's streaming service evolves with your tastes. Give songs a thumbs up or down, and your stations become more personal the more you listen. Enjoy the service at no charge with ads, upgrade to Pandora Plus for commercial-free streaming, or try Pandora Premium to add on-demand features and premium sound quality to your experience.



### Qobuz

Based in France, Qobuz was founded and built around a premium audio quality experience. It boasts 70,000 albums available for streaming at 24/192, with many more streaming at 16/44 CD quality. The service also features in-depth artist profiles and editorial content.

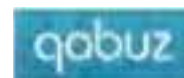

### QQMusic

China's largest music streaming service offers tens of millions of tracks and thousands of radio stations to its 400 million monthly active users. With free and premium tiers, and both local and international content, QQ Music is a dominant force in music listening in China.



### SiriusXM

With over 150 channels of commercial-free music plus sports, talk, comedy, entertainment, news and more, it's no wonder that Sirius XM is one of the most widely used premium streaming services in North America. It's a snap to go from listening in your car to listening at home with DTS Play-Fi.



### SoundMachine

Business never sounded so good! Whether it's in an office or a restaurant, a retailer or a hotel, background music enhances both the customer and the employee experience. Hundreds of stations and millions of songs, including the ability to create artist stations, so you can design the perfect sound for your brand. Fully licensed for business environments.



### Spotify

Their motto is "Music for Everyone", and with millions of listeners around the globe, Spotify seems to be onto something. Create and share playlists, or choose from thousands of curated collections. Spotify Premium subscribers can stream directly to any DTS Play-Fi enabled speaker directly from the Spotify App. Available in the US and more than 50 other countries. The Spotify Software is subject to third party licenses found here:

[www.spotify.com/connect/third-party-licenses](http://www.spotify.com/connect/third-party-licenses).

Use your phone, tablet or computer as a remote control for Spotify. Go to [spotify.com/connect](http://spotify.com/connect) to learn how



### Tidal

High Fidelity Music Streaming is Tidal's hallmark. Every track on the service streams in premium audio format, with most in lossless CD quality or above. The service also boasts many exclusive new releases, artist-curated stations and in-depth features designed to complement the music offerings. Available to DTS Play-Fi users in the US and more than 50 other countries.



**In addition to the support listed above, it also supports music services such as BBC, ESPN RADIO, HD tracks, NPR, tunein and so on, and there will be more music platforms involved in the development.**

**DISCLAIMER: Not all music services are available in all regions and countries.**

### Line In Mode

The 6000A Play supports wireless broadcasting of any of your music source inputs to other DTS Play-Fi audio solutions on your network. For instance, you can stream the turntable input from your 6000A Play to other DTS Play-Fi wireless speakers or streamers via the app. Perfect for a multi-room home audio solution.

To activate this mode simply click the icon “+” on the top right corner of DTS Play-Fi App, select “Line In”, then select the source unit, source channel and music genre. Finally select the secondary audio output device to which you wish to broadcast and click “Start Line In Broadcast” to play.

Note: there should be at least 2 or more than 2 units of DTS Play-Fi system supporting to use this function. The Broadcast mode can support all the input channels except the Bluetooth functionality.

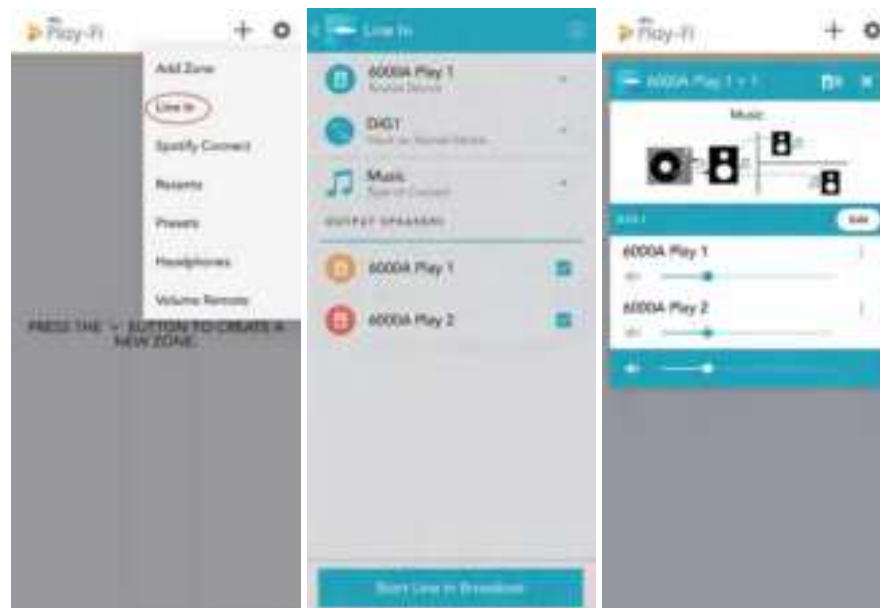

### Speakers Group

To stream music from 6000A Play to multi-room Devices such as DTS Play-Fi Speakers, open the DTS Play-Fi APP, find the Device or Speaker, give it a name and then add it.

To delete the Device or Speaker, just click on the right side of the Device name and then delete.

Currently it is not recommended to wirelessly stream Hi-Res audio to speakers if you want stable, uninterrupted playback.

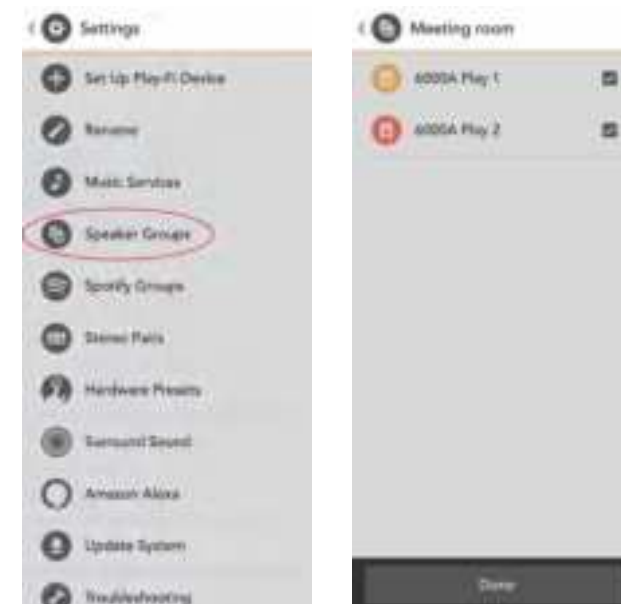

### Spotify Group Setup

Open the Set Up of the DTS Play-Fi app and click the Spotify Group. Create a new group and name for it, then select any Play-Fi products you want to add into this group (on the right side). Any speakers that can't be added to the Spotify Group will show in grey. Any speakers that can't be joined to a Spotify Group will be greyed out. Once you're satisfied, head to the Spotify app to start streaming.

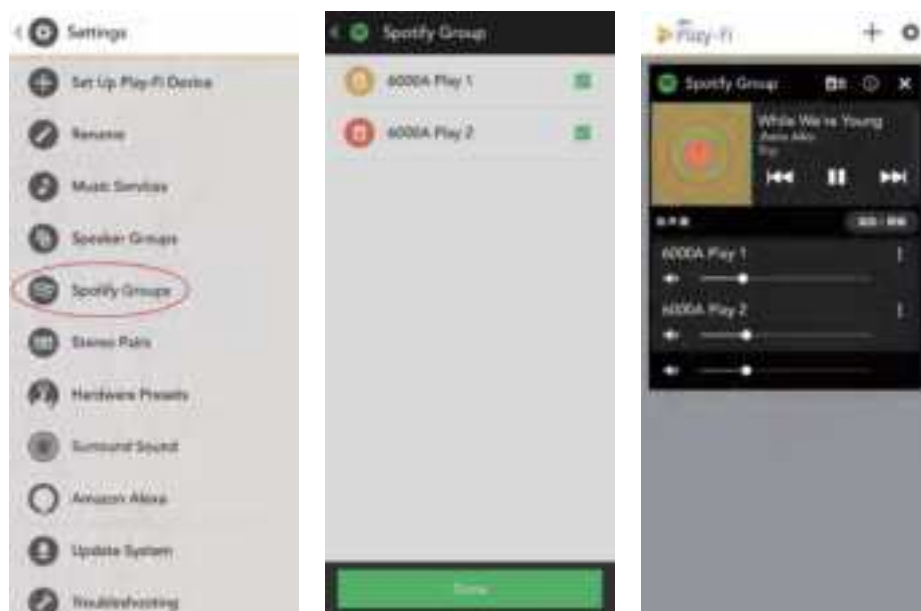

### Surround Sound

So far, 6000A Play cannot support Play-Fi Surround. For common problems in utilization and fault diagnosis, you can open the APP settings to find the "Fault diagnosis", then enter the DTS Play-Fi website knowledge base which has the detailed information.

### Update System

If there is an update available, click "Update System" and the process will carry on automatically. Click "About", you can see the DTS Play-Fi's APP version and the status of network connection, IP address and versions of the module software and MCU. For 'Advanced Settings' you can choose from various options - the default mode is recommended.

### DTS Play-Fi Windows Application

With your PC running Windows 7, 8, 8.1 or 10, the DTS Play-Fi Windows app allows you to stream from any source on your PC (apps, services or Web based) including Spotify, Google Play, iTunes, Xbox Live and more.

**Music mode:** the free version of the Windows app defaults to Music mode, then select the 6000A Play to play.

**Video mode:** allows you to sync the audio from any video, whether from a movie file or YouTube, to any one Play-Fi device on your network.

To use Video mode upgrade your app to the Play-Fi HD version. Click the option 'Video mode' then select the device to play.

Play-Fi HD is the only Wi-Fi streaming solution to include advanced codecs and proprietary QoS (Quality of Service) technology. That means audio is delivered with astonishing accuracy, even in the busiest network conditions.

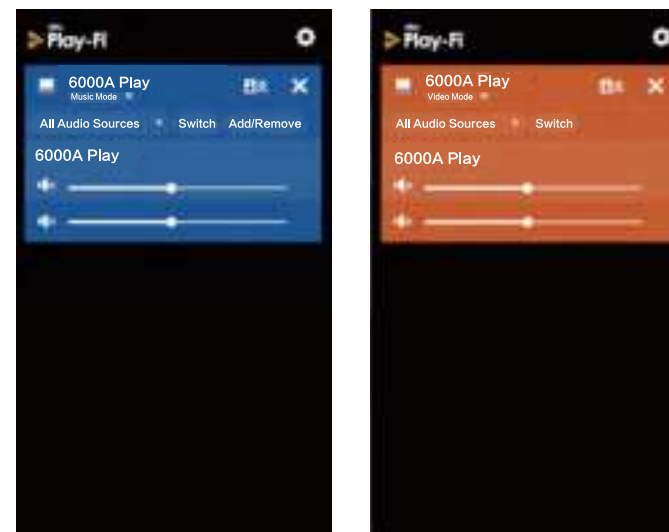



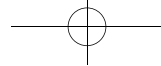

# 16. Warranty

Page 19

Audiolab Ltd. warrants this product, subject to the terms and conditions below, to be free from defects in materials and workmanship. During the warranty period Audiolab will repair or replace (at Audiolab's option) this product, or any defective part in this product, if it is found to be defective due to faulty materials, workmanship or function. The warranty period may vary from country to country.

## Terms and conditions

The warranty starts on the date of purchase (or the date of delivery if this is later).

You must provide proof of purchase/delivery before work can be carried out. Without this proof, any work carried out will be chargeable to you.

All work will be carried out by Audiolab or its authorized agents or distributors.

Any unauthorized repair or modification will void this warranty.

If any part is no longer available it will be replaced with a functional replacement part.

Any parts that are replaced will become the property of Audiolab.

Any repair or replacement under this warranty will not extend the period of warranty.

This warranty is valid only in the country of purchase, applies only to the first purchaser and is not transferable.

## The following are not covered:

1. Products which the serial number have been removed, altered or otherwise made illegible.
2. Normal wear tear and cosmetic damage.
3. Transportation or installation of the product.

Accidental damage, fault caused by commercial use, acts of God, incorrect installation, connection or packing, misuse, neglect or careless operation or handling of the product which is not in accordance with Audiolab's user instructions.

1. Repairs or alterations carried out by parties other than Audiolab or its authorized agents or distributors.
2. Products not purchased from an Audiolab authorized dealer.
3. Products that were not new at the time of original purchase.
4. Products sold 'as is', 'as seen' or 'with all faults'.

Repairs or replacements as provided under this warranty are the exclusive remedy of the consumer. Audiolab shall not be liable for any incidental or consequential damages for breach of any express or implied warranty in this product. Except to the extent prohibited by

law, this warranty is exclusive and in lieu of all other warranties whatsoever, both express and implied, including, but not limit to, the warranty of merchantability and fitness for a practical purpose.

This warranty provides benefits that are additional to and do not affect your statutory rights as a consumer.

Some countries and U.S. states do not allow the exclusion or limitation of incidental or consequential damages or implied warranties so the exclusions in the paragraph above may not apply to you. This warranty gives you specific legal rights, and you may have other statutory rights, which vary from state to state or county to county.

## How to claim:

To obtain warranty service contact the Audiolab authorized dealer from which you purchased this product. Do not dispatch goods without the prior agreement of the dealer, Audiolab or their authorized distributors.

We may refer to a local service centre. For international regions, please contact:

IAG House, 13/14 Glebe Road, Huntingdon, Cambridgeshire, PE29 7DL, UK.

Tel: +44 (0) 1480 452561 Eml: [service@audiolab.co.uk](mailto:service@audiolab.co.uk)

If asked to return products for inspection and/or repair, pack carefully, preferably in the original cartons or packing affording an equal degree of protection, and return prepaid. If unsuitable packaging is used, Audiolab may make a charge for the supply of new packaging.

Insurance is recommended and goods are returned at owner's risk. Audiolab or their authorized distributors cannot be held liable for loss or damage in transit.

# 17. Specifications

Page 20

<b>Model</b>	<b>6000A Play</b>
	IEEE 802.11a/b/g/n/ac
	Supports global, popular streaming content (Amazon Music, Spotify, TIDAL, KKBox, SiriusXM, Napster, Internet Radio, Deezer, iHeartRadio, Pandora, SoundMachine, Qobuz, QQmusic )
DTS Play-Fi® Technology	Supports Speaker Groups
	Supports Android/iOS/Kindle Fire/Windows PC Control
Analogue inputs	3 x AUX , 1x Phono (MM), 1x Power In
Digital Input	2 x Coaxial, 2 x Toslink Optical, Bluetooth (aptX/aptX LL)
Analogue output	1x RCA Pre Out
<b>Pre-amplifier Section</b>	
Gain	+8dB (Line) +55dB (Phono MM)
Input Sensitivity	720mV (Line, Volume = 0dB) 3.1mV (Phono MM, Volume=0dB)
Input Impedance	10K (Line) 47K//100pF (Phono MM)
Total Harmonic Distortion (THD)	< 0.0004% (1KHz @ 2V, Volume = 0dB)
Frequency Response	20Hz-20kHz (+/-0.1dB)
Output Voltage	2.3V max. (Volume=0dB)
Output Impedance	120 ohm
Signal-to-Noise Ration (S/N)	> 110dB (Line, A-weighted) > 76dB (Phono MM, A-weighted)
<b>DAC</b>	
D to A converter	ES9018K2M
Total Harmonic Distortion (THD)	< 0.0006% (1KHz @ 0dBFS)
Output level (0dBFS, 1KHz)	2.05V
Max. Sampling Frequency	192KHz
Signal-to-noise ratio (S/N)	> 112dB (A-weighted)
Digital Filtes	Fast Roll-off , Slow Roll-off , Minimum Phase

## Power Amplifier Section

Gain	+29dB
Rated Max. Power Output	2 X 50W (8 ohm, THD<1%) 2 X 75W (4 ohm, THD<1%)
Frequency Response	20Hz-20kHz (+/-0.3dB)
Input Sensitivity	720mV (Volume=0dB)
Total Harmonic Distortion (THD)	< 0.003% (1kHz @ 40W/8ohm)
Signal-to-Noise ratio (S/N)	> 110dB (A-weighted)
Max. Output Current	9A

## Headphone Amplifier

Total Harmonic Distortion (THD)	< 0.01% (1kHz, 10mW into 20ohm)
Output Impedance	2.35 ohm
Load impedance	20-600 ohm

## General

Standby Power Consumption	< 0.5W
Power Requirements	220-240V ~ 50 - 60H z (depending on region) 100-120V ~ 50 - 60H z
Dimensions (mm) (W x H x D)	445 x 65.5 x 300
Carton Size (mm) (W x H x D)	512 x 467 x 155
Weight	7.9kg (Net ) 10kg (Gross)
Finish	Black/Silver

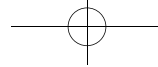

Correct disposal of this product. This marking indicates that this product should not be disposed with other household wastes throughout the EU. To prevent possible harm to the environment or human health from uncontrolled waste disposal, recycle it responsibly to promote the sustainable reuse of material resources. To return your used device, please use the return and collection systems or contact the retailer where the product was purchased. They can take this product for environmental safe recycling.



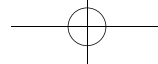

## FCC Statement

This equipment has been tested and found to comply with the limits for a Class B digital device, pursuant to part 15 of the FCC Rules. These limits are designed to provide reasonable protection against harmful interference in a residential installation. This equipment generates, uses and can radiate radio frequency energy and, if not installed and used in accordance with the instructions, may cause harmful interference to radio communications. However, there is no guarantee that interference will not occur in a particular installation. If this equipment does cause harmful interference to radio or television reception, which can be determined by turning the equipment off and on, the user is encouraged to try to correct the interference by one or more of the following measures:

- Reorient or relocate the receiving antenna.
- Increase the separation between the equipment and receiver.
- Connect the equipment into an outlet on a circuit different from that to which the receiver is connected.
- Consult the dealer or an experienced radio/TV technician for help.

Caution: Any changes or modifications to this device not explicitly approved by manufacturer could void your authority to operate this equipment.

This device complies with part 15 of the FCC Rules. Operation is subject to the following two conditions: (1) This device may not cause harmful interference, and (2) this device must accept any interference received, including interference that may cause undesired operation.

## RF Exposure Information

This equipment complies with FCC radiation exposure limits set forth for an uncontrolled environment. This equipment should be installed and operated with minimum distance 20cm between the radiator and your body.



Audiolab  
IAG House,  
13/14 Glebe Road,  
Huntingdon,  
Cambridgeshire,  
PE29 7DL,  
UK  
Tel: +44(0)1480 452561  
Email: [service@audiolab.co.uk](mailto:service@audiolab.co.uk)  
<http://www.audiolab.co.uk>