

Product Features

■ Portable mass USB storage device

You can upload/download files conveniently and quickly in the Windows Explorer without additional program.

■ 7-color backlight

You can select the color of the backlight you want.

■ Multi Codec player

Supports playback for MP3 and WMA files.

■ Multi language text support

The LCD displays file information written in 24 different languages including Korean, English, Chinese (Simplified/Traditional) and Japanese.

■ Firmware upgrade

You can upgrade the product firmware to maintain the best quality.

■ FM reception and recording

The automatic station scanning function and the preset function allows you to enjoy and record the FM broadcasting.

■ Automatic FM station scanning

The player can detect and save the available FM frequency automatically.

■ EQ

You can select one of the five equalizer modes - Rock, Jazz, Classic, Pop or User EQ.

■ User-defined equalizer (User EQ)

The player implements rich sound effects using minute adjustment in 5 bandwidths.

■ Convenient File Management

You can create and delete folders in your PC to manage files conveniently.

■ Easy to use Navigation function

You can search files easily with the tree structure navigation function in PC.

■ Low power consumption

Low power consumption enables you to use the product for a long time.

MP3
PLAYER

Name of the Unit

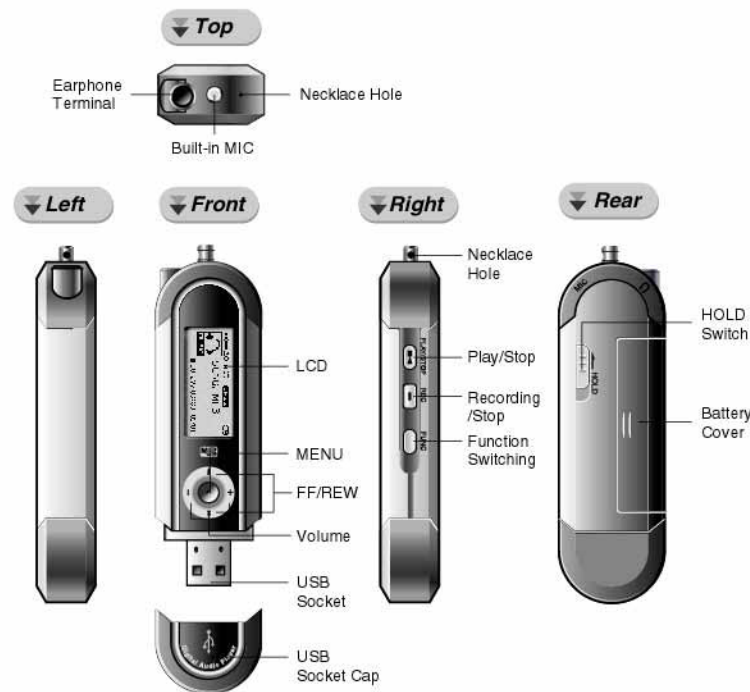

MP3
PLAYER

Description on LCD

<Music Mode>

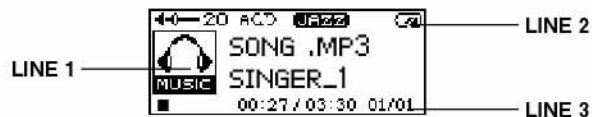

LINE 1: Displays the current music mode icon and the file name.
 LINE 2: Displays the volume, repetition, EQ and battery icon.
 LINE 3: Displays the Play/Stop status, playback time/total file playback time and playback file number/total files.

<Voice Mode>

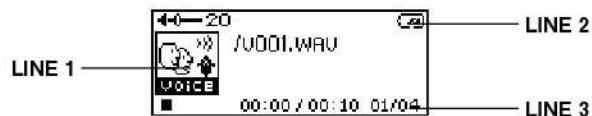

LINE 1: Displays the Voice mode icon and the file name.
 LINE 2: Displays the volume, repetition and battery icon.
 LINE 3: Displays the Play/Stop status, playback time/total file playback time and playback file number/total files.

<FM Mode>

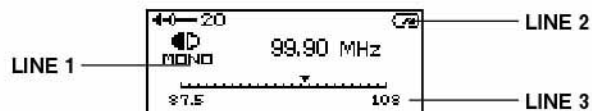

LINE 1: Displays the Mono/Stereo icon, preset channel number and frequency.
 LINE 2: Displays the volume and battery icon.
 LINE 3: Displays the frequency meter.

Before Using

■ Installing Batteries

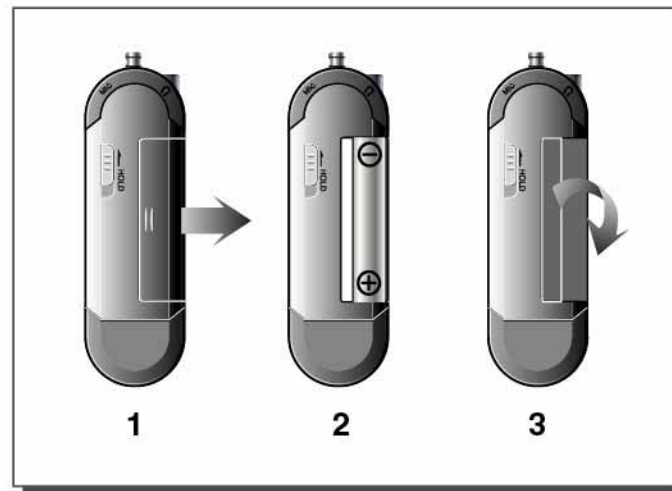

1. Press the battery cover softly and push towards the arrow direction.
2. Insert the battery with correct polarity.
3. Close the battery cover.



Caution

- ▶ Stop playback when replacing the battery.
- ▶ Check the polarities of the battery.

Before Using

Battery status icon



Note

- ▶ If the battery is low, the LCD will display "Low Battery Shut Down...", and the player will be automatically turned off.

Low Battery
Shut Down...

Battery Lifetime

| Battery | MP3 Playback (VOL. 15) | Voice Recording | FM Reception (VOL. 15) |
|-----------------|---------------------------|-----------------|---------------------------|
| AAA Alkaline | 10 hours | 10 hours | 13 hours |

Note

- ▶ Battery lifetime can vary depending on the sound volume and battery type.
- ▶ The player will be automatically turned off after 30 seconds, 1, 3 or 5 minutes later according to user selection.
- ▶ You can prevent battery waste due to button manipulation by mistake if you turn the HOLD switch on.

MP3
PLAYER

Before Using

Hold On/Off

You can prevent unintended button manipulation by setting the hold mode on.



Hold on: Push the HOLD [] button to the arrow direction.

Hold off: Push the HOLD [] button to the arrow direction in reverse.

Power On/Off

Power on: Press the MENU [] button once shortly. Then, the player will be turned on and remains in a waiting mode.

Power off: Press the MENU [] button longer than 3 seconds to turn off the player.



POWER ON

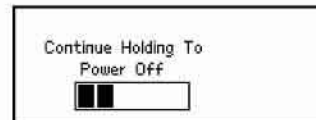

POWER OFF

Connecting an Earphone

Connect the earphone plug to the player's earphone terminal.

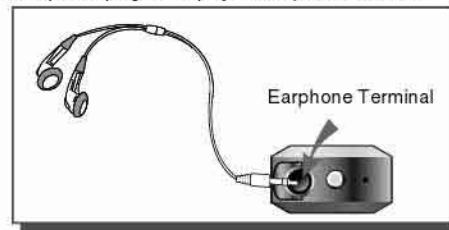

MP3
PLAYER