

For more information, please visit:



www.oraimo.com



@oraimo_accessories

Caution

1. Use careful with the earphone maybe excessive sound pressure from earphones and headphones can cause hearing loss.
2. Risk of explosion if battery is replaced by an incorrect type, dispose of used batteries according to the instructions.
 - disposal of a battery into fire or a hot oven, or mechanically crushing or cutting of a battery, that can result in an explosion;
 - leaving a battery in an extremely high temperature surrounding environment that can result in an explosion or the leakage of flammable liquid or gas;
 - a battery subjected to extremely low air pressure that may result in an explosion or the leakage of flammable liquid or gas.
3. The product shall only be connected to a USB interface of version USB 2.0.
4. EUT Temperature: 0°C ~ +45°C (Standalone) 0 ~ +40°C (with adapter).
5. To prevent possible hearing damage, do not listen at high volume levels for long periods.
6. USB cable is shielded.

Operating Frequency:
Bluetooth: 2402-2480MHz (TX/RX);
Modulation mode:
GFSK, π/4-DQPSK, 8DPSK
RF output power:
BT: 1.94dBm(Left), 3.6dBm(Right)

**EU Declaration of Conformity**

in accordance with
Annex VI of Directive 2014/53/EU of the European Parliament and of the Council

1. For the following Radio equipment:

Model: OEB-E02D

Product: True Wireless Stereo Earbuds

Trade name or Brand: oraimo

Software / Hardware number: B5501ZE-OEB-E02D_BT8896A_20210917_V3.0.5 / BT: V01-00; CHG: V00-00

2. Name and address of the manufacturer or his authorised representative:
Manufacturer: ORAIMO TECHNOLOGY LIMITED
Address: FLAT 39 8/F BLOCK D WAH LOK INDUSTRIAL CENTRE 31-35 SHAN MEI STREET FOTAN NT

3. This declaration of conformity is issued under the sole responsibility of the Manufacturer.

4. Object of the declaration (identification of the radio equipment allowing traceability; it may include a colour image of sufficient clarity where necessary for the identification of the radio equipment):

5. The object of the declaration described above is in conformity with the relevant Union harmonization legislation: Directive 2014/53/EU (RED)

6. References to the relevant harmonised standards used or references to the other technical specifications in relation to which conformity is declared:

Article 3.1a Health: EN 62479:2010

Article 3.1a Electrical Safety: EN62368-1:2014+A11:2017

Article 3.1b: ETSI EN 301 489-1 V2.2.3 (2019-11)

ETSI EN 301 489-17 V3.2.4 (2020-09)

Article 3.2: ETSI EN 300 328 V2.2.2 (2019-07)

7. **Notified Body Name:** Eurofins Electrical and Electronic Testing NA, Inc.

Notified Body Number: 0980

Notified Body Assessment Performed: Module B/C on Article 3.1a, 3.1b, 3.2 and 3.3
Technical File Identification Number: N/A

8. Where applicable, description of accessories and components, including software, which allow the radio equipment to operate as intended and covered by the EU declaration of conformity: User instructions are provided in the User Manual. The Software and Hardware versions are specified above.

9. Additional Information:

Referring to Article 10.2 of the Directive, this equipment is so constructed that it can be operated in all Member States, without infringing applicable requirements on the use of radio spectrum.
Referring to Article 10.10 of the Directive, there are no restrictions on putting this equipment into service or of requirements for authorisation of use. Please refer to the User Manual for details.

On behalf of:

Manufacturer: ORAIMO TECHNOLOGY LIMITED

Address: FLAT 39 8/F BLOCK D WAH LOK INDUSTRIAL CENTRE 31-35 SHAN MEI STREET FOTAN NT

(place and date of issue): Shenzhen, 2021-09-22

(name, function): Yiting, Luo / Manager

(signature):

FCC Caution:

(1) Any Changes or modifications not expressly approved by the party responsible for compliance could void the user's authority to operate the equipment.
This device complies with part 15 of the FCC Rules. Operation is subject to the following two conditions: (1) This device may not cause harmful interference, and (2) this device must accept any interference received, including interference that may cause undesired operation.

IMPORTANT NOTE:

Note: This equipment has been tested and found to comply with the limits for a Class B digital device, pursuant to part 15 of the FCC Rules. These limits are designed to provide reasonable protection against harmful interference in a residential installation. This equipment generates, uses and can radiate radio frequency energy and, if not installed and used in accordance with the instructions, may cause harmful interference to radio communications. However, there is no guarantee that interference will not occur in a particular installation. If this equipment does cause harmful interference to radio or television reception, which can be determined by turning the equipment off and on, the user is encouraged to try to correct the interference by one or more of the following measures:

—Reorient or relocate the receiving antenna.

—Increase the separation between the equipment and receiver.

—Connect the equipment into an outlet on a circuit different from that to which the receiver is connected.

—Consult the dealer or an experienced radio/TV technician for help.

FCC Radiation Exposure Statement:

This equipment complies with FCC radiation exposure limits set forth for an uncontrolled environment.

Customer Service**365 DAYS WARRANTY**

✉ Email: hello.ab@oraimo.com

Warranty Certificate

Name :	
Address :	
Tel. No. :	
Date of purchase : (dd/mm/yy)	
Store name :	
Warranty period :	

Warranty Terms & Conditions

* All quality-related defects on items sold directly by oraimo or oraimo's authorized resellers are covered by an extensive warranty, starting from the date of purchase.

* oraimo's limited warranty is restricted to the country of purchase. The limited warranty is void on items taken outside the country they were originally bought in or shipped to directly from an authorized online purchase.

* This warranty covers only original oraimo products. It is not applicable to normal wear and tear, or any defects arising from damage caused by misuse of this product.

* Warranty is for the primary product only not transferable. Any free additional product(s) are not covered in this warranty.

* If the product fails regardless of usage in compliance with the instruction manual and other written precaution, replacement will be provided free of charge.

* To receive replacement, bring the warranty certificate and the product itself to the store from where you have purchased the product.

oraimo
smart accessories

WELCOME GUIDE

* For safety issue, the product remains low capacity during shipping. Please fully charge the product before initial use!

Riff
— OEB-E02D —

User Manual

True Wireless Stereo Earbuds

Model: OEB-E02D

Hereby, ORAIMO TECHNOLOGY LIMITED,
Declares that this True Wireless Stereo Earbuds is in compliance with the essential requirements and other relevant provisions of directive 2014/53/EU.

Please read this Guide carefully
before using the product

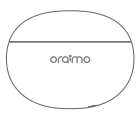
Package Contents

Charging Case x 1

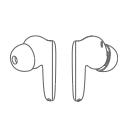

True Wireless Earbuds x 2

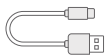

Type-C Charging Cable x 1

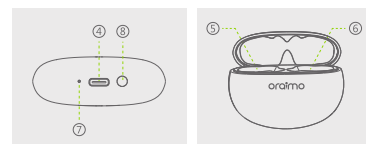

Pair of Earbuds x 2

Product Overview**Product Overview**

- 1 Earbud Status Indicator
- 2 Multi-Function Touch Sensor
- 3 Microphone
- 4 Type-C Charging Port
- 5 Left Earbud
- 6 Right Earbud
- 7 Case Status Indicator
- 8 Reset Button

Basic Product Specifications**Earbuds**

	Music play time : Up to 4.5 hours
Range : ≥ 10m	Talk time : Up to 3 hours
Driver (full range) : 10mm x 2	Battery capacity : 35mAh (each earbud)
Standby time : Up to 40 hours	Charging time : Approx. 1.5 hours

Charging Case

Charge times for earbuds : Up to 2.5 times
Battery capacity : 300mAh
Charging time : Approx. 2 hours

Using Your Earbuds**Charge The Product As Follows**

1 Put the earbuds back to the charging case.



2 Fully charge the case for 1.5 hours.

**Turn On****Pairing**

✱ Earbuds will turn on and enter pairing mode automatically when opening the charging case.

Earbud Status Indicator		Status
	White lights flashing on both earbuds	TWS Pairing
	Steady White	BT Pairing
	Lights off	Connected to a device

✱ Make sure the distance of the earbuds and your device is less than 1 metre / 3.3 feet at the first time of connection.

✱ When turned on, the earbuds will automatically connect to the last connected device if available. If not, the earbuds will enter pairing mode.

✱ If you want to clear the pairing list, long press the reset button for 6s when both earbuds inside the case.

✱ Under any abnormal condition, return the earbuds to the charging case and then take out again.

Turn Off

The earbuds turn off automatically when placed back into the charging case.



✱ The earbuds will automatically turn off after 2 minutes if no device is connected.

Charging Your Earbuds

Earbuds will be charged automatically once they are returned to the charging case with the lid closed.

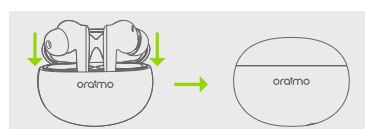
**Charging Your Case**

Use the included Type-c charging cable to charge the case.

Case Status Indicator		Status
	Steady red	Being charged
	Steady green	Fully charged

Case Power Level

Use the included Type-c charging cable to charge the case.

Case Status Indicator	Power Level
→	Steady red and off
→	Steady orange and off
→	Steady green and off
	Low
	Medium
	High

Attention

- * Use original or certified cables
- * Do not expose to liquids
- * Do not disassemble
- * Avoid dropping
- * Avoid extreme temperatures
- * Do not use the product outdoors during a thunderstorm
- * Do not use any corrosive cleaner/oil to clean

Considerate Hints

1. Do not turn up the volume to a fair high level constantly as this could shorten the service life of this product or impair your hearing.
2. When encounter any fault during operation, please cut off the power supply and disconnect the Type-C cable to prevent further damage to the product or other components.
3. The wireless transmission range or connectivity could be affected by low battery power. In that case, please recharge immediately.

Controls

Controls		
	Tap on one earbud twice	Play/Pause
	Tap and hold on the left earbud for 2 second	Previous track
	Tap and hold on the right earbud for 2 second	Next track
	Tap on one earbud twice	Answer/End a call
	Tap and hold on one earbud for two seconds	Reject call
Others		
	Tap one earbud for three times	Activate Voice Assistant
	Tap one earbud once or for three times	Exit Voice Assistant
	Long press the reset button on the charging case for 6s	Clear pairing list of the earbuds