

# **Shark™** **FLEXBREEZE™** **PRO MIST FAN** **FA302**

## **QUICK START GUIDE**

---



**FOR MORE INFORMATION**

visit [qr.sharkclean.com/fa300series](https://qr.sharkclean.com/fa300series) or

**SCAN HERE**  
**USING YOUR SMARTPHONE CAMERA**



© 2024 SharkNinja Operating LLC, Needham, MA 02494.  
SHARK is a trademark of SharkNinja Operating LLC.

FA302C\_QSG\_MP\_Mv1

# IMPORTANT SAFETY INSTRUCTIONS

SUITABLE FOR OUTDOOR USE & HOUSEHOLD USE ONLY.

**NOTE:** Before every use, empty and rinse the misting hose and water tank to prevent stagnant water from being misted.

## ⚠ WARNING

TO REDUCE THE RISK OF FIRE, ELECTRIC SHOCK, OR INJURY: READ ALL THESE INSTRUCTIONS BEFORE USE.

1. This appliance is operated by a rechargeable battery. ONLY recharge the battery with the charger supplied with the unit, battery charger for use only with model GQ36-120300-AUO power supply from Dongguan Gangqi Electronics Co., Ltd. or with model ZD036T120300US from E-TEK, or with model AJJ3-1 from Anlian. A charger that may be suitable for one type of battery may create a risk of fire when used with another battery.
2. Do not attempt to destroy, remove, or disassemble the battery pack from the machine. Do not incinerate battery cells. Consult your local waste authority for information regarding available recycling and/or disposal options.
3. This appliance comes with a remote control which contains a coin battery. Dispose of batteries properly. Always keep batteries away from children (choke hazard). Even used batteries can cause injury.
4. To reduce the risk of electric shock, connect only to an outlet provided with a ground fault circuit interrupting (GFCI) device.
5. The fan should be used on a stable and level surface.
6. Never use this fan near pools, bathtubs, showers, basins, or other vessels containing water.
7. Do not operate any unit with a damaged power supply wire or battery charger. Discard the unit or return to an authorized service facility for examination and/or repair.
8. Do not run cord under carpeting. Do not cover charge cord with throw rugs, runners, or similar coverings. Do not route charge cord under furniture or appliances. Keep charger cord away from high-traffic areas. Place charger in an area where the cord will not be tripped over.
9. If the charger cord is damaged, it should be replaced.
10. This appliance is not intended for use by anyone (including children) with reduced physical, sensory, or mental capabilities, or lack of experience and knowledge, unless they have been given supervision or instruction concerning use of the appliance by a person responsible for their safety.
11. Children should be supervised to ensure that they DO NOT play with the appliance.
12. Cleaning and user maintenance shall not be made by children without supervision.
13. Prior to cleaning or other maintenance, the appliance must be unplugged from the electrical outlet.
14. Only use Shark branded accessories.
15. Do not use if appliance is not working as it should, has been damaged, or dropped into water.
16. Turn off all controls before plugging in or unplugging the appliance.
17. Unplug from electrical outlet when not in use and before any maintenance or cleaning.
18. Hand wash exterior/hard plastic/non-electronic parts with damp cloth and water only.
19. Do not attempt to repair or adjust any electrical or mechanical functions of this appliance, as this may cause danger and void the warranty.
20. Remove and immediately recycle or dispose of used batteries according to local regulations and keep away from children. Do NOT dispose of batteries in household trash or incinerate.
21. Even used batteries may cause severe injury or death.
22. Call a local poison control center for treatment information.
23. Compatible battery type is CR2025.
24. The nominal battery voltage is 3V.
25. Non-rechargeable batteries are not to be recharged.
26. Do not force discharge, recharge, disassemble, heat above 140°F (60°C), or incinerate. Doing so may result in injury due to venting, leakage, or explosion resulting in chemical burns.
27. Ensure the batteries are installed correctly according to polarity (+ and -).
28. Do not mix old and new batteries, different brands or types of batteries, such as alkaline, carbon-zinc, or rechargeable batteries.

29. Remove and immediately recycle or dispose of batteries from equipment not used for an extended period of time according to local regulations.
30. Always completely secure the battery compartment. If the battery compartment does not close securely, stop using the product, remove the batteries, and keep them away from children.
31. The misting feature is suitable for **OUTDOOR USE ONLY**. **DO NOT** attempt to mist indoors as this could cause slippery conditions or water damage.
32. Never attempt to mist substances other than filtered or clean tap water. **DO NOT** use warm or hot water. Only use cold or room temperature water.
33. **DO NOT** handle live electrical products while in range of the misting stream.
34. Keep non-waterproof electronic equipment and appliances out of the misting stream.
35. **WARNING: CHOKING HAZARD.** Always keep nozzles and any other small parts out of the reach of children.
36. Do not apply any fragrance or scented products onto any part of the fan during use or maintenance.

### ⚠ WARNING: Not suitable for use with solid-state speed controls.

#### LITHIUM BATTERY SAFETY WARNINGS

LITHIUM BATTERIES STORE A LARGE AMOUNT OF ENERGY AND WILL VENT FIRE OR EXPLODE IF MISTREATED.

1. DO NOT DO ANY OF THE FOLLOWING TO THE BATTERY PACK:
  - a. Open
  - b. Drop
  - c. Short-circuit
  - d. Puncture
  - e. Incinerate
  - f. Expose to temperatures
2. Keep battery pack dry.
3. Charge battery pack only according to its charger's instructions.
4. Inspect battery pack before every use: do not use or charge if damaged.

#### BATTERY REMOVAL AND DISPOSAL

This product contains an integral lithium battery (not replaceable), and the remote control uses a lithium coin battery. When the remote battery no longer has a charge, it should be removed from the remote and recycled. DO NOT incinerate or compost the product with its integral battery or the remote battery. When your remote battery needs to be replaced, dispose of it or recycle it in accordance with local ordinances or regulations. In some areas, it is illegal to place spent lithium batteries in the trash or in a municipal solid waste stream. Return spent battery to an authorized recycling center or to retailer for recycling. Contact your local recycling center for information on where to drop off the spent battery.

#### POWER SUPPLY SAFETY

1. Read and follow all instructions that are on the product or provided with the product.
2. Do not use an extension cord.
3. Do not use within 10 feet of pool and do not use in a bathroom.
4. **WARNING: Risk of Electric Shock.** When used outdoors, install only to a covered Class A GFCI protected receptacle that is weatherproof with the power unit connected to the receptacle. If one is not provided, contact a qualified electrician for proper installation. Ensure that the power unit and cord do not interfere with closing the receptacle cover.

#### FCC WARNINGS

**Note:** This equipment has been tested and complies with the limits for a Class B digital device - pursuant to part 15 of the FCC Rules. These limits are designed to provide reasonable protection against harmful interference in a residential installation. This equipment generates, uses, and can radiate radio frequency energy, and if not installed and used in accordance with the instructions, may cause harmful interference to radio communications.

To see if this equipment interferes with radio or television reception, try turning the equipment off and on.

To correct any interference:

- Reorient or relocate the receiving antenna.
- Increase the distance between the equipment and the receiver.
- Connect the equipment to a different outlet than the receiver.
- Consult the dealer or an experienced technician for help.

This device complies with Part 15 of the FCC Rules. Operation is subject to two conditions:

1. This device may not cause harmful interference, and
2. This device must accept any interference received, including interference that may cause undesired operation.

**Caution:** Any changes or modifications to this unit not expressly approved by the party responsible for compliance could void the user's authority to operate the equipment.

#### IC Statement:

This device contains licence-exempt transmitter(s)/receiver(s) that comply with Innovation, Science and Economic Development Canada's licence-exempt RSS(s). Operation is subject to the following two conditions:

1. This device may not cause interference.
2. This device must accept any interference, including interference that may cause undesired operation of the device.

### ⚠ WARNING

- **INGESTION HAZARD:** This product contains a button cell or coin battery.
- **DEATH** or serious injury can occur if ingested.
- A swallowed button cell or coin battery can cause **Internal Chemical Burns** in as little as **2 hours**.
- **KEEP** new and used batteries **OUT OF REACH** of CHILDREN.
- **Seek immediate medical attention** if a battery is suspected to be swallowed or inserted inside any part of the body.



READ AND SAVE THESE INSTRUCTIONS

## ASSEMBLING YOUR FAN

**INCLUDES:** • Allen Wrench • Bolt • Fan Head • Water Tank • Remote • Multi-Tool • Base • 2-Piece Pole • Hose • Charging Cable

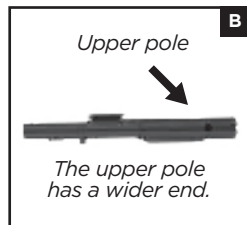
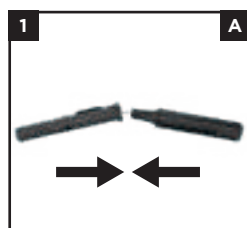

**1.** Align and insert the **Upper Pole** into the **Lower Pole** until it clicks into place.



**2.** Align the yellow dot on the assembled pole with the yellow arrow on the **Base**, then slide the pole down onto the **base**. Ensure that the pole is fully against the base before proceeding.

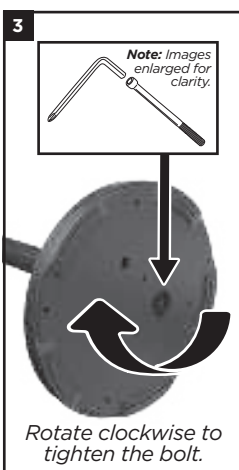

**3.** Turn the **Base** on its side, then insert the Bolt in the bottom of the **Base**. Use the **Allen Wrench** to turn the bolt clockwise to fasten it to the assembled pole.



**4. CAUTION:** finger pinch risk. Holding the fan head by the handle, insert the legs into the top of the assembled pole until they click into place.

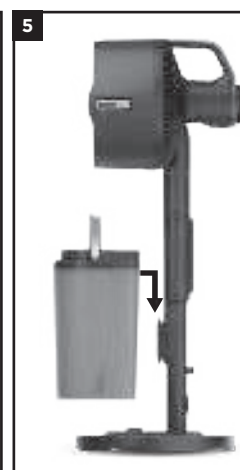

**5.** Holding the **Water Tank** by the handle, align the rear of the tank against the **Pole** and slide down to latch into place.



**6. Charge fan to 100% battery** before use without the cord. **First use:** before using remote control, press **Power Button** on fan. Fan is operable while charging.



**7.** Align the **Hose** into the back of the **Water Tank** and rotate clock-wise to lock in place.

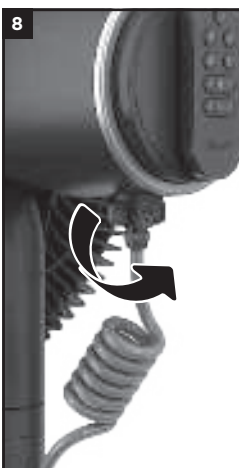

**8.** Align the **Hose** into the rear of the **Fan Head** and rotate counter clock-wise to lock in place.



**9.** Neatly tuck away the excess **Hose** into the groove and clamp behind the **Pole**.

## FEATURES

### CORDLESS

This is a 2-in-1 fan that can be used with or without the cord.

### OUTDOORS

This fan can be enjoyed indoors or outdoors.

**DO NOT CHARGE OR USE IN THE RAIN**

### BREEZEBOOST™ & NATURALBREEZE™

Activate the extra-powerful BreezeBoost™ for maximum strength airflow, or use one of the NaturalBreeze modes to simulate wind conditions.

### OUTDOOR MISTING

Integrated misting enabled through a portable water tank, 2 misting nozzles, and 3 misting modes. The misting feature is suitable for **OUTDOOR USE ONLY**.

### OSCILLATION & TILT

Direct the airflow by choosing between 3 electronic oscillation angles and manually adjusting the vertical tilt up to 55° degrees.

### REMOTE STORAGE

You can store the remote on the convenient magnetic mount on back of the fan head.

## TABLETOP MODE

To convert the fan to portable, tabletop mode:



To detach the fan from the pole, press the Lift-Away button, then slide the fan head off the pole.



Spread out the four support legs until they are fully extended. Place the fan on a flat, level surface and begin use.



Connect the hose to the tank and fan head while in tabletop mode for misting on-the-go.

**Note:** To avoid accidental damage to your fan, ensure the hose is disconnected from the back of the fan head before converting to tabletop mode.

## CHARGING YOUR FAN



**PEDESTAL MODE:** To charge the fan in pedestal mode, insert the **CHARGE PLUG** into the charging port near the bottom of the **POLE**.



**TABLETOP MODE:** To charge the fan in tabletop mode, insert the **CHARGER PLUG** into the charging port under the center shaft of the fan, between the 4 support legs. **DO NOT CHARGE OR USE IN THE RAIN.**

## REMOTE STORAGE

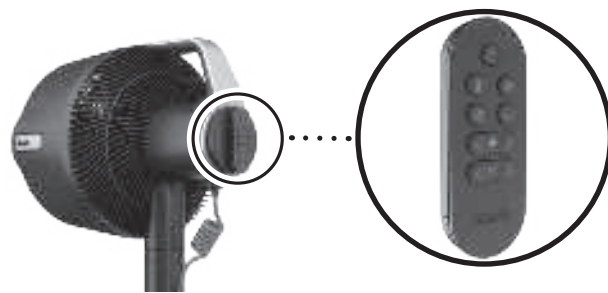

If the fan is unplugged and not used for 24 hours the remote will enter IDLE mode to preserve battery. To turn off IDLE Mode, use the buttons on the fan head.

## HOW TO USE YOUR FAN

Fan Speeds	Press  on the fan head or <  > arrows on the remote to switch between fan speeds. LED lights will indicate selected fan speed.	
	BreezeBoost™ Mode	For maximum-strength airflow, press  on the remote or  on the fan head again. During cordless use, fan speed will automatically decrease after 20 minutes to save battery power
	NaturalBreeze Modes	To activate STRONG breeze mode, press  once on the REMOTE, or press  on the fan head an additional time.
		To activate GENTLE breeze mode, press  a 2nd time on the REMOTE, or press  on the fan an additional time.
Oscillation Settings	Press  on the fan head or <  > arrows on the remote to toggle between oscillation settings. LED lights will indicate which setting is selected.	
Horizontal Angle Adjust	Press the <  > arrows on the remote to change the horizontal angle of the fan in 18° increments.	
Outdoor Misting Settings	1-3	Press  once to turn on high-pressure consistent mist. Press  a 2nd time to switch to the low-pressure consistent mist mode. Press  a 3rd time to switch to the low-pressure interval mist mode.
Runtime	Fan ONLY	<b>MAXIMUM CORDLESS RUNTIME:</b> 24 hours on fan speed 1. <b>AVERAGE CORDLESS RUNTIME:</b> 6 hours on fan speed 3. <b>MAXIMUM CORDLESS PERFORMANCE:</b> 2 hours on fan speed 5. <b>PLUGGED IN:</b> Indefinite runtime; fan will charge while operating.
	Fan + Outdoor Misting	<b>MAXIMUM MISTING RUNTIME:</b> 16-hour high-pressure consistent misting on fan speed 1 (refilling the water tank every hour). <b>AVERAGE MISTING RUNTIME:</b> 4-hour high-pressure consistent misting on fan speed 3 (refilling the water tank every hour). <b>MAXIMUM MISTING PERFORMANCE:</b> 1-hour high-pressure consistent misting on fan speed 5
Charge Time	<b>FROM 0% TO FULLY CHARGED BATTERY:</b> 5-6 hours	
Battery Indicator	<div>  70%-100%: green light   30%-69%: amber light </div> <div>  6%-29%: red light steady   5% and below: red light blinking </div>	

## VERTICAL TILT

To adjust the vertical height of the fan head, use the handle to manually tilt the head up or down.

The fan has a vertical range of 55° degrees.



Fan head tilted UP



Fan head tilted DOWN

## REMOTE PAIRING INSTRUCTIONS

Turn the unit on by pressing the power button on top of the fan head and check if the remote functions properly.

If the remote is not functioning, try the following:

1. Check to ensure the battery saver paper is removed from the remote.
2. Try connecting the remote to the fan by pressing and holding the power button on the fan head for 8 seconds. While the LEDs are flashing, press the fan speed up button on the remote.

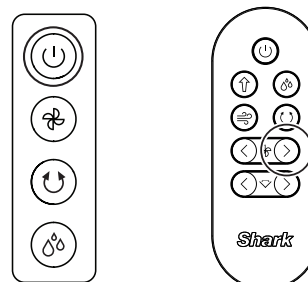

3. If the remote still doesn't work, then try replacing the batteries in the remote and repeat the connection process above.



# **Shark™** **FLEXBREEZE™** **PRO MIST FAN** **FA302**

## **QUICK START GUIDE**

---



**FOR MORE INFORMATION**

visit [qr.sharkclean.com/fa300series](https://qr.sharkclean.com/fa300series) or

**SCAN HERE**  
**USING YOUR SMARTPHONE CAMERA**



© 2024 SharkNinja Operating LLC, Needham, MA 02494.  
SHARK is a trademark of SharkNinja Operating LLC.

FA302C\_QSG\_MP\_Mv1

# IMPORTANT SAFETY INSTRUCTIONS

SUITABLE FOR OUTDOOR USE & HOUSEHOLD USE ONLY.

**NOTE:** Before every use, empty and rinse the misting hose and water tank to prevent stagnant water from being misted.

## ⚠️ WARNING

TO REDUCE THE RISK OF FIRE, ELECTRIC SHOCK, OR INJURY: READ ALL THESE INSTRUCTIONS BEFORE USE.

1. This appliance is operated by a rechargeable battery. ONLY recharge the battery with the charger supplied with the unit, battery charger for use only with model GQ36-120300-AUO power supply from Dongguan Gangqi Electronics Co., Ltd. or with model ZD036T120300US from E-TEK, or with model AJJ3-1 from Anlian. A charger that may be suitable for one type of battery may create a risk of fire when used with another battery.
2. Do not attempt to destroy, remove, or disassemble the battery pack from the machine. Do not incinerate battery cells. Consult your local waste authority for information regarding available recycling and/or disposal options.
3. This appliance comes with a remote control which contains a coin battery. Dispose of batteries properly. Always keep batteries away from children (choke hazard). Even used batteries can cause injury.
4. To reduce the risk of electric shock, connect only to an outlet provided with a ground fault circuit interrupting (GFCI) device.
5. The fan should be used on a stable and level surface.
6. Never use this fan near pools, bathtubs, showers, basins, or other vessels containing water.
7. Do not operate any unit with a damaged power supply wire or battery charger. Discard the unit or return to an authorized service facility for examination and/or repair.
8. Do not run cord under carpeting. Do not cover charge cord with throw rugs, runners, or similar coverings. Do not route charger cord under furniture or appliances. Keep charger cord away from high-traffic areas. Place charger in an area where the cord will not be tripped over.
9. If the charger cord is damaged, it should be replaced.
10. This appliance is not intended for use by anyone (including children) with reduced physical, sensory, or mental capabilities, or lack of experience and knowledge, unless they have been given supervision or instruction concerning use of the appliance by a person responsible for their safety.
11. Children should be supervised to ensure that they DO NOT play with the appliance.
12. Cleaning and user maintenance shall not be made by children without supervision.
13. Prior to cleaning or other maintenance, the appliance must be unplugged from the electrical outlet.
14. Only use Shark branded accessories.
15. Do not use if appliance is not working as it should, has been damaged, or dropped into water.
16. Turn off all controls before plugging in or unplugging the appliance.
17. Unplug from electrical outlet when not in use and before any maintenance or cleaning.
18. Hand wash exterior/hard plastic/non-electronic parts with damp cloth and water only.
19. Do not attempt to repair or adjust any electrical or mechanical functions of this appliance, as this may cause danger and void the warranty.
20. Remove and immediately recycle or dispose of used batteries according to local regulations and keep away from children. Do NOT dispose of batteries in household trash or incinerate.
21. Even used batteries may cause severe injury or death.
22. Call a local poison control center for treatment information.
23. Compatible battery type is CR2025.
24. The nominal battery voltage is 3V.
25. Non-rechargeable batteries are not to be recharged.
26. Do not force discharge, recharge, disassemble, heat above 140°F (60°C), or incinerate. Doing so may result in injury due to venting, leakage, or explosion resulting in chemical burns.
27. Ensure the batteries are installed correctly according to polarity (+ and -).
28. Do not mix old and new batteries, different brands or types of batteries,

- such as alkaline, carbon-zinc, or rechargeable batteries.
29. Remove and immediately recycle or dispose of batteries from equipment not used for an extended period of time according to local regulations.
  30. Always completely secure the battery compartment. If the battery compartment does not close securely, stop using the product, remove the batteries, and keep them away from children.
  31. The misting feature is suitable for **OUTDOOR USE ONLY**. **DO NOT** attempt to mist indoors as this could cause slippery conditions or water damage.
  32. Never attempt to mist substances other than filtered or clean tap water. **DO NOT** use warm or hot water. Only use cold or room temperature water.
  33. **DO NOT** handle live electrical products while in range of the misting stream.
  34. Keep non-waterproof electronic equipment and appliances out of the misting stream.
  35. **WARNING: CHOKING HAZARD.** Always keep nozzles and any other small parts out of the reach of children.
  36. Do not apply any fragrance or scented products onto any part of the fan during use or maintenance.

⚠️ **WARNING: Not suitable for use with solid-state speed controls.**

### LITHIUM BATTERY SAFETY WARNINGS

LITHIUM BATTERIES STORE A LARGE AMOUNT OF ENERGY AND WILL VENT FIRE OR EXPLODE IF MISTREATED.

1. DO NOT DO ANY OF THE FOLLOWING TO THE BATTERY PACK:
  - a. Open
  - b. Drop
  - c. Short-circuit
  - d. Puncture
  - e. Incinerate
  - f. Expose to temperatures
2. Keep battery pack dry.
3. Charge battery pack only according to its charger's instructions.
4. Inspect battery pack before every use: do not use or charge if damaged.

### BATTERY REMOVAL AND DISPOSAL

This product contains an integral lithium battery (not replaceable), and the remote control uses a lithium coin battery. When the remote battery no longer has a charge, it should be removed from the remote and recycled. **DO NOT** incinerate or compost the product with its integral battery or the remote battery. When your remote battery needs to be replaced, dispose of it or recycle it in accordance with local ordinances or regulations. In some areas, it is illegal to place spent lithium batteries in the trash or in a municipal solid waste stream. Return spent battery to an authorized recycling center or to retailer for recycling. Contact your local recycling center for information on where to drop off the spent battery.

### POWER SUPPLY SAFETY

1. Read and follow all instructions that are on the product or provided with the product.
2. Do not use an extension cord.
3. Do not use within 10 feet of pool and do not use in a bathroom.
4. **WARNING: Risk of Electric Shock.** When used outdoors, install only to a covered Class A GFCI protected receptacle that is weatherproof with the power unit connected to the receptacle. If one is not provided, contact a qualified electrician for proper installation. Ensure that the power unit and cord do not interfere with closing the receptacle cover.

### FCC WARNINGS

**Note:** This equipment has been tested and complies with the limits for a Class B digital device - pursuant to part 15 of the FCC Rules. These limits are designed to provide reasonable protection against harmful interference in a residential installation. This equipment generates, uses, and can radiate radio frequency energy, and if not installed and used in accordance with the instructions, may cause harmful interference to radio communications.

To see if this equipment interferes with radio or television reception, try turning the equipment off and on.

To correct any interference:

- Reorient or relocate the receiving antenna.
- Increase the distance between the equipment and the receiver.
- Connect the equipment to a different outlet than the receiver.
- Consult the dealer or an experienced technician for help.

This device complies with Part 15 of the FCC Rules. Operation is subject to two conditions:

1. This device may not cause harmful interference, and
2. this device must accept any interference received, including interference that may cause undesired operation.

**Caution:** Any changes or modifications to this unit not expressly approved by the party responsible for compliance could void the user's authority to operate the equipment.

### DÉCLARATION DE L'IC :

L'émetteur/récepteur exempt de licence contenu dans le présent appareil est conforme aux cnr d'innovation, sciences et développement économique canada applicables aux appareils radio exempts de licence. L'exploitation est autorisée aux deux conditions suivantes :

1. L'appareil ne doit pas produire de brouillage;
2. L'appareil doit accepter tout brouillage radioélectrique subi, même si le brouillage est susceptible d'en compromettre le fonctionnement.

## ⚠️ AVERTISSEMENT

- **RISQUE D'INGESTION :** Ce produit contient une pile bouton au lithium ou plate.
- L'ingestion de ce produit peut entraîner la **MORT** ou des blessures graves.
- Une pile bouton au lithium ou une pile plate avalée peut causer des **brûlures chimiques internes** en aussi peu que **2 heures**.
- **GARDEZ LES** piles neuves et usagées **HORS DE LA PORTÉE** des **ENFANTS**.
- **Consultez immédiatement un médecin** si vous soupçonnez qu'une pile a été avalée ou insérée dans une partie du corps.



**READ AND SAVE THESE INSTRUCTIONS**

## ASSEMBLING YOUR FAN

**INCLUDES:** • Allen Wrench • Bolt • Fan Head • Water Tank • Remote • Multi-Tool • Base • 2-Piece Pole • Hose • Charging Cable

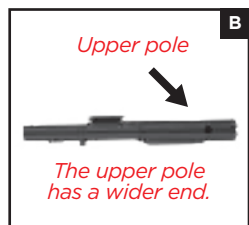
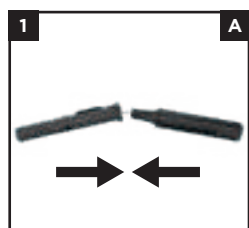

**1.** Align and insert the **Upper Pole** into the **Lower Pole** until it clicks into place.



**2.** Align the yellow dot on the assembled pole with the yellow arrow on the **Base**, then slide the pole down onto the **base**. Ensure that the pole is fully against the base before proceeding.

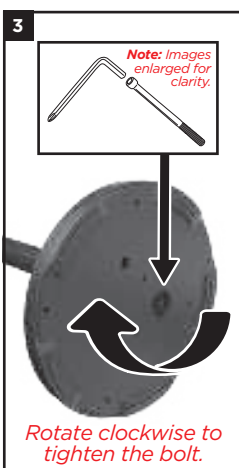

**3.** Turn the **Base** on its side, then insert the Bolt in the bottom of the **Base**. Use the **Allen Wrench** to turn the bolt clockwise to fasten it to the assembled pole.



**4. CAUTION:** finger pinch risk. Holding the fan head by the handle, insert the legs into the top of the assembled pole until they click into place.

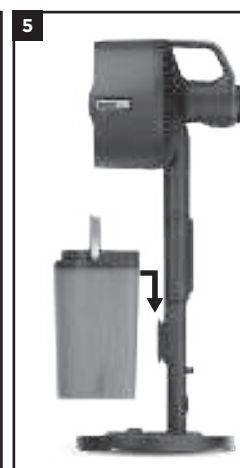

**5.** Holding the **Water Tank** by the handle, align the rear of the tank against the **Pole** and slide down to latch into place.



**6. Charge fan to 100% battery** before use without the cord. **First use:** before using remote control, press **Power Button** on fan. Fan is operable while charging.



**7.** Align the **Hose** into the back of the **Water Tank** and rotate clock-wise to lock in place.

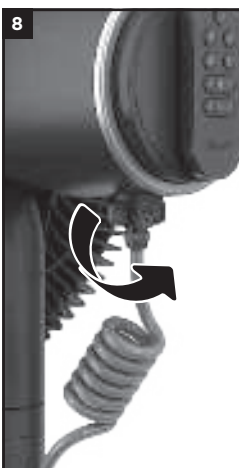

**8.** Align the **Hose** into the rear of the **Fan Head** and rotate counter-clockwise to lock in place.



**9.** Neatly tuck away the excess **Hose** into the groove and clamp behind the **Pole**.

## FEATURES

### CORDLESS

This is a 2-in-1 fan that can be used with or without the cord.

### OUTDOORS

This fan can be enjoyed indoors or outdoors.

**DO NOT CHARGE OR USE IN THE RAIN**

### BREEZEBOOST™ & NATURALBREEZE™

Activate the extra-powerful BreezeBoost™ for maximum strength airflow, or use one of the NaturalBreeze modes to simulate wind conditions.

### OUTDOOR MISTING

Integrated misting enabled through a portable water tank, 2 misting nozzles, and 3 misting modes. The misting feature is suitable for **OUTDOOR USE ONLY**.

### OSCILLATION & TILT

Direct the airflow by choosing between 3 electronic oscillation angles and manually adjusting the vertical tilt up to 55° degrees.

### REMOTE STORAGE

You can store the remote on the convenient magnetic mount on back of the fan head.

## TABLETOP MODE

To convert the fan to portable, tabletop mode:



To detach the fan from the pole, press the Lift-Away button, then slide the fan head off the pole.



Spread out the four support legs until they are fully extended. Place the fan on a flat, level surface and begin use.



Connect the hose to the tank and fan head while in tabletop mode for misting on-the-go.

**Note:** To avoid accidental damage to your fan, ensure the hose is disconnected from the back of the fan head before converting to tabletop mode.

## CHARGING YOUR FAN



**PEDESTAL MODE:** To charge the fan in pedestal mode, insert the **CHARGE PLUG** into the charging port near the bottom of the **POLE**.

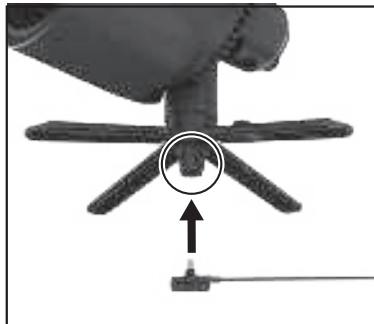





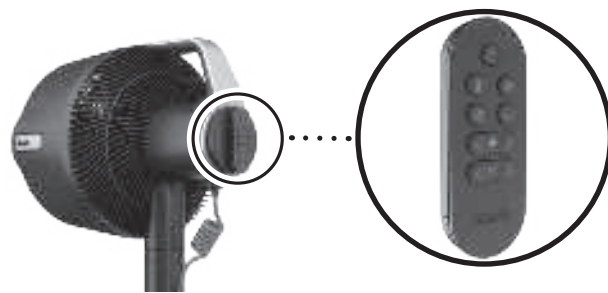











**TABLETOP MODE:** To charge the fan in tabletop mode, insert the **CHARGER PLUG** into the charging port under the center shaft of the fan, between the 4 support legs. **DO NOT CHARGE OR USE IN THE RAIN.**

## REMOTE STORAGE

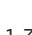

If the fan is unplugged and not used for 24 hours the remote will enter IDLE mode to preserve battery. To turn off IDLE Mode, use the buttons on the fan head.

## HOW TO USE YOUR FAN

Fan Speeds	Press  on the fan head or <  > arrows on the remote to switch between fan speeds. LED lights will indicate selected fan speed.	
	BreezeBoost™ Mode	For maximum-strength airflow, press  on the remote or  on the fan head again. During cordless use, fan speed will automatically decrease after 20 minutes to save battery power
	NaturalBreeze Modes	To activate STRONG breeze mode, press  once on the REMOTE, or press  on the fan head an additional time.
		To activate GENTLE breeze mode, press  a 2nd time on the REMOTE, or press  on the fan an additional time.
Oscillation Settings	Press  on the fan head or <  > arrows on the remote to toggle between oscillation settings. LED lights will indicate which setting is selected.	
Horizontal Angle Adjust	Press the <  > arrows on the remote to change the horizontal angle of the fan in 18° increments.	
Outdoor Misting Settings	1-3	Press  once to turn on high-pressure consistent mist. Press  a 2nd time to switch to the low-pressure consistent mist mode. Press  a 3rd time to switch to the low-pressure interval mist mode.
Runtime	Fan ONLY	<b>MAXIMUM CORDLESS RUNTIME:</b> 24 hours on fan speed 1. <b>AVERAGE CORDLESS RUNTIME:</b> 6 hours on fan speed 3. <b>MAXIMUM CORDLESS PERFORMANCE:</b> 2 hours on fan speed 5. <b>PLUGGED IN:</b> Indefinite runtime; fan will charge while operating.
	Fan + Outdoor Misting	<b>MAXIMUM MISTING RUNTIME:</b> 16-hour high-pressure consistent misting on fan speed 1 (refilling the water tank every hour). <b>AVERAGE MISTING RUNTIME:</b> 4-hour high-pressure consistent misting on fan speed 3 (refilling the water tank every hour). <b>MAXIMUM MISTING PERFORMANCE:</b> 1-hour high-pressure consistent misting on fan speed 5
Charge Time	<b>FROM 0% TO FULLY CHARGED BATTERY:</b> 5-6 hours	
Battery Indicator	<div>  70%-100%: green light   30%-69%: amber light </div> <div>  6%-29%: red light steady   5% and below: red light blinking </div>	

## VERTICAL TILT

To adjust the vertical height of the fan head, use the handle to manually tilt the head up or down.

The fan has a vertical range of 55° degrees.



Fan head tilted UP



Fan head tilted DOWN

## REMOTE PAIRING INSTRUCTIONS

Turn the unit on by pressing the power button on top of the fan head and check if the remote functions properly.

If the remote is not functioning, try the following:

1. Check to ensure the battery saver paper is removed from the remote.
2. Try connecting the remote to the fan by pressing and holding the power button on the fan head for 8 seconds. While the LEDs are flashing, press the fan speed up button on the remote.

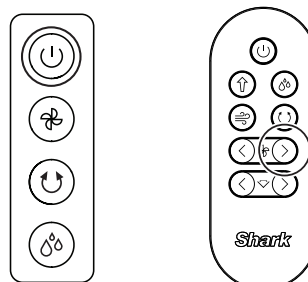

3. If the remote still doesn't work, then try replacing the batteries in the remote and repeat the connection process above.