

Pilot Pano

User Guide



Labpano Pilot Pano Panoramic Camera Overview (English)



Pilot Pano*1



Type-C USB cable*1



Wipe cloth*1



Extension rod*1



Documentation (User guide,
Warranty card, etc)

Outline

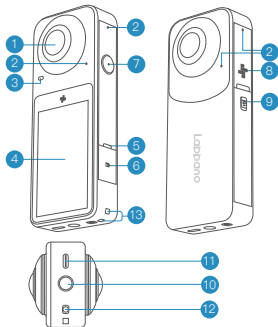

- | | |
|----------------------|---------------------------------|
| 1 Lens*2 | 8 Speaker |
| 2 Microphone*4 | 9 Battery cover release button |
| 3 Indicator | 10 Standard 1/4" mounting point |
| 4 3.0" Touch screen | 11 USB Type-C port |
| 5 SD card slot cover | 12 3.5mm mic jack |
| 6 Card slot | 13 Hang string mouth |
| 7 Power button | |

Before You Start

1. Insert the battery and charge the battery fully before using this unit for the first time.
2. Please use the included charge cable to charge the camera.

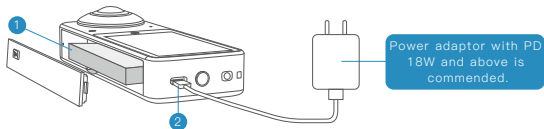

3. Insert SD card

1). Open the SD card cover.

2). Insert the SD card into the card slot. (Faced the labbled side in the direction of the screen and press it straight in as far as it will go)

Note:

- Pilot Pano with 15GB of internal storage plus support for a microSD card.
- Recommend TF card in exFAT format. When using the SD card for the first time, it is necessary to format the SD card.

3). Securely close the SD card slot cover, otherwise, it may result in water and sand entering the inside of the camera.

Insert SD card in the direction shown in the illustration.

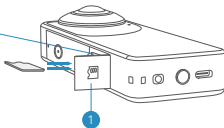

FCC

This equipment has been tested and found to comply with the limits for a Class B digital device, pursuant to Part 15 of the FCC Rules. These limits are designed to provide reasonable protection against harmful interference in a residential installation. This equipment generates uses and can radiate radio frequency energy and, if not installed and used in accordance with the instructions, may cause harmful interference to radio communications. However, there is no guarantee that interference will not occur in a particular installation. If this equipment does cause harmful interference to radio or television reception, which can be determined by turning the equipment off and on, the user is encouraged to try to correct the interference by one or more of the following measures:

- Reorient or relocate the receiving antenna.
- Increase the separation between the equipment and receiver.
- Connect the equipment into an outlet on a circuit different from that to which the receiver is connected.
- Consult the dealer or an experienced radio/ TV technician for help.

This device complies with part 15 of the FCC Rules. Operation is subject to the following two conditions:

- (1) This device may not cause harmful interference, and (2) this device must accept any interference received, including interference that may cause undesired operation.

Changes or modifications not expressly approved by the party responsible for compliance could void the user's authority to operate the equipment

Quick Start

Power on/Power off

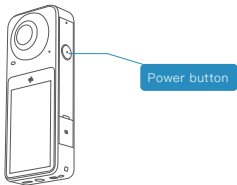

1. When Pilot Pano is powered off, press and hold the power button for 3s to power on.
2. When Pilot Pano is powered on, press the power button for 1s to set the screen on or screen off.
3. When Pilot Pano is powered on, press and hold the power button for 3s, select power off to turn off the camera.

Features (Interface)

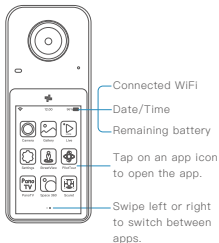

Specifications

Items	Parameters
Image sensor	Sony IMX577*2
Lens	200°/F2.0 fisheye lens*2
Screen	3.0" 800*480
Photo resolution	5.7K (5760*2880)
Video resolution	5.7K (5760*2880) 30fps 4K (3840*1920) 60fps
Storage	ROM: 32GB/Support external SD card
IMU	9 Axis
Power consumption	Max 7W
Battery	2300mAh removable LiPo battery Support batteryless mode Video: 5.7K@30fps—2H Live: 4K@30fps—1H

Items	Parameters
Internet	WiFi: 802.11b/g/n/ac 80MHz 2*2 MU-MIMO WiFi
Microphone	Built-in 4 mic, support 4-channel PCM simultaneous recording, support external stereo mic
Indicator	RGB LED Indicator
Temperature	Working Temperature: 0~40°C (32~104°F) Storage Temperature: -20~60°C (-4~140°F)
Dimensions	138*54.5*23.5mm
Input	PD 18W
Weight	About 295g (10.41 ounces)
Bluetooth version	BT 5.1

认识 Labpano Pilot Pano 全景相机（简体中文）



Pilot Pano*1



Type-C USB 数据线*1



擦镜布*1



转接杆*1



文档资料（本手册，保修卡等）

产品概述

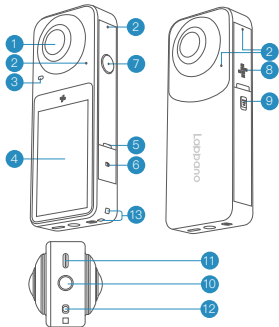

- | | |
|--------------|------------------|
| 1 镜头*2 | 8 扬声器 |
| 2 麦克风*4 | 9 电池盖拨钮 |
| 3 状态指示灯 | 10 标准1/4英寸螺口 |
| 4 3.0英寸高清触摸屏 | 11 Type-C USB 接口 |
| 5 存储卡保护盖 | 12 3.5mm麦克风接口 |
| 6 存储卡卡槽 | 13 挂绳孔 |
| 7 电源键 | |

使用前准备

1. 首次使用相机时，请放入电池并确保电池电量充足。
2. 请使用随附的充电线连接机身底部的USB Type-C接口，对相机进行充电。

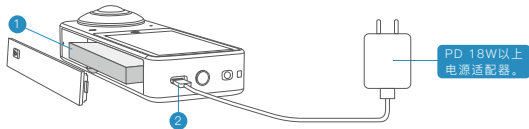

3. 插入存储卡

a. 拨开存储卡保护盖。

b. 插入存储卡。（标签朝向相机有屏幕一侧）

注意事项：

(1) 机内有15G可用内存空间，可选择插入存储卡。

(2) 请使用exFAT格式的TF存储卡，速度过低可能导致无法正常录像。当您在本相机上首次使用存储卡时，请用本相机对该卡进行格式化，以确保存储卡的稳定性能。

c. 可用拇指轻微移动确保保护盖完全锁紧，否则将影响整机的防水防尘性能。

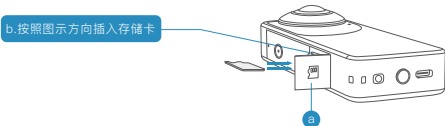

快速入门

开机/关机

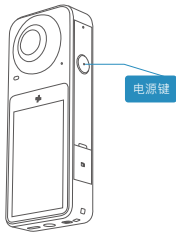

关机时，长按右侧电源键3秒，相机开机。
开机时，按压右侧电源键1秒，相机熄屏/亮屏。
开机时，长按右侧电源键3秒，出现关机菜单，选择关机。

相机功能（主界面）



规格参数

项目	规格参数
图像传感器	索尼IMX577*2
镜头	200°/F2.0鱼眼镜头*2
屏幕	3.0英寸；分辨率：800*480
全景照片分辨率	5.7K (5760*2880)
全景视频分辨率	5.7K (5760*2880) 30fps 4K (3840*1920) 60fps
存储	ROM: 32GB/支持外部存储卡
IMU	9轴
功耗	Max 7W
电池	2300mAh可更换锂聚合物电池 支持无电池模式 视频5.7K@30fps—2小时 直播4K@30fps—1小时

项目	规格参数
网络	WiFi: 802.11b/g/n/ac 80MHz 2*2 MU-MIMO WiFi
麦克风	内置4个麦克风, 支持4路PCM同步录制 可外接立体声麦克风
指示灯	RGB LED指示灯
工作温度	使用温度范围: 0~40℃ (32~104°F) 保存温度范围: -20~60℃ (-4~140°F)
尺寸	138*54.5*23.5mm
电源输入	PD 18W
重量	约295克 (10.41盎司)
蓝牙版本	BT 5.1