



WIRELESS EARPHONES (MODEL: 382)  
USB WIRELESS TRANSCIVER (MODEL: RC30-0403)  
IMPORTANT PRODUCT INFORMATION GUIDE

---

## WHAT'S INSIDE

- WIRELESS EARPHONES (MODEL: 382)

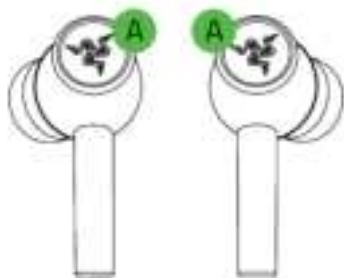

A. Backlit function button Powered by Razer Chroma™ RGB

- Charging case

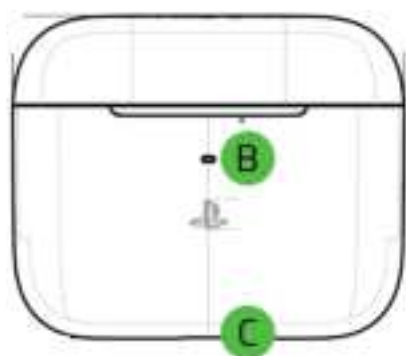

B. Status indicator

C. USB Type C charging port

- USB Type C wireless dongle



- USB Type A to USB Type C charging cable

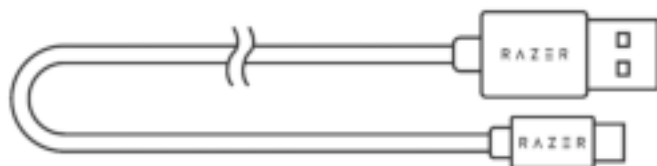

- USB Type A to USB Type C adapter cable

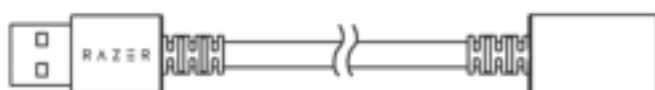

- Silicon ear-tips in 3 sizes (S, M\*, L)



*\*Pre-installed with the earbuds.*

- Important Product Information Guide

---

## WHAT'S NEEDED

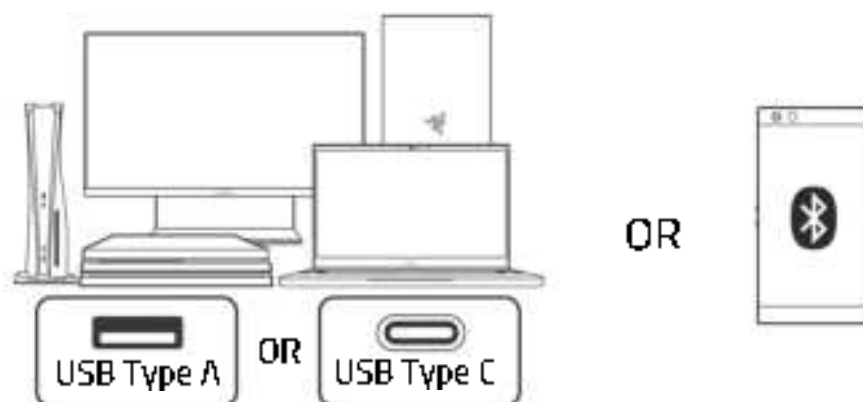

- i** *Compatible with PS5™ consoles, PS4™ consoles, PC, Mac (Bluetooth only), smartphones, tablets, and handheld gaming devices. PC compatibility not tested nor endorsed by Sony Interactive Entertainment.*

---

## LET'S GET YOU COVERED

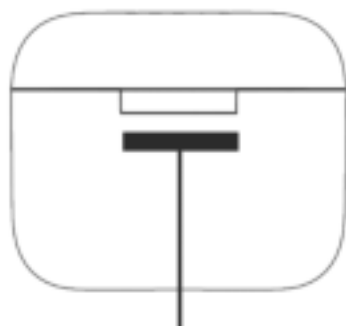

*Your product's serial number can be found here.*



Register your product and score exclusive benefits  
**[razerid.razer.com/warranty](https://razerid.razer.com/warranty)**

## SETTING UP YOUR WIRELESS EARPHONES

### CHARGING YOUR EARBUDS

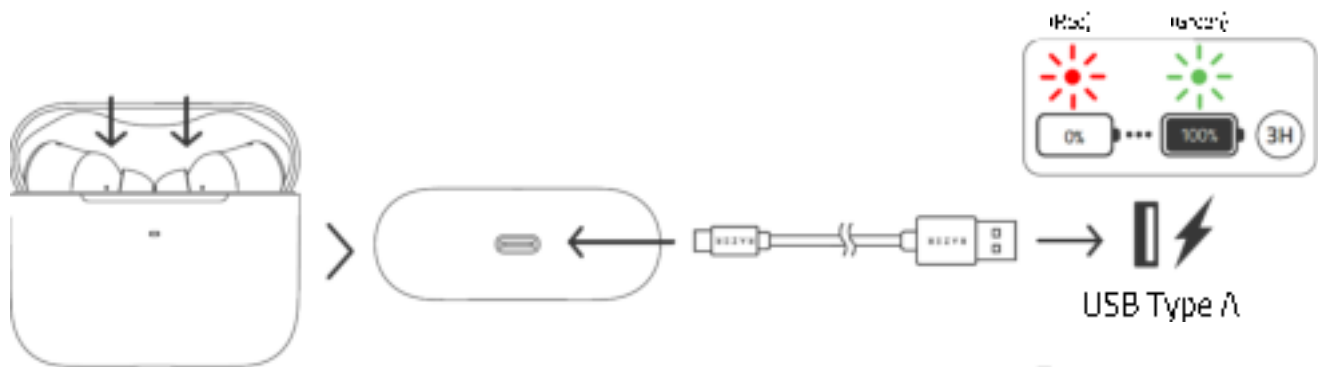

### CONNECTING TO YOUR EARBUDS

#### A. Via Bluetooth

1

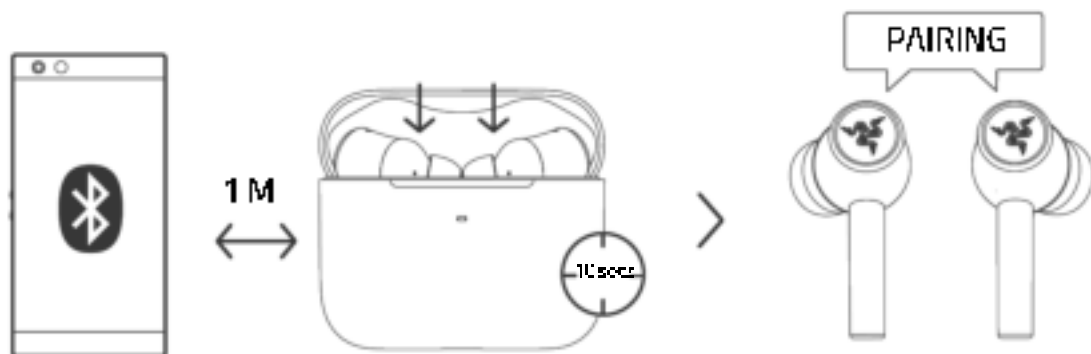

*When trying to connect your Razer product, remember to keep it within 1 meter of your mobile device. By default, the earbuds will first search for the USB Type C wireless dongle before activating pairing mode.*

2



3.

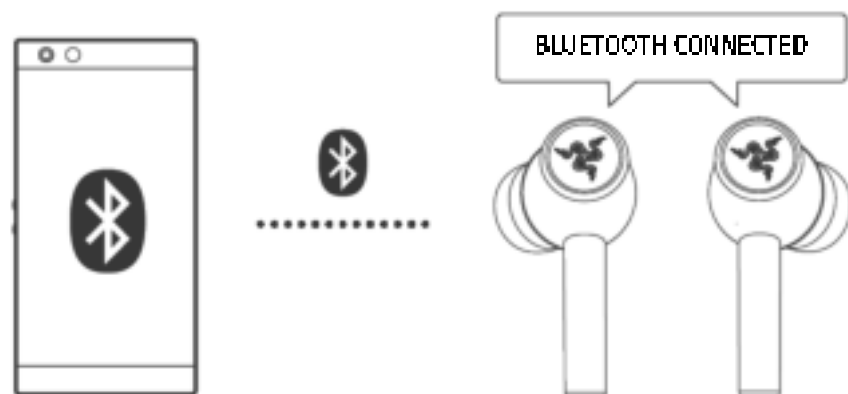

*If the earbuds fail to connect to your device, the earbuds will stay in search mode then power off after 3 minutes. If this happens, place the earbuds back inside the charging case and repeat the steps above.*

## B. Via USB Type C wireless dongle (2.4GHz)

1

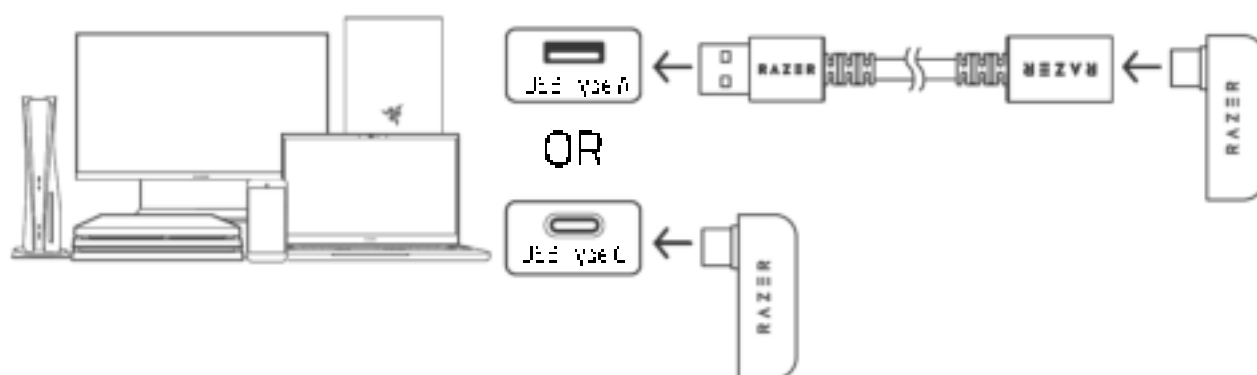

### On PS5™ consoles

PS5 Settings > Sound	Audio Output > Output device > Razer Hammerhead HyperSpeed 2.4
	Microphone > Input device > Razer Hammerhead HyperSpeed 2.4

### On PS4™ consoles

PS4 Settings > Devices > Audio Devices	Audio Output > Output device > Razer Hammerhead HyperSpeed 2.4
	Microphone > Input device > Razer Hammerhead HyperSpeed 2.4

## On PC

Sound settings	Output > Razer Hammerhead HyperSpeed 2.4
	Input > Razer Hammerhead HyperSpeed 2.4

3.

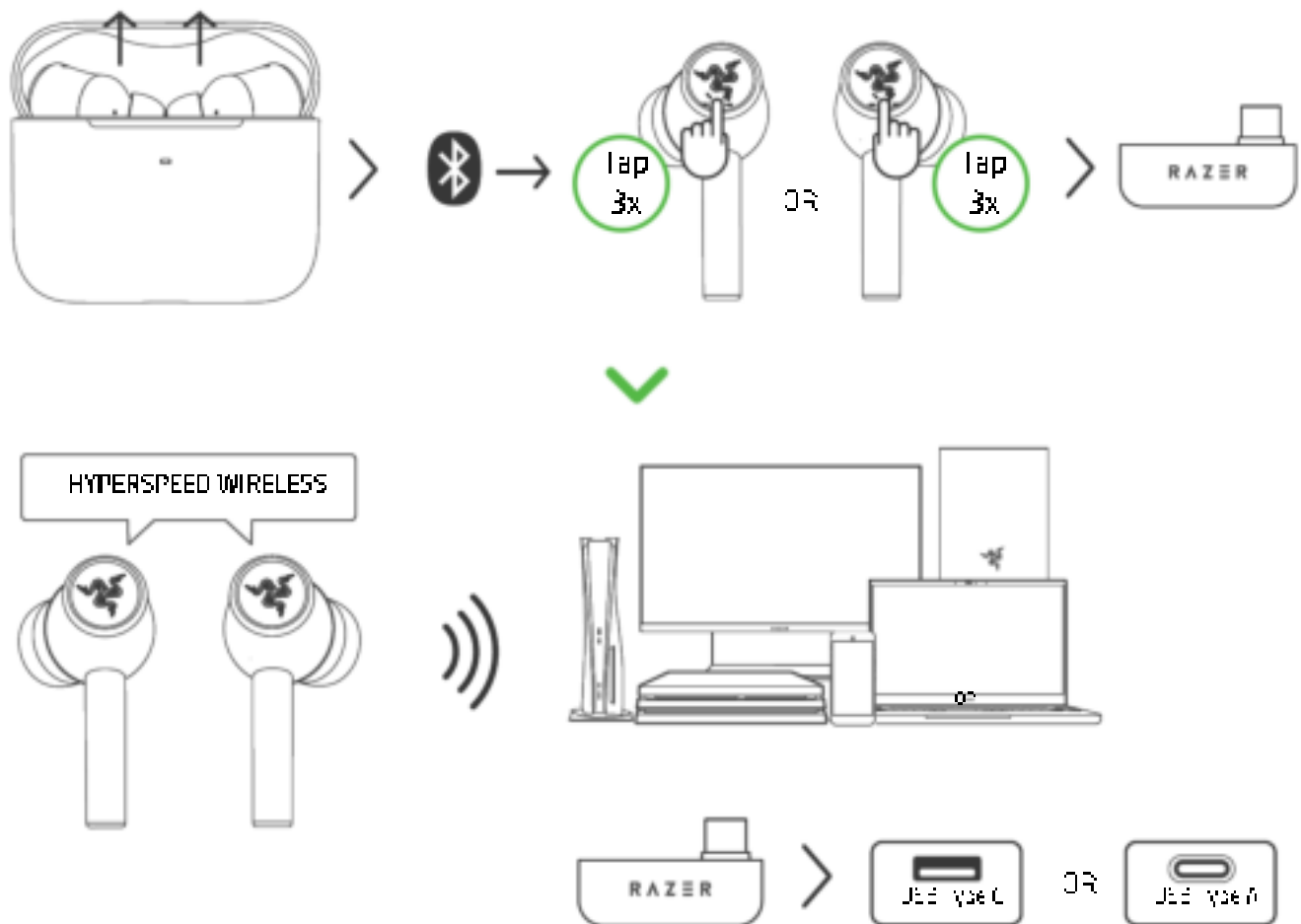

**i** When using the earbuds with a compatible device, set **Razer Hammerhead HyperSpeed (2.4)** as the default input and output device (if applicable).

## SWITCHING BETWEEN AUDIO SOURCES

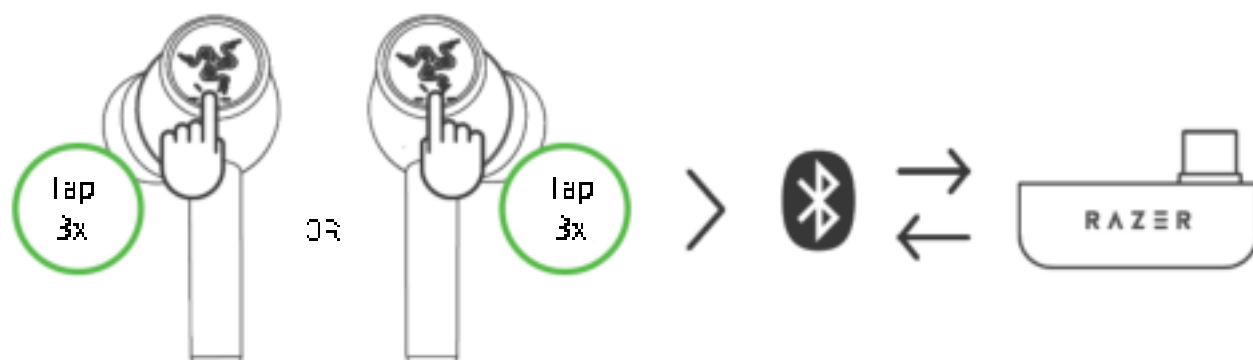

---

## PERSONALIZE YOUR MOBILE EXPERIENCE

### RAZER AUDIO APP (MOBILE)

Remap touch gestures, toggle Do Not Disturb to block incoming calls while gaming, customize EQ settings, and even experience full RGB lighting customization from your mobile device.



Razer Audio

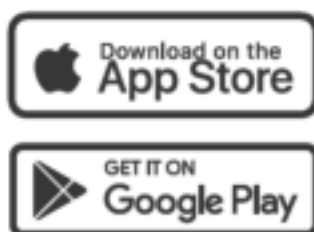

OR

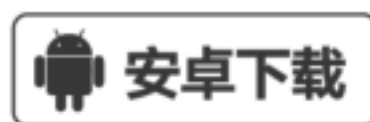

RZR.TO/AUDAPP  
(For China Only)

 Only available on iOS 13 / Android 10 (or higher) devices with Bluetooth 5.0 connectivity

Find out more about your cross-platform wireless earbuds at [support.razer.com](https://support.razer.com)

---

## SAFETY AND MAINTENANCE

### SAFETY GUIDELINES

To achieve maximum safety while using your WIRELESS EARPHONES, we suggest that you adopt the following guidelines:

Should you have trouble operating the device properly and troubleshooting does not work, unplug the device and contact the Razer hotline or go to [support.razer.com](https://support.razer.com) for assistance.

Do not take apart the device and do not attempt to operate it under abnormal current loads. Doing so will void your warranty.

Operate the device only within the specific temperature range of 0°C (32°F) to 40°C (104°F). Should the temperature exceed this range, unplug and/or switch off the device to let the temperature stabilize to an optimal level.

Your earbuds isolate external ambient sounds even at low volumes, resulting in lowered awareness of your external surroundings. Please remove the earbuds when engaging in activities that require active awareness of your surroundings.

Listening to excessively loud volumes over extended periods can damage your hearing. Furthermore, legislation of certain countries permits a maximum sound level of 85db to affect your hearing for 8 hours a day. We, therefore, recommend that you reduce the volume to a comfortable level when listening for prolonged periods. Please, take good care of your hearing.

### MAINTENANCE AND USE

The WIRELESS EARPHONES requires minimum maintenance to keep it in optimum condition. Once a month we recommend you clean it using a soft cloth or cotton swab to prevent dirt buildup. Do not use soap or harsh cleaning agents.



---

## LEGAL

### COPYRIGHT AND INTELLECTUAL PROPERTY INFORMATION

©2022 Razer Inc. All rights reserved. Razer, the triple-headed snake logo, Razer logo, "For Gamers. By Gamers." and "Razer Chroma" are trademarks or registered trademarks of Razer Inc. and/or affiliated companies in the United States and other countries. Actual product may differ from pictures. All other trademarks are the property of their respective owners. Warranty not valid outside of product's intended region.

Android, Google, Google Logo, Google Play, and the Google Play logo are trademarks of Google LLC.

Apple, the Apple logo, and iPhone are trademarks of Apple Inc., registered in the U.S. and other countries. App Store is a service mark of Apple Inc.

"PS", "PlayStation", "PS5", and "PS4" are registered trademarks of Sony Interactive Entertainment Inc. All rights reserved. Manufactured and distributed under license from Sony Interactive Entertainment.

The Bluetooth® word mark and logos are registered trademarks owned by Bluetooth SIG, Inc., and any use of such marks by Razer is under license.

Windows and the Windows logo are trademarks of the Microsoft group of companies.

Razer Inc. ("Razer") may have copyright, trademarks, trade secrets, patents, patent applications, or other intellectual property rights (whether registered or unregistered) concerning the product in this guide. Furnishing of this guide does not give you a license to any such copyright, trademark, patent or other intellectual property right. The WIRELESS EARPHONES (the "Product") may differ from pictures whether on packaging or otherwise. Razer assumes no responsibility for such differences or for any errors that may appear. Information contained herein is subject to change without notice.

### LIMITED PRODUCT WARRANTY

For the latest and current terms of the Limited Product Warranty, please visit [razer.com/warranty](https://www.razer.com/warranty).

### LIMITATION OF LIABILITY

Razer shall in no event be liable for any lost profits, loss of information or data, special, incidental, indirect, punitive or consequential or incidental damages, arising in any way out of distribution of, sale of, resale of, use of, or inability to use the Product. In no event shall Razer's liability exceed the retail purchase price of the Product.

## GENERAL

These terms shall be governed by and construed under the laws of the jurisdiction in which the Product was purchased. If any term herein is held to be invalid or unenforceable, then such term (in so far as it is invalid or unenforceable) shall be given no effect and deemed to be excluded without invalidating any of the remaining terms. Razer reserves the right to amend any term at any time without notice.



## STATEMENT OF COMPLIANCE WITH EU DIRECTIVE

### ENGLISH

#### STATEMENT OF COMPLIANCE WITH EU DIRECTIVE

Hereby, Razer (Europe) GmbH, declares that this Wireless earphones model: 382 is in compliance with the essential requirements and other relevant provisions of Directive 2014/53/EU and 2015/865/EU.

#### **Wireless earphone (Left):**

Radio Frequency: Bluetooth

Operating Frequency: 2400-2483.5Mhz

Output power: <11dBm

#### **Wireless earphone (Right):**

Radio Frequency: Bluetooth

Operating Frequency: 2400-2483.5Mhz

Output power: <11dBm

### BATTERY INFO

Risk of fire or explosion or defeat the safeguard of equipment if the battery is replaced by an incorrect type. Replace only with the same or equivalent type. Disposal of a battery into fire or a hot oven, or mechanically crushing or cutting of a battery, that can result in an explosion. High or low extreme temperatures or low air pressure at high altitude that the battery can be subjected to during use, storage or transportation. Leaving the battery in an extremely high temperature and/or low air pressure surrounding environment that can result in an explosion or the leakage of flammable liquid or gas.



### EU PRODUCT AND BATTERY DISPOSAL INFORMATION

#### BATTERY WARNING

The wireless earphones and charging case contains Li-ion rechargeable batteries. In general, the life expectancy of such batteries is dependent upon usage. If you suspect that the Li-ion rechargeable battery inside the wireless earphones and charging case may be drained (has a low charge), try charging it. Caution: Do not open, mutilate, or expose to conducting materials (metal), moisture, liquid, fire, or heat. Doing so may cause batteries to leak or explode, resulting in personal injury. Do not leave the rechargeable batteries discharged or unused for extended periods. Battery life varies with usage.



## **WASTE ELECTRICAL AND ELECTRONIC EQUIPMENT INFORMATION**

Correct Disposal of This Product (Waste Electrical & Electronic Equipment) (Applicable in the European Union and other European countries with separate collection systems) This marking shown on the product or its literature, indicates that it should not be disposed with other household wastes at the end of its working life. To prevent possible harm to the environment or human health from uncontrolled waste disposal, please separate this from other types of wastes and recycle it responsibly to promote the sustainable reuse of material resources. Household users should contact either the retailer where they purchased this product, or their local government office, for details of where and how they can take this item for environmentally safe recycling. Business users should contact their supplier and check the terms and conditions of the purchase contract. This product should not be mixed with other commercial wastes for disposal.

**FCC CAUTION STATEMENT**

This device complies with Part 15 of the FCC Rules. Operation is subject to the following two conditions:

- (1) this device may not cause harmful interference, and
- (2) this device must accept any interference received, including interference that may cause undesired operation.

Any changes or modifications not expressly approved by party responsible for compliance could void the user authority to operate this equipment.

**IMPORTANT NOTE:****FCC Radiation Exposure Statement:**

This equipment complies with FCC radiation exposure limits set forth for an uncontrolled environment. End users must follow the specific operating instructions for satisfying RF exposure compliance. This transmitter must not be co-located or operating in conjunction with any other antenna or transmitter.

**CANADA SAR**

This transmitter must not be co-located or operating in conjunction with any other antenna or transmitter. This equipment should be installed and operated with a minimum distance of 0mm between the radiator and your body.

Cet émetteur ne doit pas être Co-placé ou ne fonctionnant en même temps qu'aucune autre antenne ou émetteur. Cet équipement devrait être installé et actionné avec une distance minimum de 0mm entre le radiateur et votre corps.

**NOTICE FOR CANADA**

This Class B digital apparatus complies with Canadian ICES-003. Cet appareil numérique de la classe B est conforme à la norme NMB-003 du Canada.

**Caution!**

Any changes or modifications not expressly approved by the party responsible for compliance could void the user's authority to operate the equipment.

This transmitter must not be co-located or operating in conjunction with any other antenna or transmitter. This equipment should be installed and operated with a minimum distance of 0mm between the radiator and your body.

Cet émetteur ne doit pas être Co-placé ou ne fonctionnant en même temps qu'aucune autre antenne ou émetteur. Cet

équipement devrait être installé et actionné avec une distance minimum de 0mm entre le radiateur et votre corps.

**CANADIAN CLASS B STATEMENT:**

This device complies with Industry Canada's licence-exempt RSSs. Operation is subject to the following two conditions:

- (1) This device may not cause interference; and
- (2) This device must accept any interference, including interference that may cause undesired operation of the device.

**RADIATION EXPOSURE STATEMENT:**

The product comply with the Canada portable RF exposure limit set forth for an uncontrolled environment and are safe for intended operation as described in this manual. The further RF exposure reduction can be achieved if the product can be kept as far as possible from the user body or set the device to lower output power if such function is available.



201-220551

## Product registration numbers:

FCC ID: RWO-382XP

IC: 8092D-382XP

HVIN: 382XP