

DREO

Smart Air Purifier
Macro AP505S

USER MANUAL

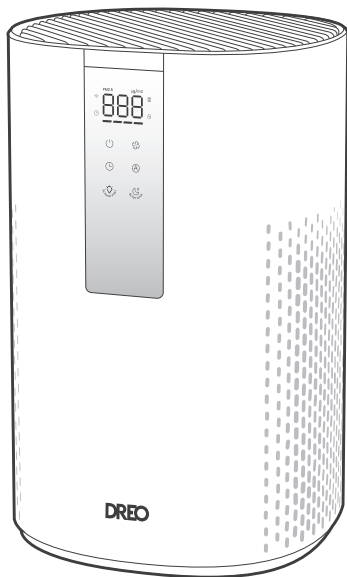

//

Thanks for Choosing **DREO!**

Your support means the world to us. We hope you enjoy our product as much as we did creating it.

EXTEND YOUR WARRANTY FOR FREE

Scan or visit [**dreocom.com/warranty**](https://dreocom.com/warranty)

To extend your warranty for free by registering your product.
If you have any product issues, we always stand ready to help.



(888) 290-1688

Mon - Fri, 9:00 am-5:00 pm PST/PDT



[**support@dreocom.com**](mailto:support@dreocom.com)



[**www.dreocom.com**](https://www.dreocom.com)

Find the digital version of this manual at
[**support.dreocom.com/en/support/product**](https://support.dreocom.com/en/support/product)

CONTENT

01

IMPORTANT SAFETY
INSTRUCTIONS

1-3

02

KNOWING YOUR
APPLIANCE

4

03

USING YOUR
APPLIANCE

5-8

04

CONNECTING TO YOUR
APPLIANCE

9

05

CLEANING AND
MAINTENANCE

10-11

06

TROUBLESHOOTING

12-14

07

DREO CUSTOMER
CARE

15-17

IMPORTANT SAFETY INSTRUCTIONS

01



READ ALL CAUTION-
ARY MARKINGS ON
THE APPLIANCE AND
SAFETY INSTRU-
CTIONS IN THE USER
MANUAL BEFORE USE.

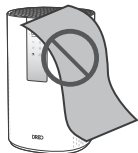

WARNING:

In order to avoid
overheating, do not
cover the appliance.

Do not use the
appliance near
flammables and
combustibles.

General Safety

1. Use the appliance as described in the user manual only. Any other use not recommended in the user manual may cause fire, electrical shock, or personal injury.
2. Children shall not play with the appliance. Cleaning and maintenance shall not be performed by children without supervision.
3. This appliance can be used by children aged above 8 years and persons with reduced physical, sensory or mental capabilities or lack of experience and knowledge if they have been given supervision or instruction concerning use of this appliance in a safe way and understand the hazards involved.

Location Safety

1. Always place the appliance on a level, stable and dry surface.
2. Keep the appliance away from heat sources to avoid fire hazards.
3. Do not place the appliance in excessively humid environments.
4. Do not place the appliance directly on or against soft furnishings such as beddings or curtains. Doing so could cause blockage of the openings.
5. Do not use the appliance outdoors, or in toxic or explosive environments, or where flammable or combustible gases are present.
6. Allow at least 15" / 38 cm of clearance on all sides of the appliance.

Operation Safety

1. Do not immerse in water and any other liquids.
2. Do not plug in or operate the appliance with wet hands.
3. Do not sit, stand or place heavy objects on the appliance.
4. Do not insert your fingers, pencil and any other objects into any openings.
5. Do not attempt to repair or modify any electrical or mechanical functions on the appliance. Doing so will void your warranty. All servicing should be performed by qualified personnel only.

Electricity Safety

1. Make sure that the voltage of your electricity supply is the same as that indicated on the appliance.
2. Always unplug before cleaning or leaving the appliance unused for a long period of time. Keep your hands dry when plugging/unplugging.
3. Do not operate this appliance with a damaged cord or plug. Discard this appliance or return to an authorized service facility for examination and/or repair.
4. Do not run cord under carpeting. Do not cover cord with throw rugs, runners, or similar coverings. Do not route cord under furniture or appliances. Keep the cord out of areas where people walk often. Place the cord where it will not be tripped over.
5. To avoid fire or shock hazard, plug the appliance directly into a wall outlet.
6. **WARNING:** To Reduce The Risk Of Fire, Electric Shock Or Injury To Persons, Do Not Use Replacement Parts That Have Not Been Recommended By The Manufacturer (e.g. Parts Made At Home Using A 3D Printer).
7. **WARNING:** To Reduce The Risk Of Fire Or Electric Shock, Do Not Use This Fan With Any Solid-State Speed Control Device.
8. This appliance has a polarized plug (one blade is wider than the other). To reduce the risk of electric shock, this plug is intended to fit in a polarized outlet only one way, If the plug does not fit fully in the outlet, reverse the plug. If it still does not fit, contact a qualified electrician. Do not attempt to defeat this safety feature.

FOR HOUSEHOLD USE ONLY

READ AND SAVE THESE INSTRUCTIONS

Gentle Reminder:



Check the appliance regularly and refer to TROUBLESHOOTING or contact our customer support if it shows any of the following signs:

- Power cord or plug is damaged.
- Loud noise, unusual smell or excessive heat.

Specifications

Model No.	DR-HAP005S
Input	120V~60Hz 17.5W
Weight	5.82lb / 2.64kg

KNOWING YOUR AIR PURIFIER

02

Package Contents

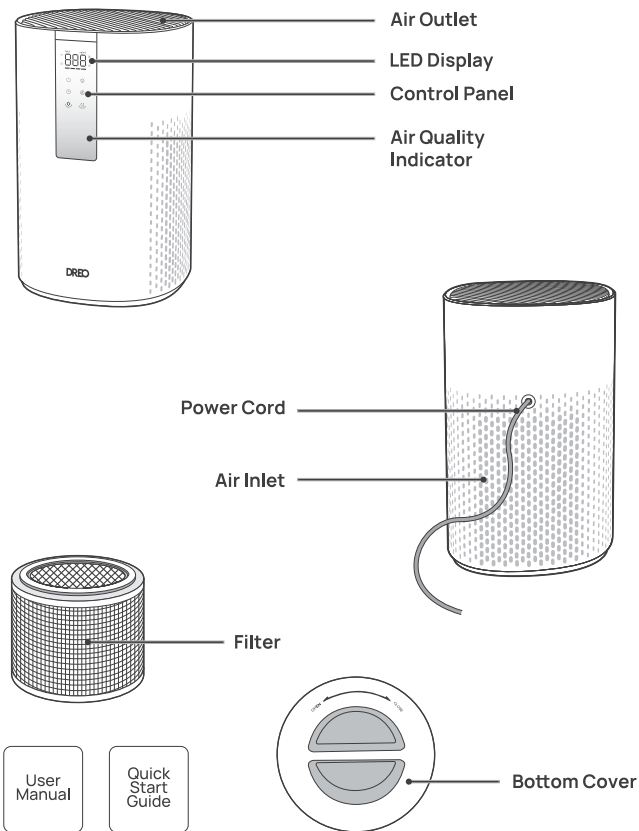

USING YOUR AIR PURIFIER

03

Before Use

1

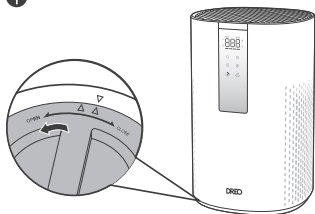

Put it upside down. Rotate the bottom cover to unlock and take the cover off.

2

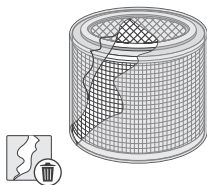

Remove the filter from its packaging then put the filter back.

3

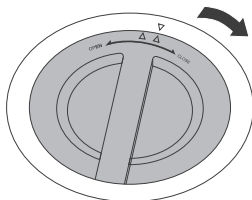

Press and rotate the bottom cover clockwise to lock back in place.

4

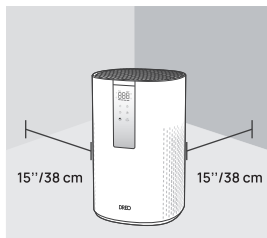

Return to upright position on a flat, stable, and clear surface.

Control Panel



Power Button

- Turn power on/off.
- Long press for 10 seconds to restore factory settings.



Fan Speed Button

- Adjust fan speed across levels 1-2-3-4.



Timer Button

- Select to set a timer (0-12H).
- Note:** The timer hour is shown on the LED display.



Auto Mode Button / WiFi Connection (5s)

- Purify and adjust fan speed automatically based on air quality conditions.
- Long press for 5 seconds to start WiFi connection settings.



RGB Light Button / Filter Reset (5s)

- Touch to turn the RGB light and display on/off.
- Long press for 5 seconds to reset the filter change reminder.



Sleep Mode Button / Child Lock (3s)

- Touch to purify the air at the most silent power setting.
- Long press for 3 seconds to activate/deactivate the child lock function.

Note: Long press ⏸ and ⏻ for 10 seconds to turn off/on WiFi connection and enter/exit Low Power Standby Mode.

LED Display

Constantly monitor the air quality in your room with the comprehensive and intuitive monitor display.

Note: You can turn off the LED display and lights in the DREO App.

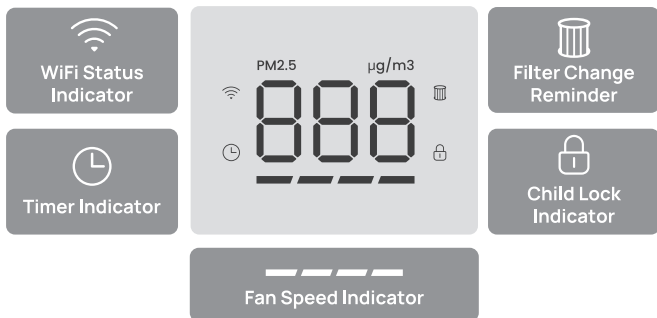

Air Quality Indicator Light



Light Color	Air Quality Level
Blue	Excellent
Green	Good
Orange	Moderate
Red	Poor

Note: The Air Quality Sensor detects PM 2.5 particles but cannot detect odors. If you feel that the indoor air odor is relatively strong, it is recommended to manually open the highest fan speed.

Additional Features



Child Lock

- Long press  for 3 seconds to activate/deactivate the child lock function.
- When activated, the  on the display will light up, and all the buttons on the appliance will be locked.



On/Off Timer

- When the appliance is ON/OFF, touch the timer button repeatedly to set a timer (from 0-12H) for the appliance to turn ON/OFF.



Memory

If the appliance is turned OFF or disconnected from power, it will operate under the previous settings (except the Child Lock function/timer setting) when it is turned ON again.



Display turns off after 5 seconds in Sleep Mode. Wake up the display with any button.

Getting the Most Out of Your Air Purifier



1. Keep the doors and windows closed when the air purifier is on.
2. Do not block the air openings and keep away from curtains or walls.
3. Maintain and replace the filters on a regular basis for maximum efficiency.

CONNECTING TO YOUR APPLIANCE

04



Before connecting the appliance to your mobile device, please scan the QR code on the left or go to the app store and search “**DREO**”, then select and download the app.



Download on the
App Store



GET IT ON
Google Play

Look for “**Macro AP505S**” when connecting your new appliance.



You can use the DREO app to connect your appliance to **Amazon Alexa** or **Google Home**. Please follow the in-app instructions to set up your voice assistant.

NOTE: You must create a DREO account to access voice assistants.

- 1 Launch DREO and sign in or create account by following in-app instructions.
- 2 Enable Bluetooth on your mobile device and plug in your appliance.
- 3 Hold the Auto Mode button (A) for 5 seconds to start WiFi connection settings.
(TIP: The WiFi indicator will keep flashing when pairing.)
- 4 Tap+ **Add Device** and select **Macro AP505S**.
- 5 Follow in-app instructions to complete WiFi connection.
- 6 You're now ready to control the appliance on your app.
(Tip: To restart connection settings, hold the Auto Mode button (A) again for 5 seconds.)

CLEANING AND MAINTENANCE

05

Replacing the Filter

The filter life is measured by the air purifier's algorithm which is based on the working mode, fan speed, run time, and indoor air quality. It's recommended to replace the filter every 6-8 months or when the filter change reminder alerts.

1



The Filter Change Reminder will flash when the filter needs to be replaced. Turn off and unplug the air purifier.

2

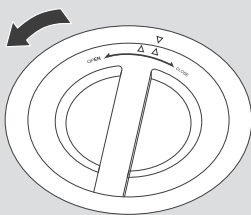

Rotate the bottom cover to unlock then take the cover off.

3

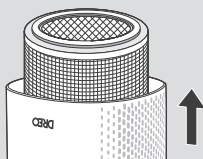

Remove the old filter then put the new filter in place.

4

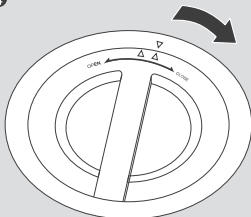

Press and rotate the bottom cover clockwise to lock in place.

5

Return to upright position and long press the  for 5 seconds until it beeps, to reset the filter change reminder.

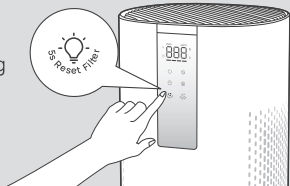

Cleaning the Inside & Outside

1

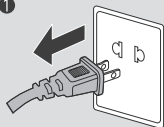

Unplug the air purifier before any cleaning and maintenance.

2

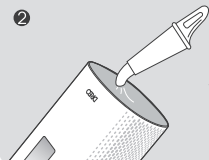

Remove the filter and clean the inside with a dust vacuum.

3



Wipe clean the housing with a dry, soft, non-abrasive cloth.

Cleaning the Filter

- For optimal use, the outer pre-filter can be cleaned with a soft, dry brush once every 2-4 weeks.
- Keep away from water and humid areas. Moisture will allow mold to grow.

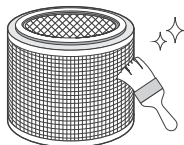

TROUBLESHOOTING 06

Related to Filter

Where can I buy a new filter?

Please purchase from DREO official website: www.dreo.com.

I changed the filter, but the Filter Change Reminder is still on.

The Filter Change Reminder will not automatically reset. Please press and hold the  Filter Reset button to reset the reminder, the indicator will turn off after reset.

The Filter Change Reminder has not turned on for a long period of time.

There are several factors that can impact the filter life, including the indoor air quality level, length of operation and particle density in the air. If your room has a better air quality level and/or you don't use your air purifier often, the reminder will take.

Related to Use

Why is my air purifier not working?

Check if the power is connected, the power cord is damaged, or the electrical outlet is powered.

The airflow from my air purifier is too weak.

- Make sure that there is enough space around the air purifier.
- Check if the filter packaging has been removed.
- Fan speed will be low when auto mode is switched on and air quality is good. Try to switch to higher speed.
- Replace the filter if the filter is clogged and overloaded.

My air purifier doesn't improve the air quality.

- Check if the filter packaging has been removed.
- Use within 183 ft² areas for optimal air refresh rate (4.8X air changes per hour).
- Make sure the windows are closed as polluted air may continue coming in from outside of the windows.
- The overloaded filter will make the fan work harder to pass the air through. Consider replacing the filter if it is clogged.
- Do not place in crowded areas and corners.
- Check if air outlet and inlet are obstructed.

Why is my air purifier making a loud noise?

- Switch the air purifier to sleep mode or lower fan speeds.

Why is the Air Quality indicator is always red?

- It's recommended to move the appliance to a different location, replug it, and check the indicator light again. If the issue persists, please contact our Customer Support.

The odor in the room is very strong, but the Air Quality Indicator is only green or blue.

- The Air Quality Sensor detects PM 2.5 particles but cannot detect odors. If you feel that the indoor air odor is relatively strong, it is recommended to manually open the highest fan speed.

Why is the Air Quality indicator always blue?

- The Air Quality sensor reports the presence of airborne particles, but it cannot detect gas. Please make sure there is no gas contamination inside your room.

Why is my air purifier making an unusual noise?

- Make sure the air purifier is operating on a flat, stable surface.
- Do not add essential oils or diffusers into the air purifier or use in a excessively humid area. Humidity will cause mold to grow.
- If the unusual noise still exists, there may be external objects blocking the air openings. Please contact our customer support.

Why does my air purifier produce an unpleasant smell?

- During the initial few days, new air purifiers produce a plastic smell which is normal and will dissipate eventually.
- Do not add essential oils or diffusers into the air purifier or use in a excessively humid area. Humidity will cause mold to grow.
- If the filter has absorbed pollutants to its maximum capacity, then the smell may come from the dirty filter. Please replace the filter when necessary.

If your problem is not listed or still persists, contact our Customer Support (see page 17).

DREO CUSTOMER CARE

07

Default 12-Month Warranty

This appliance is covered by DREO warranty for 12 months from the date of its original purchase.

Extend Your Warranty

Extend your warranty by registering your new appliance on our website <https://dreocom/warranty>.

The warranty will not apply in cases of:

1. Accident, misuse, or repairs performed by unauthorized personnel.
2. Any unit that has been tampered with or used for commercial purposes.
3. Normal wear and tear of wearable parts.
4. Use of force, damage caused by external influences.
5. Damage caused by non-observance of the User Manual, e.g. connection to an unsuitable mains supply or noncompliance with the instructions.
6. Partially or completely dismantled appliances.
7. Defects caused by or resulting from damages from shipping or from repairs, service, or alteration to the product or any of its parts that have been performed by a repair person not authorized by DREO.

We can only provide after-sales service for products that are sold by DREO or DREO authorized retailers and distributors. If you have purchased the appliance from a different place, please contact your seller for return and warranty issues.

FCC Statement

This device complies with Part 15 of the FCC Rules. Operation is subject to the following two conditions: (1) this device may not cause harmful interference, and (2) this device must accept any interference received, including interference that may cause undesired operation.

Please note that changes or modifications of this product is not expressly approved by the party responsible for compliance could void the user's authority to operate the equipment.

NOTE: This equipment has been tested and found to comply with the limits for a Class B digital device, pursuant to Part 15 of the FCC Rules. These limits are designed to provide reasonable protection against harmful interference in a residential installation. This equipment generates, uses and can radiate radio frequency energy and, if not installed and used in accordance with the instructions, may cause harmful interference to radio communications. However, there is no guarantee that interference will not occur in a particular installation.

If this equipment does cause harmful interference to radio or television reception, which can be determined by turning the equipment off and on, the user is encouraged to try to correct the interference by one or more of the following measures:

- Reorient or relocate the receiving antenna.
- Increase the separation between the equipment and receiver.
- Connect the equipment into an outlet on a circuit different from that to which the receiver is connected.
- Consult the dealer or an experienced radio/TV technician for help.

This equipment complies with FCC radiation exposure limits set forth for an uncontrolled environment. This equipment should be installed and operated with a minimum distance of 20cm between the radiator & your body. This transmitter must not be co-located or operating in conjunction with any other antenna or transmitter.

Model No.: DR-HAP005S
Rev_1.0_EN

We're Here to Help!

 **(888) 290-1688** (Mon - Fri, 9:00 am-5:00 pm PST/PDT)

 **www.dreo.com**

 **support@dreo.com**

 Shenzhen Hesung Innovation Technology Co., LTD

 26F, Bldg A7, Creative City, Shenzhen, China



MADE IN CHINA



www.dreo.com

Looking for help?

Contact us to get expert support.



support@dreo.com



[\(888\) 290-1688](tel:(888)290-1688)



www.dreo.com

Mon - Fri, 9:00 am-5:00 pm PST/PDT