

[VTECH]

[2.4GHz Monopole Antenna]

Model: VC2105 BU

Antenna description:

This wifi antenna is optimized and used in the Baby in the baby monitor models. This antenna is directly soldered to the RF output in the main PCB.

Ordering information:

Model	Description
VC2105 BU	2.4GHz Monopole Antenna

Specification:

Operation Frequency Range	2412-2472 MHz
Maximum Gain	0 dBi
Type	Monopole
Operation bandwidth	60MHz
Nominal Impedance	~50 ohms
Connectors	-
Dimensions	(show in figure 1)
Manufacturer	Vtech Telecommunications Ltd
Manufacturer address	23/F, Tai Ping Industrial Centre, Blk1, 57 Ting Kok Road, Tai Po, Hong Kong
Model number	ANT-VC2105-F-WI-1

[VTECH]

[2.4GHz Monopole Antenna]

Antenna pattern (2436MHz) (the frequency with maximum gain)

XY plane (gain theta)

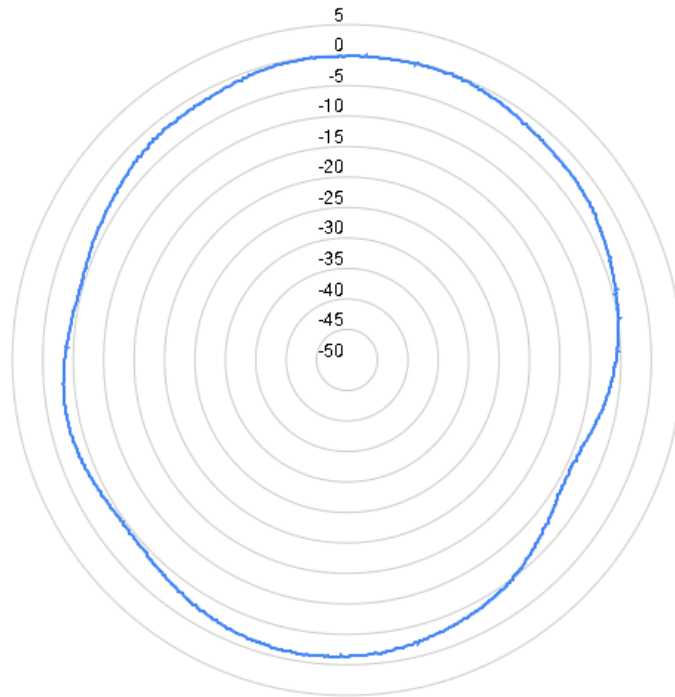

Coordination:



[VTECH]

[2.4GHz Monopole Antenna]

Physical Dimension:

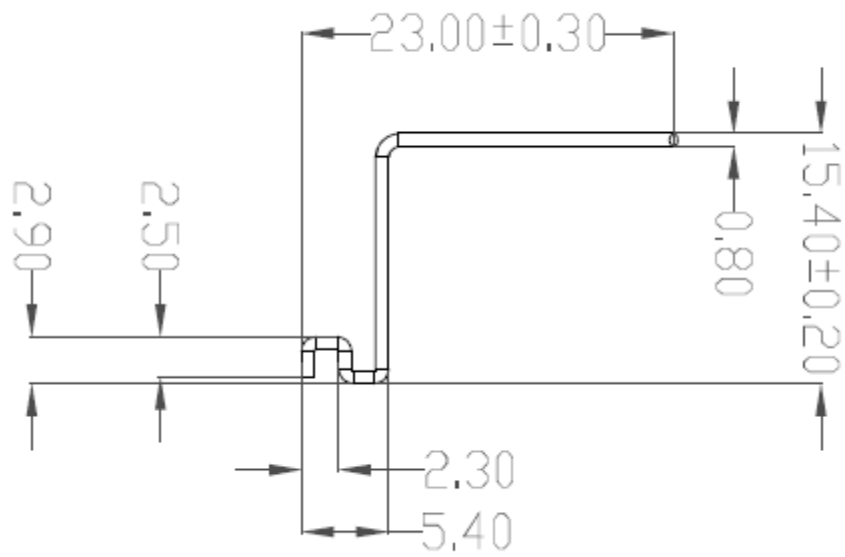

Figure 1 Physical dimension (mm)