XHC3



User's Guide

Copyright 2020. All Rights Reserved.

Document Version: 3.0

Version	Date	Changes
2.1	8 th Jul, 2021	1.Update Xfinity app setup steps 2. Correct typo and format
2.0	1 st July, 2021	Comcast made changes to images and reworded guidance
1.0	28 June, 2021	Initial Draft

Table of Contents

- CHAPTER 1 INTRODUCTION..... 1
 - Overview..... 1
 - Physical Details..... 2
 - Package Contents 4
- CHAPTER 2 BASIC SETUP 5
 - Installation..... 5
- CHAPTER 3 WALL MOUNTING10
- APPENDIX A SPECIFICATIONS.....12
 - Technical Specifications12
 - Regulatory Approvals13
 - Label Information15

Chapter 1



Introduction

Overview

XHC3 is an indoor only camera that supports full HD resolution and dual band 802.11ac Wi-Fi connectivity.

Features

- Provides 1080p HD video quality
- Supports Dual Band 2.4GHz/5GHz 802.11ac WIFI for connectivity and Bluetooth 5.0 for onboarding
- Two-way audio communication capability
- Provides black and white night vision via built-in IR LEDs

Physical Details

Front View



Figure 1: Front View

Status LED	Off.	No power or camera is paused from software app
	Solid Amber.	Camera is booting up.
	Blinking Blue.	Camera is ready to pair.
	Solid Blue.	Camera is connected to network and working normally
	Blinking Amber.	Camera has trouble connecting
Lens	The lens is designed to support full HD video and provides a wide field of view	
Light Sensor	The light sensor is used to help detect daytime and nighttime transitions to support day and night mode operation	
IR LEDs	The two IR LEDs are used to support night mode operation.	

Microphone The built-in microphone is designed to capture ambient sound and for bi-direction voice conversation.

Rear View



Figure 2: Rear View

- Power Input** Connect the included power adapter here. Do not use other power adapters; doing so may damage the camera.
- Reset Button** Gently press and hold this button for up to 10 sec and then release, the camera reboots and the settings are restored to factory default values.
- Speaker** The built-in speaker is used for voice conversation.

Package Contents

The following items are included in the package.

- XHC3 camera x 1
- Power adapter x 1
- Screw/Anchor x 1
 - Screw diameter: 3.5mm ; Length: 25mm
 - Anchor inner diameter: 2.9mm ; Length: 30mm

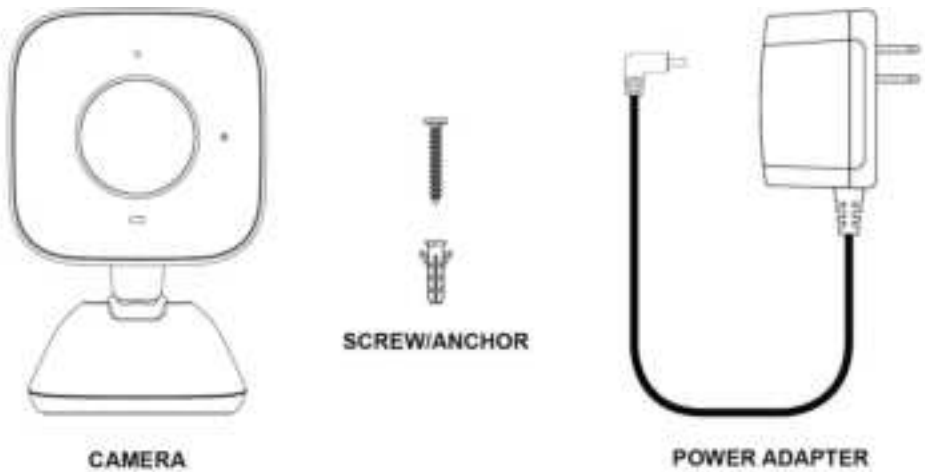

Figure 3: What's in the Box

Chapter 2

2

Basic Setup

This section provides information on how to install and setup XHC3

Installation

1. Choose a location

Choose a suitable desired location anywhere inside

2. Power Up

Plug the included power cable into to the camera and plug the power adapter into a standard power outlet.



CAUTION: Use only the power adapter provided. Using a different one can result in hardware damage.

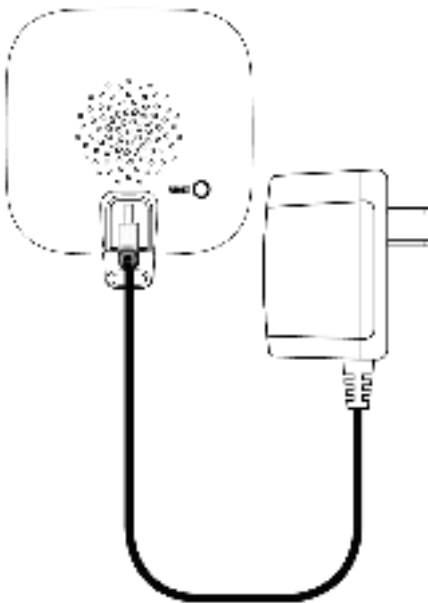

Figure 4: Power Connection

The status LED is solid amber during bootup.

3. Check the status LED

After bootup is complete, and when camera is ready to be paired, the LED is blinking blue.

4. Setup the Camera

4.1 Download the Xfinity app from the APP store or Google Play Store.

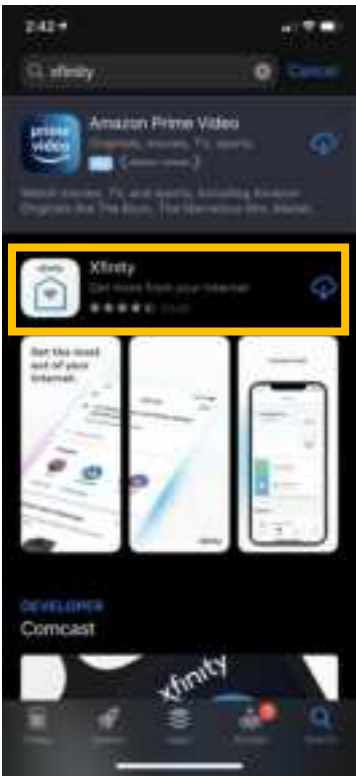

4.2 Sign in to the app with your Xfinity credentials.



4.3 Select Add a Device, then choose the Xfinity Camera to Start installing

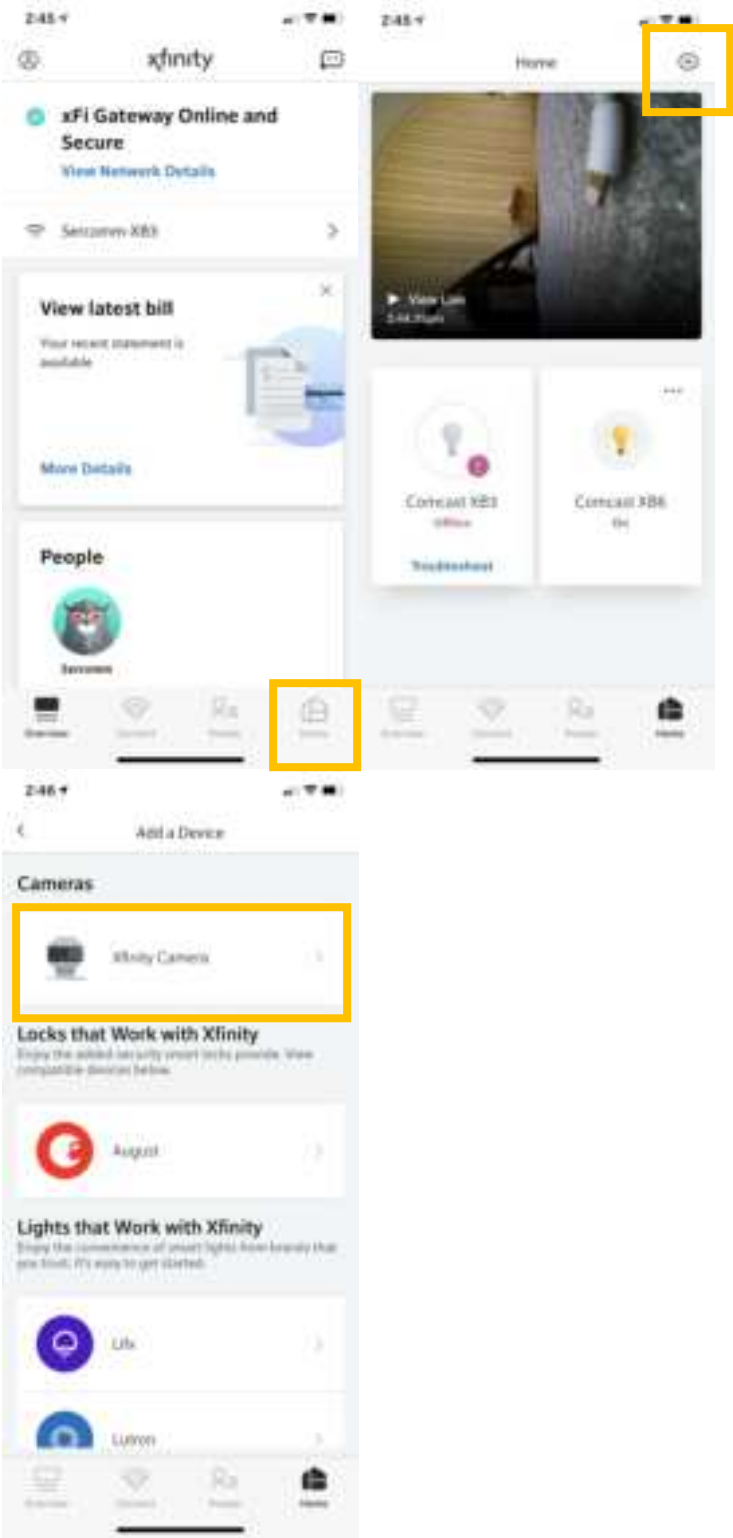

4.4 Follow the guidance in the APP to finish the onboarding process. You can also use the camera functions in the same APP after onboarding the camera

5. Mount the Camera

Place the camera in its final permanent location near a power source. For mounting on a wall, please see **Chapter 3 Wall Mounting**.

Chapter 3

Wall Mounting

This section provides details for final mounting of XHC3. Ensure that the camera is setup successfully before permanently mounting it.

1. Drill the pilot hole on the mounting surface at the desired location.
Note: It is suggested to use "Philips Head (PH2)" screwdriver. The diameter of the mounting hole is 6.35mm and total depth is 36.2mm.
2. Mount the included Anchor, if needed



Figure 5: Installing

3. Plug the included power cable into to the camera and plug the power adapter into a standard power outlet.



CAUTION: Use only the power adapter provided. Using a different one can result in hardware damage.

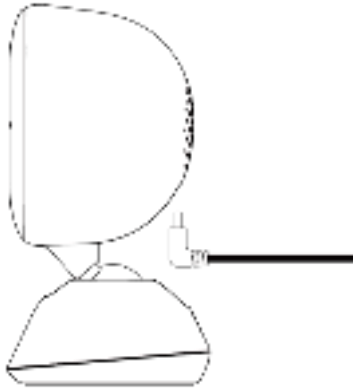

Figure 8: Routing the Cable

4. Mount the camera to the surface using the included screw.

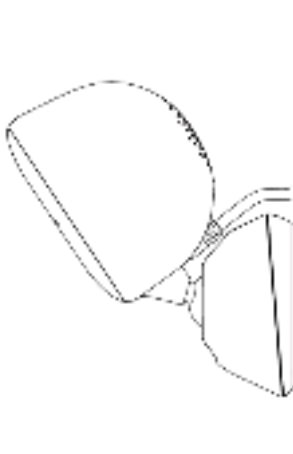

Figure 9: Mounting

5. Adjust the camera to a desired position and secure it firmly.
6. Verify that the camera is working normally.

Appendix A

Specifications



Technical Specifications

Camera	
Dimensions H x W x D	4.24" x 2.69" x 2.05" (107.74 x 68.33 x 52.17mm)
Video compression	H.264 and MJPEG
Operating Temperature	32°F to 104°F (0° C to 40° C)
Storage Temperature	-4°F to 158°F (-20° C to 70° C)
Button	1 Reset Button
Wireless interface	Dual Band, IEEE 802.11ac, 802.11a/b/g/n, BT 5.0
Audio	1 built-in Microphone 1 built-in Speaker
IR LEDs	2
LED	1 tri-color LED (Power/Network/Status)
Power Adapter	
Input	100-240V AC
Output	12V/1A DC

Regulatory Approvals

FCC Statement

This device complies with Part 15 of the FCC Rules. Operation is subject to the following two conditions: (1) This device may not cause harmful interference, and (2) this device must accept any interference received, including interference that may cause undesired operation.

This equipment has been tested and found to comply with the limits for a Class B digital device, pursuant to Part 15 of the FCC Rules. These limits are designed to provide reasonable protection against harmful interference in a residential installation. This equipment generates, uses and can radiate radio frequency energy and, if not installed and used in accordance with the instructions, may cause harmful interference to radio communications. However, there is no guarantee that interference will not occur in a particular installation. If this equipment does cause harmful interference to radio or television reception, which can be determined by turning the equipment off and on, the user is encouraged to try to correct the interference by one of the following measures:

- Reorient or relocate the receiving antenna.
- Increase the separation between the equipment and receiver.
- Connect the equipment into an outlet on a circuit different from that to which the receiver is connected.
- Consult the dealer or an experienced radio/TV technician for help.

FCC Caution: Any changes or modifications not expressly approved by the party responsible for compliance could void the user's authority to operate this equipment.

This transmitter must not be co-located or operating in conjunction with any other antenna or transmitter.

FCC Radiation Exposure Statement

This equipment complies with FCC radiation exposure limits set forth for an uncontrolled environment. This equipment should be installed and operated with minimum distance 20cm between the radiator & your body.

Note: The country code selection is for non-US model only and is not available to all US model. Per FCC regulation, all WiFi product marketed in US must fixed to US operation channels only.

Industry Canada Statement

This device complies with ISSED's licence-exempt RSSs. Operation is subject to the following two conditions: (1) This device may not cause harmful interference, and (2) this device must accept any interference received, including interference that may cause undesired operation.

Le présent appareil est conforme aux CNR d'ISED applicables aux appareils radio exempts de licence. L'exploitation est autorisée aux deux conditions suivantes : (1) le dispositif ne doit pas produire de brouillage préjudiciable, et (2) ce dispositif doit accepter tout brouillage reçu, y compris un brouillage susceptible de provoquer un fonctionnement indésirable.

Caution :

(i) the device for operation in the band 5150-5250 MHz is only for indoor use to reduce the potential for harmful interference to co-channel mobile satellite systems; (ii) where applicable, antenna type(s), antenna models(s), and worst-case tilt angle(s) necessary to remain compliant with the e.i.r.p. elevation mask requirement set forth in section 6.2.2.3 shall be clearly indicated.

Avertissement:

Le guide d'utilisation des dispositifs pour réseaux locaux doit inclure des instructions précises sur les restrictions susmentionnées, notamment :

(i) les dispositifs fonctionnant dans la bande 5150-5250 MHz sont réservés uniquement pour une utilisation à l'intérieur afin de réduire les risques de brouillage préjudiciable aux systèmes de satellites mobiles utilisant les mêmes canaux; (ii) lorsqu'il y a lieu, les types d'antennes (s'il y en a plusieurs), les numéros de modèle de l'antenne et les pires angles d'inclinaison nécessaires pour rester conforme à l'exigence de la p.i.r.e. applicable au masque d'élévation, énoncée à la section 6.2.2.3, doivent être clairement indiqués

Radiation Exposure Statement:

This equipment complies with ISSED radiation exposure limits set forth for an uncontrolled environment. This equipment should be installed and operated with greater than 20cm between the radiator & your body.

Déclaration d'exposition aux radiations:

Cet équipement est conforme aux limites d'exposition aux rayonnements ISSED établies pour un environnement non contrôlé. Cet équipement doit être installé et utilisé à plus de 20 cm entre le radiateur et votre corps.

Label Information

XHC3 Device Label Sample (Label size: 36.6 x 38.6mm)

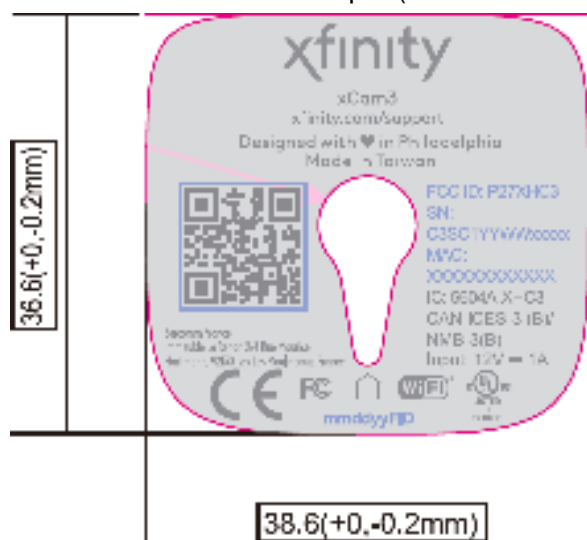

XHC3 Box Label Sample (Label size: 45 x 45mm)

