

80X112mm

Wireless Earphone



User Manual

User Manual

Note: This equipment has been tested and found to comply with the limits for a Class B digital device, pursuant to part 15 of the FCC Rules. These limits are designed to provide reasonable protection against harmful interference in a residential installation. This equipment generates, uses and can radiate radio frequency energy and, if not installed and used in accordance with the instructions, may cause harmful interference to radio communications. However, there is no guarantee that interference will not occur in a particular installation. If this equipment does cause harmful interference to radio or television reception, which can be determined by turning the equipment off and on, the user is encouraged to try to correct the interference by one or more of the following measures:

- Reorient or relocate the receiving antenna.
- Increase the separation between the equipment and receiver.
- Connect the equipment into an outlet on a circuit different from that to which the receiver is connected.
- Consult the dealer or an experienced radio/TV technician for help.

Important: Change or modifications not expressly approved by the manufacturer responsible for compliance could void the user's authority to operate the equipment.

• These instructions are for your safety. Please read through them thoroughly before use and retain for future reference.

PARTS INCLUDED

- Wireless Earphone
- Micro-USB to USB charge cable
- User manual

WARNING

- Please keep it out of small children reach, and stock against humidity and hot temperature.
- Please remove the electronic parts from the helmet when the device would be detached.
- Please keep the device against acidic, alkaline and cuspidal things.
- Please do not disassemble, amend or alter device alone, and do not throw and drop it.
- No naked flame sources, such as lighted candles, should be placed on the apparatus.

BATTERY WARNING

- Please make sure the charging time is about 2 hours at the first time.

1

- Do not throw the device in a fire, battery may explode or leak.
- The Helmet with the electronic core shall not exposed to excessive heat such as burning sun, fire or the like.
- Do not replace the set-in rechargeable Li-Ion battery alone.

FEATURES

- Wirelessly listen to music with integrated technology.
- Fashion design, let music surrounding your life any time.
- Hands free function, truly free your hand.
- Set-in rechargeable Li-Ion battery, long stand-by and working time.
- Support power displaying on iPhone, easy to know when will to be charged.
- DIY design, available to be detachable when you want.
- Sound reminder function, easy to set the device according to sound remind.

SPECIFICATIONS

- Frequency: 2.402GHz-2.480GHz
- Range: 10-15 meters (depending on device)
- Transmission distance of Microphone: ≤1 meter

2

STRUCTURES

Fig. 1

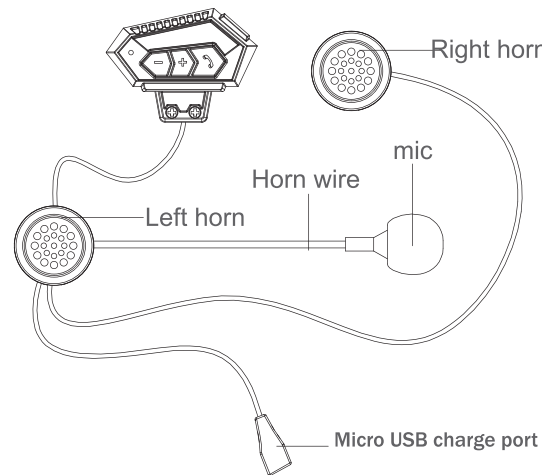

3

Fig. 2

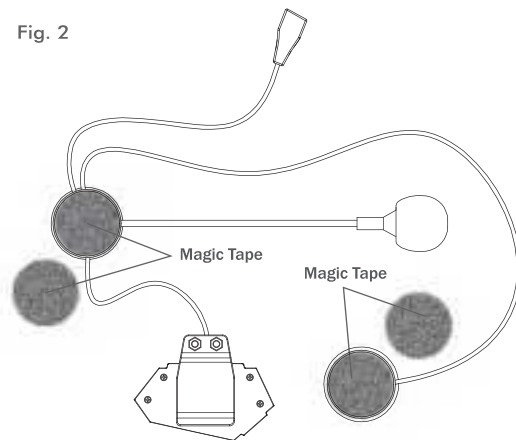

CHARGING THE HEADSET

Note: the Device will need to be fully charged prior to initial use(approx. 2 hours).

1. Connect the micro-USB end of the charge cable to the micro-USB port on the Cap(Fig. 1)
2. Connect the USB end of the charge cable to the USB port of the computer or adapter(not included).
3. The LED indicator (Fig. 1) will turn solid RED while charging and will turn off when fully charged.

Note:the Device can not be music playing or call answering while it is charging.

4

Instalacion universal

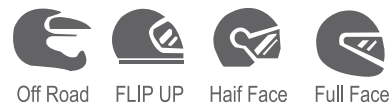

Compatibility devices:

Applicable to the following equipment:



DISPOSAL AND RECYCLING

Waste electrical products should not be disposed of with household waste. Please recycle where facilities exist. Check with your Local Authority or retailer for recycling advice. Attention should be drawn to the environmental aspects of battery disposal.



11

CALL ANSWER

- 1) Android smart phone: the cap will be alarming with "DONG, DONG..." while somebody calling.
- iPhone: the Headset will be alarming with phone calling music which is the same as the phone calling music in iPhone.
- 2) answer phone: press the power button one time to pick phone up.
- 3) Hang-up: Press the button again to hang-up.
- 4) Re-dial phone function: Press the button two times to redial the most recently phone number directly.
- 5) Phone number broadcasting: somebody call you, the device will sound broadcast the calling phone number, and the user will easy to know who calling.

Power save mode

The device will be off automatically after 5 minutes if no working device paired.

Low power warning

The device will be with the sound remind of "power low" while is working, it seems the power not enough, need to be charged.

Power Off

Press the button 3 seconds again, the device closed with the sound reminder of "power off", and the LED indicator off.

6

INSTALLING STEP

Step 1

Take out the Wireless part from the color box, and find out the two earphone, put the earphone into the both sides of the ear position via magic tape (reference, Fig. 2)

Step 2

And then, put the suitable position, try to put the helmet on the head so that the device is on suitable position, you can modify the position by hand in order to well use it. (reference, Fig. 3)

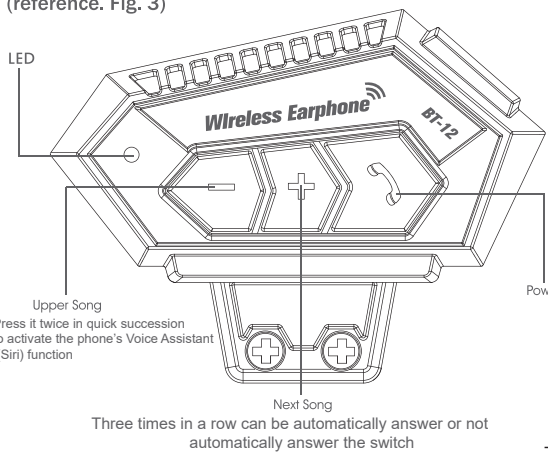

7

installation diagram



Fig.1

Use a threading knife to loosen the threads. Easy to install.



Fig.2

Move the clip and align it on the left side of the helmet Edge in.

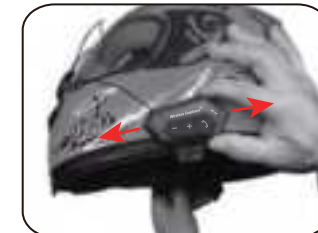

Fig.3

Adjust the position of Bluetooth core from left to right Then lock the upsetting wire and fix it.

8



Fig.4

Peel off the white stripping paper of the wool magic sticker.



Fig.5

Adhesion of Fur Magic to Helms Left ear position.



Fig.6

Stick the left horn to the magic The microphone is attached as shown in the picture.

9



Fig.7

The right trumpet retreats like a demon Skilled white strip paper.

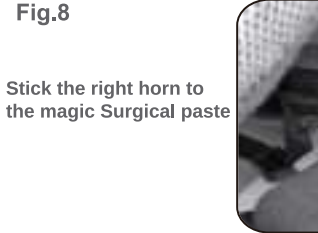

Fig.8

Stick the right horn to the magic Surgical paste



Fig.9

The horn line is buried behind the helmet. In the interior, the rechargeable head is exposed. Charging and cocoa.

10