

# CYCPLUS

## 智能运动风扇 F1

*Smart Fitness Fan F1*

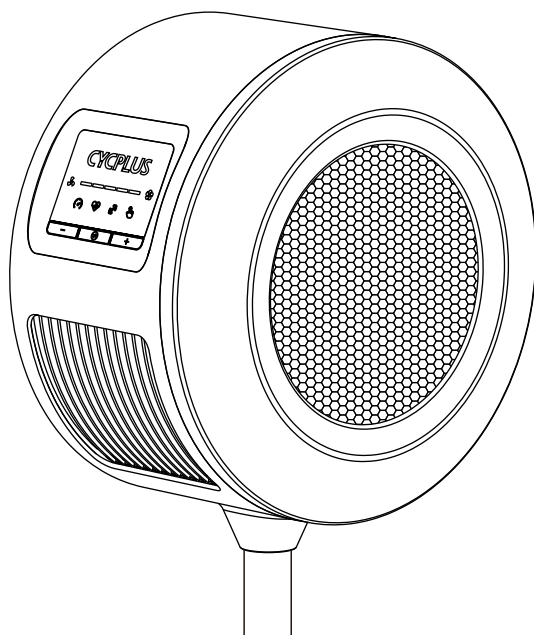

## 用户手册

USER MANUAL

# Table of Contents

Safety Warnings .....	[12]	Function Introduction .....	[18]
Before Use .....	[12]	APP Usage Procedure .....	[19]
Packing List .....	[13]	Cleaning and Maintenance .....	[21]
Product Introduction .....	[14]	Product Specifications .....	[22]
Installation of Elevating Base .....	[15]	Manufacturer Information .....	[22]
Installation of Ground Base .....	[17]		

## Safety Warnings



**Improper use may result in electric shock, fire, personal injury, or other damage.**

- Do not operate this product if the left or right air cover or the air outlet grille is loose or detached.
- Do not insert fingers or foreign objects into the air cover, air outlet grille, or rotating impeller.
- Keep hair, fabric, and other items away from the fan to avoid being drawn in and causing danger.
- Do not use this product in places with unstable or easily tilted objects nearby.
- Do not use this product in high-temperature or humid environments such as bathrooms.
- Do not use this product if the power cord is damaged or the power plug is loose.
- Do not excessively twist, bend, or distort the AC power cord to avoid exposing or breaking the core.
- Do not use inappropriate AC power outlets.
- Do not use the AC power cord provided with this product on any other devices.
- Do not disassemble or repair this product yourself.
- Do not allow children or adults who are not familiar with this manual to operate this product.

## Before Use

### Installation

1. Be sure to install this product correctly according to the manual, otherwise electric shock, fire, personal injury, or other damage may occur.
2. Do not connect the power supply before the fan is fully assembled.

### Transport

3. When moving, make sure the main unit stops running and unplug the power cord.
4. Hold the fan column or base firmly to avoid dropping and causing injury.

### During Use

5. Do not lean on or tilt the fan while it is running.
6. If the product emits abnormal sounds, smells, high temperatures, or inconsistent fan speeds, stop using it immediately.

### Power Cord

7. Before maintenance work or moving the fan, unplug the power cord from the power outlet.
8. When unplugging the power cord, pull from the power plug, do not pull the power cord itself.
9. If the power cord is damaged, it must be replaced with a special cord or parts obtained from the manufacturer or its service agent.

# Packing List



Fan main unit

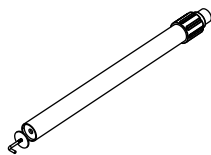

Elevating column

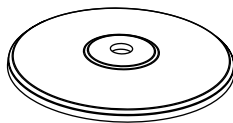

Elevating base

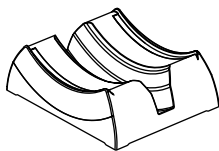

Ground base

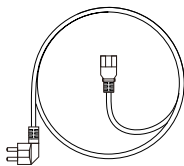

AC power cord

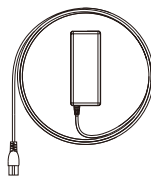

DC power adapter



M5 Screws \*2



M5 Spare screw  
\*2  
M3 Spare screw  
\*2



Screwdriver



Washer/  
L-screw



User manual

# Product Introduction

## Whole Unit

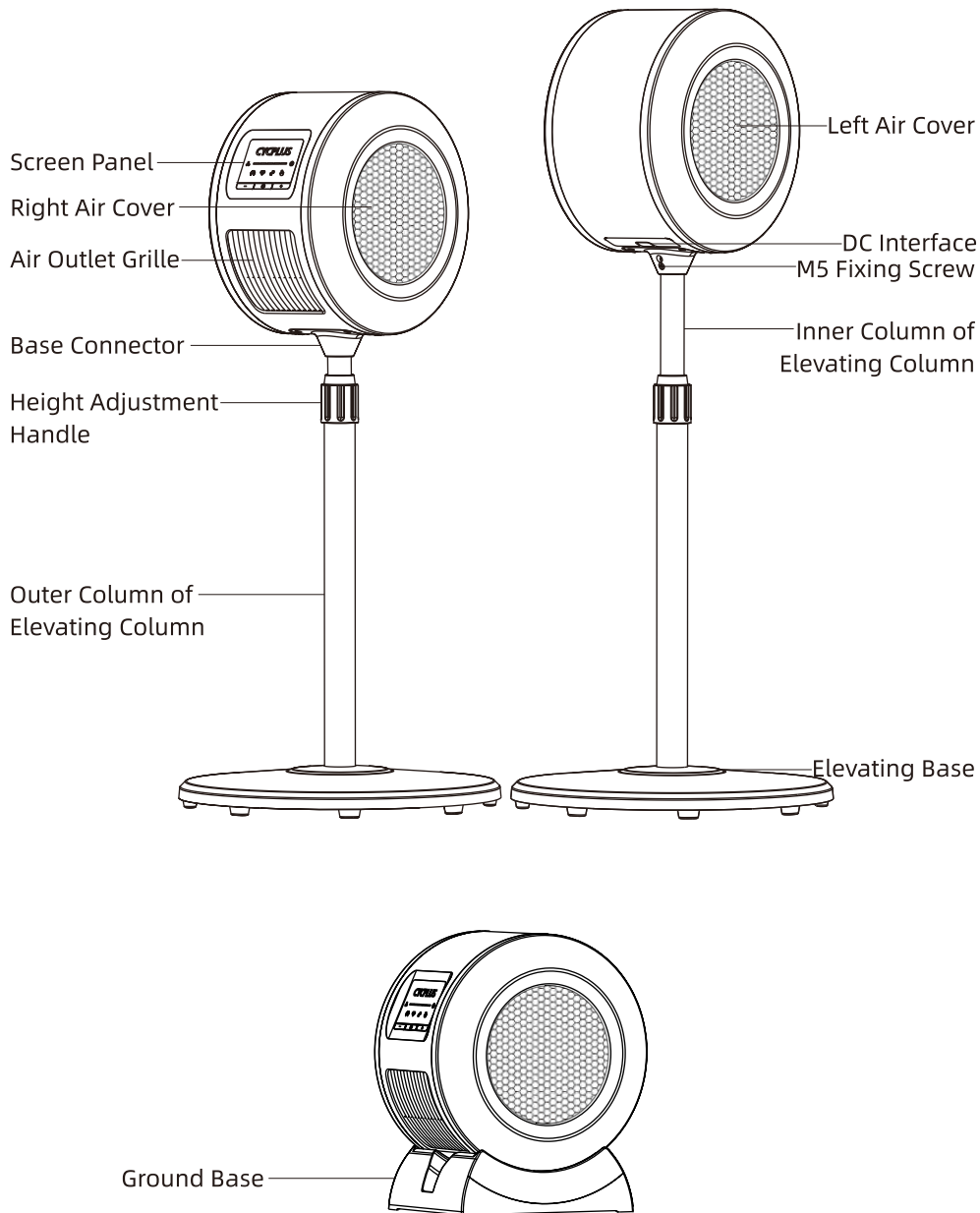

# Installation of Elevating Base

## a. Install the Base

- ❶ Take out the column, L-screw and gasket from the package;
- ❷ Insert the thicker end of the column into the recess of the elevating base, insert the washer from the inside of the base, and tighten the L-shaped screw clockwise to fix the column and base.

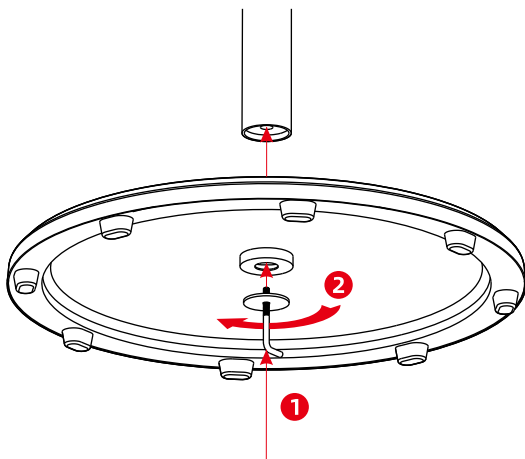

## b. Install the Fan

- ❸ Place the base and column upright on the ground, then pull out the inner column of elevating column, align the screw holes of the fan body with the screw holes of the inner column.
- ❹ Insert the groove of the fan base connector into the top of the inner column.
- ❺ Lock the two M5 screws from the back.

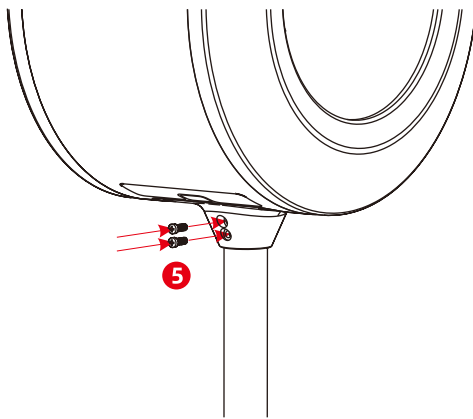
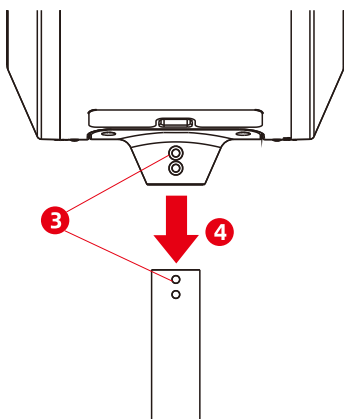

### c. Connect the Power

- ⑥ Connect the DC end port of the power adapter to the interface at the bottom of the fan.
- ⑦ Connect the AC end port to the power adapter, and plug it into the power outlet to power the fan.

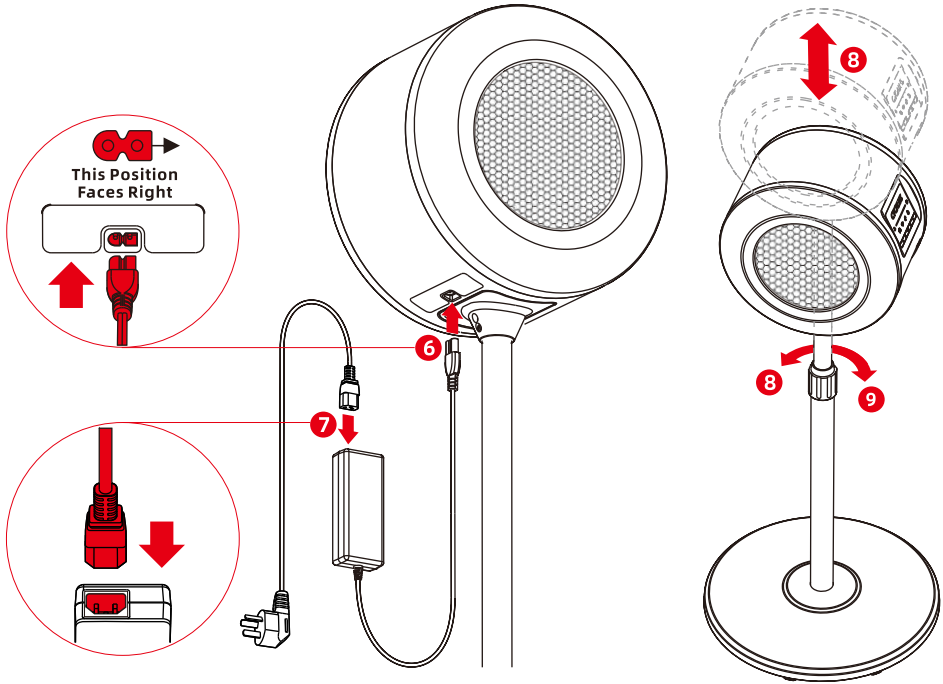

### d. Adjust the Height of the Fan Body

- ⑧ Rotate the column handle at the top counterclockwise to loosen the column, adjust the height of the fan body up and down as needed.
- ⑨ Rotate the column handle at the top clockwise to fix the height of the fan body. Make sure to tighten the handle to avoid the body from falling and causing damage.

# Installation of Ground Base

## a. Install the Base and Connect the Power

- 1 Connect the DC end port of the power adapter to the interface at the bottom of the fan.
- 2 Insert the fan body into the curved recess of the ground base, ensuring the groove direction is not distinguished between front and back, and can be placed in any direction.
- 3 Connect the AC end port to the power adapter, and plug it into the power outlet to power the fan.

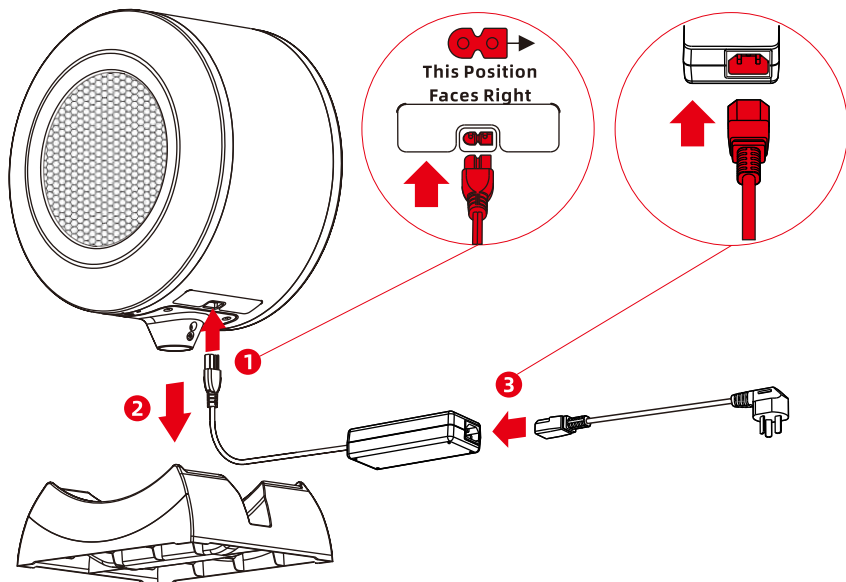

## b. Adjust the Airflow Direction

- 4 Push the top of the fan body to rotate and adjust the airflow direction. The recommended adjustment range is 0~60°.

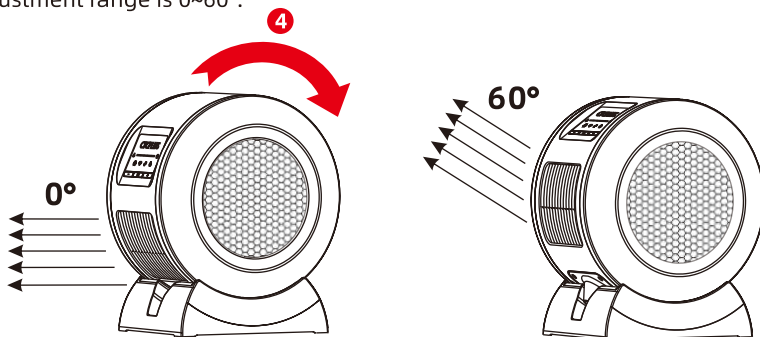

# Function Introduction

## Screen & buttons

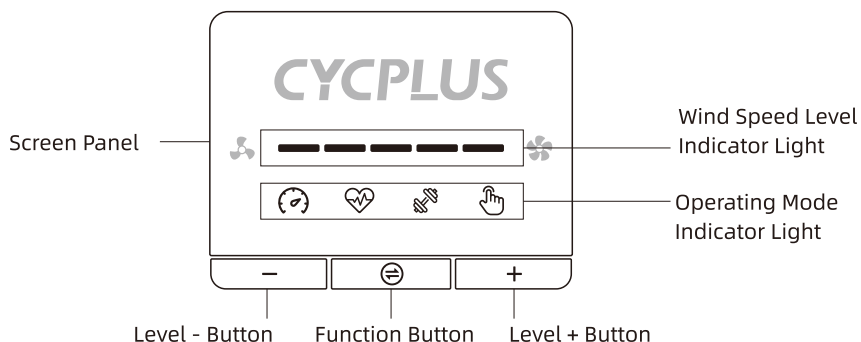



## Button Functions

Operation	Buttons	Functions
Click	—	Switch to manual mode and decrease speed.
	⊖	Cycle through operating modes.
	+	Switch to manual mode and increase speed.
Long Press for 2 Seconds	⊖	Turn on/off.
	— and +	Re-pair sensor in current mode.

## Working Modes

 **Speed Mode:** Connect to speed sensors and cycling trainers to automatically adjust the wind speed according to your cycling speed, simulating a realistic cycling experience.



 **Heart Rate Mode:** Connect to heart rate monitors and sports watches to automatically adjust the wind speed based on your heart rate, enhancing your cooling experience.

 **Power Mode:** Connect to power meters and cycling trainers to automatically adjust the wind speed according to your exercise power, providing a more responsive airflow.

 **Manual Mode:** Adjust the wind speed without using sensors, allowing for flexible adaptation to various exercise scenarios.

 **Smart Mode:** Connect to multiple devices and sensors (speed, heart rate, power) to automatically adjust the wind speed based on various data inputs for optimal automation.

# Indicator Light Functions

Icon	Light Effect	Status
	Green, Solid	ANT+ device connected and working normally
	Green, Blinking	ANT+ device searching and pairing
	Green, Breathing	Paired signal lost, waiting for connection
	Red, Solid	No sensor connected in this mode
	White, Solid	Operating in manual mode, showing speed level by bar lights

## Connecting Sensors

1. Ensure that the sensor to be connected is turned on and in pairing mode.
2. Press the function button [⊖], to switch to different operating modes, and the corresponding sensor for that mode will be connected.
3. During the first pairing, the fan will automatically connect to the sensor with the strongest signal. Subsequently, it will automatically connect to the last used sensor.
4. You can also connect to a smartphone and match sensors for each mode in the CYCPLUS APP. See [APP Usage Procedure] for details.
5. To switch sensors, long press the [-] and [+] buttons to clear the paired sensors in the current mode and re-search for pairing.
6. In non-manual modes, if no sensor signal is detected, the fan will automatically turn off after 1 minute.

## APP Usage Procedure

### Install the App / Connect the Device

1. Scan the QR code to download the CYCPLUS APP or search for "CYCPLUS" in the app store and install it.

  
Apple Store



  
Android Web



  
Google Play



2. Turn on the Bluetooth function of your phone, open the app, and select "F1 Sports Fan" from the product list.
3. Search and connect the device.

## Manual Mode Settings

Manual Mode

☐

Allows manual adjustment of wind speed.

  
on

71% 

1. Click the switch button at the top right[ON] to turn on the smart mode.
2. Adjust the wind speed by dragging the slider left or right, or manually input the value by clicking the icon on the right[].

# Speed Mode Settings

Speed Mode

ON

Wind Speed = Cycling Speed \* Gain Ratio

When the gain ratio is 50% and the cycling speed is 20 km/h, the wind speed is 10 km/h.

Gain Ratio

71%

T3-123456

- 1.Click the switch button at the top right[ON] to switch to speed mode and enter the sensor connection selection.
- 2.Select the target sensor and connect, or re-select the sensor connection at the bottom right.
- 3.Adjust the wind speed gain by dragging the slider left or right, or manually input the value by clicking the icon on the right[✎].
- 4.The wind speed gain is the product of the actual wind speed and the cycling speed. The larger the value, the greater the actual wind speed.

# Heart Rate Mode Settings

Heart Rate Mode

ON

Adjusts wind speed based on heart rate when connected to a heart rate monitor.

10%

100%

80bpm

149 bpm

H2-123456

- 1.Click the switch button at the top right[ON] to switch to power mode and enter the sensor connection selection.
- 2.Select the target sensor and connect, or re-select the sensor connection at the bottom right.
- 3.Input the power range by clicking the icon on the right[✎]. This range corresponds to the minimum and maximum wind speeds, and the wind speed will vary according to the actual power.

# Power Mode Settings

Power Mode

ON

Adjusts wind speed based on cycling power when connected to a power meter.

10%

100%

80W

300 W

T3-123456

- 1.Click the switch button at the top right[ON] to switch to power mode and enter the sensor connection selection.
- 2.Select the target sensor and connect, or re-select the sensor connection at the bottom right.
- 3.Input the power range by clicking the icon on the right[✎]. This range corresponds to the minimum and maximum wind speeds, and the wind speed will vary according to the actual power.

# Smart Mode Settings

Smart Mode

ON

Automatically adjusts wind speed based on all connected sensors.

- 1.Click the switch button at the top right[ON] to switch to smart mode. The wind speed will vary intelligently based on multiple sensor data from other modes without manual settings.

\*Due to app updates, the actual operation may differ slightly from the description. Please refer to the actual app for details.

# Cleaning and Maintenance

Since fan products are prone to attracting dust from the air during use, accumulated dirt over time can affect the performance and efficiency of the machine. We recommend cleaning the inside of the fan every 3-6 months. The maintenance frequency is related to your usage time and the air quality of the environment. When the air cover has accumulated a lot of dust, we recommend cleaning the machine immediately. Additionally, if you need to store the fan for a long time, it is also recommended to perform cleaning maintenance.

Before cleaning and maintenance, be sure to take protective measures, such as wearing a mask, gloves, and dust goggles. Be sure to cut off the power supply, and do not operate with power on.

## a.Remove the Air Cover for Cleaning

- ❶ Unscrew the two M3 screws at the bottom of the fan body and keep them safe.
- ❷ Rotate the air cover in the direction indicated by the icons at the bottom of the body to unlock, then remove the air covers on both sides of the fan.

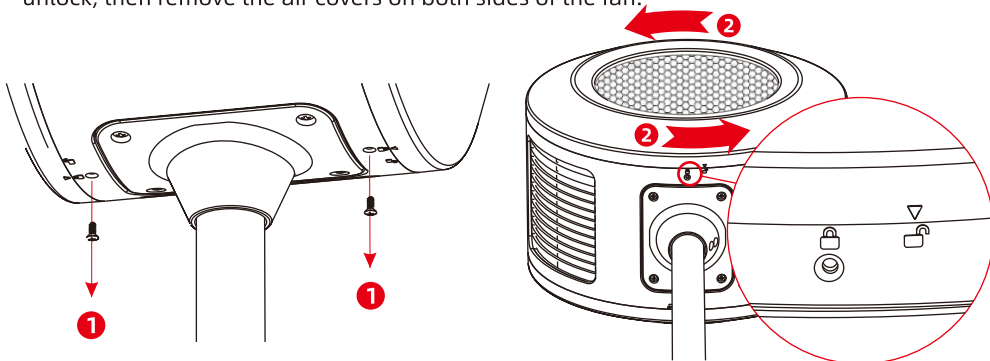

- ❸ Use a soft brush or towel to clean the dust from the mesh holes of the air cover, or rinse with clean water. Be sure to dry thoroughly after rinsing.
- ❹ Use a soft brush to clean the fan blades along the direction of the grille. Clean both sides and the air outlet grille downwards. Do not use any liquid to clean the impeller or the inside of the fan.

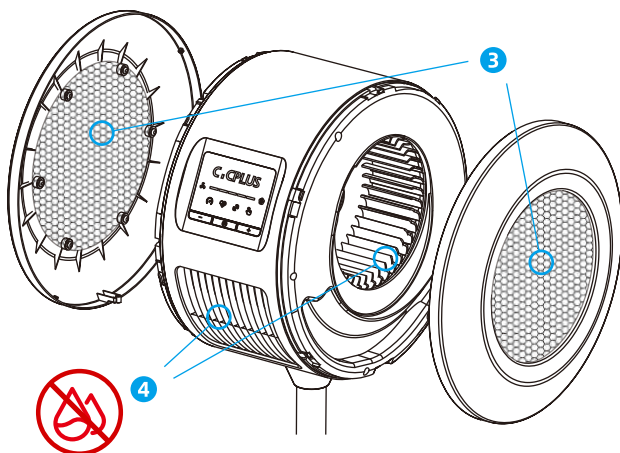

## b.Reassemble the Air Cover

- 5 The air covers do not need to be distinguished between left and right. After cleaning, reassemble the air covers and rotate them in the direction indicated by the icons until the pointer rotates to the "lock" icon. You will hear a "click" sound, indicating the air cover is locked.
- 6 Tighten the two M3 screws at the bottom of the fan body to complete the cleaning and maintenance work.
- 7 After cleaning, there may be some dust left inside the fan. Connect the power supply and adjust to the maximum speed, run for a few minutes to blow out the dust, and then use. During this process, do not direct the airflow towards people or animals to avoid dust entering the eyes.

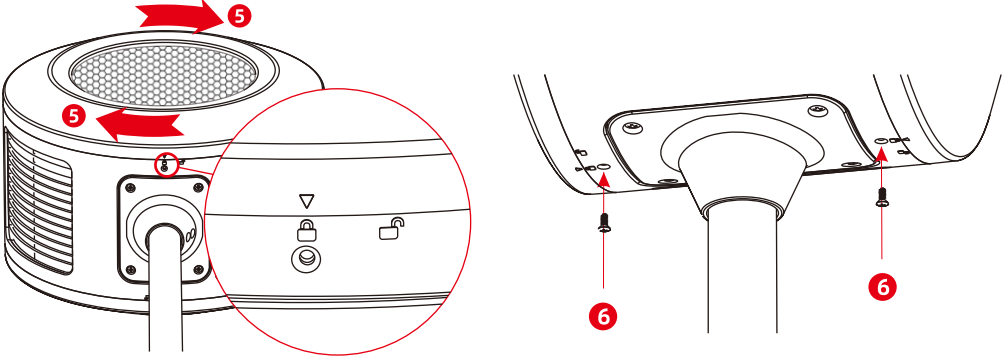

Product Specifications	
Dimensions	With Elevating Base: 440*440*(950~1450) mm
	With Ground Base: 268*215*370 mm
Net Weight	5.5 kg
Adapter Input	100~240V 50/60Hz
Adapter Output	36V $\overline{\text{---}}$ 3A (Max)
Rated Power	68 W
Maximum Speed	1280 RPM
Maximum Air Volume	About 670 m <sup>3</sup> /h
Maximum Wind Speed	About 50km/h
Sensor Connection Protocol	ANT+
Mobile Connection Protocol	BLE
Operating Temperature	0~40°C

## Factory Info

**Manufacturer:** Chengdu Chendian Intelligent Technology Co., Ltd

**Address:** No.88 Tianchen Road, Chengdu, Sichuan Province, China

**Warranty:** Free repair or replacement within one year after purchase.

**After-sales email:** steven@cycplus.com

# CYCPLUS

## 产品合格证

Certificate of Conformity

型号 Model Name	F1
产品名称 Product Name	智能运动风扇 Smart Fitness Fan
执行标准 Implementation Standard	GB4706.1-2005
检验员 Inspector	<div>检01 检验合格</div>

产品经检验合格，准予出厂。

The product has been tested and  
proved to be qualified for delivery.

成都晨电智能科技有限公司

Chengdu Chendian Intelligent Technology Co., Ltd

EC	REP	<b>EUBRIDGE ADVISORY GMBH</b> <b>Virginia Str. 2</b> <b>35510 Butzbach,Germany</b> <b>eubridge@outlook.com</b>
----	-----	---

UK	REP	<b>TANMETINT'L BUSINESS LTD</b> <b>9 Pantygraigwen Road, Pontypridd</b> <b>Mid Glamorgan, CF37 2RR,UK</b> <b>Tanmetbiz@outlook.com</b>
----	-----	---



FR

Cet appareil,  
ses accessoires,  
cordons et batteries  
se recyclent

À DÉPOSER  
EN MAGASIN



À DÉPOSER  
EN DÉCHÈTERIE

OU



Points de collecte sur [www.quefairedemesdechets.fr](http://www.quefairedemesdechets.fr)  
Privilégiez la réparation ou le don de votre appareil !

MADE IN CHINA

## FCC Warning

This device complies with part 15 of the FCC Rules. Operation is subject to the following two conditions: (1) This device may not cause harmful interference, and (2) this device must accept any interference received, including interference that may cause undesired operation.

Any Changes or modifications not expressly approved by the party responsible for compliance could void the user's authority to operate the equipment.

**Note:** This equipment has been tested and found to comply with the limits for a Class B digital device, pursuant to part 15 of the FCC Rules. These limits are designed to provide reasonable protection against harmful interference in a residential installation. This equipment generates uses and can radiate radio frequency energy and, if not installed and used in accordance with the instructions, may cause harmful interference to radio communications. However, there is no guarantee that interference will not occur in a particular installation. If this equipment does cause harmful interference to radio or television reception, which can be determined by turning the equipment off and on, the user is encouraged to try to correct the interference by one or more of the following measures:

- Reorient or relocate the receiving antenna.
- Increase the separation between the equipment and receiver.
- Connect the equipment into an outlet on a circuit different from that to which the receiver is connected.
- Consult the dealer or an experienced radio/TV technician for help.

This equipment complies with FCC radiation exposure limits set forth for an uncontrolled environment. This equipment should be installed and operated with minimum distance 20cm between the radiator & your body.