

7RYMS

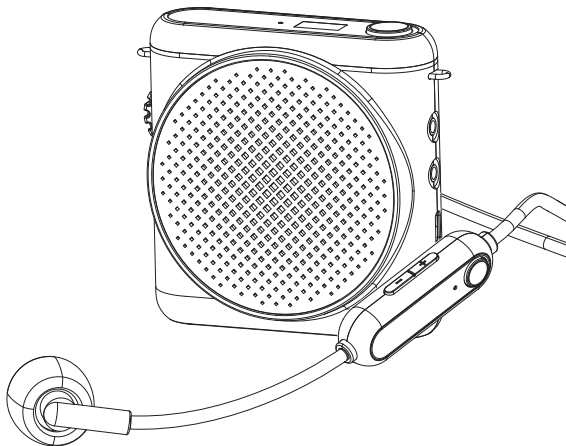

WA1

Portable Voice Amplifier with Wireless Microphone Headset

User Manual

Foreword

Thanks for purchasing 7RYMS WA1

Main Features

- Wireless Transmission, Portable and Anti-interference
- 65mm Speaker with High Volume
- DSP Intelligent Denoise Chip, Anti-howling and Noise-free
- Support AUX Audio Input
- High-efficiency LED Digital Screen
- One-click Muting, 10-level Volume Adjustment
- Ultra-long Battery Life Up to 23 Hours/28 Days
- 9.7mm Large-size Condenser Mic for Clearer Sound Pickup
- Unique Design, Compact and Portable

Notice

- ⚠ Please aim the microphone capsule at the sound source to get an excellent recording
- ⚠ The wireless headset will turn off automatically if it is not connected within 30 minutes
- ⚠ Do not place the headset next to the amplifier when using it, otherwise howling may occur
- ⚠ The amplifier's external mic port only supports cardioid mics specially used for amplifiers. It does not support common lavalier mics; otherwise, howling may occur.
- ⚠ The product is a high-precision device, please prevent it from falling, collision, or pounding
- ⚠ Do not use this device near sources of heat or interference, such as radiators, ovens, refrigerators, air conditioners, etc
- ⚠ Please do not use the device in rainy or damp environments to avoid short-circuit danger
- ⚠ Please keep the device in a dry environment

Packing List

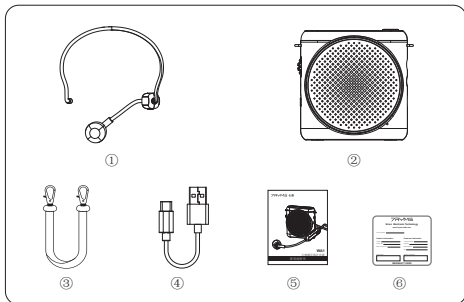

1. Wireless Headset(TX)*1

2. Amplifier(RX)*1

3. Strap*1

4. Charging Cable*1

5. User Manual*1

6. Warranty Card*1

Components and Instruction

Wireless Headset (TX)

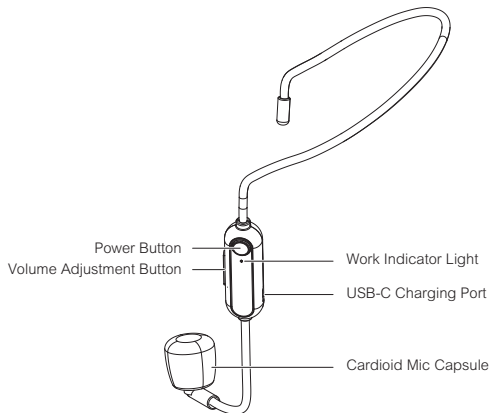

1. Power Button

Long press to turn power on/off; short press to turn muting on/off

2. Volume Adjustment Button

Press + to increase volume, press - to decrease volume; long press the + and - button in sync to enter pairing status

3. Work Indicator Light

| | |
|--------------------------------|--------------------------|
| Unpair | Blue light blinks slowly |
| Pairing | Blue light blinks fast |
| Paired | Blue light keeps on |
| Muting | Red light keeps on |
| Low power | Red light blinks slowly |
| Charging when powered off | Red light keeps on |
| Fully charged when powered off | Blue light keeps on |

4. USB-C Charging Port

Charging the wireless headset with the power bank/DC power supply via the charging cable

5. Cardioid Mic Capsule

Amplifier(RX)

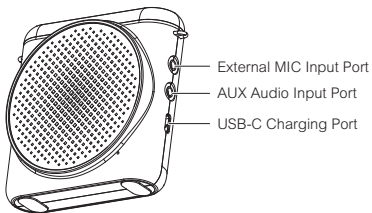
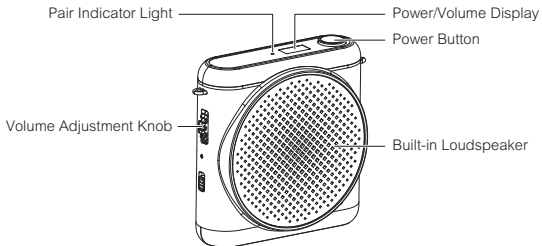

1. Pair Indicator Light

| | |
|--------------------------------|--------------------------|
| Unpair | Blue light blinks slowly |
| Pairing | Blue light blinks fast |
| Paired | Blue light keeps on |
| Charging when powered off | Red light keeps on |
| Fully charged when powered off | Blue light keeps on |

2. Volume Adjustment Knob

It has 10 volume levels, move up to increase volume, move down to decrease volume

3. Power/Volume Display

Battery level displayed by default; volume level displayed when volume is adjusted, then the battery level will be displayed after 5 seconds

4. Power Button

Long press to turn on/off

5. Built-in Loudspeaker

6. External MIC Input Port

7. AUX Audio Input Port

8. USB-C Charging Port

Installation and Usage

Used as Amplifier

Pair(All have been paired by default, if you need to re-pair, please follow the instructions below.)

1. Restart the amplifier, and long press the + and - buttons of the headset to enter the pairing state (make sure the amplifier and wireless headset are within 1 meter when pairing)
2. During the pairing state, the work indicator light of headset blinks blue fast, and the pair indicator light of amplifier blinks blue fast
3. After successful pair, the work indicator light of headset keeps on blue, and the pair indicator light of amplifier keeps on blue



The wireless headset will turn off automatically if it is not connected within 30 minutes

Installation Methods

Wireless Headset(TX)

Wear the headset on your head or neck, and adjust the microphone position to the direction of the sound source

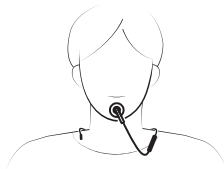

External Mic Input

Insert an external mic to the external mic input port of the amplifier to input audio

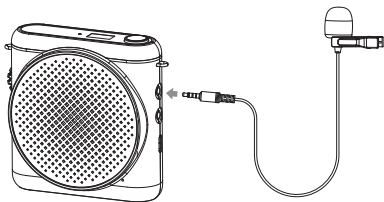

This port only supports cardioid mics for amplifier

Amplifier(RX)

It can be placed in a fixed position for amplification, or carried by the back clip or strap. Please note that the distance between the amplifier and the wireless headset should be within 50 meters



Used as Loudspeaker

AUX Input Play

Connect to smartphone/computer and other devices to input audio through AUX audio input port

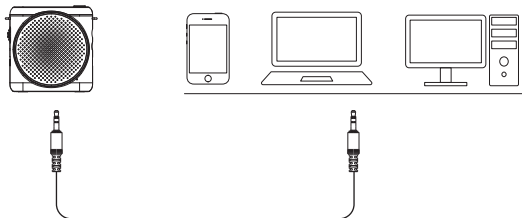

Specifications

| | |
|--------------------------------|--|
| Wireless Type | Ceramic Antenna |
| Wireless Transmission Power | +3dBm |
| Wireless Reception Sensitivity | -96dBm |
| Microphone Sensitivity | -52dB±2dB |
| Microphone Directivity | Cardioid Directivity |
| Maximum Power Output | 5W |
| Frequency Response | 150Hz~12kHz |
| S/N | 80dBA |
| MIC Maximum Input | 70mV RMS |
| AUX Maximum Input | 700mV RMS |
| Sound Delay | <20ms |
| Charging Specification | USB-C 5V/1A |
| Battery Type | Wireless Headset: Li-Polymer 95mAh 3.8V Wireless Amplifier: Li-Polymer 2000mAh 3.7V |
| Charging Time | Wireless Headset: 1.5H Wireless Amplifier: 3H |
| Standby Time | Wireless Headset: 7H Wireless Amplifier: 23H |
| Net Weight | Wireless Headset: 25g Wireless Amplifier: 168g |
| Dimension | Wireless Headset: 62 x20 x14mm Wireless Amplifier: 99 x93 x39mm |
| Working Temperature | 0°C ~ 45°C |
| Storage Temperature | -10°C ~ 60°C |



Website: 7ryms.com

Facebook: 7RYMS

Instagram: 7ryms_official

YouTube: 7RYMS

The 7RYMS LOGO is a trademark which is registered and owned by
Errun Electronic Technology Co., Ltd

7RYMS 七语

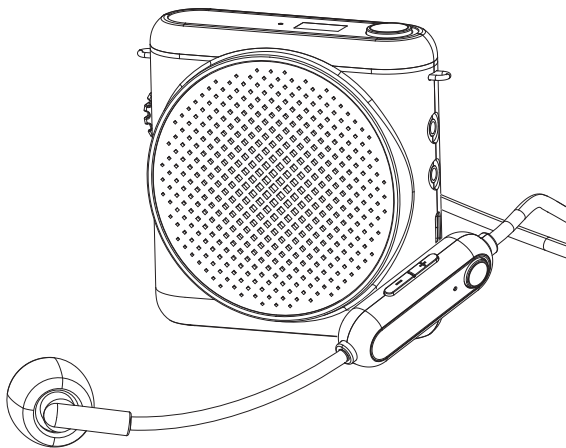

WA1

小蜜蜂无线扩音器

使用说明书

前言

感谢您购买七语WA1

主要功能

- 无线传输，便携抗干扰
- 65mm喇叭大音量
- DSP智能降噪芯片，防啸叫无杂音
- 支持AUX音频输入
- 高效LED数码屏
- 一键静音，十级音量可调
- 超长续航高达23小时/28天
- 9.7mm大尺寸电容咪头收音更清晰
- 设计独特、小巧便携

注意事项

- ⚠ 为获得更好的拾音效果，请将麦克风味头对准音源
- ⚠ 无线耳麦30分钟未连接将自动关机
- ⚠ 使用时请勿将耳麦放在扩音器旁，否则易产生啸叫
- ⚠ 扩音器外置麦克风输入接口只支持扩音器专用心型麦，不支持普通领夹麦，否则易出现啸叫现象
- ⚠ 本设备属于高精密仪器类产品，请避免使用时掉落、碰撞或重击
- ⚠ 请勿将本设备放置在热源或干扰源附近使用，如散热器、烤箱、冰箱、空调等
- ⚠ 不要在雨中或潮湿的环境中使用该设备，否则会有短路的危险
- ⚠ 请在干燥环境中对本设备进行保存

包装清单

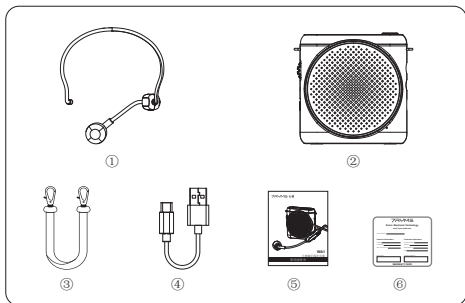

1. 无线耳麦(TX) *1
2. 扩音器(RX) *1
3. 背带 *1

4. 充电线 *1
5. 说明书 *1
6. 保修卡 *1

部件介绍及说明

无线耳麦 (TX)

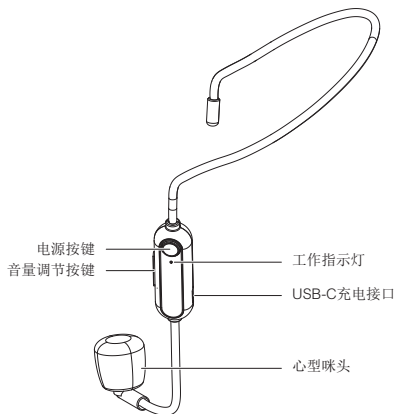

1. 电源按键

长按开启/关闭电源；短按开启/关闭静音

2. 音量调节按键

按+增大音量，按-减小音量；同时长按+-按键进入配对状态

3. 工作指示灯

| | |
|--------|------|
| 未配对 | 蓝灯慢闪 |
| 配对中 | 蓝灯快闪 |
| 配对后 | 蓝灯长亮 |
| 静音时 | 红灯长亮 |
| 电量不足 | 红灯慢闪 |
| 关机充电状态 | 红灯长亮 |
| 关机充满状态 | 蓝灯长亮 |

4. USB-C充电接口

通过充电线连接充电宝/DC电源进行充电

5. 心型咪头

扩音器 (RX):

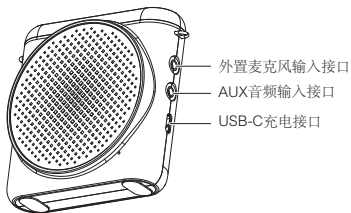
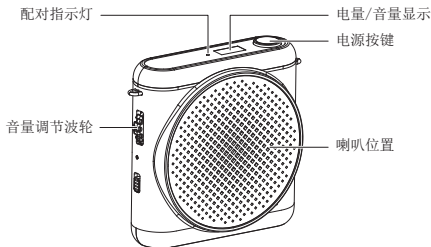

1. 配对指示灯

| | |
|------|------|
| 未配对 | 蓝灯慢闪 |
| 配对中 | 蓝灯快闪 |
| 配对后 | 蓝灯长亮 |
| 关机充电 | 红灯长亮 |
| 关机充满 | 蓝灯长亮 |

2. 音量调节波轮

0-10级音量可调，向上拨动增大音量，向下拨动减小音量

3. 电量/音量显示

默认显示电量；调节音量时显示音量等级，5秒后显示电量

4. 电源按键

长按开/关机

5. 喇叭位置

6. 外置麦克风输入接口

7. AUX音频输入接口

8. USB-C充电接口

安装与使用

作为扩音器使用

配对(出厂已默认配对，如遇特殊情况需重新配对请参照以下配对方法)

1. 重启扩音器，同时长按耳麦的音量+ -按键进入配对状态（配对时确保扩音器和无线耳麦保持在1米距离内）
2. 配对中的耳麦工作指示灯蓝灯快闪，扩音器配对指示灯蓝灯快闪
3. 配对成功后的耳麦工作指示灯蓝灯长亮，扩音器配对指示灯蓝灯长亮



无线耳麦30分钟未连接将自动关机

安装方法

无线耳麦 (TX)输入

将无线耳麦佩戴至头部或脖子，调节咪头位置，使之指向音源方向



外置麦克风输入

在扩音器的外置麦克风输入接口处，插入外置麦克风，输入音频

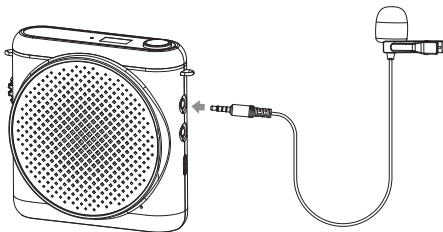

 此接口仅支持扩音器专用心型麦

扩音器 (RX)

可放置固定位置进行扩音，亦可通过背夹或背带随身携带。请注意扩音器和无线耳麦距离在50米以内



作为音响使用

AUX输入播放

通过AUX音频输入接口连接手机/电脑等设备输入音频

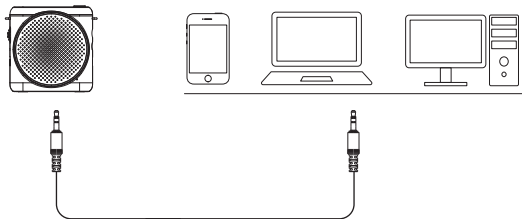

规格参数

| | |
|----------|--|
| 天线类型 | 陶瓷天线 |
| 无线发射功率 | +7dBm |
| 无线接收灵敏度 | -96dBm |
| 麦克风灵敏度 | -52dB±2dB |
| 麦克风指向性 | 心型指向 |
| 喇叭最大输出功率 | 5W |
| 频率响应 | 150Hz~12kHz |
| 信噪比 | 80dBA |
| MIC最大输入 | 70mV RMS |
| AUX最大输入 | 700mV RMS |
| 声音延迟 | <20ms |
| 充电规格 | USB-C 5V/1A |
| 电池类型 | 无线领夹麦: 锂聚合物 95mAh3.8V 无线扩音器: 锂聚合物 2000mAh3.7V |
| 充电时间 | 无线领夹麦: 1.5小时 无线扩音器: 3小时 |
| 续航时间 | 无线领夹麦: 7小时 无线扩音器: 23小时 |
| 净重 | TX: 25g RX: 168g |
| 尺寸 | TX主体: 62x20x14mm RX: 99 x93 x39mm |
| 工作温度 | 0℃ ~ 45℃ |
| 存储温度 | -10℃ ~ 60℃ |



扫二维码关注
七语官方公众号



7RYMS七语麦克风



7RYMS七语



七语影音旗舰店



7RYMS七语

邮箱: support@7ryms.com

电话: 400-8303-981

网址: www.7ryms.com

版权及七语商标归尔润电子科技有限公司所有

Federal Communications Commission (FCC) Statement. This device complies with part 15 of the FCC Rules. Operation is subject to the following two conditions:

(1) This device may not cause harmful interference, and

(2) this device must accept any interference received,

including interference that may cause undesired operation. Note: This equipment has been tested and found to comply with the limits for a Class B digital device, pursuant to part 15 of the FCC Rules. These limits are designed to provide Reasonable protection against harmful interference in a residential installation. This equipment generates, uses and can radiate radio frequency energy and, if not installed and used in accordance with the instructions, may cause harmful interference to radio communications. However, there is no guarantee that interference will not occur in a particular installation. If this equipment does cause harmful interference to radio or television reception, which can be determined by turning the equipment off and on, the user is encouraged to try to correct the interference by one or more of the following measures:

- Reorient or relocate the receiving antenna.
- Increase the separation between the equipment and receiver.
- Connect the equipment into an outlet on a circuit different from that to which the receiver is connected.
- Consult the dealer or an experienced radio/TV technician for help.

Warning: Changes or modifications made to this device not expressly approved by Shenzhen Commlite Technology Co.,LTD.

may void the FCC authorization to operate this device.Note: The manufacturer is not responsible for any radio or TV interference caused by unauthorized modifications to this equipment. Such modifications could void the user's authority to operate the equipment.

RF exposure statement:

This device complies with FCC RF radiation exposure limits set forth for an uncontrolled environment. The device is installed and operated without restriction.