

**DO NOT RETURN TO STORE! CONTACT CUSTOMER CARE
CUSTOMERSERVICE@WECOOLOYS.COM**

LUMITEK
R/C

8+

**TERROR
TOWER**
REMOTE CONTROL TRUCK

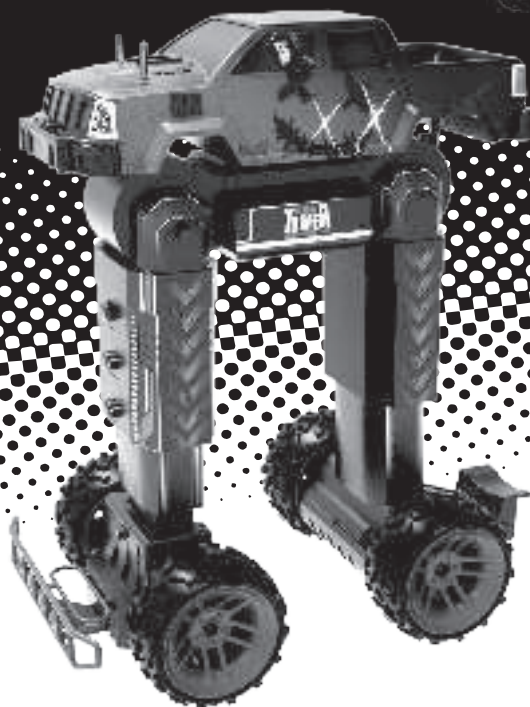

INSTRUCTION GUIDE

WeCool ©2024

A PALADONE GROUP HOLDINGS LTD COMPANY
APEX HOUSE, DOLPHIN WAY, SHOREHAM-BY-SEA,
WEST SUSSEX, BN436NZ, UK
350, CHEMIN DU PRÉ NEUF,
SUITE CDV 64877, 38350, LA MURE, FR
801 ARNOLD AVENUE,
POINT PLEASANT, NJ 08742, USA
2024 WECOOOL ALL RIGHTS RESERVED
WWW.PALADONE.COM
MADE IN CHINA

ITEM NUMBER: 600295
ITEM NAME: TERROR TOWER

**7.4V BATTERY
INCLUDED**

**2 x AA BATTERY
NOT INCLUDED**



QUICK START GUIDE

Prepare to conquer new heights and any road with the powerful LUMITEK RC™ TERROR TOWER!

1. Remove the battery of your **TERROR TOWER** from the battery compartment.
2. Charge it with the USB charger until red light turns green.
3. Replace the battery into your **TERROR TOWER**.
4. Insert two batteries AA 1.5V into the remote controller.
5. Turn on your **TERROR TOWER** and then the remote controller until light turns off.
6. Press the remote controller trigger to watch the **TERROR TOWER** roam ahead!

TERROR TOWER can drive about 20 minutes on a single charge.

TERROR TOWER™ is also equipped with super bright lights for dazzling drives both day and night! So, get ready to start dynamic road races and light up the night with your **LUMITEK RC™ TERROR TOWER!**

BEFORE FIRST USE: PLEASE REFER TO INSTRUCTIONS.

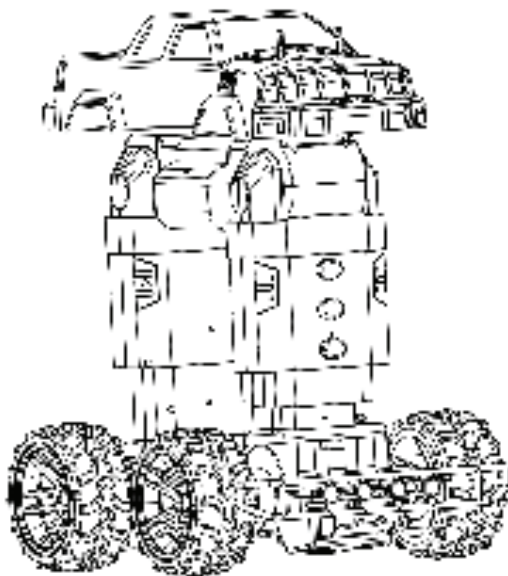

WARNING: Hair Entanglement. Tie back and cover hair and secure loose clothing prior to play.
CAUTION: Not a Ride-On Toy. Not intended to bear weight of children

CONTENTS

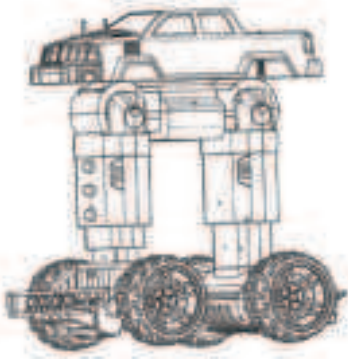

1 x TERROR TOWER



1 x REMOTE CONTROLLER



1 x INSTRUCTION GUIDE



4 x EXTRA HOUSING PINS

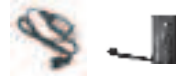

1 x USB CHARGER +
1 x 7.4V LI-ION BATTERY

HOW TO INSTALL BATTERIES

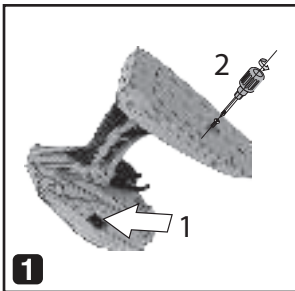

Grasp the body of the LUMITEK RC™ remote controller and switch it off. Look under the remote controller and notice the battery door. Loosen up the screw with a Philips head screwdriver. Remove the battery door.

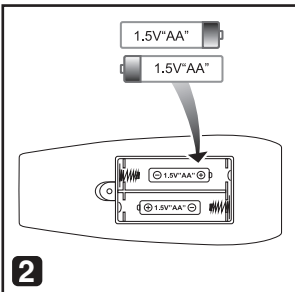

If used batteries are present, remove these batteries from the unit by pulling up on one end of each battery. **DO NOT** remove or install batteries using sharp or metal tools.

Install two new AA 1.5V batteries (not included) as shown in the polarity diagram (+/-) inside the battery compartment.

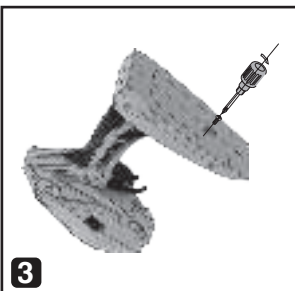

Replace battery door securely.

NOTE: Check your local laws and regulations for correct recycling and/or battery disposal.

HOW TO CHARGE

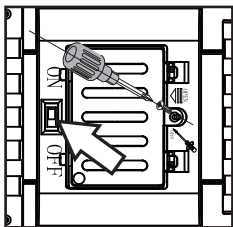

Switch off your LUMITEK RC™ TERROR TOWER. Loosen the screw holding the battery door on the bottom side of the model with a Philips head screwdriver counter-clockwise and remove the battery door.

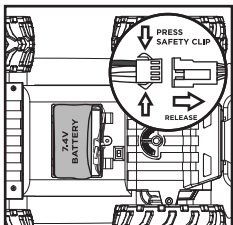

Disconnect the rechargeable 7.4V Lithium-Ion battery from the vehicle. Do not force during this process and press the safety clip to allow the disconnection.

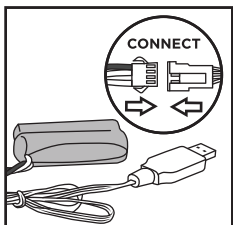

Connect the battery plug directly to the USB power plug socket and make sure the connection is secure. The Lithium battery connecting plug and the car's plug socket fit in only one direction; never force the connection.

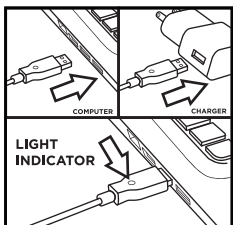

Connect the USB end of the cable to your computer's USB port or a USB wall charger. The red charge indicator light turns on to show that charging is in progress. The red charge indicator light turns green when the battery is fully charged (Between 4 to 5 hours).

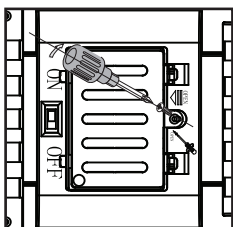

Reconnect the fully charged battery to the vehicle and secure the door with the screw.

NOTE: periodically examine the charger for external damage. External damage to the charger may result in the risk of fire, electric shock, or injury to persons. Never use a damaged adapter. The charger used with the toy is to be regularly examined for damage to the cord, plug, enclosure and other parts, and that, in the event of such damage, the toy must not be used with this charger until the damage has been repaired.

We strongly recommend that you should remove the batteries from your car if the car is not in use.

HOW TO CONNECT THE CONTROLLER

Before being able to drive your LUMITEK RC™ TERROR TOWER, you must understand how to control it with the LUMITEK RC™ remote controller.

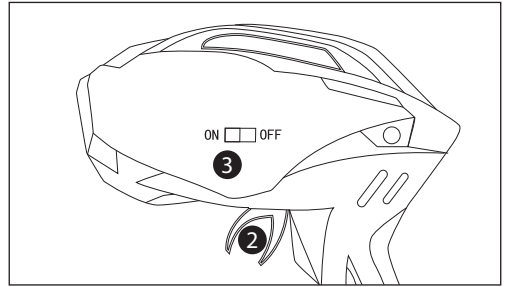
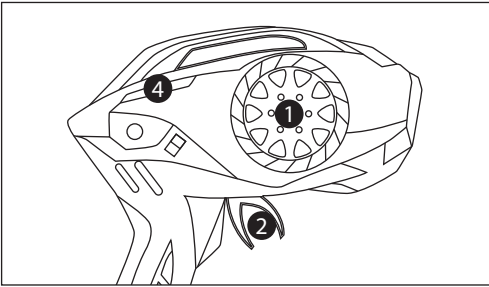

- 1. STEERING WHEEL:** Turns right and left the vehicle.
- 2. SPEED TRIGGER:** Moves forward and backward the vehicle.
- 3. POWER ON/OFF SWITCH (OPPOSITE SIDE):** Turns on and off the remote controller.
- 4. LED INDICATOR:** LED signal for pairing and commands.

Now that you are familiar with the remote controller, you first must connect/pair your LUMITEK RC™ TERROR TOWER to the remote controller. Please follow the below instructions in the right sequence order.

NOTE: If you do not follow this sequence, the car will NOT be paired and you will not be able to drive it!

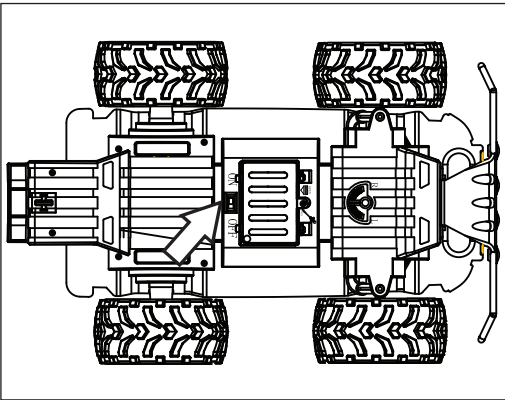

1. Turn on the switch on the bottom of the vehicle, near the battery door.

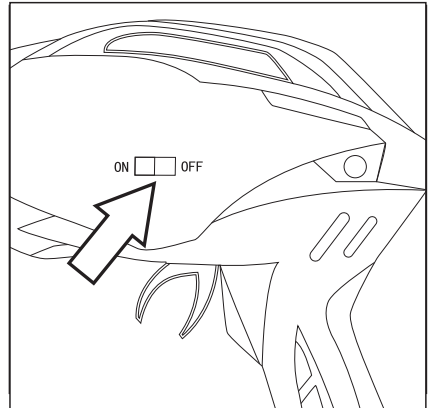

2. Turn on the switch on the side of the remote controller. The red LED on the opposite side will light on once paired.

NOTE: If you do NOT follow these instructions, your car will NOT be paired and you will NOT be able to drive it!
AFTER SUCCESSFUL PAIRING, YOUR CAR IS NOW READY TO DRIVE!

HOW TO DRIVE

Your LUMITEK RC™ TERROR TOWER has the following driving commands: drive forward, backward, turn right and left.

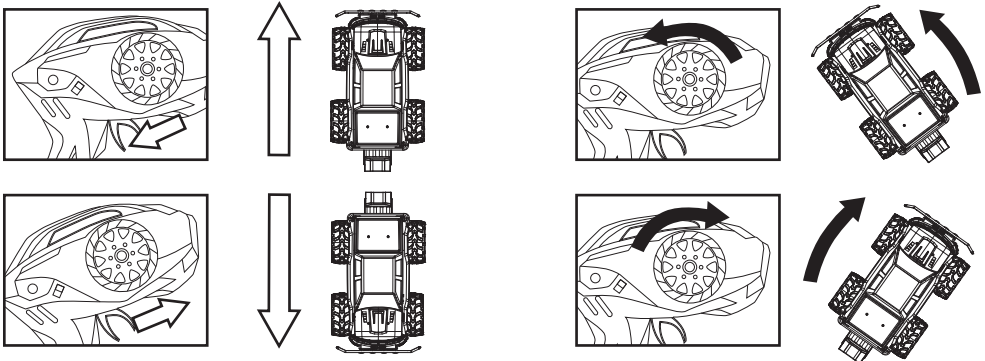

Once you become conformable with the basic commands driving the vehicle, perform driving practice on the tracks as shown in the figure below.

Keep practicing until you feel comfortable with the steering, throttle and brake at low speeds.

Once you are feeling comfortable try operating on another and more complex track. When you have mastered the basics you will be able to drive at higher speeds in a more controlled fashion.

The sky is the limit so feel free to create your own race track and/or explore your creativity!

WARNING: Hair Entanglement. Tie back and cover hair and secure loose clothing prior to play.
CAUTION: Not a Ride-On Toy. Not intended to bear weight of children

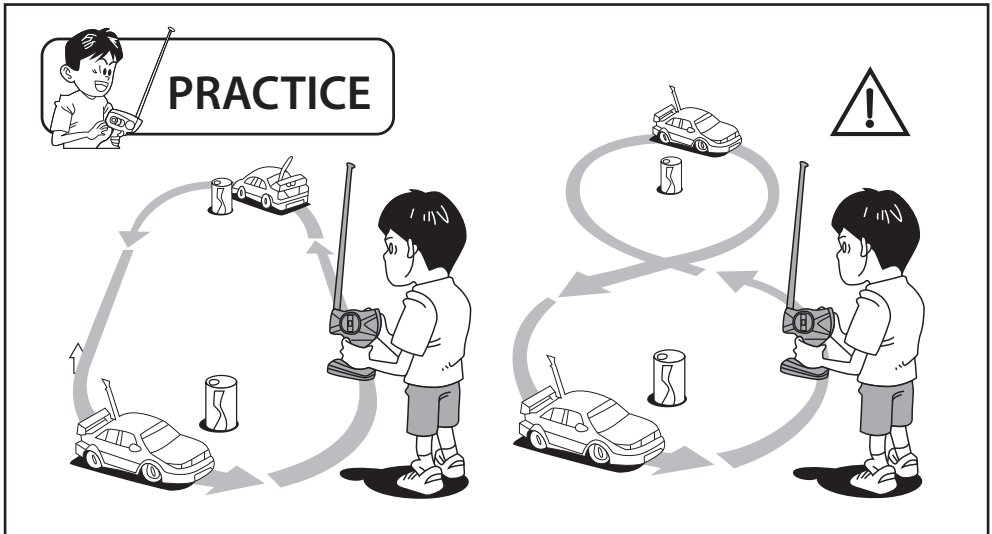

HOW TO ROTATE THE LEGS

Your LUMITEK RC™ TERROR TOWER has the ability to extend, retract and rotate the legs into multiples positions. Try every possible combination to have more fun with your monster truck!

But first, let's learn how to rotate the legs.

NOTE: Do not force the leg rotation! Make sure the button is fully pressed before you rotate the leg. We recommend using two hands for this operation.

On the left side of the truck, there is one round button located just under the housing at the top of each leg as per the diagram aside.

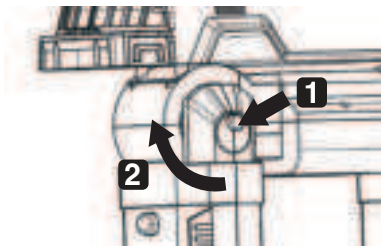
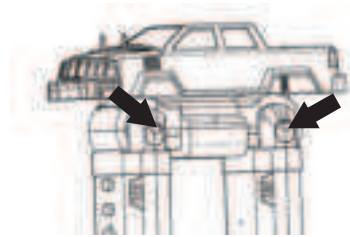

To rotate each leg, the button first must be pressed (1) and while it is pressed, you can freely rotate the leg (2) to your desired angle. Release the button to lock the position you selected.

NOTE: Rotating the front leg will require to adjust the wheels so that they can still turn. Please follow the illustrations below to adjust accordingly.

In order to rotate the wheels and align the bumper horizontally with the rest of the truck, you must use two hands, pressing the switch to the left as per the illustration below and rotating that part while the switch is pressed. The switch can be released when the right position has been selected. The goal is to always have the bumper aligned horizontally with the rest of the truck so that the wheels can be tuned when driving the truck

