

START THE COZYPOD
PRESS the  ON button.



TURN OFF COZYPOD
LONG PRESS the  ON button.



CHANGING FAHRENHEIT TO CELCIUS
LONG PRESS the Fahrenheit icon to switch back and forth to Celcius.
The CozyPod will remember your setting.

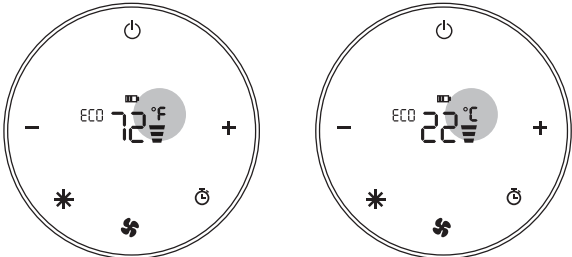

TIMER FUNCTION
a. **SHORT PRESS** the timer icon  to start.
b. Choose 1 - 12 hours on the timer.
c. **LONG PRESS** the icon to shut the timer off.

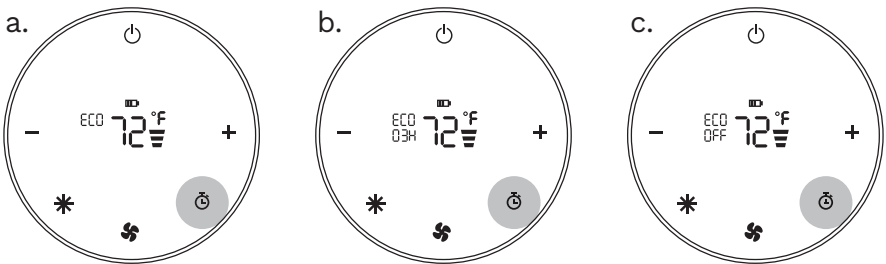

LIGHTING CONTROL
SHORT PRESS the lighting icon  to toggle between the lighting brightness.



TROUBLESHOOTING

PROBLEM	SOLUTION
The remote isn't turning on	<ul style="list-style-type: none">Make sure the main power unit is turned on to start the flow of electricity.With CozyPod plugged in, return the remote to the charging dock.
The heater turned off automatically	<ul style="list-style-type: none">Check the Eco Mode settings. If your room temperature is higher than the set temperature, CozyPod will turn off to preserve energy.The unit has a 24 hour safety setting to not be kept on continuously more than a full day.
ERROR MESSAGES	
HH	OVERHEAT PROTECTION The unit is too hot and needs to cool down before being turned on again.
E1	OPEN CIRCUIT The unit has a faulty circuit and should not be used. Contact our support team.
E2	SHORT CIRCUIT The unit has a short circuit and should not be used. Contact our support team.

**MUST READ
BEFORE USE**
SAVE THESE
INSTRUCTIONS

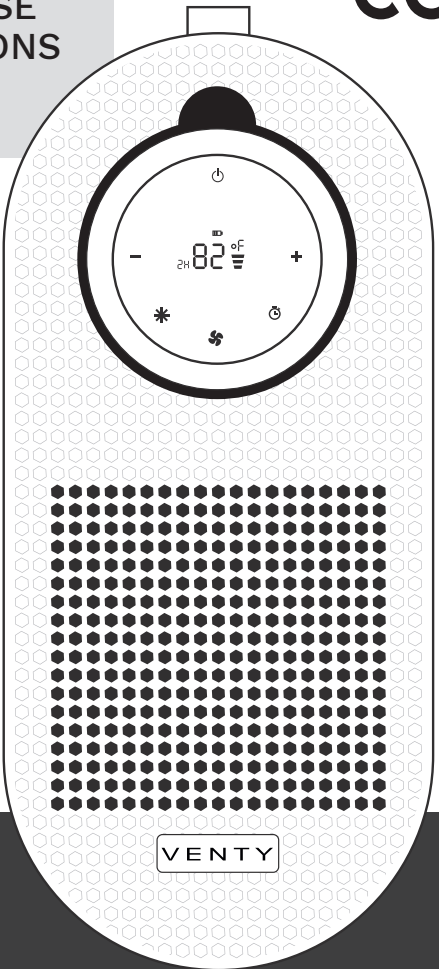

**COZYPod
USER MANUAL**

MUST
READ
BEFORE
USE

IMPORTANT INSTRUCTIONS
SAVE THESE INSTRUCTIONS

Warning: To reduce the risk of fire or electric shock do not use with an extension cord.

CAUTION – High temperature, keep electrical cords, drapery, and other furnishings at least 3 feet (0.9 m) from the front of the heater and away from the side and rear.

WARNING – Risk of Hyperthermia.

- This heater is hot when in use. To avoid burns, do not let bare skin touch hot surfaces. Use the top silicone piece when moving this heater.
- Keep combustible materials, such as furniture, pillows, bedding, papers, clothes, and curtains at least 3 feet (0.9 m) from the front of the heater and keep them away from the sides and rear.
- Extreme caution is necessary when any heater is used by or near children or those in need of assistance, especially whenever the heater is left operating and unattended.
- To prevent a possible fire, do not block air intakes or exhaust in any manner. Do not use on soft surfaces, like a bed, where openings may become blocked.
- A heater has hot and arcing or sparking parts inside. Do not use it in areas where gasoline, paint, or flammable liquids are used or stored.
- Use this heater only as described in this manual. Any other use not recommended by the manufacturer may cause fire, electric shock, or injury to persons.
- Always plug heaters directly into a wall outlet/receptacle. Never use with an extension cord or relocatable power tap (outlet/power strip).
- This heater may include an audible (a visual) alarm to warn that parts of the heater are getting excessively hot. If the alarm sounds (flashes), immediately turn the heater off and
- DONOT OPERATE THE HEATER WITH THE ALARM SOUNDING (FLASHING).
- SAVE THESE INSTRUCTIONS

CARE AND MAINTENANCE

Turn off the heater and unplug it from power when not in use. Use only a soft cloth to wipe the outer surfaces gently. Do not use any cleaning agents or detergents. Never immerse the heater in water. Be careful not to get the heating element and switches wet. To achieve the best performance, we suggest cleaning the heater at least once during the operating season or before storing it when it will not be in use for a long period. Maintenance For storage, you may leave the heater covered to protect it from dust. Store it in a cool, dry location and remove the power plug so that it does not bend while not in use.

Note that CozyPod is meant for smaller rooms, bedrooms, and offices. If placed in a large open space, Eco Mode may not reach your desired temperature but will blow heat constantly.

TECH SPECS	
PRODUCT NAME	Venty CozyPod
MAX POWER	550W / 4.2A
INPUT VOLTAGE	110V-240V 50/60Hz
HEATING METHOD	PTC
SOUND	30-36db
PRODUCT WEIGHT	1.5lbs
REMOTE BATTERY	3.7V 400mh
SIZE	23.1cm x 10cm x 5.6cm

UNDERSTANDING YOUR COZYPod

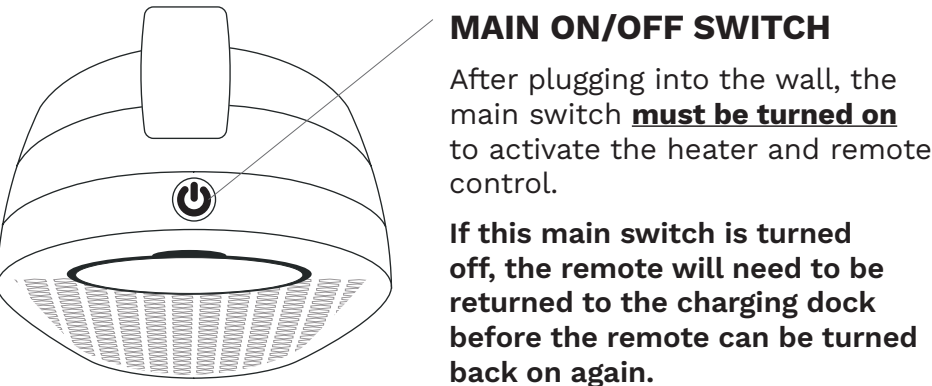
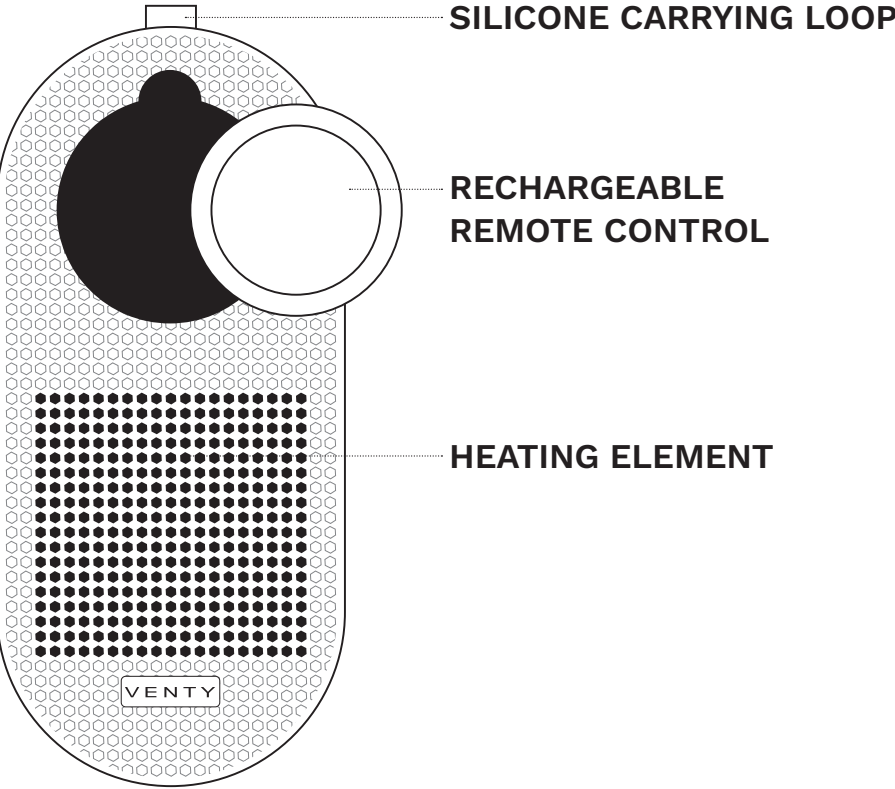

HOW TO INSTALL AND REMOVE THE SOCKET HEAD

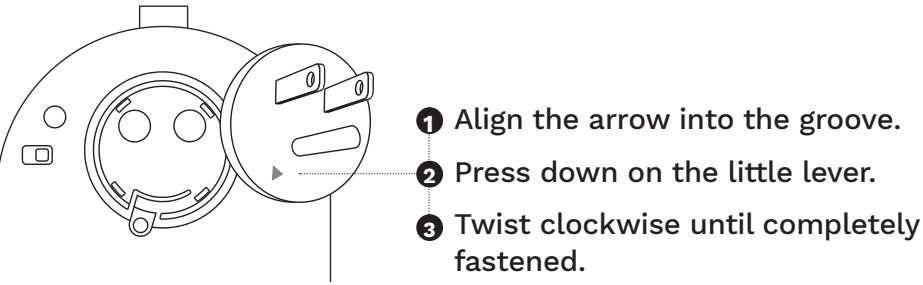

UNDERSTANDING YOUR WIRELESS CHARGING REMOTE

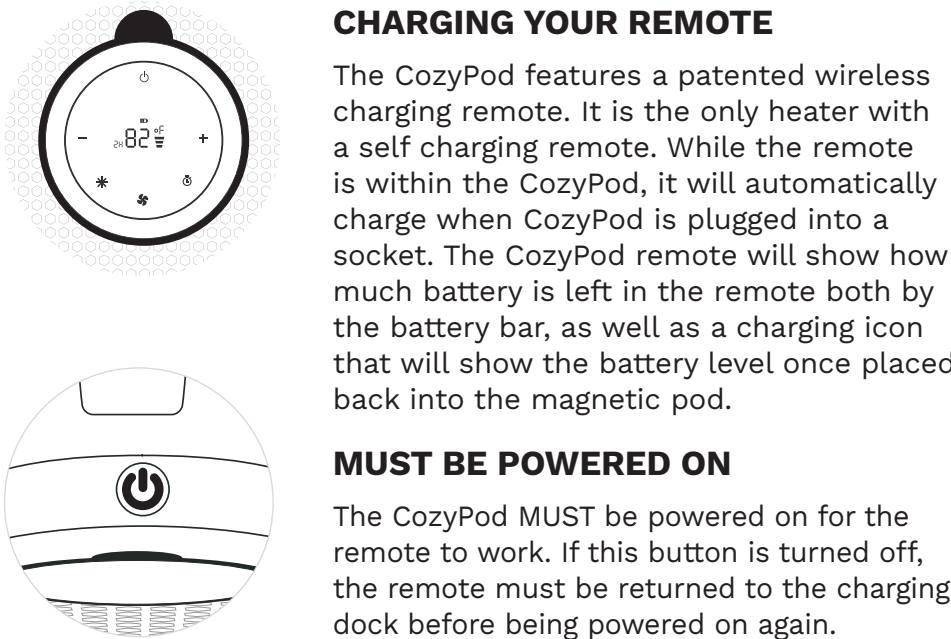

FCC warning statements:

This equipment has been tested and found to comply with the limits for a Class B digital device, pursuant to part 15 of the FCC Rules. These limits are designed to provide reasonable protection against harmful interference in a residential installation. This equipment generates, uses and can radiate radio frequency energy and, if not installed and used in accordance with the instructions, may cause harmful interference to radio communications. However, there is no guarantee that interference will not occur in a particular installation. If this equipment does cause harmful interference to radio or television reception, which can be determined by turning the equipment off and on, the user is encouraged to try to correct the interference by one or more of the following measures:

- Reorient or relocate the receiving antenna.
- Increase the separation between the equipment and receiver.
- Connect the equipment into an outlet on a circuit different from that to which the receiver is connected.
- Consult the dealer or an experienced radio/TV technician for help.

Caution: Any changes or modifications to this device not explicitly approved by manufacturer could void your authority to operate this equipment.

This device complies with part 15 of the FCC Rules. Operation is subject to the following two conditions: (1) This device may not cause harmful interference, and (2) this device must accept any interference received, including interference that may cause undesired operation.

The device has been evaluated to meet general RF exposure requirement This equipment complies with FCC radiation exposure limits set forth for an uncontrolled environment.

This equipment should be installed and operated with minimum distance 20cm between the radiator & your body.