



H603W

Portable Wi-Fi Phone Quick Installation Guide

Fanvil Technology Co., Ltd.
www.fanvil.com

English (EN)

Precautions

Warning: Please do not power cycle the device during system boot up or firmware upgrade. You may corrupt firmware images and cause the unit to malfunction.

Warning: Use only the power adapter included in the device package. Using an alternative non-qualified power adapter may possibly damage the unit.

Overview

Fanvil H603W are portable and elegant Wi-Fi phone designed for mobile communication applications. They come with built-in dual-band 2.4G & 5G Wi-Fi(Wi-Fi 6) , which enables stable and efficient communication in various wireless network environments. Installed with a rechargeable 1900mAh battery, the H603W are ready for 7.5 hours talk time or 100 hours standby time. Widely applicable to high-end hotel application scenarios, providing users with a high-quality mobile communication experience.

Packing list



Portable
Wi-Fi Phone



Charging Base

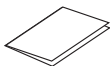

Quick Installation Guide



Rechargeable Battery



Power Adapter

Keys description

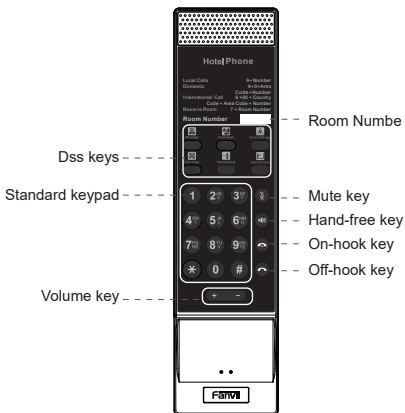

Note: If you need additional settings, please contact your service provider or download the user manual and frequently asked questions for more detailed configuration instructions.

Install the battery

- 1. Remove the rear case:** Remove the rear case of the whole machine with a little force from the handle position of the rear case of the main unit.
- 2. Install the battery:** Take the battery out of the packaging box, with the battery with the notch facing up, put the battery B at the battery compartment B, and pull the battery button until it completely fits the underside of the battery.
- 3. Install the back cover:** Align the back cover with the buckle on the back of the main unit, press your hands along the edge of the main unit from top to bottom (there will be a "click" sound during the process), and ensure that there is no gap, it means that the back cover is fastened.

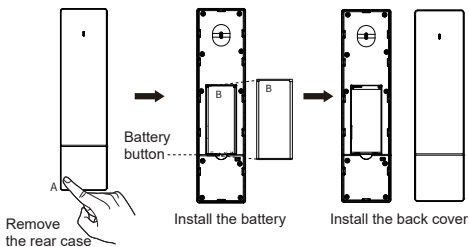

Connect the charging base

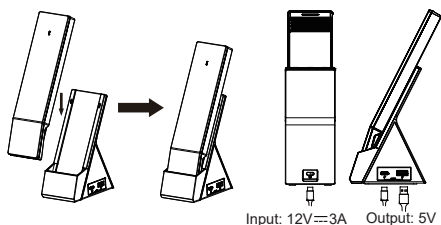

Note:

1. Use the original power adapter (12V/3A, **only for the base**). Third-party power adapters may damage the device.
2. The base provides power output via USB-A and USB-C ports, with a maximum output of 20W, suitable for charging devices such as smartphones (compliant with QC3.0 fast charging standard)..
3. Check the charging status through the host indicator.
4. When there is no charging base, the phone can also be charged separately with 5V/2A charger.

Network connect

Method 1 (Customer selected W611W):

1. Enter [Advanced Settings] on the W611W, then go to [Share Wi-Fi] to enable the Wi-Fi sharing function and set the office network SSID and password. At this point, the W611W functions as an AP.
2. Power on the H603W devices.
3. After powering up, the W611W will push the office network SSID and password to the H603W, enabling them to connect to the office network. Once the Wi-Fi connection is successful, the power indicator will flash quickly 5 times.

Method 2 (Customer no W611W):

1. The user creates a Wi-Fi network with the SSID "WiFi-device-ssid" and the password "i<0%aY8+".
2. After powering on, the H603W device will automatically connect to this Wi-Fi.
3. Once the connection is successful, the power indicator will flash quickly 5 times. The Wi-Fi information of the H603W can be modified through automatic deployment to connect to the office network.
4. Wi-Fi module configuration file as shown:

<<VOIP CONFIG FILE>>Version:2.0000000000

<NET CONFIG MODULE>

--WIFI List-- :
Item1 WIFI Name :Redmi K60
Item1 WIFI SSID :Redmi K60
Item1 Secure Mode :1
Item1 WIFI Encryption :1
Item1 WIFI User Name :

Item1 WIFI Password :12345678

<<END OF FILE>>

Configuration via Web

1. Hold down the # key for 3s. The device will broadcast the IP address.
2. Login: Input the IP address in the web browser. The PC and phone should be in the same IP address segment (The default username and password are both 'admin'.)
3. Configure: Select Line, and fill the relevant content.

Warning

Do not use above 35℃ while the battery is charging.

- Please dispose of lifeless battery under guidance.
- Recycle your device.
- Replacement of a battery with an incorrect type that can defeat a safeguard (for example, in the case of some lithium battery types).
- Disposal of a battery into fire or a hot oven, or mechanically crushing or cutting of a battery, that can result in an explosion.
- Leaving a battery in an extremely high temperature surrounding environment that can result in an explosion or the leakage of flammable liquid or gas.
- A battery subjected to extremely low air pressure that may result in an explosion or the leakage of flammable liquid or gas.

FCC Caution:

Any Changes or modifications not expressly approved by the party responsible for compliance could void the user's authority to operate the equipment.

This device complies with part 15 of the FCC Rules. Operation is subject to the following two conditions: (1) This device may not cause harmful interference, and (2) this device must accept any interference received, including interference that may cause undesired operation.

Note: This equipment has been tested and found to comply with the limits for a Class B digital device, pursuant to part 15 of the FCC Rules. These limits are designed to provide reasonable protection against harmful interference in a residential installation. This equipment generates, uses and can radiate radio frequency energy and, if not installed and used in accordance with the instructions, may cause harmful interference to radio communications. However, there is no guarantee that interference will not occur in a particular installation. If this equipment does cause harmful interference to radio or television reception, which can be determined by turning the equipment off and on, the user is encouraged to try to correct the interference by one or more of the following measures:

—Reorient or relocate the receiving antenna.

—Increase the separation between the equipment and receiver.

—Connect the equipment into an outlet on a circuit different from that to which the receiver is connected.

—Consult the dealer or an experienced radio/TV technician for help.

Specific Absorption Rate (SAR) information

SAR tests are conducted using standard operating positions accepted by the FCC with the phone transmitting at its highest certified power level in all tested frequency bands, although the SAR is determined at the highest certified power level, the actual SAR level of the phone while operating can be well below the maximum value. Before a new model phone is available for sale to the public, it must be tested and certified to the FCC that it does not exceed the exposure limit established by the FCC, tests for each phone are performed in positions and locations as required by the FCC.

For body worn operation, this model phone has been tested and meets the FCC RF exposure guidelines when used with an accessory designated for this product or when used with an accessory that contains no metal and that positions the handset a minimum of 5mm from the body.

Non-compliance with the above restrictions may result in violation of RF exposure guidelines

1. This equipment complies with Part 68 of the FCC rules and the requirements adopted by the ACTA. On the bottom of this equipment is a label that contains, among other information, a product identifier in the format US:AAAEQ##TXXXX. If requested, this number must be provided to the telephone company.

2. A plug and jack used to connect this equipment to the premises wiring and telephone network must comply with the applicable FCC Part 68 rules and requirements adopted by the ACTA. A compliant telephone cord and modular plug is provided with this product. It is designed to be connected to a compatible modular jack that is also compliant. See installation instructions for details.

3. If this equipment [US: 311IPNANH603W] causes harm to the telephone network, the telephone company will notify you in advance that temporary discontinuance of service may be required. But if advance notice isn't practical, the telephone company will notify the customer as soon as possible.

Also, you will be advised of your right to file a complaint with the FCC if you believe it is necessary.

4. The telephone company may make changes in its facilities, equipment, operations or procedures that could affect the operation of the equipment. If this happens the telephone company will provide advance notice in order for you to make necessary modifications to maintain uninterrupted service.

5. If trouble is experienced with this equipment [US: 311IPNANH603W], for repair or warranty information, Service can be facilitated through our office at:

U.S. Agent Company name: EMCTEK

Address: 11788 Big Canyon Ln, San Diego CA 92131 USA

Tel: +1 858 401 9073

Fax: /

If the equipment is causing harm to the telephone network, the telephone company may request that you disconnect the equipment until the problem is resolved.

6. Please follow instructions for repairing if any (e.g. battery replacement section); otherwise do not alternate or repair any parts of device except specified. For repair procedures, follow the instructions outlined under the limited warranty.

7. Connection to party line service is subject to state tariffs. Contact the state public utility commission, public service commission or corporation commission for information.

8. If your home has specially wired alarm equipment connected to the telephone line, ensure the installation of this [IP] does not disable your alarm equipment. If you have questions about what will disable alarm equipment, consult your telephone company or a qualified installer.

9. If the telephone company requests information on what equipment is connected to their lines, inform them of:

a) The ringer equivalence number [NAN]

b) The USOC jack required [N/A]

c) Facility Interface Codes ("FIC") [N/A]

d) Service Order Codes ("SOC") [N/A]

e) The FCC Registration Number [US: 311IPNANH603W]

10. The REN is used to determine the number of devices that may be connected to a telephone line.

Excessive RENs on a telephone line may result in the devices not ringing in response to an incoming call. In most but not all areas, the sum of RENs should not exceed five (5.0). To be certain of the number of devices that may be connected to a line, as determined by the total RENs, contact the local telephone company. The REN for this product is part of the product identifier that has the format US:AAAEQ##TXXXX. The digits represented by ## are the REN without a decimal point. For this product the FCC Registration number is [US: 311IPNANH603W] indicates the REN would be NAN.

11. We suggest the customers use a surge arrestor to protect the device.

简体中文 (ZH)

注意事项

警告: 请不要在设备启动未完成或设备升级软件时断开电源，因为如刚才所述的操作将会导致设备本身的程序损坏，进而导致设备无法启动。

警告: 请使用设备包装中的电源适配器，因为使用其他没有经过认证的替代电源适配器有可能对设备造成损害。

产品概述

H603W是一款便携式Wi-Fi话机，专为移动办公的无线通信需求而设计，H603W内置双频2.4G & 5G Wi-Fi(Wi-Fi 6)，支持快速漫游，在各种无线网络环境中均可实现稳定、高效的通讯；它还配备大容量电池，长效续航无压力，广泛适用于高端酒店应用场景，为用户提供优质的移动通讯体验。

按键概览



便携式Wi-Fi电话



底座

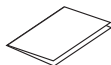

快速安装手册



电池



电源适配器

按键概览

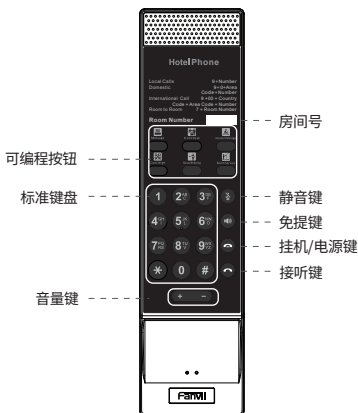

注意：如有其他需要的设置，请联系您的服务提供商，或下载用户手册和常见问题解答以获得更详细的配置说明。

安装电池

- 移除后壳：**从主机后壳的手柄位置A稍微用力，将整个机身的后壳取下。
- 安装电池：**从包装盒中取出电池，注意电池的凹口朝上，将电池B放入电池仓B中。
- 安装后壳：**将后壳与主机背部的扣环对齐，从上到下用手按住主机边缘（过程中会听到“咔嗒”声），确保没有间隙，即表示后壳已固定。

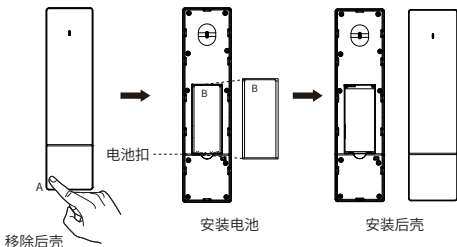

连接充电底座

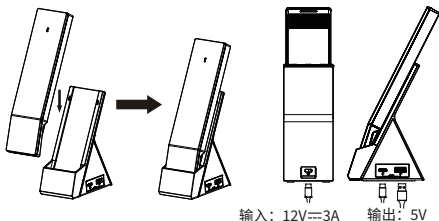

注意:

1. 请使用原厂提供的电源适配器（12V/3A，**仅给底座供电**）。第三方电源适配器可能会损坏设备。
2. 底座USB-A USB-C输出口对外供电输出最大20W，可用于给手机等设备充电(QC3.0快充标准)。
3. 通过主机指示灯查看充电状态
4. 在无充电底座时，移动话机也可以使用5V/2A充电机单独充电。

连接网络

H603W出厂便配置了连接名为WiFi-device-ssid，默认 SSID 的密码“i<0%aY8+”，连接成功后，电源灯会闪烁5次。

方式一（客户选购了W611W）

1. W611W进入>>【高级设置】>>【分享Wi-Fi】开启分享Wi-Fi功能，并设置办公网络的SSID及密码，此时W611W相当于AP。
2. H603W设备上电。
3. 上电启动后，W611W将办公网络的SSID和密码推送到H603W，使其连接到办公网络。Wi-Fi连接成功，电源指示灯会快闪5次。

方式二（客户无W611W）

1. 用户在AP路由器上创建一个 SSID为WiFi-device-ssid密码为i<0%aY8+的Wi-Fi；
2. H603W设备上电后能够自动连接到该Wi-Fi；
3. 连接成功后，电源指示灯会快闪5次；可以通过自动部署的方式修改H603W的Wi-Fi信息，使其连接到办公网络。
4. Wi-Fi模块配置文件如示例：

<<VOIP CONFIG FILE>>Version:2.0000000000

<NET CONFIG MODULE>

--WIFI List-- :

Item1 WIFI Name :Redmi K60

Item1 WIFI SSID :Redmi K60

Item1 Secure Mode :1

Item1 WIFI Encryption :1

Item1 WIFI User Name :

Item1 WIFI Password :12345678

<<END OF FILE>>

通过WEB端设置

1. 长按#号键3s，设备会播报IP地址。
2. 登录：获取到IP地址后，在电脑浏览器中输入IP地址访问(电脑和电话应该在相同的IP地址段内)默认访问用户名和密码均为"admin"。
3. 配置：登录话机网页后，进入【线路】>【SIP】，填写用户名、验证密码、服务器地址、服务器端口(此信息需联系对应IPPBX厂家获取)，并勾选启用选项，配置完成后点击提交完成注册。

警告

在充电状态下，请在35°C以下使用设备。

- 请在指导下处理无法工作的电池。
- 回收您的设备。
- 更换电池时，请不要使用错误类型的电池，这可能会破坏保护装置（例如某些锂电池类型）。
- 不要将电池丢入火中或热烤箱，也不要对电池进行机械压碎或切割，以免引发爆炸。
- 不要将电池放在极高温度的环境中，这可能导致爆炸或易燃液体或气体泄漏。
- 不要将电池置于极低气压的环境中，这可能导致爆炸或易燃液体或气体泄漏。