

## Previously Connected Devices

- The speaker can remember multiple Bluetooth devices and will always try to re-connect to the last device used.
- To re-connect to a different device, turn off Bluetooth on unwanted devices, then access the Bluetooth settings menu on the device you wish to use and select **ISBW108**.
- If the speaker should become unpaired or will not connect normally, follow these steps in your device's Bluetooth Settings Menu.
  - » Delete the speaker ("Forget This Device").
  - » Turn Bluetooth OFF then ON again, and repeat the **Initial Bluetooth Connection**.

## Aux In (3.5mm Audio Input)

1. Connect a 3.5mm audio cable (not included) to the **Aux In** on the unit and the **audio output/headphone jack** on a media player.
2. The unit will automatically detect the input and switch to **Aux In Mode**, indicated by a voice prompt and a **slowly blinking** indicator light. Use the controls on the connected device to select and play audio.

## FCC WARNINGS

This equipment may generate or use radio frequency energy. Changes or modifications to this equipment may cause harmful interference unless the modifications are expressly approved in the instruction manual. The user could lose the authority to operate this equipment if an unauthorized change or modification is made. This device complies with part 15 of the FCC Rules. Operation is subject to the following two conditions: (1) This device may not cause harmful interference, and (2) this device must accept any interference received, including interference that may cause undesired operation. The device has been evaluated to meet general RF exposure requirement. The device can be used in portable exposure condition without restriction.

NOTE: This equipment has been tested and found to comply with the limits for a Class B digital device, pursuant to part 15 of the FCC Rules. These limits are designed to provide reasonable protection against harmful interference in a residential installation. This equipment generates, uses and can radiate radio frequency energy and, if not installed and used in accordance with the instructions, may cause harmful interference to radio communications. However, there is no guarantee that interference will not occur in a particular installation. If this equipment does cause harmful interference to radio or television reception, which can be determined by turning the equipment off and on, the user is encouraged to try to correct the interference by one or more of the following measures:

- Reorient or relocate the receiving antenna.
- Increase the separation between the equipment and receiver.
- Connect the equipment into an outlet on a circuit different from that to which the receiver is connected.
- Consult the dealer or an experienced radio/TV technician for help.
- The rating information is located at the bottom of the unit.

## ADDITIONAL WARNINGS

- **WARNING:** To prevent fire or shock hazards, do not expose this unit to rain or moisture.
- **WARNING :** Where the mains plug or appliance coupler is used as the disconnect device, such disconnect device shall remain readily operable.
- Lithium batteries, like all rechargeable batteries, are recyclable and should be recycled or disposed of according to state and local guidelines. They should never be disposed of in normal household waste and they should never be incinerated, as they might explode. Contact your local government for disposal or recycling practices in your area.
- **To avoid hearing damage**, make sure that the volume on your music player is turned down before connecting your earbuds or headphones. After placing earbuds in/on your ears, gradually turn up the volume until you reach a comfortable listening level.



**WARNING:** This product can expose you to chemicals including lead, which is known to the State of California to cause cancer and birth defects or other reproductive harm. For more information go to [www.P65Warnings.ca.gov](http://www.P65Warnings.ca.gov). **This product meets and complies with required Federal product guidelines**

## Contact Information

**Website:** [www.iLiveElectronics.com](http://www.iLiveElectronics.com)

**Email Support:** [proinfo@dpiinc.com](mailto:proinfo@dpiinc.com)

**Email Parts:** [partsinfo@dpiinc.com](mailto:partsinfo@dpiinc.com)

**Phone Support:** 1-888-999-4215

## Warranty

For Warranty Information and the most up-to-date version of this User's Guide, go to: [www.iLiveElectronics.com](http://www.iLiveElectronics.com).



Specifications are subject to change without notice.  
Copyright © 2021 Digital Products International (DPI, Inc.)  
All other trademarks appearing herein are the property of their respective owners.



**Waterproof Wireless Speaker**  
User's Guide for Model ISBW108 v2842-01

## Features

- Bluetooth wireless: range 60 ft.
- Durable fabric & rubberized coating
- DC battery power - built-in rechargeable battery: approx. 7.5 hrs playtime at 50% volume

## Waterproof Rating - IPX5

- Protection from contact with enclosed equipment.
- Protection from heavy splashing water.
- Protection from dust, oil, and other non-corrosive material.

**IMPORTANT:** To ensure your speaker is prepared for use in a wet environment, disconnect and remove any power cables, and tightly close the charging port water cap. If the water cap is not properly closed, water resistance will be compromised and could result in damage to the speaker or personal injury.

## Includes

- USB charging cable
- Carabiner
- User's Guide

## Overview

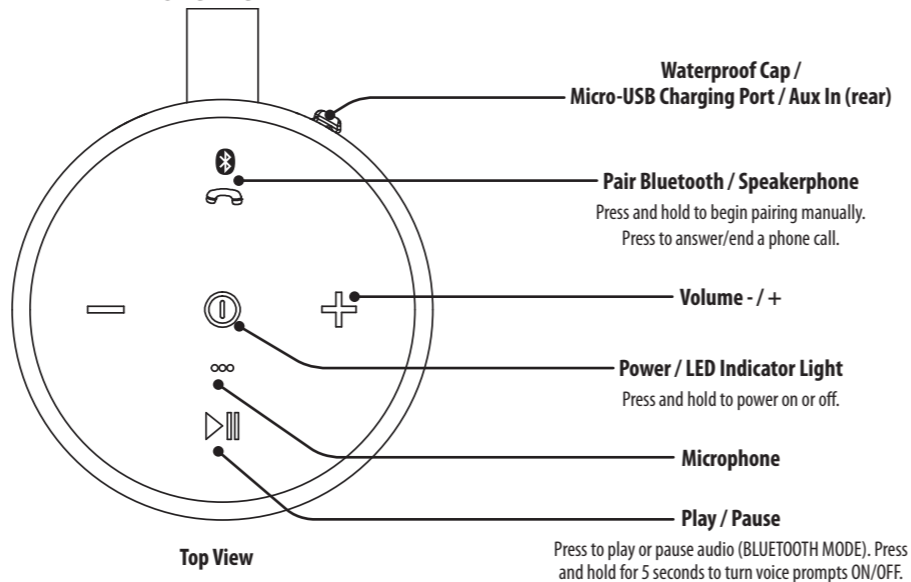

## Charging the Battery

**Warning: Do not charge the speaker while it is in or near water. If splashed or wet, allow ample time to dry before charging.**

Initial charge time is approximately 2 hours. Charge fully before use.

- Pull back the water cap and use a **Micro-USB to USB** cable (included), to connect to the USB port of a powered on computer or USB power adapter (not included).

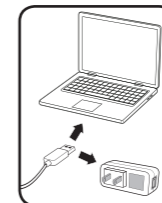
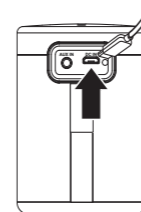

Power Status	Indicator Light
Low Battery	Flashing red light
Charging	Solid Red light
Finished Charging	No light

## Pairing & Playing Audio

When first powered on, the speaker defaults to Bluetooth Mode, indicated by a voice prompt. All other play modes will change automatically when connected to the different audio sources.

1. Power on the speaker by pressing and holding the Power button. When first powering on, the unit will start in Bluetooth Mode, indicated by a voice prompt. *When pairing, remain within 3 feet of the unit.*
2. Using the controls on your Bluetooth device, select **ISBW108** in the Bluetooth Settings to pair. *If need be, refer to the user's manual for your specific device for more information.*
3. When successfully paired, a voice will announce "Bluetooth is connected" and the LED indicator will turn solid blue. Audio from the connected Bluetooth device will now be heard through the speaker.
4. Use the controls on the connected Bluetooth device to select and play audio. Use the speaker controls or the connected Bluetooth device to play, pause, and adjust the volume level.
5. After initial pairing, the unit will stay paired unless unpaired manually by the user or erased due to a reset of the device. Note: If your device should become unpaired or you find it is unable to connect, press & hold the **Pair Bluetooth / Speakerphone** button to enter into Pairing Mode. A voice will announce "Bluetooth is connecting" and you can connect to the speaker manually

## Using the Speakerphone

- To accept a call, press the **Pair Bluetooth / Speakerphone** button or use the controls on the connected phone.
- To end a call, press the **Pair Bluetooth / Speakerphone** button or use the controls on the connected phone.
- To re-dial the last dialed number, press the **Pair Bluetooth / Speakerphone** button twice.