



FLOOR ONE S3 SERIES

Smart Cordless Hard Floor Cleaner

Bedienungsanleitung

Instruction Manual

Manual De Uso

Mode D'emploi

Manuale D'istruzioni



CONTENTS

| | |
|------------------------------------|----|
| Important Safety Instructions..... | 24 |
| Overview..... | 28 |
| Accessories..... | 30 |
| Assembly | 31 |
| Operation | 32 |
| Maintenance | 38 |
| Specifications | 42 |
| Troubleshooting..... | 43 |
| Warranty | 44 |

Important Safety Instructions

SAVE THESE INSTRUCTIONS

Household use only.

When using an electrical appliance, basic precautions should always be followed, including the following:

READ ALL INSTRUCTIONS BEFORE USING (THIS APPLIANCE). Failure to follow the warnings and instructions may result in electric shock, fire and/or serious injury.

WARNING – To reduce the risk of fire, electric shock, or injury:

1. Use only indoors, on non-carpeted floor surfaces such as vinyl, tile, sealed wood, etc. Be careful not to run over loose objects or edges of area rugs. Stalling the brush may result in premature belt failure.
2. Do not allow to be used as a toy. Close attention is necessary when used by or near children, pets or plants.
3. Use only as described in this manual. Use only manufacturer's recommended attachments.
4. Do not use with a damaged cord or plug. If appliance has been dropped, damaged, left outdoors, dropped into water, or is not working as it should, return it to a service center.
5. Do not handle charger, including charger plug, and charger terminals with wet hands.
6. Do not put any object into openings. Do not use with any opening blocked; keep free of dust, lint, hair, and anything that may reduce air flow.
7. Keep hair, loose clothing, fingers, and all parts of your body away from openings and moving parts.
8. Use extra care when cleaning on stairs.
9. Do not use to pick up flammable or combustible liquids, such as gasoline, or use in areas where they may be present.
10. Do not pick up anything that is burning or smoking, such as cigarettes, matches, or hot ashes.
11. Do not use without filter.
12. Prevent unintentional activation. Ensure the switch is in the off-position before picking up or carrying the appliance. Carrying the appliance with your finger on the switch or energizing appliance that have the switch on invites accidents.
13. Always switch off the appliance before making any adjustments, changing accessories, or storing the appliance. Such preventive safety measures reduce the risk of starting the appliance accidentally.
14. Recharge only with the charger specified by Tineco. A charger that is suitable for one type of battery pack may create a risk of fire when used with another battery pack.
15. Use appliances only with specifically designated Tineco battery packs. Use of any other battery packs may create a risk of injury and fire.
16. Under abusive conditions, liquid may be ejected from the battery; avoid contact. If contact accidentally occurs, flush with water. If liquid comes into eye contact, seek medical help. Liquid ejected from the battery may cause irritation or burns.

17. Do not use a battery pack or appliance that is damaged or modified. Damaged or modified batteries may exhibit unpredictable behavior resulting in fire, explosion or risk of injury.
18. Do not expose a battery pack or appliance to fire or excessive temperature. Exposure to fire or temperature above 266°F (130°C) may cause an explosion.
19. Follow all charging instructions and do not charge the battery pack or appliance outside of the temperature range specified in the instructions. Charging improperly or at temperatures outside of the specified range may damage the battery and increase the risk of fire.
20. Have servicing performed by a qualified repair person using only identical replacement parts. This will ensure that the safety of the product is maintained.
21. Do not modify or attempt to repair the appliance or the battery pack except as indicated in the instructions for use and care.
22. Always turn off this appliance before connecting or disconnecting the motorized nozzle.
23. Do not charge or store the appliance outdoors or inside the car. Only charge, store or use the battery in a dry indoor area where the temperature is higher than 39.2°F (4°C) but lower than 104°F (40°C). The charger is for indoor use only.
24. Do not use to pick up ultrafine particles, such as lime, cement, sawdust, gypsum powder, or ashes.
25. Do not use to pick up sharp objects, such as metallic nails, pieces of glass, metal paper clips, or pins.
26. Do not use to pick up hazardous material and chemicals, such as solvent, drain cleaner, strong acids, or strong alkali.
27. Stop using immediately if the appliance is overheating, making unusual noises, producing unusual odors, performing low suction, or leaks electricity.
28. Turn cleaner OFF and disconnect from electrical outlet for long-term storage.
29. Always clean the Dirty Water Tank after each use to avoid potential blockage, which may lead to low suction power, motor overheating, or reduce the service life of the appliance.
30. Store appropriately indoors in a dry place after use.
31. Do not place or submerge appliance in standing water or try to clean flooded areas.
32. All data and technical instructions of this manual are based on results from lab tests of Tineco or designated third parties. The company reserves all rights for final explanations.
33. Do not use the appliance when the water depth is more than 5mm above the surface.

Range of Usage

1. The cordless hard floor cleaner is to be used on indoor hard floors, such as vinyl, tile, sealed wood, etc. Use on a rough surface may not get the best performance.
2. Keep your appliance away from heat sources, such as fireplace or heater, to avoid casing deformation.
3. Do not use to pick up flammable or combustible liquids, ultrafine particles, sharp objects, hazardous material, chemicals or anything that is burning or smoking, as described above.

About Cleaning Solution

1. A large amount of cleaning solution entering into the motor may cause damage to the appliance.
2. Add solution as instructed in the Operation section. We recommend using the provided cleaning solution. Do not use the product with acidic, alkaline solution, or any substances harmful to the environment.
3. Keep out of reach of children. If any solution gets into the eyes, immediately flush them with clean water. If any solution is swallowed by accident, seek medical care immediately.
4. Dirty water and solution disposal should comply with local environmental regulations.

About the Appliance

1. Do not modify or attempt to repair the appliance except as indicated in the instructions for operating and cleaning.
2. Charge the appliance with the Tineco adaptor. Input Voltage: AC 100-240V. Both high and low voltages can damage the adaptor, appliance, or even cause danger to the user.
3. Use extra care when cleaning on stairs.
4. Ensure that the Power Switch is in the OFF-position before picking up or carrying the appliance. Do not lay flat or lean the appliance so as to prevent dirty water from entering into the motor.
5. To avoid being tripped accidentally, please put away the appliance on the charging base.
6. Always install the Dirty Water Tank and Clean Water Tank properly before use.
7. Do not allow the appliance or charger to get wet to avoid risk of fire or injury caused by a short circuit.

Only For NA:

FCC Supplier's Declaration of Conformity

TINECO / FLOOR ONE S3 SERIES

FW050100US,FW050100CA,FW050200US,FW050200CA,FW050300US,FW050300CA,
FW050400US,FW050400CA,FW050500US,FW050500CA

This appliance complies with part 15 of the FCC Rules. Operation is subject to the following two conditions:

(1) This appliance may not cause harmful interference, and (2) this appliance must accept any interference received, including interference that may cause undesired operation.

TINECO INTELLIGENT, INC.

1700 WESTLAKE AVENUE N., SUITE 200, SEATTLE, WA, 98109, USA

WWW.TINECO.COM

1-855-292-8864

Changes or modifications not expressly approved by the party responsible for compliance could void the user's authority to operate the equipment.

Note: This equipment has been tested and found to comply with the limits for a Class B digital appliance, pursuant to Part 15 of the FCC Rules. These limits are designed to provide reasonable protection against harmful interference in a residential installation. This equipment generates uses and can radiate radio frequency energy and, if not installed and used in accordance with the instructions, may cause harmful interference to radio communications. However, there is no guarantee that interference will not occur in a particular installation. If this equipment does cause harmful interference to radio or television reception, which can be determined by turning the equipment off and on, the user is encouraged to try to correct the interference by one or more of the following measures:

- (1) Reorient or relocate the receiving antenna.
- (2) Increase the separation between the equipment and receiver.
- (3) Connect the equipment into an outlet on a circuit different from that to which the receiver is connected.
- (4) Consult the dealer or an experienced radio/TV technician for help.

FCC Radiation Exposure Statement

This equipment complies with FCC radiation exposure limits set forth for an uncontrolled environment. This equipment should be installed and operated with a minimum distance of 20cm between the radiator and any part of your body.

Note

The manufacturer is not responsible for any radio or TV interference caused by unauthorized modifications to this equipment, such modifications could void the user's authority to operate this equipment.

IC Note

This appliance contains licence-exempt transmitter(s)/receiver(s) that comply with Innovation, Science and Economic Development Canada's licence-exempt RSS(s). Operation is subject to the following two conditions:

- (1) this appliance may not cause interference.
- (2) this appliance must accept any interference, including interference that may cause undesired operation of the appliance.

-This Class B digital apparatus complies with Canadian ICES-003.

-This equipment complies with ISSED RSS-102 radiation exposure limits set forth for an uncontrolled environment. This equipment should be installed and operated with a minimum distance of 20cm between the radiator and any part of your body.

Overview

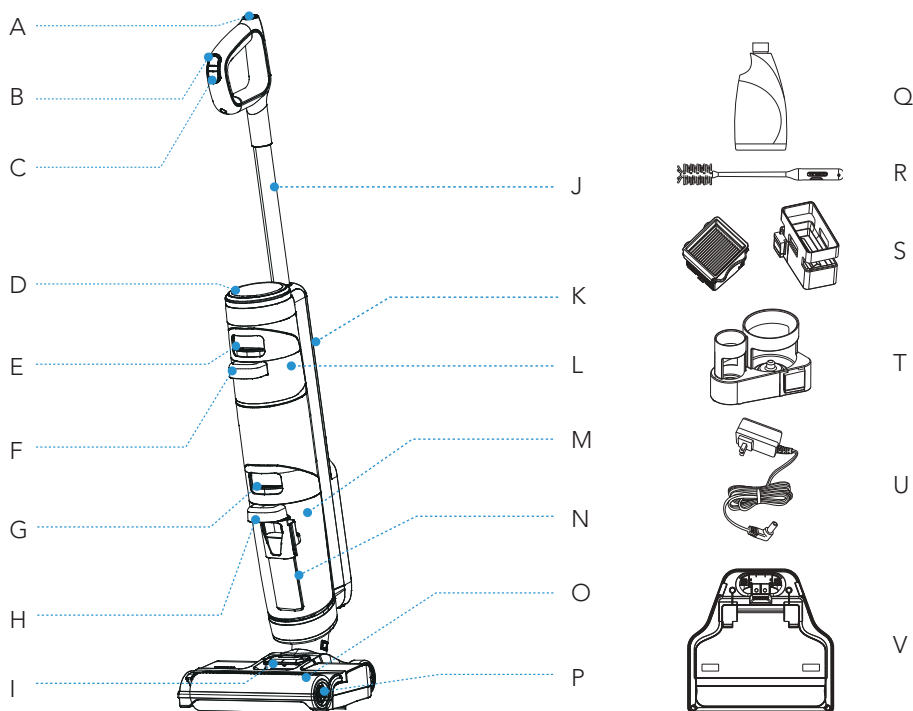

A. Self-cleaning Button

B. AUTO/MAX

C. Power On/Off

D. Digital Display

E. Clean Water Tank Release

F. Clean Water Tank Handle

G. Dirty Water Tank Release

H. Dirty Water Tank Handle

I. Brush Roller Cover Release

J. Tube

K. WiFi/Mute Button

L. Clean Water Tank (CWT)

M. Dirty Water Tank (DWT)

N. Floater

O. Brush Roller Cover

P. Brush Roller

Q. Deodorizing & Cleaning Solution

R. 3-in-1 Cleaning Tool

S. HEPA Filter & HEPA Holder

T. Accessory Holder

U. Adaptor

V. Charging Base

Digital Display

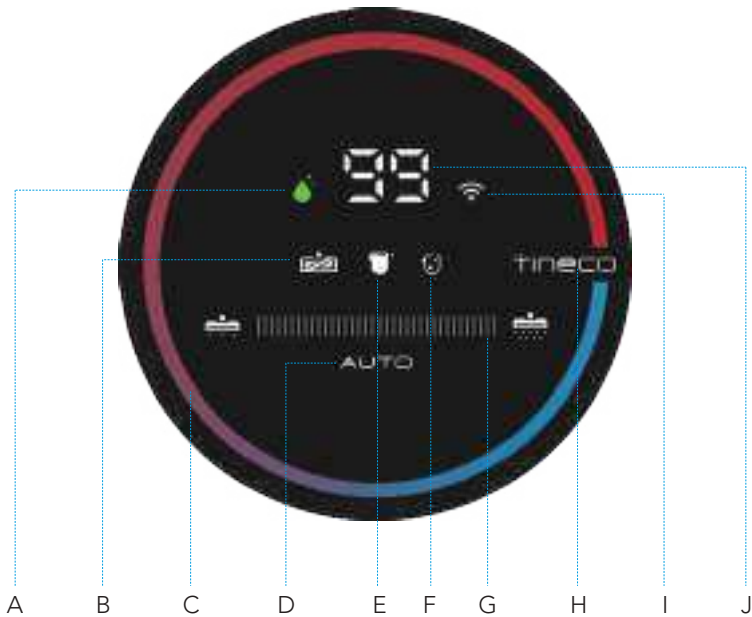

A. Self-cleaning Icon

B. Brush Roller Tangled Indicator

C. Dirt Monitoring Loop
(Blue to red according to the dirt amount)

D. AUTO Mode

E. DWT Full or Blocked

F. CWT Empty

G. Power Indicator

H. Tineco Logo

I. WiFi Indicator

J. Battery Level Indicator

Accessories

Note:

Accessories may vary between markets. If you require other accessories, please make a purchase on the Tineco official website.



www.tineco.com

Products

Parts and Accessories

Buy Now



Deodorizing & Cleaning Solution

Removes dirt, grime, grease and tough stains from most types of hard surfaces, like tile, marble, sealed hardwood floors, and more. Always use Tineco solution in your appliance.

Add one bottle cap of solution to each full tank of clean water.

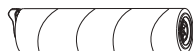

Brush Roller

Soft roller head with bristles can be used to vacuum and wash at the same time. It can be easily cleaned with the self-cleaning function.



3-in-1 Cleaning Tool

A full brush to clean the DWT, brush chamber and opening.

The tool also has a bristled end to remove dirt and mud on the roller and DWT. The tool has a bladed end to remove hair and debris that is wrapped around the roller.

Assembly

How to Assemble/Disassemble

Note:

For water tank and brush assembly, please refer to "Operation" and "Maintenance".

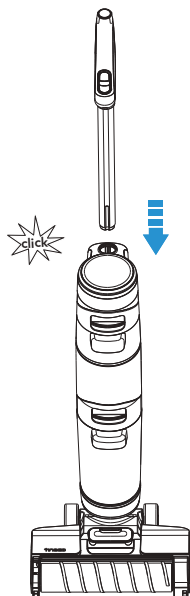

To assemble the handle, insert it into the appliance until you hear a click.

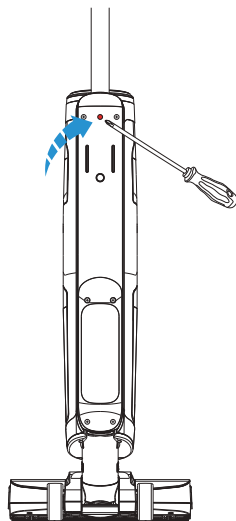

In the event that the product must be returned, please disassemble the handle. Press the spring to release the handle with a tool (like a screwdriver) and lift the released handle from the appliance.



Operation

Preparing for Use

Before first use, please charge the appliance for 4±0.5 hours (refer to “Charging Instructions” for details).

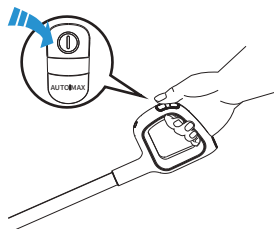
* Based on results from Tineco lab tests. Lab temperature 39.2°F (4°C) ~ 104°F (40°C).



Press the  button and the appliance will start in AUTO mode by default. Press it again to turn off the appliance. Switch between AUTO and MAX mode by pressing the  button.

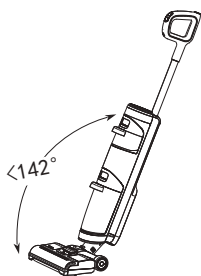

Do not recline the appliance more than 142° to protect against water leakage.

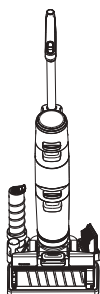

Place the appliance on the charging base vertically after use for recharge and storage.

Note:

- Please add cleaning solution before use. If you decide to only use water, power on while the appliance is in an upright position, long-press  for 3 seconds. Selecting the appropriate mode depending on the CWT contents is vital for maximum dirt detection effectiveness.
- Do not vacuum foamed liquid.
- To vacuum water left on the surface, the appliance will switch off in 3 seconds after power off.

Filling Clean Water Tank

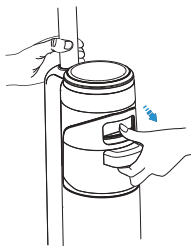

Press the Clean Water Tank release button to remove it from the appliance.

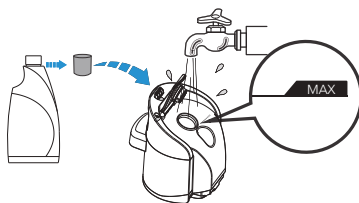

Open the tank cap, and fill with tap water to the Max line. When deep cleaning is necessary, add one bottle cap of solution to the CWT and tightly close the cap.

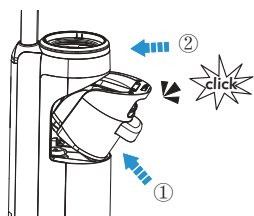

Place the tank back into the appliance. You should hear a "Click" if done correctly.

Note:

Only use water under 140°F/60°C.
DO NOT USE HOT WATER.

Charging Instructions

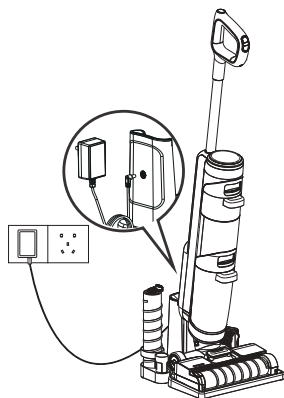

To charge the appliance, place the appliance on the charging base and plug the adaptor into a power outlet.

1. To charge the appliance, connect the external charging cord to the charging base and plug it into the wall outlet.
2. To avoid tripping hazards, please place the appliance on the charging base near a wall during charging.



Warning:

- Only charge the appliance with the adaptor supplied by Tineco.
- During long periods of not being used, the appliance must be charged once every 3 months for optimal performance. It may take 4±0.5 hours for a full charge.
- Store indoors in a dry place. Do not expose the appliance to sunlight or freezing temperatures. Recommended temperature range: 39.2°F (4°C) ~ 104°F (40°C).

Cleaning Mode Selection

AUTO Mode

- In AUTO mode, the iLoop™ sensor automatically detects how dirty the floor is and applies the appropriate amount of detergent and suction power.
- A red dirt monitoring loop indicates more dirt is detected, and a blue loop indicates less dirt is detected. This mode automatically provides the best cleaning solution.



AUTO



Clean: on Min Power



Vary depending on dirt amount



Heavy dirt: on Max Power

MAX Mode

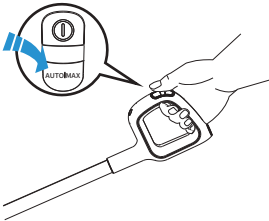

- In AUTO mode, press the AUTO/MAX button to enter MAX mode. The AUTO indicator on the display will turn off.
- In Max mode, the appliance will apply max suction power and will spray water/solution (about 220ml/min) for deeper cleaning.

Note:

Keep sharp objects away from the digital display screen to avoid scratches and scrapes.

Runtime

- When in AUTO mode, the runtime is approximately 35 minutes. When MAX power is used, the runtime is approximately 25 minutes.
- Estimated runtime data was obtained by a Tineco Laboratory.

Charging Time

- A full charge takes approximately 4±0.5 hours.
- Estimated data was obtained by a Tineco Laboratory using ambient temperatures between 39.2°F (4°C) to 104°F (40°C).

Indicator

When in Use



Battery level ≥ 10%: battery indicator will be illuminated.



Battery level < 10%: battery indicator will be blinking.



Off: no power detected or possible battery malfunction.



Blinking red: dirt sensor malfunction or blocked.



Indicator blinking: CWT is empty.



Indicator blinking: DWT is full or channel has a blockage.



Indicator blinking: brush roller is not installed or has a blockage.



Illuminated: WiFi has successfully connected.





Blinking: WiFi is connecting.



Off: WiFi is not connected, please connect to the network.



Indicator blinking: appliance is in need of self-cleaning.

During Charging



Tineco indicator: blinking.

Fully Charged



In 5 minutes: Tineco indicator illuminated.
After 5 minutes: all indicator lights turn off.

App

All the functions can be performed using the Tineco app. Download the Tineco app from the App Store, Google Play and Tineco Official Site.



Q Tineco



✓ iOS 9.0 or later

✓ Android 5.0 or later