

**PHILIPS**

Wireless Speaker

TAS5505

TAPROOZ



# User manual

Register your product and get support at  
[www.philips.com/support](http://www.philips.com/support)

# Contents

---

<b>1</b>	<b>Important</b>	<b>2</b>
	Safety	2

---

<b>2</b>	<b>Your wireless speaker</b>	<b>3</b>
	Introduction	3
	What's in the box	3
	Overview of the speaker	3

---

<b>3</b>	<b>Get started</b>	<b>4</b>
	Charge the built-in battery	4
	Turn on/off	4

---

<b>4</b>	<b>Play from Bluetooth devices</b>	<b>5</b>
	Play from Bluetooth devices	5
	Control playback	5
	Control phone call	5
	Pairing for stereo mode	5

---

<b>5</b>	<b>Other features</b>	<b>6</b>
	Play from an external audio device	6
	Multi-color LED light	6

---

<b>6</b>	<b>Product information</b>	<b>7</b>
----------	----------------------------	----------

---

<b>7</b>	<b>Troubleshooting</b>	<b>8</b>
	General	8
	Bluetooth	8

---

<b>8</b>	<b>Notice</b>	<b>9</b>
	Compliance	9
	Care of the environment	9
	FCC Statement	9
	Trademark notice	10

# 1 Important

## Safety

### Important safety instructions

- Make sure that the power supply voltage corresponds to the voltage on the back or the underside of the unit.
- The speaker shall not be exposed to dripping or splashing.
- Do not place any source of danger on the speaker (e.g. liquid filled objects, lit candles).
- Make sure that there is enough free space around the speaker for ventilation.
- Please use the speaker safely in an environment with temperature between 0° and 45°.
- Only use attachments and accessories specified by the manufacturer:



### Warning

- Never remove the casing of this speaker.
- Never lubricate any part of this speaker.
- Place this speaker on a flat, hard and stable surface.
- Never place this speaker on other electrical equipment.
- Only use this speaker indoors. Keep this speaker away from water, moisture and liquid-filled objects.
- Keep this speaker away from direct sunlight, naked flames or heat.
- Risk of explosion if a battery is replaced by an incorrect type.

### Battery safety precautions

- Danger of explosion if a battery is incorrectly replaced. Replace only with the same or equivalent type.
- A battery (battery pack or battery installed) shall not be exposed to excessive heat such as sunshine, fire or the like.
- A battery in extreme high or low temperatures during use, storage or transportation, and low air pressure at high altitude can pose safety hazards.
- Do not replace a battery with an incorrect type that can defeat a safeguard (for example, some lithium battery types).

## 2 Your wireless speaker

Congratulations on your purchase, and welcome to Philips! To fully benefit from the support that Philips offers, register your product at [www.philips.com/welcome](http://www.philips.com/welcome).

### Introduction

With this speaker, you can enjoy audio from Bluetooth-enabled devices or other audio devices through a 3.5mm audio-in cable.

### What's in the box

Check and identify the contents of your package:

- Speaker
- USB cable
- Audio cable
- Quick start guide
- Safety sheet
- Worldwide warranty

### Overview of the speaker

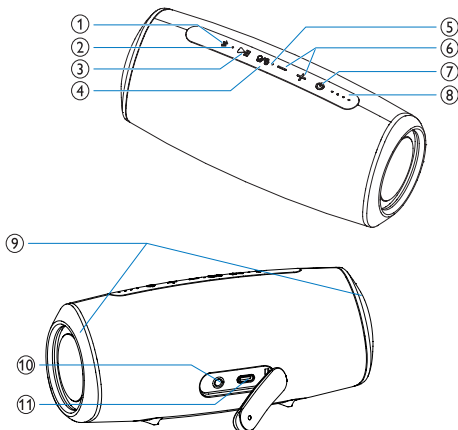

- ①
  - Enter Bluetooth pairing mode.
  - Clear Bluetooth pairing information.
  - Respond to an incoming call through Bluetooth connection.
- ② **LED indicator**
- ③
  - In Bluetooth mode, press to pause or resume play.
  - In Bluetooth mode, press twice to play the next track..
- ④
  - Press to turn the Multi-color LED light on or off.
  - Press and hold to enter stereo pairing mode.
- ⑤ **Microphone**
- ⑥
  - Adjust volume.
- ⑦
  - Turn the speaker on or off.
  - Check the battery level.
  - Show the Bluetooth status.
- ⑧ **Battery level indicators**
  - Show the charging progress.
  - Show the battery level.
- ⑨ **Multi-color LED light**
- ⑩
  - Connect an external audio device.
- ⑪
  - Charge the built-in battery.

## 3 Get started

Always follow the instructions in this chapter in sequence.

### Charge the built-in battery

The speaker is powered by a built-in rechargeable battery.

#### Note

- Fully charge the built-in battery before using.
- When the speaker is turned on and the battery is low, the battery level LED indicator blinks green.

Connect the USB-C socket on the speaker to an outlet (5V = 3A) by using the provided USB cable.

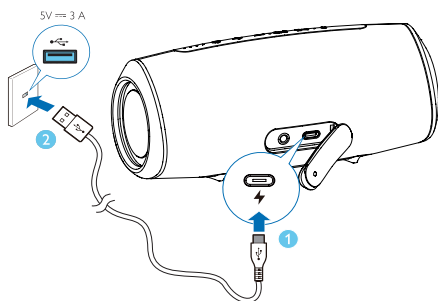

- ↳ When the speaker is being charged, the battery level LED indicator lights up gradually.
- ↳ When the speaker is fully charged, the battery level LED indicator lights on.

#### ! Caution

- Risk of speaker damage! Make sure the power supply voltage corresponds to the voltage printed on the back or the underside of the speaker.
- Risk of electric shock! When unplug the USB cable, always pull the plug from the socket. Never pull the cable.
- Use only a USB cable specified by the manufacturer or sold with this speaker.

### Turn on/off

Press  to turn the speaker on.

- ↳ You will hear the prompt sound.
- ↳ If no external audio device is connected to the AUX socket, it will enter Bluetooth pairing mode automatically and the LED indicator will blink blue.

To turn the speaker off, press  again.

#### Note

- The speaker will turn off automatically after 15 minutes without audio signal from Bluetooth or via AUX IN.