

LEXIBOOK®

JG7440

TV Game Console



Mode d'emploi • Instruction manual • Manual de instrucciones
Manual de instruções • Manuale di istruzioni • Bedienungsanleitung
Gebruikershandleiding • Brugsanvisning • Instrukcja obsługi
Návod k použití • Használati utasítás

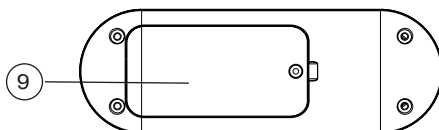
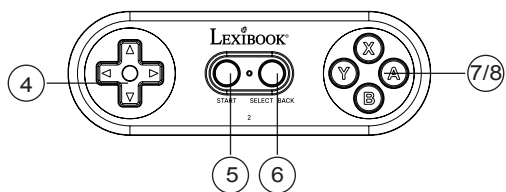
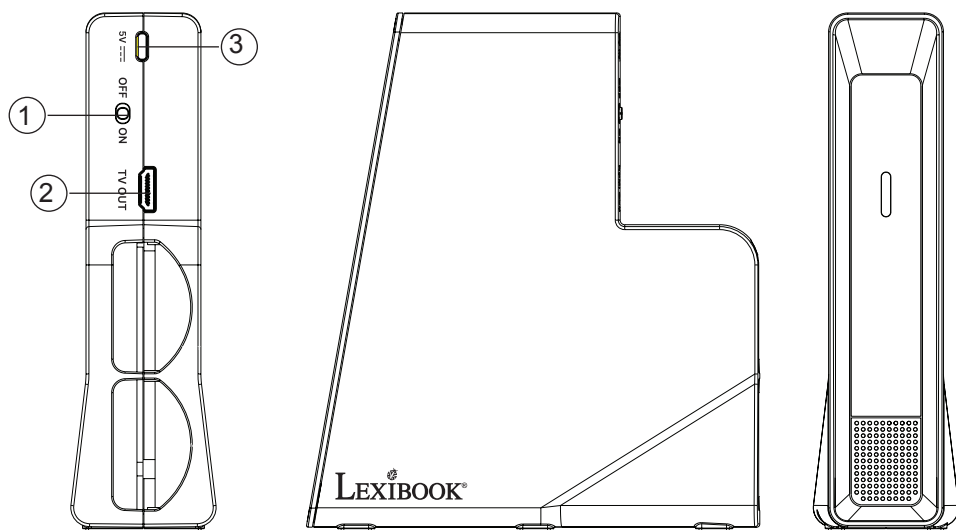

MOTION SPORTS GAMES (30)

FUNNY BASEBALL	FRUIT MASTER	BASKETBALL	ICE HOCKEY
HAPPY TRAMPOLINE	TENNIS	CANOE SLALOM	ROWING
CLASSICAL BOWLING	PINGPONG TENNIS	THROWING GOBLIN	ARCHERY
SUPER FIGHTERS	POKE BUBBLE	HAPPY MINER	EQUESTRIAN BOY
HAPPY PARKOUR	FENCING	CATCHING LOACHES	JUMPING EGGS
HAPPY SKIPPING ROPE	HAPPY CURLING	HAPPY OSTRICHES	DARTS
RUNNING TALENT	FISHING	MINI SOCCER	
HUNDERD-METER FLYER	THROWING JAVELIN	JUMP JUMP	

PUZZLE CASUAL GAMES (100)

EVERYBODY FISHING	CARTOON AIRCRAFT BATTLE	ADVENTURE BUNNY	ROBOT WARS
TRAMPLE GOBLIN	ROULETTE	PASTRY PARTY	SHAPE SWITCHER
BEANS KING	ODD EVEN NUMBER	CAKE SHOP	SPIN MATCH
DREAM OF GEMS	DOOM RAILS	BOMBER BOY	COLORED GEMS
CARTOON AIR WAR	EYE CHALLENGE	CARTOON PUZZLE	SUPER PIZZA
MIX & MATCH	FLYING	CHANGE CUP	SUPER PORTERS
JACK OR EGGS	CONNECTING PIPE	SEA FIGHT	CRAZY CAT
PIGPY GO HOME	JACK'S ADVENTURES	DIAMOND FOREST	COLLAPSED BLOCK
FLIGHT CHESS	JUMPING MICE	GO DOWNSTAIRS	TURN STONE
PENGUIN TREASURE HUNT	JUMPING RABBIT	ANIMAL WAR	BOUNTY HUNTERS
SUBMARINE WAR	KILL THE VIRUS	GOOD FISHERMAN	X-TRAINING
SEABED BUBBLE	NAUGHTY MONKEY	HAPPY BIRDS	SPOT DIFFERENCE
SUDOKU	PINBALL	IQ COW	BEE OF WAR
GOBANG	PLANE FIGHT 2	JAPANESE SUMO	CHESS
DIGITAL MEMORY	SEA AIR WAR	HAPPY BABY KARTING	ICE BLOCKS
BALL ESCAPE	SPACE FIGHTER	STREET BASKETBALL	RABBIT CROSSING THE RIVER
MINE CLEARANCE	SPACE RESCUE	MATCH CARTOON	TABLE FOOTBALL
HIGHWAY RACING	SPACE WALKER	BRAIN CHALLENGE	FREECELL
RESCUE PETS	ANIMALS MACHINES	MAZE TRAP	CONNECTING LINES
BIG EATER	STREETS VOLLEYBALL	CRAZY PIRATE SHIP	COLORLED SQUARES
BOME PRINCESS	BIG SHOT CHECKERS	THE BEER MASTER	JUMP JACK
OPEN BOXS	BLACK JACK	POCKET CHANGE	SOKOBAN
MAHJONG CLEAN	GEM ELIMINATE	PRECIPICE	GO UPSTAIRS
BILLIARD BALL	BALLOON SHOOT	CAR PARK	PLANE FIGHT
CRAZY BBQ	BUMPER BALLS	PUSH COLOR	BUBBLE FROG

SHOOTING GAMES (20)

SNIPER AIRBORNE	DUMP SHOOTER	LIGHTNING GUNNER	SHOOTING DUCK
ANNOYING BIRD	FRISBEE ARENA	PERFECT COUNTERATTACK	SPLIT BOMB
CAVE GHOST	FRUIT SHOOTER	RAGA OF WARS	STREET GUNMAN
CLEAR ROAD-BLOCK	HOSTAGE CRISIS	SEA OF FIRE	TOY SHOOTER
DEER HUNTING	INTERCEPT MINES	SHARPSHOOTER	DRAGON HUNTER

CLASSIC GAMES (100)

ABSCONDEE	BURBLES	FEARMASTER	PINDABLE
AERIAL HERO	BURROW EXPLORER	FINAL BLOOD	POBBLE
AERIAL WARFARE	BUSY BAR	FIRST DEFENDER	POLAR BAT
AETHER CRUISER	CANDY WORKSHOP	FISHING	PUZZLE
AETHER	CANNONADE	FIVE DAYS	RACING FIGHTER
AIM CRUISE	CIRCLE RACING	FLING BALL	SEA WOLF
AIMLESS	CLIMBING	GALLAGANT	SEAPORT GUARL
ANGEL	CLOSE QUARTERS	GHOST CASTLE	SUBMARINE
ANIMAL BLOCKES	COAST GUARD	GOAL KEEPER	SURFG SPORT
ANIMAL CONTEST	COLLIDING	GOBLET TOWER	TENNIS
AQUARIUM	CONTEST	GREEDS	THE ARCHER
ARENA	COOKIES LABYRINTH	HAPPY MATCH	THE HACKER
ASSART	CRYSTAL BLAST	ICE OCEAN	THROUGH MAN
AWFUL RUSH	CUB ADVENTURE	LABYRINTH	TWIN CARDS
BALLOON SHOOT	CUT FISH	LITTLE WITCH	TWIN FISH
BASEBALL	DANGER BRIDGE	LUNARIAN	UNDERSEA ARENA
BLOBMAN	DARK CASTLE	LUNATION	UTMOST WARFARE
BLOCKS WORLD	DEFENSIVE	MAD XMAS	VANGUARD
BOAT RACE	DEVILDOM DOOM	MAN IN RED	VIGILANT
BOMB KING	DIFFERENCE	MARMOT	WARRIOR
BOXWORLD	DUNE WAR	MECCANO	WATER PIPE
BROTHER BALL	EGG CONTEST	MOVE BOX	WILD WORM
BUBBLE	EIDOLON'S REVENGE	MUSIC MOMENT	WONDER BALL
BUG CATCHER	ESCAPEWAY	OCTOPUS SEA	WONDER RABBIT
BUG'S WAR	FATED PIRATE	PANZER ATTACK	ZOOM

Introduction

Thank you for purchasing this Lexibook "TV Games Console".
Please read the following instructions to discover all its functions and understand the safety rules.

Contents of the packaging

When unpacking, ensure that the following elements are included:

- 1 x game console "TV Games Console"
- 2 x wireless controllers
- 1 x TV cable
- 1 x USB-C power cable
- 1 x instruction manual

WARNING: All packaging materials, such as tape, plastic sheets, wire ties and tags are not part of this toy and should be discarded for your child's safety.

Key guide

Console

Note: Refer to diagram p.2.

1. POWER key: to turn the game console on or off
2. TV port
3. USB-C power input

Controller

Note: Refer to diagram p.2.

4. Directional keys: to navigate within the menus and play games (Up/Down/Left/Right)
5. START key: to start playing
6. SELECT / BACK key
- 7/8. A, B, X and Y keys: to play the games.

Note: The function of the key depends on the game.

9. Battery compartment

Battery Information

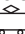
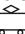
The "TV Games Console" shall only be used with the USB-C power cable provided (5.0V , 1000 mA ) and an adapter (not included).

Adapter Specification:

Input: 100V-240V~ 50/60Hz, 0.3A Output DC 5.0V  1.0A 5.0W

The 2 wireless controllers work with 2 x 1.5V  AAA/LR03 type batteries each (not included).

Parental advisory: transformer and adaptor for toys are not intended to be used as a toy. The usage must be under parental advice.

Console:

1. Make sure the game console is switched off.
2. Plug the USB-C cable (included) into the port on the back of the console ③.
3. Plug the other end of the cable into an AC adapter (not supplied) and then into a power outlet.
4. Switch the game console on ①.

Note: The toy is not to be connected to more than the recommended number of transformers or power supplies.

Warning: Disconnect the adapter if the game is not used for a long period of time to prevent overheating. When the game is powered by an adapter, do not play outside. Check the state of the adapter and the connection cords regularly. If their condition is deteriorating, do not use the adapter until it has been repaired. The toy shall only be used with a transformer for toys. The adapter is not a toy. The console should be disconnected from the power supply to be cleaned if liquids are used for cleaning. The toy is not intended for children under 3 years old. Misuse of transformer can cause electrical shock.

Wireless controllers:

1. Use a screwdriver to open the battery compartment located at the back of the controller.
2. Install the 2 x LR03/AAA type batteries observing carefully the polarity indicated at the bottom of the battery compartment and as per the diagram shown below.
3. Close the battery compartment and tighten the screw.
4. Repeat the 3 previous steps to install the batteries of the second controller.

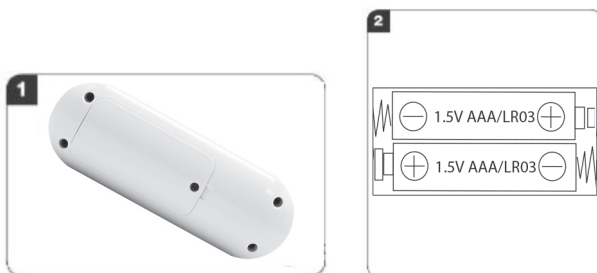

Non-rechargeable batteries are not to be recharged. Rechargeable batteries are to be removed from the toy before being charged. Rechargeable batteries are only to be charged under adult supervision. Different types of batteries or new and used batteries are not to be mixed. Only batteries of the same or equivalent type as recommended are to be used. Batteries are to be inserted with the correct polarity. Exhausted batteries are to be removed from the toy. The supply terminals are not to be short circuited. Do not throw batteries into a fire. Remove the batteries if you are not going to use the game for a long period of time. Battery shall not be exposed to excessive heat such as sunshine, fire or the like.

The toy is only to be connected to equipment bearing either of the following symbols:



WARNING: Mal-function or loss of memory may be caused by strong frequency interference or electrostatic discharge. Should any abnormal function occur, reset the unit or remove the batteries and insert them again, or unplug the adapter from the mains socket and plug it back in.

Safety Instructions

PLEASE READ BEFORE OPERATING THIS EQUIPMENT.

Before using the unit, be sure to read all operating instructions carefully. Please note that these are general precautions and may not pertain to your unit

1. Read this Instruction Manual before you attempt to connect or operate the appliance.
2. Keep these instructions in good condition. Heed all warnings. Follow all instructions.
3. Save this Instruction Manual for future reference.
4. The apparatus shall not be exposed to dripping or splashing and no objects filled with liquids, such as vases, shall be placed on the product. Dry location use only.
5. No naked flame source, such as candles, should be placed on the product.

6. Ventilation should not be impeded by covering the ventilation openings.
7. Only use accessories, which are specified by the manufacturer.
8. Use replacement parts, which are specified by the manufacturer.
9. Install the unit in accordance with the manufacturer's instructions.
10. Place the unit where there is good ventilation. Place the system on a flat, hard and stable surface.
Do not expose to temperatures above 40°C. Allow at least 10 cm clearance from the rear and the top of the unit and 5 cm from each side.
11. Press the players buttons gently. Pressing them too hard can damage the player.
12. Dispose of used batteries in an environmental-responsible manner.
13. Always ensure that the product is unplugged from the electrical outlet before moving or cleaning.
Clean it with dry cloth only.
14. Turn off the product during lightning, storms or when it will not be used for long periods of time.
15. This product has no user-serviceable parts. Do not attempt to repair this product yourself. Only qualified service personnel should perform servicing. Take the product to the electronics repair shop of your choice for inspection and repair.
16. NEVER let anyone, especially children, push anything into holes, slots or any other openings in the unit's casing as this could result in a fatal electric shock.
17. Don't mount this product on a wall or ceiling.
18. Do not place the unit near TVs, speakers and other objects that generate strong magnetic fields.
19. Do not leave the unit unattended when it is in use.
20. Keep minimum distances around the apparatus for sufficient ventilation.
21. The ventilation should not be impeded by covering the ventilation openings with items, such as newspapers, table-cloths, curtains, etc.
22. The use of apparatus in moderate climates.
23. Batteries should be disposed of properly. Take them to the collection container in order to protect the environment.

Connecting the console to a TV set

The "TV Games Console" must be plugged to a TV set.

Note: The TV set and the console **MUST BE TURNED OFF**.

1. Insert one end of the TV cable into the console ② and the other end of the cable into the TV's TV port.
2. Switch on the TV set and turn on the console.

Positioning the console in the play area:

- Place the console observing carefully the diagram shown opposite.
- Ensure you have enough space and there are no obstacles in the play area (furniture, overhead light, carpet...)
- Place the console on a flat and steady table at about the same height as the television.
- Play directly in front of the television within a distance of 1 meter from the console.

Note: Do not use other controllers in the same room and during the game, it may occur abnormal function of the console.

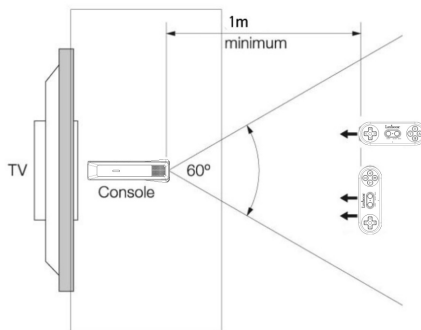

Note: In order to show the image transmitted by the main unit, you must set your television to the input jack being used. Input selection button may be located differently upon TV manufacturer and labeled as: select, input, input select, line, line in, source, in, EXT or AUX. Please refer to your TV's instruction manual for further information.

Let's play

Pairing controllers with the console.

- Power on the console.
- Press any key on the controller. A red light will blink on the controller keep on when pairing is completed.
- Repeat above procedure for the second controller.



ENGLISH

List of games

30 interactive sport games

Please kindly refer to the games list provided on page 3.

Note: In these games there are one or two players. Hold the controller in one hand.

Note: For the shooting games, please aim using the arrows on the controller (4), and shoot by moving the controller in a fast, downward motion.

220 arcade and mini games

Please kindly refer to the games list provided on page 3.

Specifications

Frequency range: 2400MHz – 2500MHz

Transmission power: 6dBm

Adapter

Input

AC 100V-240V~ 50-60Hz 0.3A

Output

DC 5.0V  1.0A 5.0W

Epilepsy Warning

Read before you or your children use video games. Some people are prone to epileptic seizures or losses of consciousness as a result of seeing certain flickering lights or objects often present in daily life. These people are at risk from seizures when they watch certain television images or play certain video games. Such incidents can happen even if the person has no previous medical history of epilepsy. If you or a member of your family has ever displayed symptoms linked with epilepsy (seizures or loss of consciousness) while watching flickering lights or images, consult your doctor before use.

Parents are advised to supervise their children while playing video games. If you or your child shows any of the following symptoms: dizziness, vision problems, eye or muscle tenseness, loss of consciousness, involuntary movements or seizures, cease playing immediately and consult your doctor.

Precautions to take in any case while using a video game:

- When you use a video game which can be connected to a TV screen, stand or sit relatively far from the TV screen and as far as the connection cable allows it.
- Use preferably video games which have a small screen. Avoid playing video games if you are tired or lack some sleep.
- Make sure to play in room which is well lit.
- While playing video games, take 10 to 15 minute breaks every hour.

Simplified EU Declaration of Conformity

We, Lexibook® S.A.
Bât 11., 6 avenue des Andes
91940 Les Ulis - France
Kind of product: Gaming Console
Type designation: JG7440

Lexibook UK
PO Box 423, UMBERLEIGH
EX32 2JW, United Kingdom

Hereby, Lexibook Limited declares that the radio equipment type JG7440 is in compliance with Directive 2014/53/EU and Radio Equipment Regulations 2017.

The full text of the EU declaration of conformity is available at the following internet address:
<http://www.lexibook.com/doc/JG7440.pdf>

Yiu Wai Man

Yiu Wai Man
Product Development Manager
Hong Kong



Maintenance and Warranty

Only use a soft, slightly damp cloth to clean the unit. Do not use detergent. Do not expose the unit to direct sunlight or any other heat source. Do not immerse the unit in water. Do not dismantle or drop the unit. Do not try to twist or bend the unit.

NOTE: please keep this instruction manual, it contains important information.

This product is covered by our 2-year warranty.

For any claim under the warranty or after sale service, please contact your distributor and present a valid proof of purchase. Our warranty covers any manufacturing material and workmanship defect, with the exception of any deterioration arising from the non-observance of the instruction manual or from any careless action implemented on this item (such as dismantling, exposition to heat and humidity, etc.). It is recommended to keep the packaging for any further reference. **WARNING!** Not suitable for children under 3 years. Choking Hazard-Small parts. In a bid to keep improving our services, we could implement modification on the colours and the details of the product shown on the packaging.

Reference: JG7440
Designed and developed in Europe
– Made in China
©LEXIBOOK®

Lexibook S.A.
6 avenue des Andes
Bâtiment 11
91940 Les Ulis
France

Lexibook UK
PO Box 423
UMBERLEIGH
EX32 2JW
United Kingdom

United Kingdom & Ireland

For after-sales service, please contact us at savcomfr@lexibook.com

www.lexibook.com

Environmental Protection:

Unwanted electrical appliances can be recycled and should not be discarded along with regular household waste! Please actively support the conservation of resources and help protect the environment by returning this appliance to a collection centre (if available).



This device complies with Part 15 of the FCC Rules. Operation is subject to the following two conditions: (1) this device may not cause harmful interference, and (2) this device must accept any interference received, including interference that may cause undesired operation.

Changes or modifications to this unit not expressly approved by the party responsible for compliance could void the user ' s authority to operate the equipment.

NOTE: This equipment has been tested and found to comply with the limits for a Class B digital device, pursuant to Part 15 of the FCC Rules. These limits are designed to provide reasonable protection against harmful interference in a residential installation. This equipment generates uses and can radiate radio frequency energy and, if not installed and used in accordance with the instructions, may cause harmful interference to radio communications. However, there is no guarantee that interference will not occur in a particular installation. If this equipment does cause harmful interference to radio or television reception, which can be determined by turning the equipment off and on, the user is encouraged to try to correct the interference by one or more of the following measures:

- Reorient or relocate the receiving antenna.
- Increase the separation between the equipment and receiver.
- Connect the equipment into an outlet on a circuit different from that to which the receiver is connected.
- Consult the dealer or an experienced radio/TV technician for help.

This device and its antenna(s) must not be co-located or operation in conjunction with any other antenna or transmitter.

Radiation Exposure Statement

The device has been evaluated to meet general RF exposure requirement in portable exposure condition without restriction.