

Smart Watch User Manual



Please make a full charge before using it.

APP:FitCloudPro

English

1. Product introduction and button definition

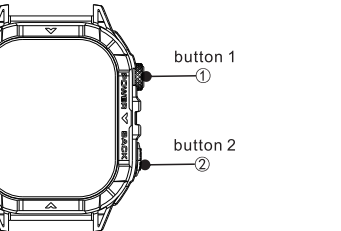

Button ① definition:

Power button

Short press: Short press the watch face interface once to enter the application list interface, short press once on the application list interface to return to the watch face interface.

Long press for 3 seconds: power on/off, restart, reset(long press to display the menu selection).

Button ② definition:

Back button/shortcut key:

Short press:

- A. Other pages return to the previous level.
- B. Short press under the screen off to light up the screen.
- C. Pause/continue during exercise.
- D. Short press when a call comes in, mute.

-01-

Long press for 3 seconds: Turn on sports mode.

2. Touch screen control definition

↓ **Swipe down:** Swipe down on the dial interface to open the status bar.

↑ **Swipe up:** Swipe up on the dial interface to enter the notification information interface.

← **Swipe left:** Swipe left on the dial interface to enter the card shortcut function.

→ **Swipe right:** Swipe right on the dial interface to enter the main menu interface.

Press the dial on the dial interface for 2-3 seconds to switch the dial, swipe left and right to select the dial and click the selected dial.

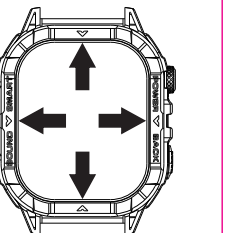

3. Charging

3.1 When the watch prompts that the battery is low, please charge it in time. The charging time is 2-3 hours.

3.2 The watch is magnetically charged. Align the charging contact of the charging cable with the charging port of the watch to charge until the watch screen displays the charging prompt.

3.3 When charging, in order to ensure stable charging, the watch will turn off the screen to charge. Click the button to wake up the watch. When the battery level of the watch is too low, it takes 3-5 minutes to wake up the watch. This is normal.

-02-

Please wait for 5 minutes before checking the charging status of the watch.
3.4 Please use a charger with a rated output voltage of 5V and a rated output current of 0.5A-2A or a computer USB port to charge the watch.
3.5 When the watch is not used for a long time, please fully charge it and turn it off for storage. Do not store it for a long time when it is low on power. To avoid damaging the battery due to long-term low power storage.

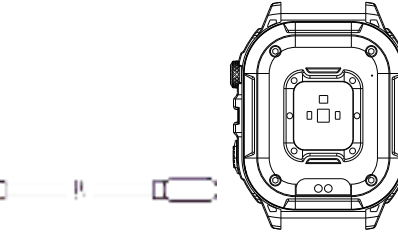

4. APP connection

Scan the watch QR code or enter the major application markets to download and install the "FitCloudPro" APP. When you open the APP for the first time, a pop-up window will pop up to remind you of the permissions. Please click "Allow" to ensure that the APP can obtain the corresponding permissions.

-03-

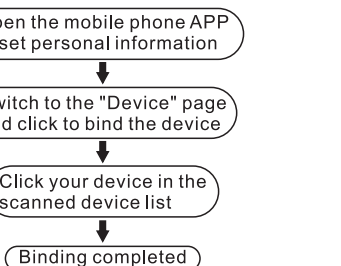

During the connection process, there will be a pop-up window prompt to confirm the pairing connection with the watch and mobile phone. Please click to confirm the pairing. After the connection is successful, the call icon and data connection icon in the watch status bar will turn green. Red means not connected.



BT Call and APP Disconnected

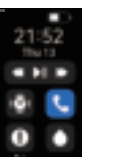

APP Connected BT Call Disconnected



APP Connected BT Call Connected

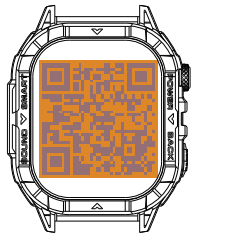

Scan Watch QR Code

5. APP Unbinding

IOS: Find "Unbind" in the APP "Device" interface and click Unbind to enter the "Settings-Bluetooth" interface of the mobile phone system, click on the right side of the device, and then select "Forget this device" to unbind from the mobile phone system to ensure that it is no longer connected to the mobile phone, otherwise it will not be able to connect again next time.

Android: Find "Unbind" in the APP "Device" interface and click Unbind to disconnect from the mobile phone.

6. Precautions

6.1 Do not charge in the presence of water stains.

6.2 This device is not a medical device, and the data and information provided are for reference only.

6.3 Do not wear it in hot showers or saunas to prevent steam intrusion. If the watch is damaged by water due to non-use according to the instructions, the company will not provide free warranty.

6.4 Do not place the device in direct sunlight, such as car dashboards or windowsills.

6.5 Do not place the device near heat sources or exposed fire sources, such as induction cookers, microwave ovens, ovens, water heaters, fires, candles or other places that may produce high temperatures.

6.6 Do not allow children or pets to swallow the device or its accessories to avoid injury or device failure.

6.7 This device is not a toy. Children should use the device under adult supervision.

6.8 This device is equipped with a non-removable built-in battery. Do not replace the battery by yourself.

6.9 If the watch has been in contact with water, please wipe off the water stains on the surface of the watch in time after leaving the water source. If there is too much residual water stains in the speaker cavity and it is not discharged in time, it may

-05-

affect the sound effect. Please find the speaker outlet and shake out the residual water stains in the cavity in time.

FCC Statement

This device complies with part 15 of the FCC rules. Operation is subject to the following two conditions: (1) this device may not cause harmful interference, and (2) this device must accept any interference received, including interference that may cause undesired operation.

Changes or modifications not expressly approved by the party responsible for compliance could void the user's authority to operate the equipment.

NOTE: This equipment has been tested and found to comply with the limits for a Class B digital device, pursuant to part 15 of the FCC Rules. These limits are designed to provide reasonable protection against harmful interference in a residential installation. This equipment generates uses and can radiate radio frequency energy and, if not installed and used in accordance with the instructions, may cause harmful interference to radio communications. However, there is no guarantee that interference will not occur in a particular installation. If this equipment does cause harmful interference to radio or television reception, which can be determined by turning the equipment off and on, the user is encouraged to try to correct the interference by one or more of the following measures:

- Reorient or relocate the receiving antenna.
 - Increase the separation between the equipment and receiver.
 - Connect the equipment into an outlet on a circuit different from that to which the receiver is connected.
 - Consult the dealer or an experienced radio/TV technician for help.
- The device has been evaluated to meet general RF exposure requirement. The device can be used in portable exposure condition without restriction

-06-