

Instruction manual

Thanks!

For choosing this product

P11-B

Battery Type:	Lithium Polymer Battery
Battery Capacity:	10000mAh/3.85V/38.5Wh
Type-c Input:	5V==3A, 9V==2A, 12V==1.5A
Type-c Output:	5V==3A, 9V==2.22A, 12V==1.67A
USB-A Output:	5V==3A, 9V==2A, 12V==1.5A, 10V==2.25A
Type-c cable Input:	5V==3A, 9V==2A, 12V==1.5A
Type-c cable Output:	5V==3A, 9V==2.22A, 12V==1.67A
USB cable Input:	5V==2A
Lightning cable Output:	5V==2A
Wireless charging output:	5W/7.5W/10W/15W(MAX)
Multi-Port Total Output:	5V==3A
Maximum Output:	22.5W
Power display:	LED light display
Operating temperature:	-10°C/40°C

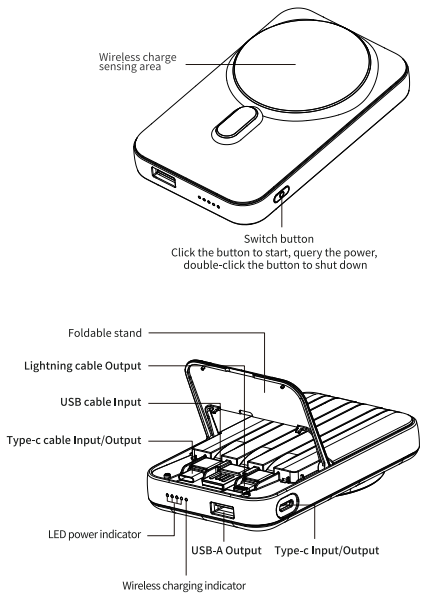

4 capacity indicator lights.

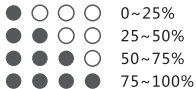

Charging mobile power

Plug and charge without pressing the button.

- 1) Flashing lights, it's charging.
- 2) The amount of flashing indicator lights shows the amount of current electricity
- 3) 4 Capacity lights on, fully charged.

Charging Devices

Capable of charging more than 95% of smartphones and other devices on the market.

Wired charging

- 1) Flashing lights, it's charging device.
- 2) The amount of flashing indicator lights shows the remains of electricity

Wireless charging

Product standby or boot without pressing the button, directly put the phone in the center of the wireless transmission coil

When wireless charging is working, the blue light of the wireless charging indicator is long and bright, and the maximum of wireless charging is 15W.

Wireless charging tips

1. Place the wireless charging mobile phone in the wireless charging area of the product (the wireless charging coil transmitting area is shown in the figure) for wireless charging, please adjust the wireless red dot charging distance of the mobile phone within the wireless charging range.

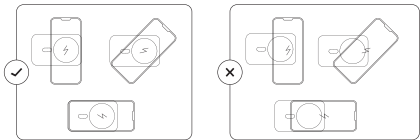

2. The charging contact surface on the back of the phone should not contain metal materials, such as iron sheets, rings, metal protective shells, etc.
3. When charging the mobile phone, if intermittent charge and discharge or hot heat are found, it is probably because the mobile phone receiving ring and the wireless charging coil are not fully aligned, and there are metal foreign objects in the mobile phone protective case, please try to cool the mobile phone, remove the protective case and then align the normal position.
4. The product generates heat during wireless charging. When the felt temperature is in the range of 50-60°C (it feels hot to the touch, but the hand can continue to touch (more than 30 seconds)), it is the normal temperature of the normal working load under the wireless charging function, which is in the safe range. If there is abnormal heat (hand touch product is hot, contact within 5 seconds must be off the hand), please contact customer service immediately.

FCC Warning Statement: Changes or modifications to this unit not expressly approved by the party responsible for compliance could void the user's authority to operate the equipment. This equipment has been tested and found to comply with the limits for a Class B digital device, pursuant to Part 15 of the FCC Rules. These limits are designed to provide reasonable protection against harmful interference in a residential installation. This equipment generates, uses and can radiate radio frequency energy and, if not installed and used in accordance with the instructions, may cause harmful interference to radio communications.

However, there is no guarantee that interference will not occur in a particular installation. If this equipment does cause harmful interference to radio or television reception, which can be determined by turning the equipment off and on, the user is encouraged to try to correct the interference by one or more of the following measures:

- Reorient or relocate the receiving antenna.
- Increase the separation between the equipment and receiver.
- Connect the equipment into an outlet on a circuit different from that to which the receiver is connected.
- Consult the dealer or an experienced radio/TV technician for help.

This device complies with Part 15 of the FCC Rules. Operation is subject to the following two conditions: (1) this device may not cause harmful interference, and (2) this device must accept any interference received, including interference that may cause undesired operation.

FCC Radiation Exposure Statement

The device has been evaluated to meet general RF exposure requirement.
The device can be used in portable exposure condition without restriction.