

PRD-XXXXX-XXX

RBB10BW

BlackBerry XXXX

IC 2503A-RBB10BW

FCC ID L6ARBB10BW

Patents: www.rim.net/patents

IMEI: 123456789012345

DMY

CE 0168



I.T.E.

US LISTED
89NN



PIN: ABCDEFAB

Made In XXXXXX

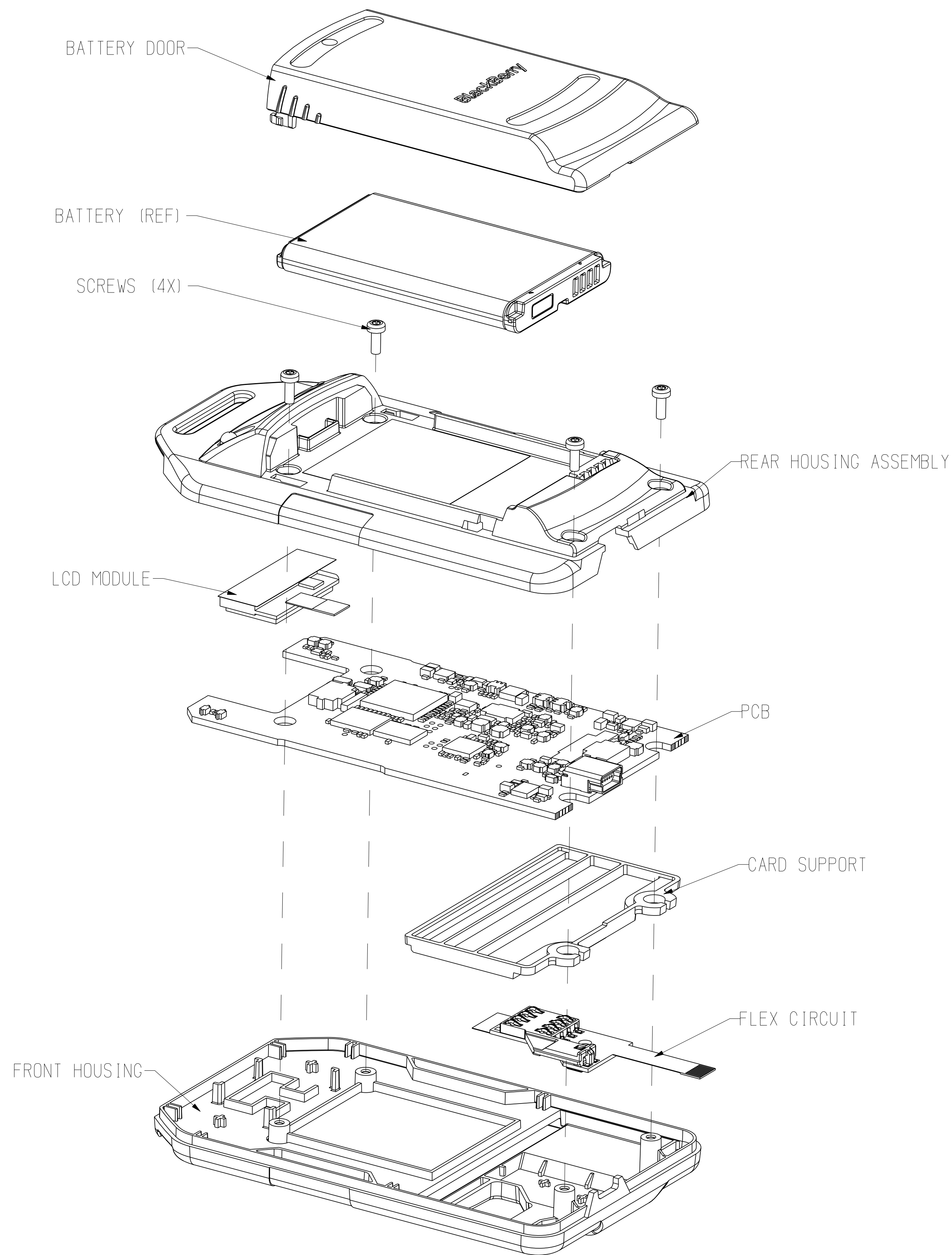

ASSEMBLY:

1. FLEX CIRCUIT:
ALIGN FLEX AS SHOWN AND INSERT INTO TOP HOUSING BY EDGING FLAT STIFF END FIRST UNDER BUMP IN FRONT HOUSING. USE THE TWO CROSSES FOR LOCATION AND ENSURE IT LIES FLAT AND IS ADHERED FIRMLY.
2. CARD SUPPORT:
ALIGN CARD SUPPORT AS SHOWN AND INSERT CARD SUPPORT OVER BOSSES IN TOP HOUSING ENSURING IT IS FULLY SEATED.
3. PCB:
PLACE PCB INTO TOP HOUSING, LOCATING ON THE FOUR BOSSES IN TOP HOUSING ENSURING IT LIES COMPLETELY FLAT. BENT FLEX CIRCUIT TRACE INTO CONNECTOR ENSURING IT IS FULLY SEATED THEN SNAP CONNECTOR DOOR CLOSED.
4. LCD:
REMOVE PROTECTIVE OVERLAY, ALIGN LCD AS SHOWN AND INSERT TRACE INTO CONNECTOR. ENSURE CONNECTOR IS FULLY SEATED AND LCD SITS CENTRED AND FLAT IN FRONT HOUSING. SNAP CONNECTOR DOOR CLOSED.
5. REAR HOUSING ASSEMBLY:
ALIGN REAR HOUSING ASSEMBLY AND PRESS TOGETHER WITH FRONT HOUSING. INSERT SCREWS IN THROUGH REAR HOUSING AND TIGHTEN TO 1.3 IN-LB OF TORQUE.
6. BATTERY DOOR:
ALIGN BATTERY DOOR AS SHOWN AND DROP INTO HOLES IN REAR HOUSING. SLIDE IT FORWARD TOWARDS LCD WINDOW UNTIL IT CLIPS TO PLACE.

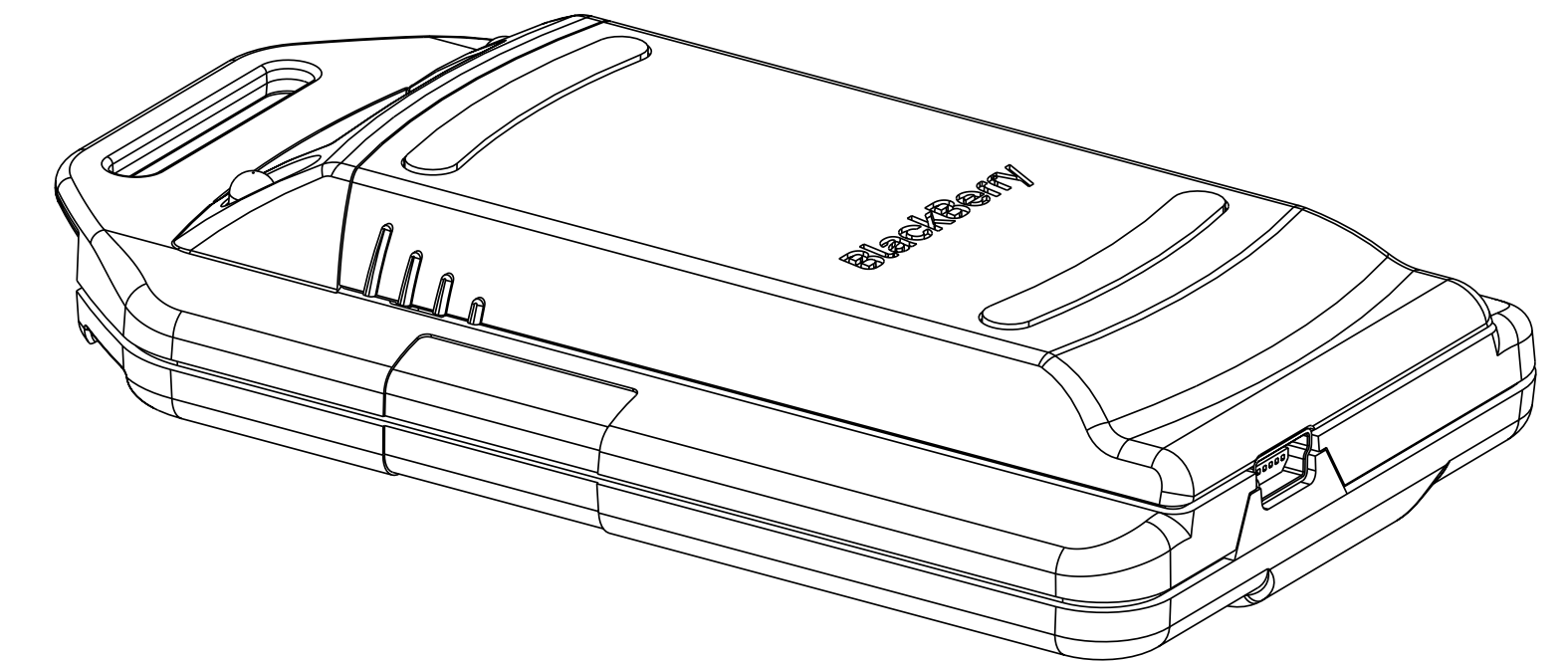
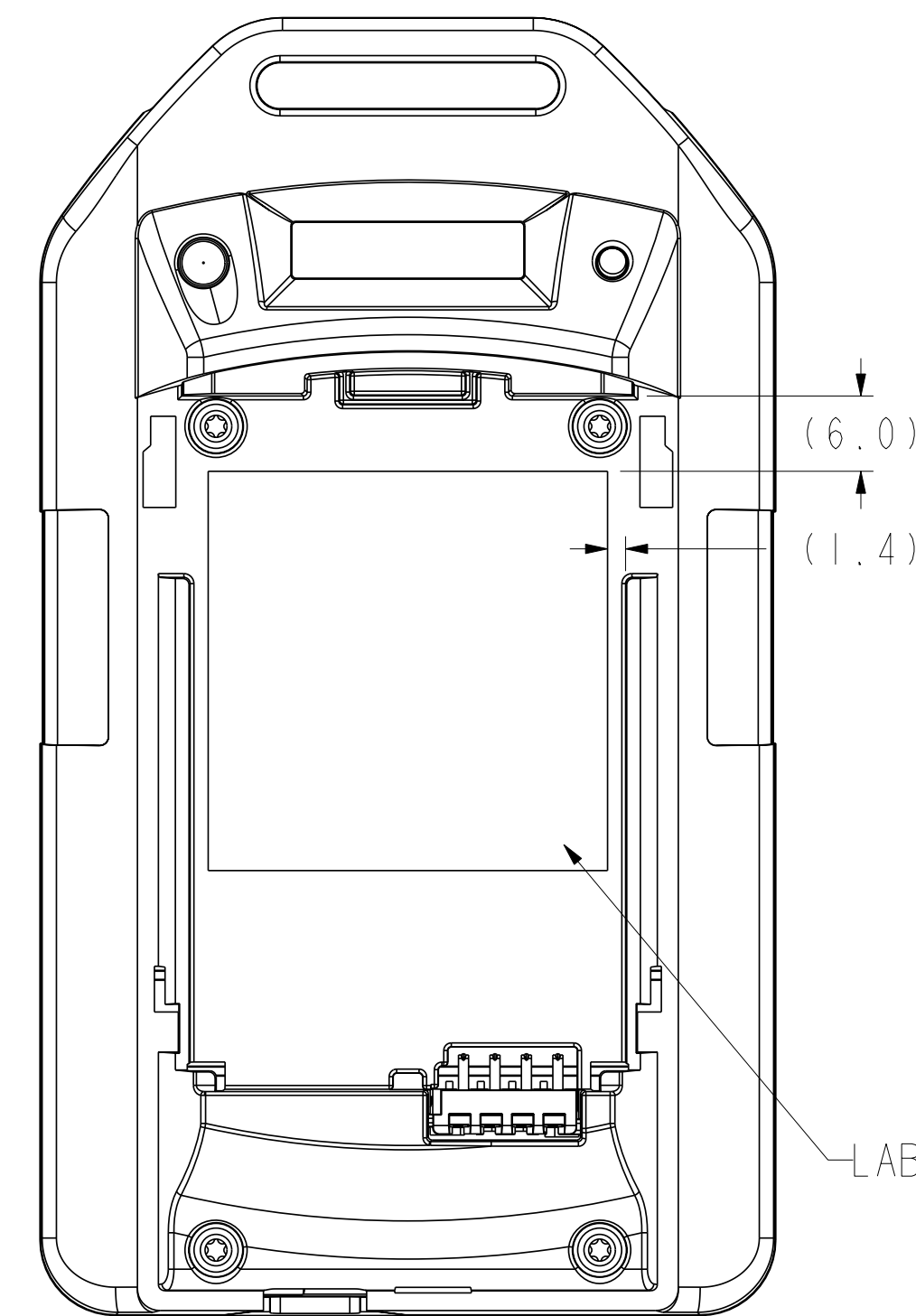

1A	ECN-05294	PREPRODUCTION RELEASE AND MODIFIED DRAWING VIEWS	MS	03/08/05
B		INITIAL RELEASE		5-20-05
A	ECN-00	INITIAL RELEASE		5-11-05
REV	ECN		CHANGES	DFTS DATE
D				
DWG SIZE				
APPROVALS				
DESIGNED BY	NAME	DATE	THE CONTENT OF THIS DOCUMENT IS RIM INTELLECTUAL PROPERTY. IT IS CONFIDENTIAL AND IS NOT TO BE DISCLOSED, REPRODUCED OR USED EXCEPT WITH THE WRITTEN PERMISSION OF RIM. COPYRIGHT 2004. RESEARCH IN MOTION LIMITED.	
DRAWN BY		MM-DD-YY		
CHECKED BY				
ENG APPR'D				
SUPR'D BY				
FILEPATH	Unassigned		PROJECT: Unassigned	
			NAME: ASSEMBLY COMPLETE FERMION	
			CAD MODEL FILE: ASSEMBLY COMPLETE FERMION	
			SCALE: 2.000	
			SHEET 1 OF 1	
			ASY-09858-001	
			REV 1A	