

Router

Quick InstallationGuide

Hardware Connections

(This picture just reference only, please make connection according to your actual router)

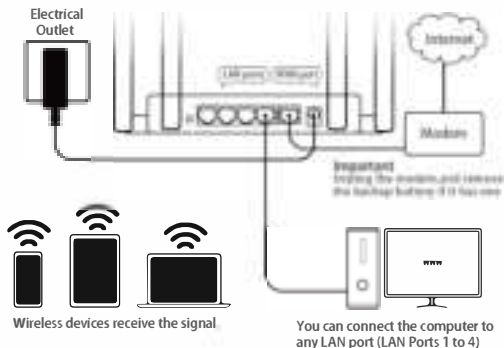

The Functions of LED Lights and Buttons:

LED Light	Name	Normal state
	Power Light	The signal light for connecting to the power supply flashes and stays on for a long time after going out
	Wireless Status Light	Signal light always on
	LAN Status Light	Ethernet port light flashing After the port is connected, the network port light flashes

Button	Name	Function
WPS/ RESET	WPS/Reset Button	Press for one second to enable WPS, If you press the button for 5 to 8 seconds, the router will be reset to the factory default setup



Router Setup

Note: The default access mode is: "Router Mode (DHCP)". If you want to switch to another mode, click "Change Mode - Easy Setup". "Router Mode" and "WISP Mode" are used as examples.

1.Router Mode(PPPOE)

Mobile config wireless router

1. You can use mobile phone to connect wireless signal, wireless name is: WiFi 2.4G pro_XXXXXX (means wireless Net address last 8 character)



Note: If you use PC to config wireless router, please reference setp 2

2. You can access with type 192.168.11.1 into config main page. Default use account password admin printed on the label at the bottom of the router.

A screenshot of a web-based 'User Login' form. The form has a light gray header with the title 'User Login'. Below the header, there are two text input fields. The first field is labeled 'Email' and has a dropdown arrow on the right. The second field is labeled 'Password (6 to 16 characters)'. Below these fields is a prominent blue button with the text 'Login' in white. The entire form is enclosed in a light gray border.

3. Fill in your Account and Password provided by your ISP, Click Apply

Account Name:

Account Password:

Username:

Password:

IP Address:

Subnet Mask:

Gateway:

DNS:

Note
Home network please choice use from PPPoE and DHCP
A.ONU access please provide account from ISP
B.Router access please choice DHCP mode

4. Create a Network Name (SSID) and Password for your Wireless Network, Click Apply

SSID:

Channel:

Security:

Key:

WPA:

WPA Password:

WPA Key:

Your router is already set up here, wait about 1 minute, please reconnect your WiFi name

2. Access Point Mode

In this mode, the router transforms your existing wired network to a wireless one.

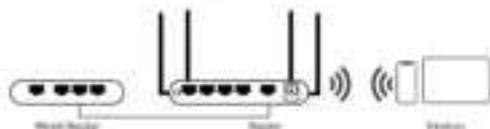

- A. Power on the router.
- B. Connect the router's WAN port to your wired router's Ethernet port via an Ethernet cable as shown above.
- C. Connect a computer to the router via an Ethernet cable or wirelessly by using the SSID (network name).
- D. Launch a web browser and enter 192.168.11.1 in the address bar and default user account password/admin printed on the label at the bottom of the router.
- E. Click Next to start the Easy Setup. Select Access Point and follow the step-by-step instructions of the Easy Setup to set up the Internet connection.

3. WISP Mode

In this mode, the router boosts the existing wireless coverage in your home.

1. Configure
 - A. Place the router next to your host router and power it on.
 - B. Connect a computer to the router via an Ethernet cable or wirelessly by using the SSID (network name).
 - C. Launch a web browser and enter 192.168.11.1 in the address bar and default user account password/admin printed on the label at the bottom of the router.
 - D. Click Next to start the Quick Setup, select Range Extender and follow the step-by-step instructions to set up the Internet connection.

2. Placement

Place the router about halfway between your host router and the Wi-Fi "dead" zone. The location you choose must be within the range of your existing host network.

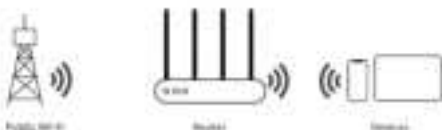

Enjoy the Internet!

Note: Using this WISP Mode, if you cannot log in, please check the router's real IP address, which maybe change to others.

1. Product Overview

This 300Mbps router is designed to provide you with a stable and high-speed wireless network connection, applicable to various scenarios such as households and offices.

2. Product Specifications

1. Transmission Rate	300Mbps
2. Operating Frequency Band	2.4GHz
3. Interfaces: 1 WAN port	1 WAN port, 4 LAN ports

3. Package Contents

1. Router main body
2. Power adapter
3. Network cable
4. Quick installation guide

4. Installation Steps

1. Connect the power supply: Insert the power adapter into the power interface of the router and connect it to the power socket.
2. Connect the network: Use an Ethernet cable to connect the LAN port of your broadband modem (such as an optical modem) to the WAN port of the router.
3. Connect the devices: Use an Ethernet cable to connect your computer and other devices to the LAN ports of the router, or connect to the router's network wirelessly.

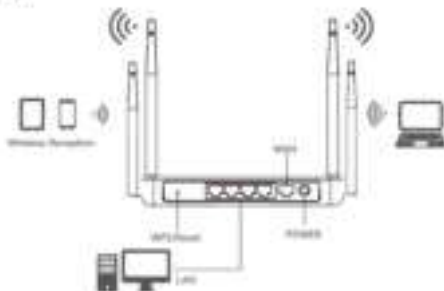

6. Wireless Connection Settings

1. Turn on the wireless network setting function of your device (such as a mobile phone or computer).
2. In the list of available wireless networks, find the network name (SSID) of your router, which is usually found on the label on the back of the router.
3. Click to connect and enter the default wireless password. The default password can also be found on the label on the back of the router.
4. After a successful connection, you can modify the wireless network name and password as needed.

7. Router Setup Process

1. Log in to the router management interface: Enter the default management address (192.168.1.1) of the router in the browser and press Enter.
2. Enter the password: Enter the default password (admin) to log in to the router's management interface.
3. Basic Settings:
 - Network Settings: According to the information provided by your network service provider, set the WAN port connection type (such as PPPoE, Dynamic IP, Static IP, etc.) and enter the corresponding account and password.
 - Wireless Settings: You can modify parameters such as the wireless network name (SSID), wireless password, and wireless channel to optimize the performance and security of the wireless network.
4. Advanced Settings:
 - Dynamic DNS: If you have a dynamic IP address but need to access external network resources through a fixed domain name, you can set up the Dynamic DNS service.
5. Save Settings: After completing each setting, remember to click the "Save" or "Apply" button to make the settings effective.

8. Common Problems and Solutions

1. Unable to connect to the wireless network:
 - Confirm whether the wireless password you entered is correct.
 - Try to place the router and the device closer to ensure sufficient signal strength.
 - Restart the router and the device.
2. Slow network speed:
 - Check if other devices are consuming a large amount of network bandwidth.
 - Try to change the wireless channel to avoid interference.
 - Ensure that the router's firmware is the latest version.

9. Precautions

1. Please place the router in a well-ventilated and dry location, avoiding direct sunlight and humid environments.
2. Do not place heavy objects on the router or block its heat dissipation holes.
3. Change the wireless password regularly to enhance network security.

This device complies with part 15 of the FCC Rules. Operation is subject to the following two conditions: (1) This device may not cause harmful interference, and (2) this device must accept any interference received, including interference that may cause undesired operation.

Any Changes or modifications not expressly approved by the party responsible for compliance could void the user's authority to operate the equipment.

Note: This equipment has been tested and found to comply with the limits for a Class B digital device, pursuant to part 15 of the FCC Rules. These limits are designed to provide reasonable protection against harmful interference in a residential installation. This equipment generates uses and can radiate radio frequency energy and, if not installed and used in accordance with the instructions, may cause harmful interference to radio communications. However, there is no guarantee that interference will not occur in a particular installation. If this equipment does cause harmful interference to radio or television reception, which can be determined by turning the equipment off and on, the user is encouraged to try to correct the interference by one or more of the following measures:

- Reorient or relocate the receiving antenna.
- Increase the separation between the equipment and receiver.
- Connect the equipment into an outlet on a circuit different from that to which the receiver is connected.
- Consult the dealer or an experienced radio/TV technician for help.
- This equipment complies with FCC radiation exposure limits set forth for an uncontrolled environment. This equipment should be installed and operated with minimum distance 20cm between the radiator & your body.