

# Quick Start Guide

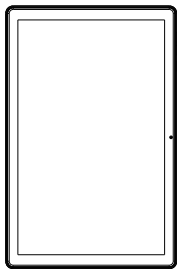

# In The Box



10.1 " Tablet

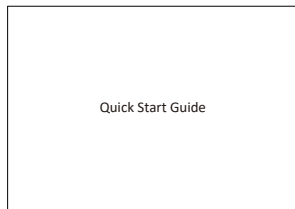

Quick Start Guide

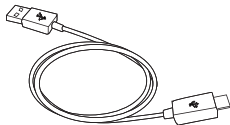

USB-C cable

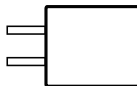

Charger

Input: 100-240V~50/60Hz,0.3A  
Output:5.0V  $\equiv$  2.0A

# Get to Know Your Tablet

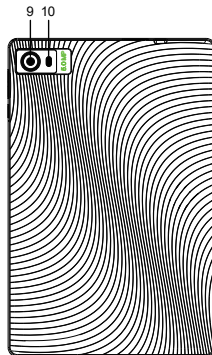
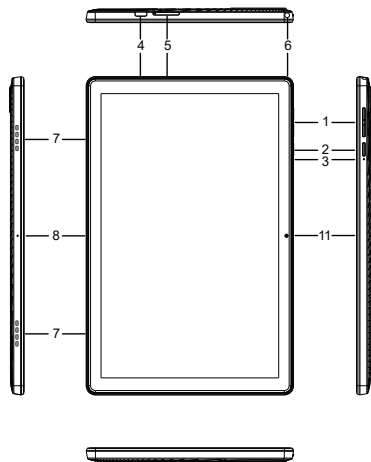

1. Volume Control
2. Power On/Off
3. Reset
4. TYPE-C
5. SIM Card Slot+TF Card Slot  
(2xNano SIM card or 1x Nano SIM+1xMicro SD)
6. Earphonejack
7. Speaker
8. Mic
9. Camera(Rear)
10. Flashlight
11. Camera(Front)

# Charging Your Tablet

It is recommended to fully charge the tablet before first use. To charge the tablet, 1) plug the USB cable into the AC adapter, 2) attach the other end to the USB-C input on the tablet, 3) plug the AC adapter into a wall outlet.

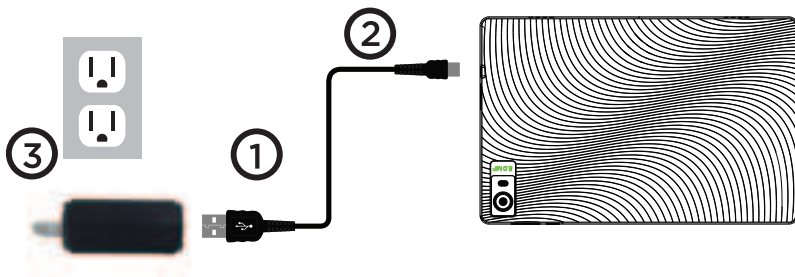

When the tablet is ON and charging, the battery icon will pulsate.

It is normal for the tablet to get warm while charging, playing games, or streaming video.

Battery life will vary depending on usage.

Note: Leave tablet in a well ventilated area while charging.

# Important Safety Instructions

1. Do not install near any heat sources such as radiators, heat registers, stoves, or other apparatus (including amplifiers) that produce heat.
2. WARNING: Only use attachments/accessories specified or provided by the manufacturer (such as the exclusive supply adapter, battery etc).
3. WARNING: The mains plug should be kept in a state that can be disconnected at anytime to avoid emergency situation.
4. WARNING: The apparatus should not be exposed to dripping or splashing. Objects filled with liquids, such as vases or drinking glasses, should not be placed on the apparatus
5. WARNING: Please refer the electrical and safety information on tablet and user manual before installing or operating the apparatus.

Use the device where the ambient temperature is between 0° and 35° C (32° to 95° F).

Low-Or high-temperature conditions might cause the device to change its behavior to regulate its temperature. Using your tablet in very cold conditions outside of its operating range might temporarily shorten the battery life and could cause the device to turn off. Battery life will return to normal when you bring the device back to higher ambient temperatures. Using the device in very hot conditions can permanently shorten battery life.

FCC statements:

This equipment has been tested and found to comply with the limits for a Class B digital device, pursuant to part 15 of the FCC Rules. These limits are designed to provide reasonable protection against harmful interference in a residential installation. This equipment generates uses and can radiate radio frequency energy and, if not installed and used in accordance with the instructions, may cause harmful interference to radio communications. However, there is no guarantee that interference will not occur in a particular installation. If this equipment does cause harmful interference to radio or television reception, which can be determined by turning the equipment off and on, the user is encouraged to try to correct the interference by one or more of the following measures:

- Reorient or relocate the receiving antenna.
- Increase the separation between the equipment and receiver.
- Connect the equipment into an outlet on a circuit different from that to which the receiver is connected.
- Consult the dealer or an experienced radio/TV technician for help.

This device complies with part 15 of the FCC rules. Operation is subject to the following two conditions:

- (1) this device may not cause harmful interference, and
- (2) this device must accept any interference received, including interference that may cause undesired operation.

Warning: Changes or modifications to this unit not expressly approved by the party responsible for compliance could void the user's authority to operate the equipment.

#### Specific Absorption Rate (SAR) information

The SAR limit of USA (FCC) is 1.6 W/kg averaged over one gram of tissue. This model (FCC ID: 2APUQ-LM1097P) has also been tested against this SAR limited. The highest SAR value reported under this standard during product certification for use at the body is 1.205W/kg.

For U-NII devices (5G WIFI)

Working temperature: 0°C to 45°C

Working voltage: 3.8V  $\pm$  15%

The device for operation in the band 5150–5250 MHz is only for indoor use to reduce the potential for harmful interference to co-channel mobile satellite systems.