

DT-3+1

DIGITAL TRANSMITTER

Code Setting Instructions

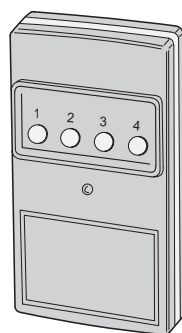

Linear

USA & Canada (800) 421-1587 & (800) 392-0123
(760) 438-7000 - Toll Free FAX (800) 468-1340
www.nortekcontrol.com

DESCRIPTION

The Delta-3 DT-3+1 is a hand-held four-channel transmitter with a three-channel section plus an individual one-channel section. It's designed so that channel 1 may have a system code independent of the other three channels. This transmitter operating in conjunction with four single-channel receivers, or one multi-channel receiver, can perform a variety of remote switching tasks. The DT-3+1 has 2 digital encoders (switch A, and switch B). Coding switch "A" is designed for use with private multiple garage door openers, activated by push buttons 2, 3 and 4. Coding switch "B" under the back cover is designed for use with less frequently changed codes, such as a community access gate that can be activated by push button 1.

NOTE: The transmitter transmits continuously with the button pressed. The red indicator lights during transmission to indicate battery condition. Should it fail to illuminate, it is recommended that you replace the 9-volt battery.

STEP 1: Locate coding switch. There are two digital coding switches in the DT-3+1 transmitter. Code switch "A" is exposed by removing the battery access cover by inserting your thumbnail or small screwdriver under either of the two slots at the edge of the case. To access switch "B", remove the battery and remove the rear half of the case by gently pulling down and back on the battery end of the rear case.

(CAUTION: The white plastic push buttons rest freely in the case front and may fall out if care is not exercised.)

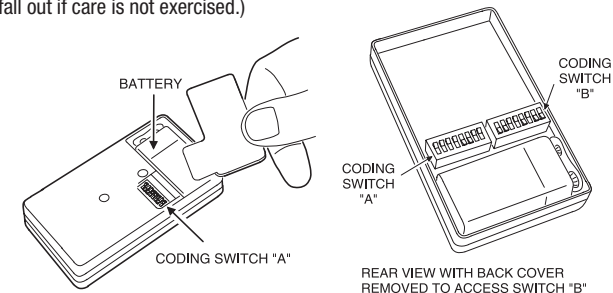

STEP 2: Setting Code Switches. The coding switches have eight keys numbered 1-8. To set coding switch "A", select any combination of ON or OFF positions for switch keys numbered 3-8. Use a paper clip or other pointed object (except a pencil or pen) to set the keys. To set coding switch "B", select any combination of ON or OFF positions for switch keys numbered 1-8.

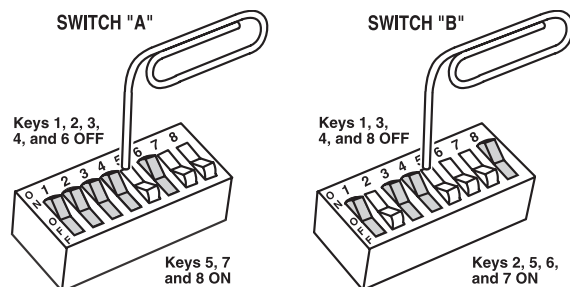

CAUTION: IT IS NOT ADVISABLE TO SET A CODE WITH ALL KEYS ON, OFF, OR ALTERNATING ON AND OFF. THESE CODES CAN EASILY BE DUPLICATED.

STEP 3A: Code Setting for Four Single-Channel Receivers. Set keys 3-8 of receivers 2, 3 and 4 to match keys 3-8 of switch "A". Set keys as follows:

- Receiver 1** - Set all eight keys to match switch "B", activates from button 1
- Receiver 2** - Set Key 1 and 2 OFF, match keys 3-8, activates from button 2
- Receiver 3** - Set Key 1 ON, Key 2 OFF, match keys 3-8, activates from button 3
- Receiver 4** - Set Key 1 OFF, Key 2 ON, match keys 3-8, activates from button 4

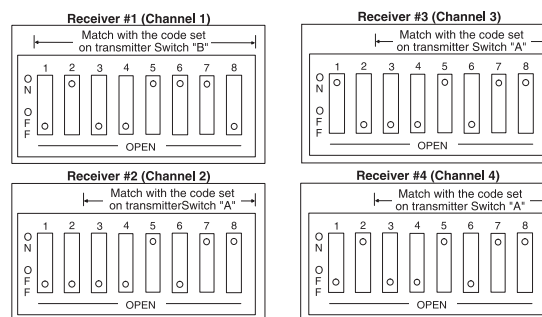

STEP 3B: Code Setting for Four-Channel Receiver. Set coding switch keys 3-8 of the receiver to match keys 3-8 of coding switch "A" of the DT-3+1. Matching these keys completes the coding procedure required to activate the first THREE channels of the receiver. The receiver keys 1 and 2 do not have to be set. Their functions are preprogrammed to access channels 1-4. Receiver channels are activated as follows:

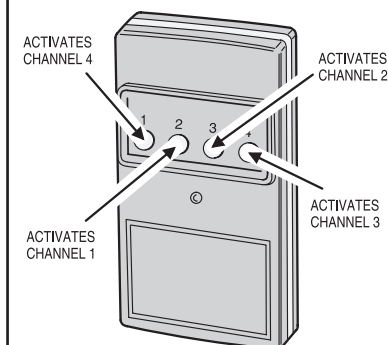

Channel 4 of the receiver can be activated by setting keys 3-8 of coding switch "B" to match keys 3-8 of coding switch "A". Set keys 1 and 2 of coding switch "B" to on position. Channel 4 of receiver can now be activated by pressing button 1 of the DT-3+1.

STEP 4: Test the equipment. Connect the receiver(s) to the operators as described in the receiver's installation instructions. Be sure the door/gate area is clear. Activate the transmitter and verify that the receiver triggers the operator. Check that the correct button on the DT-3+1 activates the desired operator.

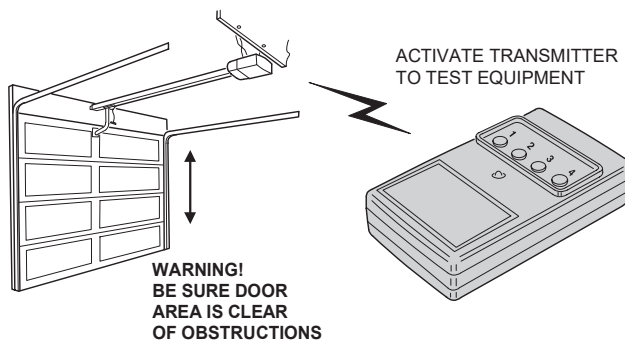

BATTERY REPLACEMENT

The battery should last 12 to 18 months with normal use. The red LED on the face of the transmitter will glow when the unit is activated. When the red LED lights dimly, or not at all when transmitting, the battery needs to be replaced. Remove the battery access door to change the battery. Any type of 9-volt battery can be used.

REPLACE BATTERY WITH
FRESH 9-VOLT BATTERY

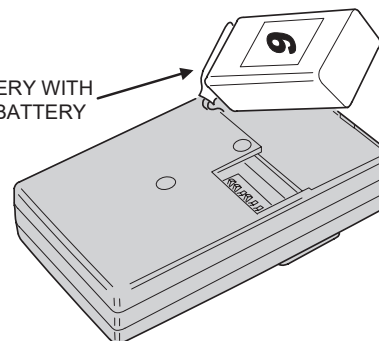

LIMITED WARRANTY

This Nortek Security & Control LLC product is warranted against defects in material and workmanship for twenty-four (24) months. This warranty extends only to wholesale customers who buy direct from Nortek or through Nortek's normal distribution channels. Nortek Security & Control LLC does not warrant this product to consumers. Consumers should inquire from their selling dealer as to the nature of the dealer's warranty, if any. There are no obligations or liabilities on the part of Nortek Security & Control LLC for consequential damages arising out of or in connection with use or performance of this product or other indirect damages with respect to loss of property, revenue, or profit, or cost of removal, installation, or reinstallation. All implied warranties, including implied warranties for merchantability and implied warranties for fitness, are valid only until the warranty expires. This Nortek Security & Control LLC Warranty is in lieu of all other warranties express or implied.

All products returned for warranty service require a Return Authorization Number (RA#). Contact Nortek Security & Control Returns at 1-855-546-3351 for an RA# and other important details.

FCC & IC Notice

This device complies with Part 15 of the FCC Rules and Industry Canada license exempt standard(s). Operation is subject to the following two conditions:

- 1) This device may not cause harmful interference, and
- 2) This device must accept any interference received, including interference received that may cause undesired operation.

Le présent appareil est conforme aux CNR d'Industrie Canada applicables aux appareils radio exempts de licence. L'exploitation est autorisée aux deux conditions suivantes:

- 1) (1) l'appareil ne doit pas produire de brouillage, et
- 2) (2) l'utilisateur de l'appareil doit accepter tout brouillage radioélectrique subi, même si le brouillage est susceptible d'en compromettre le fonctionnement.

WARNING: Changes or modifications not expressly approved by the manufacturer could void the user's authority to operate the equipment.