

Milesight

QUICK START GUIDE

WS50x Series

SMART WALL SWITCH
FEATURING LoRaWAN®

1. Packing List

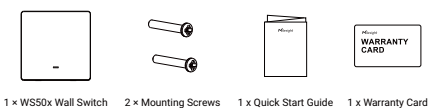

* The product appearance may vary by model.

2. Hardware Introduction

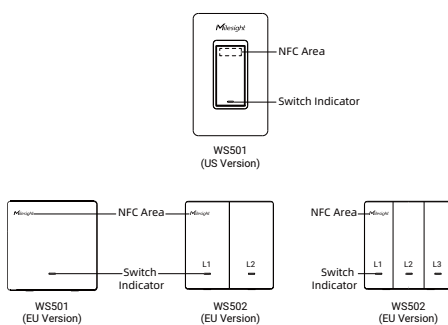

Reset to Factory Default: hold on any switch for more than 10s until indicator quickly blinks.

3. Wirings (3-Wire Version)

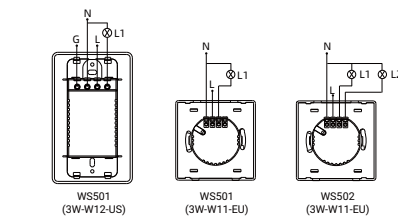

4. Wirings (2-Wire Version)

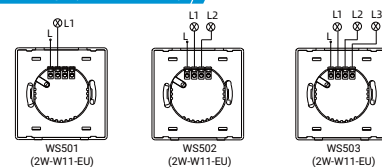

5. Installation

1. Ensure the circuit is shutted off and the old switch has been taken off.
2. Open the front panel of WS50x switch.

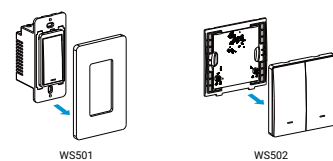



Cloud App



Quick Start Guide

All software & files can be downloaded from
<https://www.milesight-iot.com/documents-download/>

Better Inside, More in Sight

Milesight IoT Co., Ltd. | www.milesight-iot.com

3. Connect corresponding wires to the WS50x switch.

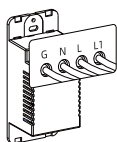

WS501

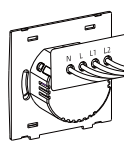

WS502

4. Fix the WS50x switch to the switch box with mounting screws, then fix the front panel back to the device.

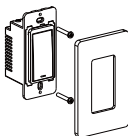

WS501

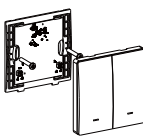

WS502

6. Configuration Guide

1. Download "Milesight ToolBox" App on an NFC-supported smartphone.



Android



iOS

2. Open "Milesight ToolBox" App and attach the smartphone with NFC area to read/write the device until App shows a successful prompt. It's suggested to configure a device password for security. (Default password: 123456)



NFC Area
WS501

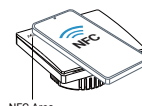

NFC Area
WS502

Besides, it can be configured by dedicated NFC reader provided by Milesight IoT.

7. Safety Precautions

- The installation must be conducted by qualified person and should strictly comply with the electrical safety regulations of the local region.
- Ensure the breaker is Powered out during installing.
- Do not leave any object inside the switch box when installation.
- In order to get the best transmission, ensure the device is within the signal range of the LoRaWAN® gateway and avoid the obstacles or metal objects.
- Do not overload the maximum capacity in order to avoid the damage of the device.
- The device is intended only for indoor use. Do not place device outdoors where the temperature or humidity is below/above operating range.
- Do not place the device close to objects with naked flames, heat source (oven or sunlight), cold source, liquid and extreme temperature changes.
- Keep the device away from water to prevent electric shock.
- Use the device only in clean environments. Dusty or dirty environments may prevent the proper operation of this device.
- Do not drop the device or subject it to physical shocks and strong vibration.

FCC Warning:

This device complies with Part 15 of the FCC Rules. Operation is subject to the following two conditions (1) this device may not cause harmful interference, and

(2) this device must accept any interference received, including interference that may cause undesired operation. Changes or modifications not expressly approved by the party responsible for compliance could void the user's authority to operate the equipment.

Note 1: This equipment has been tested and found to comply with the limits for a Class B digital device, pursuant to part 15 of the FCC Rules. These limits are designed to provide reasonable protection against harmful interference in a residential installation. This equipment generates, uses and can radiate radio frequency energy and, if not installed and used in accordance with the instructions, may cause harmful interference to radio communications. However, there is no guarantee that interference will not occur in a particular installation. If this equipment does cause harmful interference to radio or television reception, which can be determined by turning the equipment off and on, the user is encouraged to try to correct the interference by one or more of the following measures: —Reorient or relocate the receiving antenna. —Increase the separation between the equipment and receiver. —Connect the equipment into an outlet on a circuit different from that to which the receiver is connected. —Consult the dealer or an experienced radio/TV technician for help.

Note 2:

1. Changes or modifications to this unit not expressly approved by the party responsible for compliance could void the user's authority to operate the equipment.
2. The minimum separation generally be used is at least 20 cm.