

Thank you for purchasing this Autel MaxiSys MS906 Pro-TS. Our tools are manufactured to a high standard and — when used according to these instructions and properly maintained — will provide years of trouble-free performance.

◎ **MaxiSys MS906 Pro-TS Display Tablet**

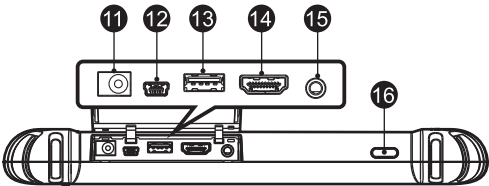
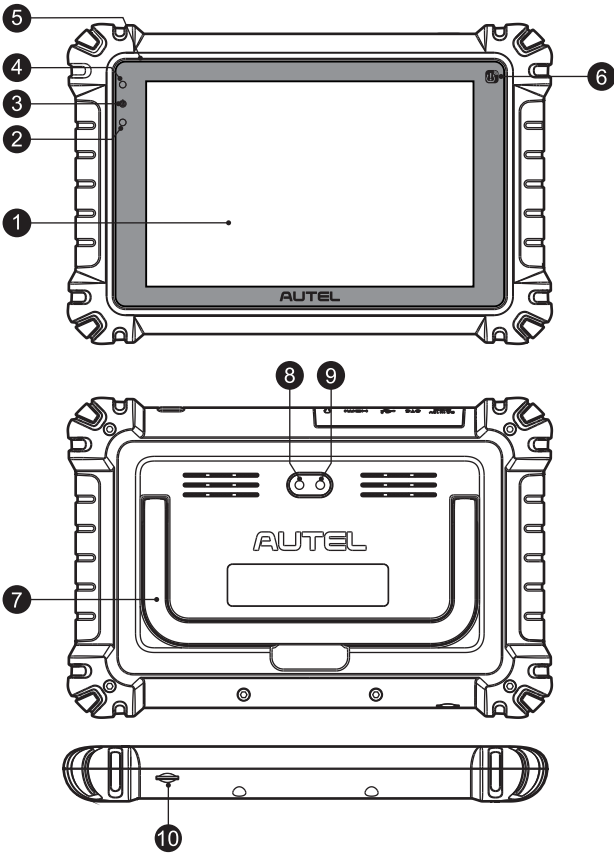

- 1. 8-inch LED Capacitive Touchscreen
- 2. Ambient Light Sensor — detects ambient brightness
- 3. Power LED
- 4. Front Camera
- 5. Microphone
- 6. TPMS Service Symbol — indicates the position of the embedded TPMS antenna
- 7. Collapsible Stand — extends from the back to allow hands-free viewing of the tablet
- 8. Rear Camera
- 9. Camera Flash
- 10. TF Card Slot
- 11. DC Power Supply Input Port
- 12. Mini USB Port
- 13. USB Port (for VCI Connection)
- 14. HDMI Port
- 15. Headset Jack (3-band 3.5mm)
- 16. Lock/Power Button — press and hold to turn on/off the tablet, or tap to lock the screen

◎ **VCI (Vehicle Communication Interface) Device — MaxiVCI V200**

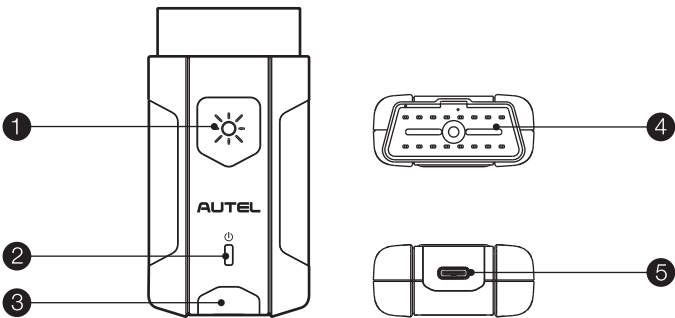

- 1. Flashlight Power Button
- 2. Power LED
- 3. Vehicle/Connection LED
- 4. Vehicle Data Connector (16-pin)
- 5. USB Port

VCI LED Description

LED	Color	Description
Power LED	Yellow	The VCI is powered on and performing self-check.
	Green	The VCI is ready for use.
	Flashing Red	The firmware is updating.
Vehicle /Connection LED	Green	<ul style="list-style-type: none">• Solid Green: The VCI is connected via USB cable.• Flashing Green: The VCI is communicating via USB cable.
	Blue	<ul style="list-style-type: none">• Solid Blue: The VCI is connected via Bluetooth.• Flashing Blue: The VCI is communicating via Bluetooth.



IMPORTANT: Before operating or maintaining this unit, please read these instructions carefully, paying extra attention to the safety warnings and precautions. Failure to use this product properly may cause damage and/or personal injury and will void the product warranty.

1

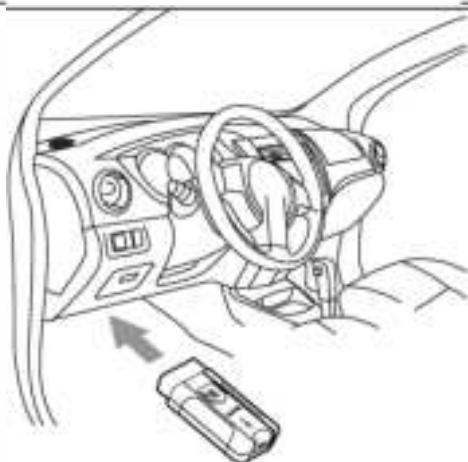

- Insert the Vehicle Data Connector on the MaxiVCI V200 into the vehicle's DLC, which is generally located under the vehicle dashboard.

2

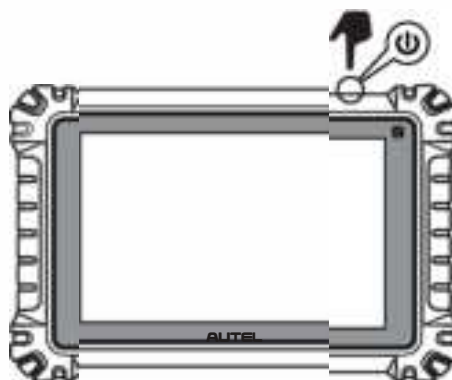

- Ensure the tablet is sufficiently charged or is connected to the supplied DC power supply.
- Power up the tablet.

3

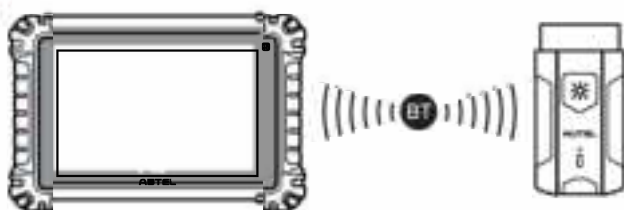

- Pair the tablet with the MaxiVCI V200 via Bluetooth to establish a communication link.

NOTE: The tablet and the MaxiVCI V200 are configured to automatically synchronize with each other on first use, so there should be no need to pair up.

OR



Alternatively, connect the tablet and the MaxiVCI V200 using the USB cable.

4

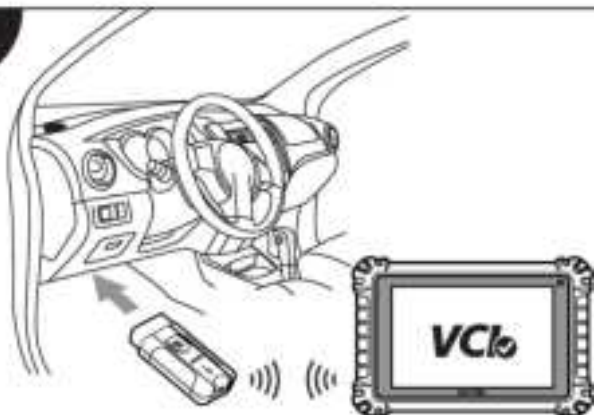

- When the MaxiVCI V200 is properly connected to the vehicle and the tablet, the VCI status button on the bottom bar of the screen will display a green badge with a check mark at the corner indicating the tablet is ready to start vehicle diagnosis.

5

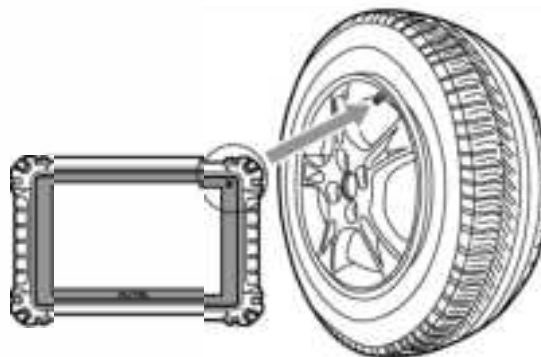

- Hold the MaxiSys MS906 Pro-TS tablet with its top right corner close to the tire sidewall at the valve stem to activate the TPMS sensor.

1

2

3

4

5

6

7

8

15.21 Information to user.

Any Changes or modifications not expressly approved by the party responsible for compliance could void the user's authority to operate the equipment.

15.105 Information to user.

This equipment has been tested and found to comply with the limits for a Class B digital device, pursuant to Part 15 of the FCC Rules. These limits are designed to provide reasonable protection against harmful interference in a residential installation. This equipment generates uses and can radiate radio frequency energy and, if not installed and used in accordance with the instructions, may cause harmful interference to radio communications. However, there is no guarantee that interference will not occur in a particular installation. If this equipment does cause harmful interference to radio or television reception, which can be determined by turning the equipment off and on, the user is encouraged to try to correct the interference by one or more of the following measures:

• Reorient or relocate the receiving antenna.

• I ncrease the separation between the equipment and receiver.

• C onnect the equipment into an outlet on a circuit different from that to which t he receiver is connected.

• C onsult the dealer or an experienced radio/TV technician for help.

Specific Absorption Rate (SAR) information:

This product meets the government's requirements for exposure t o radio waves. The guidelines are based on standards that were developed by independent scientific organizations through periodic and thorough evaluatio n of scientific studies. The standards include a substantial safety margin designed to assure the safety of all persons regardless of age or health. FCC RF Exposure Information and Statement The SAR limit of USA (FCC) is 1.6 W/kg averaged over one gram of tissue. This device was test ed for typical body-worn operations with the back of the handset kept 5mm from the body. To maintain compliance with FCC RF exposure requirements, use accessories that maintain a 5mm separation distance between the user's body and the back of the handset. The use of belt clips, holsters and similar accessories should not contain metallic components in its assembly. The use of accessories that do not satisfy these requirements may not comply with FCC RF exposure requirements, and should be avoided. Body-worn Operation This device was tested for typical body-worn operations. To comply with RF exposure requirements, a minimum separation distance of 5mm for body worn must be maintained between the user's body, including the antenna. Third-party belt-clips, holsters, and similar accessories used by this device should not contain any metallic components. Body-worn accessories that do not meet these requirements may not comply with RF exposure requirements and s hould be avoided. Use only the supplied or an approved antenna.

对折

颜色

PANTONE
BLACK

语言：英文

注：AUTEL设计部不指定供应商。效果做到参考样品一致即可。

DIM

0~6

6~30

30~120

120~300

300~600

600~1200

>1200

ANG.

Sheetmetal

0.10

0.15

0.25

0.35

0.50

0.60

0.80

1~

Machining

0.05

0.10

0.15

0.20

0.25

0.30

0.50

30°

AUTEL®

道通科技股份有限公司

Autel Intelligent Technolog Corp.Ltd.

These Drawings And Specification Are The Property Of AUTEL. And Shall NOT Be Reproduced Copied Or Used In Any Manner Without The Prior Written Consent Of AUTEL

PROJ

DRAW: 张贝贝

CHKD: 杨柳

STAD:

APPD: 廖岳龙

SHEET: 1 OF 1

TITLE:

快速指引

UNIT'S: 210x285 mm

FINISH:

MASS(Kg):

SCALE:

PRODUCT: MS906 Pro-TS

DWG NO.: AUT62060568

PART NO.: 500005471

Material: 120g书写纸

1

2

3

4

5

6

7

8

A

B

C

D

E

F

RELEASE LEVEL: &PROJ RELEASE

FILENAME: MODEL NAME

A3