

KEY TOOL®

USER MANUAL

TABLE OF CONTENTS

1) Safty Precautions And Warnings	02
2) Product Packaging Checklist	02
3) Overview	
3.1 Schematic	03
3.2 Characteristics	05
3.3 Specifications	05
4) General Information	05
5) Operating Introductions	
5.1 Main Interface	06
5.2 Transponder Cloning	07
5.3 Transponder Generating	11
5.4 Remote Cloning	12
5.5 Remote Generating	14
5.6 Garage Remote Generating	16
5.7 Remote Renew	16
5.8 Frequency Test	17
5.9 Special Functions	17
6) FAQ	18

SAFTY PRECAUTIONS AND WARNINGS

To prevent personal injury or device damage, users should carefully observe the instructions provided by this operation manual and adopt the following safety precautions :

- Always operate the tool under the safe condition
- Do not place the tool in any wet, oily, dusty area
- Do not place any tool or container on the tool
- Please use this tool with local legal permission

PRODUCT PACKAGING CHECKLIST

The whole package covers the following items, if missing, please contact your dealer.

Name	Quantity	Description
VVDI KEY TOOL	1	device
B5 Remote	5	Xhorse wire universal type
Remote programming cable	2	programming Xhorse wire remote
Remote renew cable	1	renew smart key
Transponder collection box	2	place for chip
User Manual	1	

OVERVIEW

TOOL SCHEMATIC

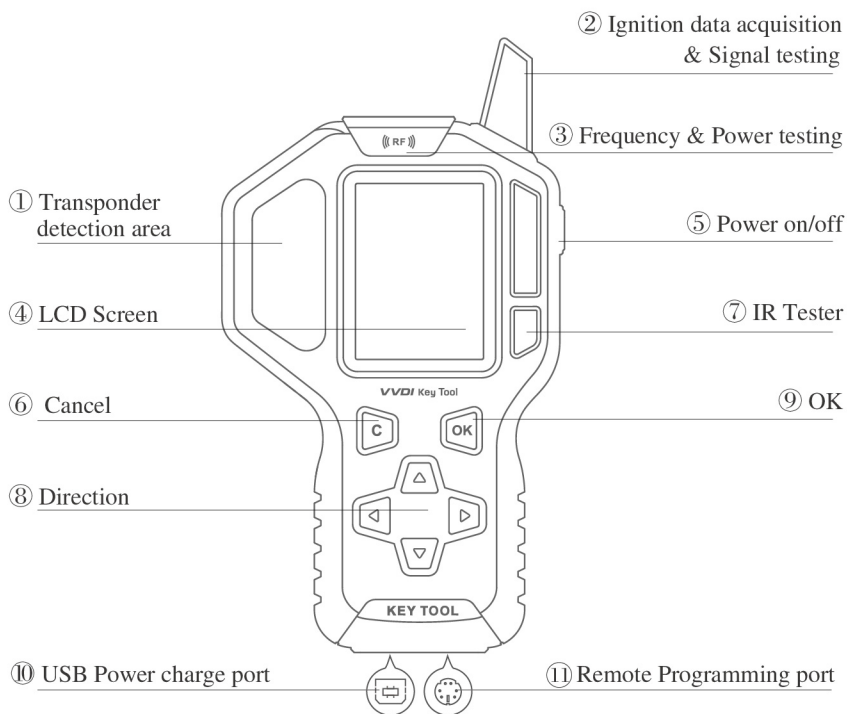

CHARACTERISTICS

- Built-in more than 1200 types of vehicle remote database
(More vehicle types will be supported continuously)
- Support varieties of offline transponder cloning
- Built-in hundreds of key renew database
- Support most HCS rolling code and fixed code remote cloning
- Support partial Non-HCS rolling code remote cloning
- Perfect testing function of frequency, power, IR and Ignition coil signal
- Large capacity lithium battery ensures super long working time
- Bounes points reward system

SPECIFICATIONS

LCD size	2.4'
Display	240X320
Battery voltage	3.6~4.2V
Battery capacity	>2500mAh
Charge voltage	4.5~6.5V
Charge current	<1000mA
Working time	≧ 10 Hour

GENERAL INFORMATION

- 1、 The descriptions, Illustrations and specifications given in the pamphlet are subject to alteration without notice.
- 2、 Under the usage of instruction sheet, The warranty time is three years.
- 3、 Even if within the warranty period, If the following occurs, Certain maintenance costs will not be free:
 - The product malfunction caused by not in accordance with the user manual operation
 - The malfunction and damage caused by unauthorized repairs and alteration
 - The product malfunction caused by the fall, crash and the improperly voltage
 - Damage due to force majeure

【 RIGHTS RESERVED 】 No part of this publication may be reproduced, stored in a retrieval system, or transmitted, in any form, or by any means (mechanical, electronic, photocopying, recording, or others), without permission of Xhorse. Due to continuous product improvement, the information contained in this manual is subject to change without notice.

OPERATING INSTRUCTIONS

The operation instructions describe the basic operating procedures and precautions of each function, at the same time listed some common problems encountered during using this function.

Please read operating instructions section carefully before your work.

1、MAIN INTERFACE

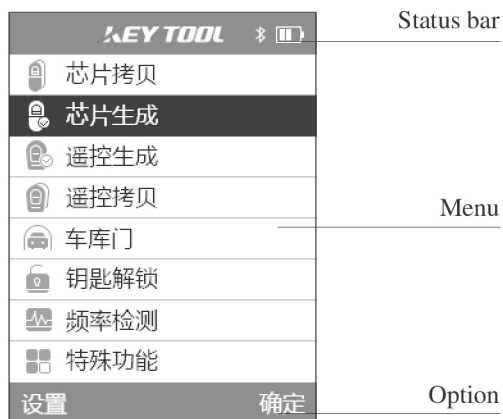

2、 TRANSPONDER CLONING

Support identification all immobile Transponder in current market, clone & edit partial common Transponder.

- **Support editing transponder types**

36/46(Hitag2)、47(Hitag3)、48、4D(40/80)、7935

- **Support cloning transponder types**

Support 36/46 original or aftermarket transponder offline cloning

Support 4D-40 bit 60 63 83 67 69, etc offline cloning

Support 11/12/13/4c/30/33/42 offline cloning

Support Toyota 72-G transponder online cloning

Support Hyundai/KIA 70(4D-80) bit online cloning

Support Ford 83-80 bit online cloning

Support all 48 online cloning

- **Support unlocking transponder type**

Support unlocking Xhorse special 4D, 46 transponder

Support unlocking all 7935 locked transponder

After enter transponder cloning function,
Please put transponder on ① transponder detection
area and press [ok] to identification,
The identification result will be showed as picture 2.2

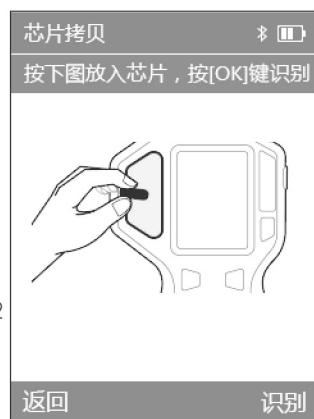

Picture 2.1
Transponder identification diagram

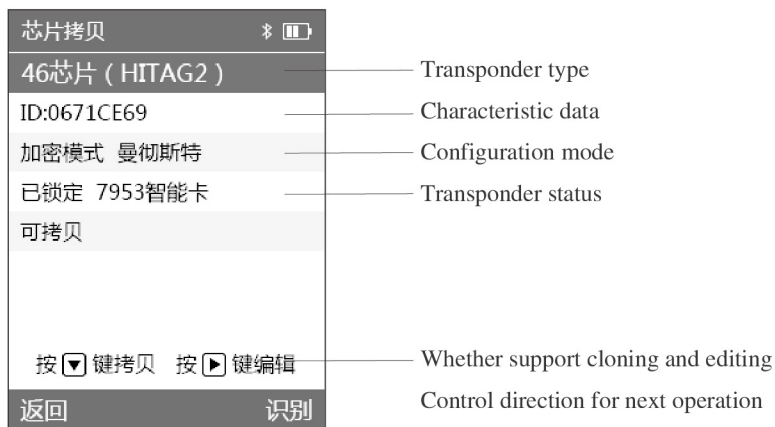

Picture 2.2
Identification result

Press  for transponder editing

- Use direction buttons to move cursor or revise editing content, Click on [OK] to confirm.

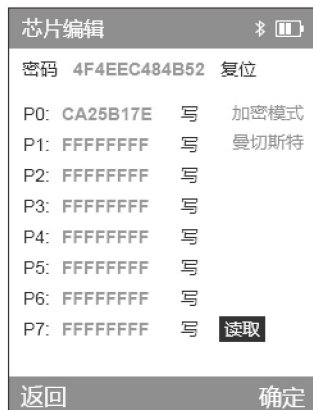

Picture 2.3

Transponder editing diagram



Picture 2.4

Ignition data acquisition

Press  for transponder cloning

- Partial transponder cloning need to Ignition data acquisition first, other types no need to sniffer data, press [OK] to start sniffer data.