

• Android Connection Instructions:

Bluetooth pairing charging Low voltage indicator 1. Turn on the device, the blue light shinning one time, then press Button of Connect with 3 seconds, the blue light Twinkle, so that means the keyboard in the matching status. after maching succeed, the twinkle blue light off, fold close the keyboard, the Power off.

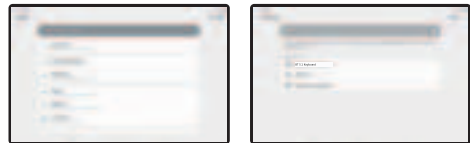

2. Open "Settings" and then click "Connect" 3. Turn on Bluetooth to search for the pair name.



4. Click the pair name "BT 5.1 Keyboard". pair request is displayed, click OK. 5. There is a tip for connecting successfully .you can use your keyboard comfortably .

Remarks: After connecting successfully the next time you don't need match code, just open the Bluetooth keyboard power switch and the tablet PC "Bluetooth." The BT keyboard will search the device and automatic connects.

• Win10 Connection Instructions:

Bluetooth pairing charging Low voltage indicator 1. Turn on the device, the blue light shinning one time, then press Button of Connect with 3 seconds, the blue light Twinkle, so that means the keyboard in the matching status. after maching succeed, the twinkle blue light off, fold close the keyboard, the Power off.



2. Open settings, turn on Bluetooth, click Add Bluetooth or other devices.

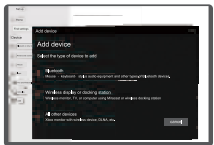

3. Select "Bluetooth" in the Add Device to search.

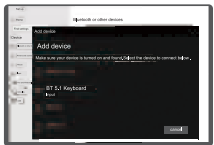

4. You will find the "BT 5.1 Keyboard " and then click the pairing name to connect.

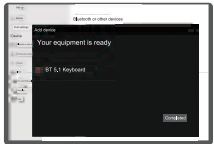

5. There is a tip for connecting successfully . you can use your keyboard comfortably .

• iOS Connection Instructions:

Bluetooth pairing charging Low voltage indicator 1. Turn on the device, the blue light shinning one time, then press Button of Connect with 3 seconds, the blue light Twinkle, so that means the keyboard in the matching status. after maching succeed, the twinkle blue light off, fold close the keyboard, the Power off.



2. Open the tablet PC setting "Bluetooth" into searching and pairing status .



3. You will find the "BT 5.1 Keyboard" and then click to next step .



4. There is a tip for connecting successfully . you can use your keyboard comfortably .

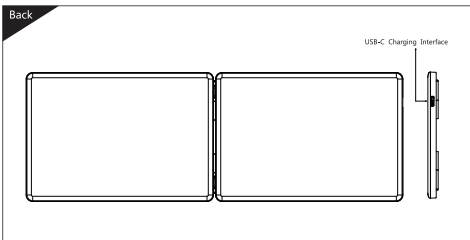
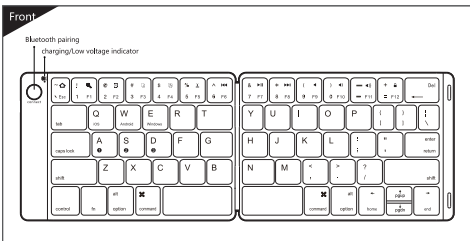

Compatible System

Win /iOS /Android

Bluetooth keyboard User's Manual

FCC Statement
Changes or modifications not expressly approved by the party responsible for compliance could void the user's authority to operate the equipment. This equipment has been tested and found to comply with the limits for a Class B digital device, pursuant to Part 15 of the FCC Rules. These limits are designed to provide reasonable protection against harmful interference in a residential installation. This equipment generates uses and can radiate radio frequency energy and, if not installed and used in accordance with the instructions, may cause harmful interference to radio communications. However, there is no guarantee that interference will not occur in a particular installation. If this equipment does cause harmful interference to radio or television reception, which can be determined by turning the equipment off and on, the user is encouraged to try to correct the interference by one or more of the following measures:
-- Reorient or relocate the receiving antenna.
-- Increase the separation between the equipment and receiver.
-- Connect the equipment into an outlet on a circuit different from that to which the receiver is connected.
-- Consult the dealer or an experienced radio/TV technician for help
This device complies with part 15 of the FCC rules. Operation is subject to the following two conditions (1) this device may not cause harmful interference, and (2) this device must accept any interference received, including interference that may cause undesired operation.

Note: Please read the user manual carefully before you start using this product

Warranty Card

User information

Company or personage full name

Contact address

TEL Zip

The purchased product name and model NO.

Purchased date

This reason due to the product broken and damage is not include on the warranty.
(1) accidents, misuse, improper operation, or any unauthorized maintenance, alteration, or disassembly;
(2) Improper operation or maintenance, violation of product instructions or improper connection of power during use;
(3) Or use consumables (such as spare batteries) that are not provided by the company but applicable laws Except where such restrictions are prohibited.



Keyboard Maintenance

1. Please keep the keyboard away from liquid or humid environment, saunas, swimming pool, steam room and don't let the keyboard get wet in the rain.
2. Please don't expose the keyboard at too high or too low temperature condition.
3. Please don't put keyboard under sun for a long time.
4. Please don't put keyboard close to the flame, such as cooking stoves, candles or fireplace.
5. Avoid sharp objects scratching products, timely to recharge products to ensure the normal use.

FAQ

1. The tablet PC can't connect the BT keyboard?
1) At first check the BT keyboard is into match code state, then open the table PC Bluetooth searching.
2) Checking the BT keyboard Battery is enough, the battery low is also lead to can't connect, you need charge.

2. The keyboard indication light always flashing when use?

Keyboard indication always flashing when use, is means the keyboard will be no power ,please charge the power as soon as possible.

3. The table PC display BT keyboard is disconnect?

The Bluetooth keyboard is not used for a period of time, the device will automatically enter the sleep state in order to save power. Press any key on the keyboard to wake up, and the Bluetooth connection will be automatically restored.

Multi-channel connection

- ◆ When connecting the first device, press Fn+ 1 , first and press "Connect" for 3 seconds to start the connection.
- ◆ Before connecting the second device, press Fn+ 2 , first and press "Connect" for 3 seconds to start the connection.
- ◆ Before connecting the third device, press Fn+ 3 , first and press "Connect" for 3 seconds to start the connection.
- ◆ To use multiple devices at the same time, press Fn + 1 / 2 / 3 BT3 to switch to the connected devices freely .

Troubleshooting

Please contact the after-sales service.

Copyright

It is forbidden to reproduce any part of this manual without the permission of seller.

Safety instructions

Do not open or repair this device, Do not use the device in a damp environment. Clean the device with a dry cloth.

Warranty

The device is provided with one-year limited hardware warranty from the purchase day.

Three system switching languages

iOS : control+Space key switch language

Windows : Alt+Shift switch language

Android : Shift+Space key switch language

Technical Specifications

Keyboard size : 291 x 100 x 7 mm(Open) Use key the working current : < 2.5 mA

Weight : 150 g Standby current : < 0.5 mA

Working distance : 8 m Sleep current : < 60 μA

Lithium battery capacity : 90 mAh Sleep time : Ten minutes

Working voltage : 3.3~4.2V Awaken way : Press key

Charger specifications: 5V 1A or 2A

Status Display LED

- ◆ Connect : Turn on the device, the blue light shinning one time, then press Button of Connect with 3 seconds, the blue light Twinkle, so that means the keyboard in the matching status , after maching succeed, the twinkle blue light off.
- ◆ Charging : Indicator light will be on green, after fully charging, the light crush out.
- ◆ Low Voltage Indication : When the voltage is below 3.3 V, blue light twinkles.

Remarks: In order to prolong the life span of the battery, when you do not use the keyboard for a long time, please switch off the power.

Product features

iOS/Android		Windows		Windows	
Fn+	Corresponding function	Fn+Shift	Corresponding function	Fn+	Corresponding function
~⇧	Return to Desk	~⇧	Home Page	~⇧	Esc
↵\Esc		↵\Esc		↵\Esc	
! F1	Search	! F1	Search	! F1	F1
@ F2	Select	@ F2	Select	@ F2	F2
# F3	Copy	# F3	Copy	# F3	F3
\$ F4	Stick	\$ F4	Stick	\$ F4	F4
% F5	Cut	% F5	Cut	% F5	F5
^ F6	Pre-Track	^ F6	Pre-Track	^ F6	F6
& F7	Play/Pause	& F7	Play/Pause	& F7	F7
* F8	Next	* F8	Next	* F8	F8
(F9	Mute	(F9	Mute	(F9	F9
) F10	Volume-) F10	Volume-) F10	F10
← F11	Volume+	← F11	Volume+	← F11	F11
+ F12	lock	+ F12	lock	+ F12	F12

Three system input method switch

iOS: control+ Space key

Windows : control+ Shift

Android : control+ Shift