

S M O O T H Q 4

EN - Quick start guide

1. Getting Started



Download "ZY Cami" App



Read Detailed
User Guide



Watch Video
Tutorials

2. Getting to Know SMOOTH-Q4

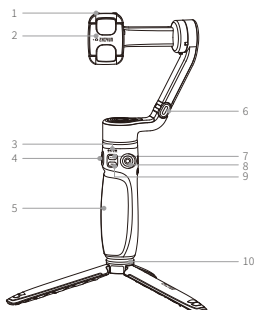

1. Fill Light Magnet
2. Phone Clamp
3. Gimbal Mode/Battery Level Indicator Lights
4. Control Wheel
5. Handle
6. Gimbal Shaft
7. MODE Button
8. Joystick
9. Photo/Video Button
10. Tripod
11. Tilt Axis Motor

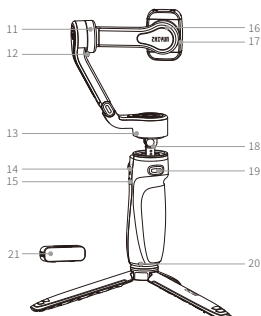

12. Tilt Axis Lock Clip
13. Pan Axis Motor
14. Type-C Charging/Firmware Upgrade Port
15. Power Button
16. Roll Axis Motor
17. Phone Clamp Lock Clip
18. Extension Rod
19. Trigger Button
20. Wrist Strap Hole
21. Magnetic Fill Light
(in SMOOTH-Q4 COMBO package)

3. Charging

Use provided USB Type-C cable to connect the USB charger (not included in the package, 5V2A recommended) to charge SMOOTH-Q4. The four indicator lights on the gimbal stay on in green when charging is complete.

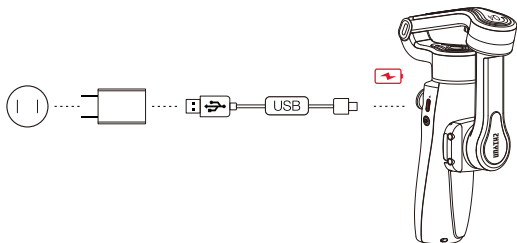

 Please power off SMOOTH-Q4 before charging.

4. Installation

1. Expand SMOOTH-Q4. Unlock the tilt axis, pan axis, and the phone clamp.

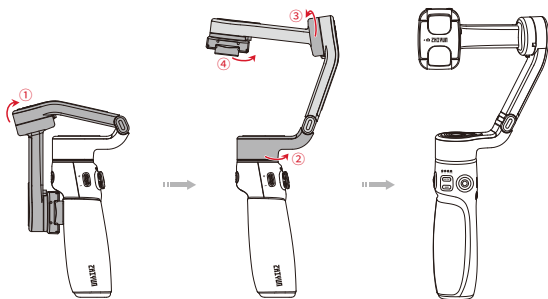

 Please rotate in the correct direction shown in the image to prevent the lock clip from damaging.

2. Install the smartphone to the phone clamp.

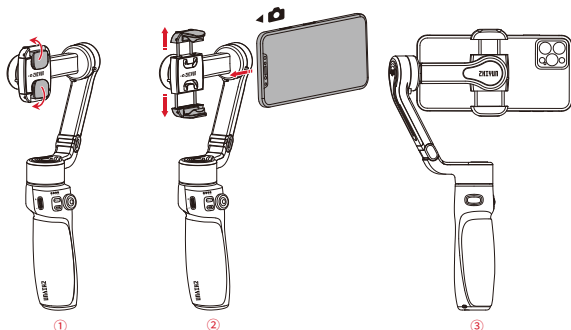

- 💡 Magnetic fill light is included in the SMOOTH-Q4 COMBO package. Install the magnetic fill light on the front or rear camera according to the actual filming scenario.

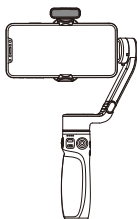

Fill Light on
Front Camera

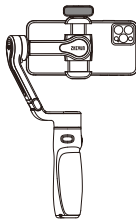







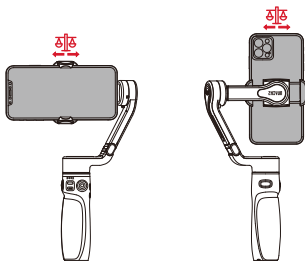

Fill Light on
Rear Camera

5. Balancing

When the phone is in landscape mode, adjust the position of the phone left or right until the phone is steady and is at almost level with the ground. When the phone is in portrait mode, move the phone clamp left or right until the phone is steady and is at almost level with the ground.



6. Button Description

- 1**  **Power Button**
 Single press: See gimbal battery level
 Long press: Power on/off
 Press eight times: Reset Bluetooth
- 2**  **Photo/Video Button**
 Single press: Take a photo/shoot a video
 Double press: Switch between photo/video mode
 Triple press: Switch between front/rear camera
 Long press: Take multiple photos
- 3**  **MODE Button**
 Single press: Switch gimbal mode
 Double press: Return to previous mode
 Long press: Enter/exit standby mode
- 4**  **Trigger Button**
 Single press: Enable/disable SmartFollow
 Double press: Gimbal reposition
 Triple press: Switch between landscape/portrait mode
 Long press: Enter Go mode
- 5**  **Gimbal Mode/Battery Level Indicator Lights**
 Display current mode/ battery level of the gimbal
- 6**  **Joystick**
 Push the joystick up/down/left/right to control the gimbal to rotate.
- 7**  **Control Wheel**
 Single press: Adjust the brightness of the magnetic fill light
 Long press: Turn on/off the magnetic fill light
 Slide up/down: Adjust the focal length
- 8**  **Type-C Charging/Firmware Upgrade Port**
 Charge the gimbal/connect to the computer for firmware upgrade via this port.

 Some of the buttons above are only available when the smartphone is connected to the gimbal and using “ZY Cami” app.

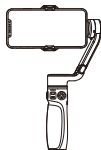

Landscape Mode

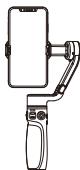

Portrait Mode

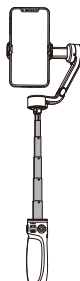

Extension Mode

7. Connect to "ZY Cami" App

1. Power on SMOOTH-Q4 and turn on Bluetooth on the smartphone.
2. Launch the "ZY Cami" app. Tap the camera icon in the upper left corner in the home screen to open the device list and select the SMOOTH-Q4 device you wish to connect (the SMOOTH-Q4 Bluetooth name can be checked on the axis arm USER ID: XXXX).
3. Activation on the "ZY Cami" app is required if the SMOOTH-Q4 connects the "ZY Cami" app for the first time. Internet connection is required. After the activation succeeds, you can enter the camera interface of ZY Cami App.

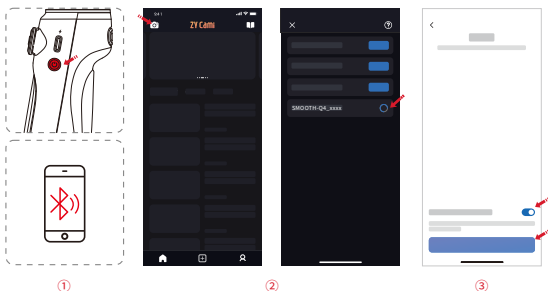

- 💡 ① ZY Cami is an app dedicatedly designed for SMOOTH-Q4. After activating SMOOTH-Q4 via the app, you can also use the app for many other advanced features such as SmartFollow, gesture control, timelapse, SMART mode, etc.
- ② The app is subject to updates without notice. Please always refer to the latest version.

8. Packing

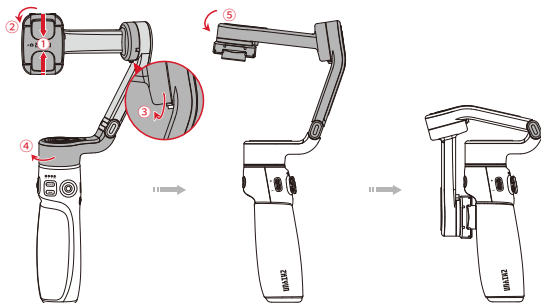

Disclaimer and Warnings

Thank you for purchasing SMOOTH-Q4. The information contains herein affects your safety, legitimate rights and obligation. Please read this instruction carefully to ensure proper configuration before use. Failure to read and follow this instruction and warnings herein may result in serious injury to you or bystanders, or damage to your device or property. Guilin Zhishen Information Technology Co., Ltd (hereinafter referred to as "ZHIYUN") reserves all rights for final explanation of this instruction and other documents related to SMOOTH-Q4. The information is subject to update without notice. Please visit www.zhiyun-tech.com to obtain the latest product information.

By using this product, you hereby signify that you have read this document carefully and that you understand and agree to abide by the terms and conditions herein. You agree that you are solely responsible for your own conduct while using this product, and for any consequences thereof. You agree to use this product only for purposes that are proper and in accordance with all terms, precautions, practices, policies and guidelines ZHIYUN has made and may make available.

ZHIYUN accepts no liability for damage, injury or any legal responsibility incurred directly or indirectly from the use of this product. Users shall observe safe and lawful practices including, but not limited to, those set forth herein.

ZHIYUN™ is the trademark of Guilin Zhishen Information Technology Co., Ltd and its affiliates. All product names or trademarks referred to herein are trademarks or registered trademarks of their respective holders.

Reading Tips

Legends:  Hints and Tips  Important

Scanning the QR code to visit websites, reading and downloading digital user guide under carrier network may cause traffic fee which will be charged by your carrier. It is recommended to operate under Wi-Fi.

Warnings

Read the ENTIRE User Guide to become familiar with the features of this product before operating. Failure to operate the product correctly can result in damage to the product or personal property and cause serious injury. This is a sophisticated product. It must be operated with caution and common sense and requires some basic mechanical ability. Failure to operate this product in a safe and responsible manner could result in injury or damage to the product or other property. This product is not intended for use by children without direct adult supervision. DO NOT use with incompatible components or in any way otherwise as mentioned or instructed in the product documents provided by ZHIYUN. The safety guidelines herein contain instructions for safety, operation and maintenance. It is essential to read and follow all of the instructions and warnings in the User Guide, prior to assembly, setup or use, in order to operate the product correctly and avoid damage or serious injury.

Safe Operation Guidelines

WARNING:

1. Never allow the product to come into contact with any liquid. Never immerse the product in water or make it get wet. Never use the product in the rain or a humid environment. Corrosion reaction may occur when the interior of the product is exposed to water, which may cause the battery to ignite spontaneously and may even cause an explosion.
2. If the product catches fire, please use water or water mist, sand, fire blanket, dry powder, carbon dioxide fire extinguisher immediately to put out the fire. Please choose the method according to the actual situation.
3. Please use the product in an environment with a temperature between -10°C and 45°C.
4. It is forbidden to disassemble the product in any way. If the battery is pierced during disassembly, it will cause the electrolyte inside the battery to leak or even cause fire or explosion.
5. Mechanical impact, rolling, or throwing of the product is prohibited. Do not place heavy objects on the product.

6. Do not heat the product. Do not place the product in a microwave oven or pressure cooker.
7. It is forbidden to place the product near a heat source (stove or heater, etc.) or inside the car in hot weather. Do not store the product in an environment above 45°C. The ideal temperature of storage is 22°C to 28°C.
8. Do not store the battery for a long time after it is completely discharged to avoid the battery entering the over-discharged state and causing damage to the battery cell, and it will not be able to resume use.

BE CAREFUL:

1. SMOOTH-Q4 is a high-precision control device. Damage may be caused to SMOOTH-Q4 if dropped or subject to external force, and this may result in malfunction.
2. Make sure the rotation of the gimbal axes is not blocked by external force when SMOOTH-Q4 is turned on.
3. SMOOTH-Q4 is not waterproof. Prevent contacts of any kind of liquid or cleaner with the SMOOTH-Q4. It is recommended to use dry cloth for cleaning.
4. Protect SMOOTH-Q4 from dust and sand during use.

CAUTION:

1. After the charging is complete, disconnect the product from the charger.
2. If you do not use the product for more than 10 days, please charge/discharge the battery to 40%-65% and store it to extend the battery life.
3. Recharge and discharge every 3 months to keep the battery active.
4. Keep the handle stable when powering on the SMOOTH-Q4. Shakiness during power-on may fail to start.

Warranty Period

1. Customers are entitled to replacement or free repair service in case of quality deficits found in the product within 15 days upon receipt of the product.
2. Customers are entitled to free repair service from ZHIYUN for any product proven defective in material or workmanship that results in product failure during normal consumer usage and conditions within the valid warranty period, which is 12 months counting from the date of selling. However, warranty period varies by product component and country of purchase. Please contact our after-sales service team on ZHIYUN official website or your place of purchase for detailed warranty information.

Warranty Exclusions

1. Products subjected to unauthorized repair, misuse, collision, neglect, mishandling, soaking, accident, and unauthorized alteration.
2. Products subjected to improper use or whose labels or security tags have been torn off or altered.
3. Products whose warranty has expired.
4. Products damaged due to force majeure, such as fire, flood, lightning, etc.

Warranty Claim Procedure

1. If failure or any problem occurs to your product after purchase, please contact a local agent for assistance, or you can always contact ZHIYUN's customer service through email at info@zhiyun-tech.com or website at www.zhiyun-tech.com.
2. Your local agent or ZHIYUN's customer service will guide you through the whole service procedure regarding any product issue or problem you have encountered. ZHIYUN reserves the right to reexamine damaged or returned products.

Scan the QR code below to know more about our products.



Official website



Facebook
(Zhiyun Tech)



Facebook
(Zhiyun Support)



Instagram



YouTube

Quality Certificate

Please download the latest version from www.zhiyun-tech.com

This document is subject to change without notice.

ZHIYUN™ are the trademark of ZHISHEN.

Copyright © 2022 ZHISHEN. All rights reserved.

Tel: +86 400 900 6868

USA Hotline: +1 808-319-6137, 9:00-18:00 GMT-7, Mon-Fri

Europe Hotline: +49 (0)6101 8132 180, 10:00-17:00 GMT+1, Mon-Fri

Email: info@zhiyun-tech.com

Website: www.zhiyun-tech.com

Address: 09 Huangtong Road, Tieshan Industrial Zone, Qixing District, Guilin, 541004, Guangxi, China.



If at any time in the future you should need to dispose of this product please note that:
Waste electrical products should not be disposed of with household waste. Please recycle where facilities exist. Check with your Local Authority or retailer for recycling advice. (Waste Electrical and Electronic Equipment Directive)

FCC STATEMENT :

This device complies with Part 15 of the FCC Rules. Operation is subject to the following two conditions:

- (1) This device may not cause harmful interference, and
 - (2) This device must accept any interference received, including interference that may cause undesired operation.
- Warning: Changes or modifications not expressly approved by the party responsible for compliance could void the user's authority to operate the equipment.

NOTE: This equipment has been tested and found to comply with the limits for a Class B digital device, pursuant to Part 15 of the FCC Rules. These limits are designed to provide reasonable protection against harmful interference in a residential installation. This equipment generates uses and can radiate radio frequency energy and, if not installed and used in accordance with the instructions, may cause harmful interference to radio communications. However, there is no guarantee that interference will not occur in a particular installation. If this equipment does cause harmful interference to radio or television reception, which can be determined by turning the equipment off and on, the user is encouraged to try to correct the interference by one or more of the following measures: Reorient or relocate the receiving antenna. Increase the separation between the equipment and receiver. Connect the equipment into an outlet on a circuit different from that to which the receiver is connected. Consult the dealer or an experienced radio/TV technician for help.

RF warning statement:

The device has been evaluated to meet general RF exposure requirement. The device can be used in portable exposure condition without restriction.