

Online Manual

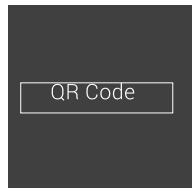

Need more help? Scan here to view the manual for more information.

You can also type the following link in a web browser:

www.etekcity.com/support/manual/model/esf24

Due to app updates and improvements, the contents of the manual may change without notice. In case of any differences, follow the in-app instructions.

Warranty

Scan Here to Receive Exclusive News

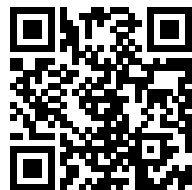

Your product comes with a 2-year limited warranty starting from the date of purchase.

1. Scan the QR code or visit etekcity.com/warranty
2. Enter your purchase info to receive exclusive news.
3. Learn about our quality customer support and gain easy access to warranty information.

If you have any questions or concerns about your new product, please contact our helpful Customer Support Team.

Customer Support

Etekcity Corporation
1202 N. Miller St., Suite A
Anaheim, CA 92806

Support Hours
Mon–Fri
9:00 am – 5:00 pm PST/PDT

Email: support@etekcity.com
Toll-Free: 1-855-686-3835

*Please have your invoice and order ID ready before contacting Customer Support.

AQ_24G17_us



Smart Fitness Scale

Quick Start Guide

WARNING: This scale uses a harmless electrical current to measure body fat. Consult a healthcare professional before using the smart scale if you use electronic medical equipment such as a pacemaker.

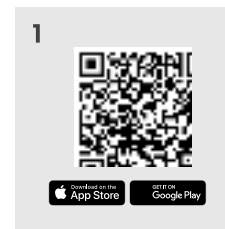

To download the free VeSync app, scan the QR code or search "VeSync" in the Apple App Store® or Google Play Store.

Note:

- Please make sure your firmware and software are up to date.
- The VeSync app is continually being improved and may change over time. If there are any differences, follow the in-app instructions.

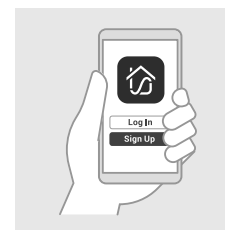

Open the VeSync app.
Log In or **Sign Up**.

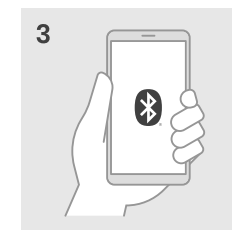

Make sure your phone has
Bluetooth® turned on.

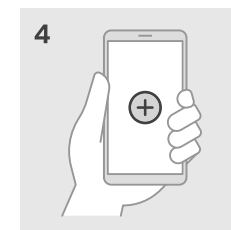

Tap **+** in the VeSync app.

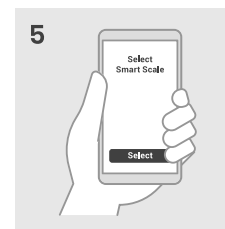

Select your smart scale
from the device list.

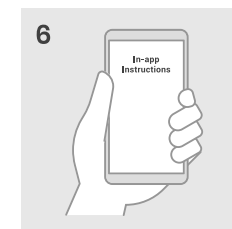

Follow the in-app instructions
to complete setup.

Note:

- You can change the scale's in-app name and icon at any time in the smart fitness scale settings.
- When the scale display turns off, the scale's Bluetooth will disconnect and go into auto-off mode. However, when the scale display lights up and the app is opened to the device page, the scale will reconnect to Bluetooth.

Note:

- You can tap on the product categories to jump to different sections of the device list.
- Make sure to choose the right device model (you can find it on the back of the scale), or it will lead to a connection failure.

Display Controls

	Up Button
	Set Button
	Down Button

Note: Controls **only** show when in **Manual Mode**. They will not show in Smart Mode.

Using Your Smart Scale

Tips

Specifications

Models	EFS-C651-KUS
Weight Capacity	400 lb / 180 kg / 28 st
Increments	0.1 lb / 0.05 kg
Weight Units	lb / kg / st
Platform	Tempered Glass
Dimensions	11 x 11 x 1.1 in / 28 x 28 x 2.9 cm
Battery	4 x 1.5V AAA Batteries
Auto-Off	3 seconds (after displaying biometrics)
Operating Systems	iOS® 12.0+ or Android™ 6.0+

Display Icons

	User Icon (Manual Mode only)
	Manual Mode Indicator
	Zero-Current Mode is activated (Electrical current is disabled . Scale will only measure weight and BMI).
	Bluetooth® Indicator shows when the scale is connected to the VeSync app
	Low Battery Indicator only shows when the batteries are getting low and need to be replaced.
	Increase/Decrease Indicators display the change in current result compared to previous result.

Federal Communication Commission Interference Statement – Part 15

This device complies with Part 15 of the FCC Rules. Operation is subject to the following two conditions:

- (1) This device may not cause harmful interference, and
- (2) This device must accept any interference received, including interference that may cause undesired operation.

NOTE: This equipment has been tested and found to comply with the limits for a Class B digital device, pursuant to Part 15 of the FCC Rules. These limits are designed to provide reasonable protection against harmful interference in a residential installation. This equipment generates, uses and can radiate radio frequency energy and, if not installed and used in accordance with the instructions, may cause harmful interference to radio communications. However, there is no guarantee that interference will not occur in a particular installation. If this equipment does cause harmful interference to radio or television reception, which can be determined by turning the equipment off and on, the user is encouraged to try to correct the interference by one or more of the following measures:

- ✧ Reorient or relocate the receiving antenna.
- ✧ Increase the separation between the equipment and receiver.
- ✧ Connect the equipment into an outlet on a circuit different from that to which the receiver is connected.
- ✧ Consult the dealer or an experienced radio/TV technician for help.

FCC Caution: Any changes or modifications not expressly approved by the party responsible for compliance could void the user's authority to operate this equipment.

FCC SDOC SUPPLIER'S DECLARATION OF CONFORMITY

Etekcity Corporation hereby declares that this equipment is in compliance with the FCC Part 15 Subpart B. The declaration of conformity may be consulted in the support section of our website, accessible from www.etekcity.com