

高品質藍牙耳機

使用說明書

型號：TWS-B6

感謝您使用TWS-B6藍牙耳機，流線型的機身，簡約的按鍵操作，時尚的設計風格，是您最好的選擇。在使用藍牙耳機前，您須給耳機充滿電，並通過您選定的藍牙設備配對連接。

1、關於TWS- B6藍牙耳機

- ① 耳機指示燈
- ② 多功能鍵
- ③ 聽筒
- ④ 充電位
- ⑤ 配機充電盒
- ⑥ 充電盒充電口
- ⑦ 充電盒指示燈
- ⑧ 充電盒無線充電位置

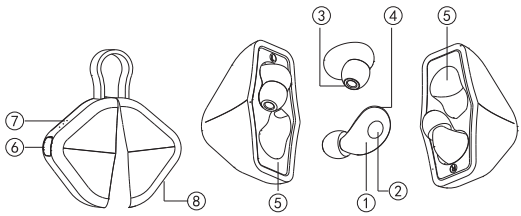

2、產品充電

- 1) 給耳機充電
請將耳機放入充電盒相對應的充電位，耳機及充電盒的白色LED指示燈將持續發光，同時耳機進入充電狀態，當耳機的完成充電後白色指示燈將會熄滅，充電時間大約為1.5小時。
- 2) 給座充電
您可使用產品自帶的充電線進行充電，也可使用滿足Qi標準的無線充電底座進行充電，電源指示燈亮起時表示座充進入充電狀態。

3、將耳機與您的手機配對

- 1) 當耳機置於充電盒時，打開耳機充電盒，耳機會自動開機，耳機上綠色指示燈閃爍3次，左右耳機对接成功後，左耳機進入手機配對狀態，此時左耳機上的白/綠色指示燈交替閃爍,與手機配對請按3.2說明操作。
- 2) 與手機配對
1、打開手機上的設置，進入藍牙功能；
2、選定“新配對設備”中的更多設備，搜索名稱為“B6”的耳機設備；
3、選定搜索到的“B6”耳機設備進行配對，如果手機要求輸入PIN碼，請輸入“0000”（四個零）確認配對。
註：部分手機配對完成後還須手動連接藍牙設備；若您的手機藍牙是2.1或以上版本的，配對時無需配對密碼即可完成配對。
- 4、初次連接約15秒內手機上出現副機會自動發起與手機配對連接請求，點擊確認後手機保存副機配對記錄，可以實現左右耳主副機切換。

-1-

4、如何使用

功 能	操 作	LED 狀態	提示音	說明
開機	1.將耳機從充電座取出 2.關機後，長按多功能鍵約3秒	綠燈閃爍3次	/	若藍牙沒有回連5分鐘後關機
關機	將耳機放入充電座	白燈閃爍1次	/	藍牙關機
TWS 配對模式	開機後自動進入TWS配接,完成配對	/	/	耳機進入配對模式
來電接聽	來電時，雙擊多功能鍵或用手機接聽	/	/	當從本機中聽到鈴聲後,雙擊多功能鍵,本機可接聽電話
來電拒接	有電話打入時,長按多功能鍵	/	/	有來電時長按多功能鍵即可拒接來電接聽
結束通話	雙擊輕觸多功能鍵	/	/	通話中,雙擊多功能鍵,通話結束
播放/暫停	輕觸多功能按鍵1次	/	/	在待機狀態下,單擊多功能鍵,音樂啟動播放,在按臺下,音樂暫停,可重複操作
語音撥號	在聯機待機,無音樂狀態,雙擊多功能鍵	/	/	在聯機待機,無音樂狀態,雙擊多功能鍵,然後根據手機提示對着耳機說出手機通訊錄中存儲的號碼所對應的人名（手機必須支持語音撥號功能）
下臺曲	播放歌曲時雙擊多功能鍵	/	/	會自動切換到下臺曲
充電	耳機放入充電盒,合上蓋,耳機在充電時,指示燈將發出白光	充電中白色指示燈亮,充滿時白燈熄滅	/	對耳機充電時耳機將自動關機,在充電過程中,白色指示燈點亮,電池充滿後白燈熄滅

5、備註說明

- 1) TWS對接方式簡易快速使用方法：（打開座充，耳機自動開機；耳機放入充電座後將充電座合上，耳機自動關機並開始充電）打開充電座，左右耳自動對接，對接成功後主機（白線LED交替閃爍）進入配對模式，用手機搜索並且連接藍牙使用
- 2) 無線充電功能
將藍牙座充無線充電標誌對準充電器無線充電標誌，重合放穩，即可給藍牙座充充電。

6、疑難排除

- 若您未能將耳機和移動電話連接上，請嘗試以下步驟：
- 1) 確保耳機已被啟動及已完全充電；
2) 確保耳機已與移動電話配接；
3) 確保移動電話的藍牙功能已被啟動，詳細指引請參閱您的移動電話用戶手冊；

-2-

- 4) 確保耳機在移動電話10米範圍內，且當中沒有障礙物阻隔，例如：牆壁或其他電子設備；
5) 若以上步驟未能排除疑難，請將耳機充電，或將您的移動電話關機後再次開機嘗試連接。

7、安全守則

- 1) 請根據當地法律法規，駕車時正確使用移動電話及耳機；若在駕駛時使用耳機，請保持足夠專注力，以確保行車安全；
2) 切勿將耳機給予兒童玩耍，細小零件可引致窒息危險；
3) 用戶請留意在某些指定區域的指示，按規定使用移動電話和耳機（這些區域包括醫院、爆破範圍及有潛在爆炸危險的環境）；
4) 用戶在登機前請先關掉耳機，切勿在飛機上使用；
5) 切勿將耳機懸掛或存放在任何氣袋可能展開的位置，當氣袋展開時，這會造成嚴重的人身損害；
6) 切勿拆開或損毀內置電池。
注意：當棄置電池時，須根據當地條例，不可當普通廢物棄置。

8、保養及維修

- 1) 將耳機方在口袋或袋子前，請先關掉耳機，避免誤操作按下耳機功能鍵；
2) 切勿將耳機暴露於液體或潮濕的地方；
3) 切勿使用研磨型溶劑清潔耳機；
4) 切勿將耳機放置在溫度極高或極低的地方，最佳存放環境為-10℃到+60℃，否則會影響耳機的使用壽命；
5) 切勿將耳機暴露於明火之中，避免爆炸危險。
6) 切勿將耳機接觸尖銳對象，會造成刮痕或損毀；
7) 切勿將任何物件插入耳機內，會損毀內部組件；
8) 切勿嘗試拆卸耳機。
如果長時間不使用耳機，請確保將耳機放置在乾燥的地方，若放置超過壹個月要按時給予充電，以保證電池及耳機的工作性能，並遠離溫度變化很大及多塵的地方。

9、產品技術參數

- 1) 藍牙版本： V5.0+EDR
2) 藍牙協議： A2DP、AVRCP、Headset、Handsfree、CVC、APTX
3) 頻率範圍： 2402.0-2480.5MHz
4) 工作範圍： 10米
5) 通話時間： 約8小時
6) 待機時間： 約50小時
7) 充電時間： 約2小時

-3-

High-end Bluetooth TWS Earbuds

User Manual

Model No.:TWS-B6

1、TWS-B6 Bluetooth Earbuds

- 1 Indicator light for headset
2 Multifunctional button
3 Speaker
4 Headset charging place
5 Charging case
6 Charging interface
7 Indicator light for charging case
8 Wireless charging place

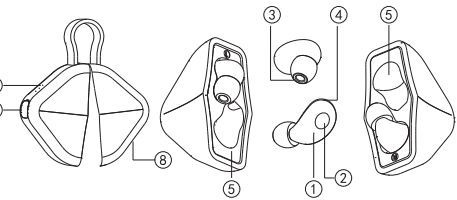

2、Charging

- 2.1 Charging for earbuds
Please put the earbuds into the the charging case. The white LED indicator will keep on when charging, and off after finishing charging. It takes approx 1.5 hours to fully charge the battery.
- 2.2 Charing for case
You can use the charging cable to charge, or use the wireless charging case that meets the Qi standard for charging. When the power indicator is on, it indicates that the case is charging.

3、Pairing

- 3.1 When open the case, the earbuds will automatically turn on, and the green light will flashes 3 times. After the left and right earbuds are successfully connected, the left earbud gets into the pairing state, then white and green indicator lights will flash alternately. To pair with the mobile phone, please follow the instructions in 3.2.
- 3.2 Pair with your phone
1) Turn on your mobile Bluetooth function
2) SSelect more devices in the "New paired device" and search for a headset device named "B6".
3) Select the searched "B6" headset device for pairing. If your phone required to enter PIN code, please enter "0000" to confirm the pairing. (If your mobile operating system is 2.1 or above, don't need to enter password.) Note: Some mobile phones need to be connected with Bluetooth device after pairing.
4) Within 15 seconds after the initial connection, a secondary opportunity appears on the mobile phone to initiate a connection request with the mobile phone. After clicking the confirmation, the mobile phone saves the pairing record of the auxiliary machine, and the left and right ear main and auxiliary machines can be switched.

4、Description

- 4.1 Easy way to use TWS method: (Open the charger, the earbuds will automatically turn on; Put earbuds into case and close, the earbuds will automatically shut down and start charging).Open the charging case, the left and right ears are automatically pairing. The host (white and green LED light flash alternately) enters the pairing mode, search blurtooth name and connect.
- 4.2 Wireless charging function

-1-

Put charging wireless charging mark with the wireless charging indicator of the case, then it will charge for the case.

5、How to use

Function	Operation	LED status	Voice Prompt	Description
Power on	1.Remove the headsets from the charging case. 2.press the multifunction button in 3 seconds after shutting down.	Green light flashes 3 times	/	It will shut down if bluetooth does not return after 5 minutes.
Power off	Put the headsets into the charging case	White light flashes once	/	Bluetooth shutdown
TWS pairing mode	Automatically enter TWS mating after booting, complete pairing	/	/	Headsets enter pairing mode
Answer Call	Double-click the MFB or by your mobile phone	/	/	Double-click the MFB to answer the call
Reject Call	Press MFB	/	/	Press MFB to reject call
End Call	Double-click the MFB	/	/	Double-click the MFB to end the call
Play/Pause	Touch MFB once	/	/	In standby mode, click MFB, the music starts, click again, the music is paused
Voice dialing	Double-click the MFB	/	/	In online standby, no music status, double-click the MFB, and then speak the name corresponding to the number stored in the phone address book to the headset according to the prompt of the mobile phone (the phone must support the voice dialing function)
Next song	Double-click the MFB	/	/	Switch to the next song
Charging	Put headsets into case and close, the indicator light will turn on white	White light on when charging, and off when fully charge	/	The headset will automatically shut down when charging the headset. During the charging process, the white indicator light is on and the white light is off when the battery is fully charged

6、Troubleshooting

- If you are unable to connect your headset to your mobile phone, please try the following steps:
- 1) Make sure the headset is activated and fully charged.
2) Make sure the headset is connected to the mobile phone.
3) Make sure the Bluetooth function of the mobile phone has been activated. Please refer to your mobile phone user manual for detailed instructions.

-2-

- 4) Make sure that the headset is within 10 meters of the mobile phone and there are no obstructions in it, such as walls or other electronic devices.
5) If the above steps can not solve the problem, please charge the headset, or turn off your mobile phone and try to connect again.
7、Safe rules
1) Please use mobile phones and earphones correctly when driving according to local laws and regulations; if you use headphones while driving, please maintain sufficient concentration to ensure driving safety.
2) Do not give headphones to children to play, small parts can cause suffocation.
3) Please pay attention to the instructions in certain designated areas, using mobile phones and headphones as required (these areas include hospitals, blasting areas and potentially explosive environments).
4) Please turn off the headset before boarding the aircraft, and do not use it on the aircraft.
5) Do not hang or store the headphones in any position where the air bag may be deployed. This may cause serious personal injury when the air bag is deployed.
6) Do not disassemble or damage the internal battery.
Note: When disposing of the battery, it must be disposed of as ordinary waste according to local regulations.

8、Care and Maintenance headset

- 1) Turn the headset in front of your pocket or bag, please turn off the headset to avoid accidental operation. Press the headset function button.
2) Do not expose headphones to liquid or moisture.
3) Do not use abrasive solvents to clean the headphones.
4) Do not place the headphones at extremely high or low temperatures. The optimal storage environment is -10 ° C to +60 ° C, otherwise it will affect the life of the headphones.
5) Do not expose headphones to open flames to avoid the risk of explosion.
6) Do not touch the earphones with sharp objects, which may cause scratches or damage.
7) Do not insert anything into the earphone, it will damage the internal components.
8) Do not attempt to disassemble the headset.
If you don't use the headset for a long time, please ensure that the headset is placed in a dry place. If it is left for more than one month, it should be charged on time to ensure the performance of the battery and headphones, and away from the place where the temperature changes greatly and is dusty.
9、About Certification This device complies with part 15 of the FCC Rules. Operation is subject to the following two conditions: (1) This device may not cause harmful interference, and (2) this device must accept any interference received, including interference that may cause undesired operation.
(3) FCC ID: XELB6

Changes or modifications not expressly approved by the party responsible for compliance could void the user's authority to operate the equipment.

10、Specification

- 1) Bluetooth Version: V5.0+EDR
2) Profiles supported: A2DP、AVRCP、Headset、Handsfree、CVC、APTX
3) Frequency range: 2402.0-2480.5MHz
4) Operation range: 10 meters
5) Talking time: about 8 hours
6) Standby time: about 50 hours
7) Charging time: about 2 hours

-3-

档案比例：1:1

规格尺寸：392*98mm

材质：125g铜版纸

成型后尺寸：98*98mm

风琴折