

INSTRUCTION  
MANUAL



W18  
Wireless Charger



• Charging the Bluetooth headset

Insert the plug to the Bluetooth headset charging compartment (Attention: If a thick silicone protective cover is provided on the headset charging compartment, it may cause poor contact and failure to charge, please remove the silicone protective cover before charging.)

INTRODUCTION

- ① Wireless charging area for mobile phone
- ② Charging of AirPods/AirPods Pro.
- ③ TYPE-C Charging
- ④ Operating indicator light.
- ⑤ TYPE-C Female
- ⑥ Cellphone stand using for charging in horizontal direction

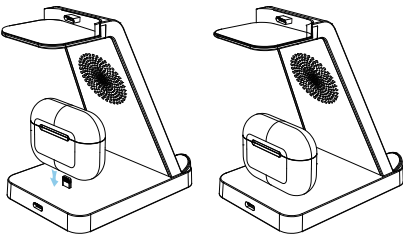
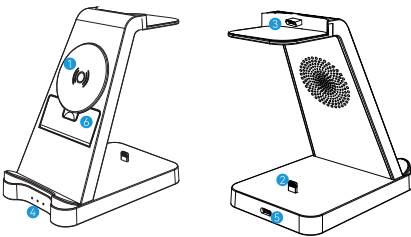

• Charging for W18

This product needs to be powered with an adapter with a power of 12V-1.5A / 9V-2A / 9V-2.22A / 12V-1.67A and connected to the type-c port. When the bottom power indicator is on, it means that the power supply is connected.

• Operating indicator

The blue working indicator is always on during the charging process of the mobilephone;  
The green working indicator is on when it's been fully charged;  
The red working indicator is always on when standby by;  
The red working indicator light will be flashing when there with errors.

OPERATION INSTRUCTIONS

• Charging for cellphone

In vertical direction: Support the maximum phone thickness. Put the mobile phone upright in the wireless charging area of mobile phone, and you can see the "Charging indicator" on the display of the mobile phone, showing that it is being charged properly

In horizontal direction: Put the fold-able stand down, put cellphone in horizontal direction on this stand, and you can see the "Charging indicator" on the display of the mobile phone, showing that it is being charged properly

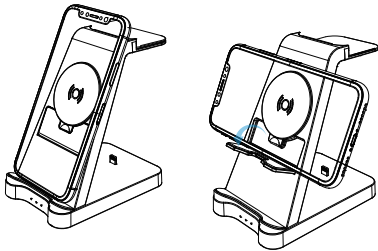

SPECIFICATIONS

Name	Wireless Charger	Model	w18
Product size	124*77.2*128mm	Power Supply Port	Type C
Input	12V-1.5A / 9V-2A 9V-2.22A / 12V-1.67A	Maxium Output Power	Phone Charging 15W , Type-C Charging 3W, Lightning Charging 5W

MATTERS NEEDING ATTENTION

- When charging the device, do not use a protective cover with a thickness of more than 5mm, and do not use a protective cover with a metal sheet.
- Do not put metal foreign objects in the charging area.
- When charging, please aim the device at the center of the charging area.
- Please use the adapter we included or another adapter that can achieve at least 18W output.

This device complies with part 15 of the FCC Rules. Operation is subject to the following two conditions: (1) This device may not cause harmful interference, and (2) this device must accept any interference received, including interference that may cause undesired operation.

Any Changes or modifications not expressly approved by the party responsible for compliance could void the user's authority to operate the equipment.

**Note:** This equipment has been tested and found to comply with the limits for a Class B digital device, pursuant to part 15 of the FCC Rules. These limits are designed to provide reasonable protection against harmful interference in a residential installation. This equipment generates uses and can radiate radio frequency energy and, if not installed and used in accordance with the instructions, may cause harmful interference to radio communications. However, there is no guarantee that interference will not occur in a particular installation. If this equipment does cause harmful interference to radio or television reception, which can be determined by turning the equipment off and on, the user is encouraged to try to correct the interference by one or more of the following measures:

- Reorient or relocate the receiving antenna.
- Increase the separation between the equipment and receiver.
- Connect the equipment into an outlet on a circuit different from that to which the receiver is connected.
- Consult the dealer or an experienced radio/TV technician for help.

This equipment complies with FCC radiation exposure limits set forth for an uncontrolled environment. This equipment should be installed and operated with minimum distance 20cm between the radiator & your body.