

SOUND DETECTION AND AUTO WAKE UP

Adjust sound detection sensitivity

You can turn on **Sound Detection Alert** and adjust the **Sound Sensitivity** to detect sounds and turn on the parent unit while its screen is switched off or dimmed.

When the baby unit detects sounds that exceed certain levels, the parent unit screen will turn on and the baby unit starts transmitting the sounds to the parent unit, and you can see and hear your baby.

If you have turned on **Sound Detection Alert**, the parent unit beeps when the baby unit detects sounds.

Sound Sensitivity Level	Level 3 (Highest)	Level 2 (Medium)	Level 1 (Lowest)
DESCRIPTION	The parent unit screen and speaker turn on for very small babbling and louder sounds from your baby. The parent unit remains quiet when your baby makes soft sounds.	The parent unit screen and speaker turn on for loud babbling and louder sounds from your baby. The parent unit remains quiet when your baby makes soft sounds.	The parent unit screen and speaker turn on for loud crying or screaming sounds from your baby. The parent unit remains quiet when your baby makes soft sounds.

Sound activated screen and audio - Auto Wake Up

When **Auto Wake Up** is turned on, the parent unit screen stays off to save power when the baby unit detects no sound.

Once the baby unit detects sounds that are louder than the chosen sound sensitivity level, the parent unit screen and speaker turn on automatically. The parent unit will then turn off again after 50 seconds of no sound detection.

NOTES

- If you have muted the parent unit speaker, only the parent unit screen will turn on when a sound is detected.
- If you have turned on **Auto Wake Up** but turned off **Sound Detection Alert**, the parent unit will wake up when the baby unit detects sounds that are louder than the chosen sound sensitivity level.

MOTION DETECTION

Adjust motion detection sensitivity

You can turn on **Motion Alert** and adjust the **Motion Sensitivity** to detect motions and turn on the parent unit while its screen is switched off or dimmed.

When the baby unit's camera detects motions that exceed certain levels, the parent unit screen will turn on and the baby unit starts transmitting the sounds to the parent unit, and you can see and hear your baby.

If you have turned on **Motion Alert**, the parent unit beeps when the baby unit detects motions.

Motion Sensitivity Level	Level 3 (Highest)	Level 2 (Medium)	Level 1 (Lowest)
DESCRIPTION	The parent unit screen and speaker turn on for small motions, such as yawning or stretching.	The parent unit screen and speaker turn on for normal daily motions, such as crawling or playing around the house.	The parent unit screen and speaker turn on for large motions, such as children are chasing or jumping around.

NIGHT VISION

The baby unit has infrared LEDs that allow you to see your baby clearly at night or in a dark room. When the baby unit being viewed detects too low light levels, the infrared LEDs are switched on automatically. The images from the baby unit are in black and white, and **NV** appears on the screen.

NOTES

- It is normal if you see a short white glare on your parent unit screen as the baby unit is adapting to the dark environment.
- When the infrared LEDs are on, the images are in black and white. This is normal.

TIP

- Depending on the surroundings and other interfering factors, like lightings, objects, colors and backgrounds, the video quality may vary. Adjust the baby unit's angle or place the baby unit at a higher level to prevent glare and blurry display.

DIM MODE

The parent unit display will dim to conserve energy after 5 minutes of inactivity, in which there is neither key pressed nor alert received from the baby unit.



FOR VM919-2HD ONLY

Monitoring mode

Change different views - Single CAM

Select baby unit 1 **1** or baby unit 2 **2** to view the image from the baby unit.

Change different views - Patrol

Select **Patrol** mode as your monitoring mode to alternately view the images from baby units **1** and **2** every 10 seconds.

Change different views - Split

Select **Split** mode as your monitoring mode to view the images from both baby units at once.

NOTE

- While in **Split** mode, you can press **4** or **7** to highlight the view of the baby unit 1 **1** or baby unit 2 **2**, and hear the sounds transmitted from the baby unit.

MOUNT THE BABY UNIT ON DRY WALL (OPTIONAL)

NOTES

- Check for reception strength and baby unit's angle before drilling the holes.
- The types of screws and anchors you need depend on the composition of the wall. You may need to purchase the screws and anchors separately to mount your baby units.

- Place the wall mount bracket on a wall and then use a pencil to mark the top and the bottom holes as shown. Remove the wall mount bracket and drill two holes in the wall (7/32 inch drill bit).
- If you drill the holes into a stud, go to step 3.
- If you drill the holes into an object other than a stud, insert the wall anchors into the holes. Tap gently on the ends with a hammer until the wall anchors are flush with the wall.



- Align the wall mount bracket and screws with the holes in the wall as shown. Tighten the screw in the middle hole first, so that the wall mount bracket position is fixed. You can tighten the other screw in the top hole.
- Insert the screws into the holes and tighten the screws until only 1/4 inch of the screws are exposed.



- Place the baby unit on the wall mount bracket. Tighten the screw into the threaded socket at the bottom to secure the baby unit.
- Place the baby unit on the wall mount bracket. Tighten the screw into the threaded socket at the bottom to secure the baby unit.



- You can maximize your baby unit's viewing angles by tilting the wall mount bracket. Hold the baby unit, and then rotate the knob in anticlockwise direction. This will loosen the joint of the wall mount bracket. Tilt your baby unit up or down to adjust to your preferred angle. Then, rotate the knob in clockwise direction to tighten the joint and secure the angle.

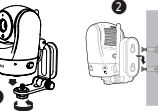

FREQUENTLY ASKED QUESTIONS

Below are the questions most frequently asked about the baby monitor.

Why does the baby monitor not respond normally?

- Try the following (in the order listed) for common cure:
 - Disconnect the power to the baby units and the parent unit.
 - Wait a few seconds before connecting power back to the baby units and the parent unit.
 - Turn on the baby units and the parent unit.
 - Wait for the parent unit to synchronize with the baby units. Allow up to one minute for this to take place.

Why don't the lights of the baby unit and patch unit go on when I switch on the unit?

Perhaps the parent unit's battery is depleted. Insert the appliance plug into the parent unit and put the adapter in a wall socket. The parent unit will establish connection with the baby unit.

Perhaps the baby unit is not connected to the power. Insert the appliance plug into the baby unit and put the adapter in a wall socket. Then, slide the **ON/OFF** to switch on the baby unit and to establish connection with the parent unit.

Why doesn't my parent unit charge to AC power?

Make sure the power is not controlled by a wall switch.

Why do I get glare or blurry display on my parent screen when viewing my baby at night?

The screen is in black and white during night-time or in a dark room when the night vision feature is activated. This is normal.

Why does the baby monitor produce a high-pitched noise?

The parent unit and baby units may be too close to each other.

- Move the parent unit away from the baby units until the noise stops. OR
- Turn down the volume of your parent unit.

Why does the parent unit beep?

The parent unit may not have enough charge for the parent unit to perform normally. Charge the battery in the parent unit until the battery icon becomes solid **100%**.

The temperature of your baby's room may be too high or too low.

Why can't I hear a sound? Why can't I hear my baby cry?

The parent unit speaker/volume may be too low. Press **VOL+** to increase the volume, or use the parent unit menu to change sound sensitivity level to the highest level.

Why can't I establish a connection? Why is the connection lost every now and then?

Other electronic and wireless products may cause interference with your baby monitor. Try installing your baby monitor as far away from these devices as possible.

If you power on only one baby unit, your parent unit may display **Make sure baby unit X is on or move closer to baby unit X**, and the **LINK** LED light flashes. Switch to the baby unit you have powered on via menu.

THE RBRC SEAL

The RBRC seal on the lithium-ion battery indicates that Vtech Communications, Inc. is voluntarily participating in an industry program to collect and recycle these batteries at the end of their useful lives, when taken out of service within the United States and Canada.

The program provides a convenient alternative to placing used lithium-ion batteries into the trash or municipal waste, which may be illegal in your area.

Vtech's participation makes it easy for you to drop off the parent battery at local retailers participating in the program or at authorized Vtech product service centers. Please call **1 (800) 8 BATTERY** for information on Li-ion battery recycling and disposal restrictions in your area. Vtech's involvement in this program is part of its commitment to protecting our environment and conserving natural resources.

The RBRC Seal and (800) 8 BATTERY are registered trademarks of Call2Recycle, Inc.

FCC AND IC REGULATIONS

FCC Part 15

This equipment has been tested and found to comply with the requirements for a Class B digital device under Part 15 of the Federal Communications Commission (FCC) rules. These requirements are intended to provide reasonable protection against harmful interference in a residential installation. This equipment generates, uses and can radiate radio frequency energy and, if not installed and used in accordance with the instructions, may cause harmful interference to radio communications. However, there is no guarantee that interference will not occur in a particular installation. If this equipment does cause harmful interference to radio or television reception, which can be determined by turning the equipment off and on, the user is encouraged to try to correct the interference by one of the following measures:

- Reorient or relocate the receiving antenna.
- Increase the separation between the equipment and receiver.
- Connect the equipment into an outlet on a circuit different from that to which the receiver is connected.
- Consult the dealer or an experienced radio/TV technician for help.

WARNING: Changes or modifications to this equipment not expressly approved by the party responsible for compliance could void the user's authority to operate the equipment.

This device complies with Part 15 of the FCC rules. Operation is subject to the following two conditions: (1) this device may not cause harmful interference, and (2) this device must accept any interference received, including interference that may cause undesired operation.

To ensure safety of users, the FCC has established criteria for the amount of radio frequency energy that can be safely absorbed by the human body. This equipment complies with the FCC's safety limits. This product has been tested and found to comply with the FCC criteria. The baby unit shall be installed and used such that parts of all persons' bodies are maintained at a distance of approximately 8 in (20 cm) or more. The transmitter and antenna of the parent unit shall be held at least 1 in (2.5 cm) from your neck.

This Class B digital apparatus complies with Canadian requirement: CANICES (3) /NMB-3(B)

Industry Canada

This device complies with the Canadian requirements for the amount of radio frequency energy that can be safely absorbed by the human body. This equipment complies with the FCC's safety limits. This product has been tested and found to comply with the FCC criteria. The baby unit shall be installed and used such that parts of all persons' bodies are maintained at a distance of approximately 8 in (20 cm) or more. The transmitter and antenna of the parent unit shall be held at least 1 in (2.5 cm) from your neck.

Industry Canada

This device complies with the Canadian requirements for the amount of radio frequency energy that can be safely absorbed by the human body. This equipment complies with the FCC's safety limits. This product has been tested and found to comply with the FCC criteria. The baby unit shall be installed and used such that parts of all persons' bodies are maintained at a distance of approximately 8 in (20 cm) or more. The transmitter and antenna of the parent unit shall be held at least 1 in (2.5 cm) from your neck.

Industry Canada

This device complies with the Canadian requirements for the amount of radio frequency energy that can be safely absorbed by the human body. This equipment complies with the FCC's safety limits. This product has been tested and found to comply with the FCC criteria. The baby unit shall be installed and used such that parts of all persons' bodies are maintained at a distance of approximately 8 in (20 cm) or more. The transmitter and antenna of the parent unit shall be held at least 1 in (2.5 cm) from your neck.

Industry Canada

This device complies with the Canadian requirements for the amount of radio frequency energy that can be safely absorbed by the human body. This equipment complies with the FCC's safety limits. This product has been tested and found to comply with the FCC criteria. The baby unit shall be installed and used such that parts of all persons' bodies are maintained at a distance of approximately 8 in (20 cm) or more. The transmitter and antenna of the parent unit shall be held at least 1 in (2.5 cm) from your neck.

Industry Canada

This device complies with the Canadian requirements for the amount of radio frequency energy that can be safely absorbed by the human body. This equipment complies with the FCC's safety limits. This product has been tested and found to comply with the FCC criteria. The baby unit shall be installed and used such that parts of all persons' bodies are maintained at a distance of approximately 8 in (20 cm) or more. The transmitter and antenna of the parent unit shall be held at least 1 in (2.5 cm) from your neck.

Industry Canada

This device complies with the Canadian requirements for the amount of radio frequency energy that can be safely absorbed by the human body. This equipment complies with the FCC's safety limits. This product has been tested and found to comply with the FCC criteria. The baby unit shall be installed and used such that parts of all persons' bodies are maintained at a distance of approximately 8 in (20 cm) or more. The transmitter and antenna of the parent unit shall be held at least 1 in (2.5 cm) from your neck.

Industry Canada

This device complies with the Canadian requirements for the amount of radio frequency energy that can be safely absorbed by the human body. This equipment complies with the FCC's safety limits. This product has been tested and found to comply with the FCC criteria. The baby unit shall be installed and used such that parts of all persons' bodies are maintained at a distance of approximately 8 in (20 cm) or more. The transmitter and antenna of the parent unit shall be held at least 1 in (2.5 cm) from your neck.

Industry Canada

This device complies with the Canadian requirements for the amount of radio frequency energy that can be safely absorbed by the human body. This equipment complies with the FCC's safety limits. This product has been tested and found to comply with the FCC criteria. The baby unit shall be installed and used such that parts of all persons' bodies are maintained at a distance of approximately 8 in (20 cm) or more. The transmitter and antenna of the parent unit shall be held at least 1 in (2.5 cm) from your neck.

Industry Canada

This device complies with the Canadian requirements for the amount of radio frequency energy that can be safely absorbed by the human body. This equipment complies with the FCC's safety limits. This product has been tested and found to comply with the FCC criteria. The baby unit shall be installed and used such that parts of all persons' bodies are maintained at a distance of approximately 8 in (20 cm) or more. The transmitter and antenna of the parent unit shall be held at least 1 in (2.5 cm) from your neck.

Industry Canada

This device complies with the Canadian requirements for the amount of radio frequency energy that can be safely absorbed by the human body. This equipment complies with the FCC's safety limits. This product has been tested and found to comply with the FCC criteria. The baby unit shall be installed and used such that parts of all persons' bodies are maintained at a distance of approximately 8 in (20 cm) or more. The transmitter and antenna of the parent unit shall be held at least 1 in (2.5 cm) from your neck.

Industry Canada

This device complies with the Canadian requirements for the amount of radio frequency energy that can be safely absorbed by the human body. This equipment complies with the FCC's safety limits. This product has been tested and found to comply with the FCC criteria. The baby unit shall be installed and used such that parts of all persons' bodies are maintained at a distance of approximately 8 in (20 cm) or more. The transmitter and antenna of the parent unit shall be held at least 1 in (2.5 cm) from your neck.

Industry Canada

This device complies with the Canadian requirements for the amount of radio frequency energy that can be safely absorbed by the human body. This equipment complies with the FCC's safety limits. This product has been tested and found to comply with the FCC criteria. The baby unit shall be installed and used such that parts of all persons' bodies are maintained at a distance of approximately 8 in (20 cm) or more. The transmitter and antenna of the parent unit shall be held at least 1 in (2.5 cm) from your neck.

Industry Canada

This device complies with the Canadian requirements for the amount of radio frequency energy that can be safely absorbed by the human body. This equipment complies with the FCC's safety limits. This product has been tested and found to comply with the FCC criteria. The baby unit shall be installed and used such that parts of all persons' bodies are maintained at a distance of approximately 8 in (20 cm) or more. The transmitter and antenna of the parent unit shall be held at least 1 in (2.5 cm) from your neck.

FOR CETL COMPLIANCE ONLY

Measures de sécurité importantes

La plaque signalétique appliquée est étiquette de base du socle de l'unité d'alimentation.

Lorsque vous utilisez votre appareil, vous devez toujours suivre certaines mesures de précaution de base afin de réduire les risques d'incendie, d'électrocution ou de blessures corporelles, dont ceux qui sont énumérés ci-dessous.

1. Ne touchez pas les fils dénudés ou les fils dénudés.
2. Ne touchez pas les fils dénudés ou les fils dénudés.
3. Ne touchez pas les fils dénudés ou les fils dénudés.
4. Ne touchez pas les fils dénudés ou les fils dénudés.
5. Ne touchez pas les fils dénudés ou les fils dénudés.
6. Ne touchez pas les fils dénudés ou les fils dénudés.
7. Ne touchez pas les fils dénudés ou les fils dénudés.
8. Ne touchez pas les fils dénudés ou les fils dénudés.
9. Ne touchez pas les fils dénudés ou les fils dénudés.
10. Ne touchez pas les fils dénudés ou les fils dénudés.
11. Ne touchez pas les fils dénudés ou les fils dénudés.
12. Ne touchez pas les fils dénudés ou les fils dénudés.
13. Ne touchez pas les fils dénudés ou les fils dénudés.
14. Ne touchez pas les fils dénudés ou les fils dénudés.
15. Ne touchez pas les fils dénudés ou les fils dénudés.
16. Ne touchez pas les fils dénudés ou les fils dénudés.
17. Ne touchez pas les fils dénudés ou les fils dénudés.
18. Ne touchez pas les fils dénudés ou les fils dénudés.
19. Ne touchez pas les fils dénudés ou les fils dénudés.
20. Ne touchez pas les fils dénudés ou les fils dénudés.
21. Ne touchez pas les fils dénudés ou les fils dénudés.
22. Ne touchez pas les fils dénudés ou les fils dénudés.
23. Ne touchez pas les fils dénudés ou les fils dénudés.
24. Ne touchez pas les fils dénudés ou les fils dénudés.
25. Ne touchez pas les fils dénudés ou les fils dénudés.
26. Ne touchez pas les fils dénudés ou les fils dénudés.
27. Ne touchez pas les fils dénudés ou les fils dénudés.
28. Ne touchez pas les fils dénudés ou les fils dénudés.
29. Ne touchez pas les fils dénudés ou les fils dénudés.
30. Ne touchez pas les fils dénudés ou les fils dénudés.
31. Ne touchez pas les fils dénudés ou les fils dénudés.
32. Ne touchez pas les fils dénudés ou les fils dénudés.
33. Ne touchez pas les fils dénudés ou les fils dénudés.
34. Ne touchez pas les fils dénudés ou les fils dénudés.
35. Ne touchez pas les fils dénudés ou les fils dénudés.
36. Ne touchez pas les fils dénudés ou les fils dénudés.
37. Ne touchez pas les fils dénudés ou les fils dénudés.
38. Ne touchez pas les fils dénudés ou les fils dénudés.
39. Ne touchez pas les fils dénudés ou les fils dénudés.
40. Ne touchez pas les fils dénudés ou les fils dénudés.
41. Ne touchez pas les fils dénudés ou les fils dénudés.
42. Ne touchez pas les fils dénudés ou les fils dénudés.
43. Ne touchez pas les fils dénudés ou les fils dénudés.
44. Ne touchez pas les fils dénudés ou les fils dénudés.
45. Ne touchez pas les fils dénudés ou les fils dénudés.
46. Ne touchez pas les fils dénudés ou les fils dénudés.
47. Ne touchez pas les fils dénudés ou les fils dénudés.
48. Ne touchez pas les fils dénudés ou les fils dénudés.
49. Ne touchez pas les fils dénudés ou les fils dénudés.
50. Ne touchez pas les fils dénudés ou les fils dénudés.
51. Ne touchez pas les fils dénudés ou les fils dénudés.
52. Ne touchez pas les fils dénudés ou les fils dénudés.
53. Ne touchez pas les fils dénudés ou les fils dénudés.
54. Ne touchez pas les fils dénudés ou les fils dénudés.
55. Ne touchez pas les fils dénudés ou les fils dénudés.
56. Ne touchez pas les fils dénudés ou les fils dénudés.
57. Ne touchez pas les fils dénudés ou les fils dénudés.
58. Ne touchez pas les fils dénudés ou les fils dénudés.
59. Ne touchez pas les fils dénudés ou les fils dénudés.
60. Ne touchez pas les fils dénudés ou les fils dénudés.
61. Ne touchez pas les fils dénudés ou les fils dénudés.
62. Ne touchez pas les fils dénudés ou les fils dénudés.
63. Ne touchez pas les fils dénudés ou les fils dénudés.
64. Ne touchez pas les fils dénudés ou les fils dénudés.
65. Ne touchez pas les fils dénudés ou les fils dénudés.
66. Ne touchez pas les fils dénudés ou les fils dénudés.
67. Ne touchez pas les fils dénudés ou les fils dénudés.
68. Ne touchez pas les fils dénudés ou les fils dénudés.
69. Ne touchez pas les fils dénudés ou les fils dénudés.
70. Ne touchez pas les fils dénudés ou les fils dénudés.
71. Ne touchez pas les fils dénudés ou les fils dénudés.
72. Ne touchez pas les fils dénudés ou les fils dénudés.
73. Ne touchez pas les fils dénudés ou les fils dénudés.
74. Ne touchez pas les fils dénudés ou les fils dénudés.
75. Ne touchez pas les fils dénudés ou les fils dénudés.
76. Ne touchez pas les fils dénudés ou les fils dénudés.
77. Ne touchez pas les fils dénudés ou les fils dénudés.
78. Ne touchez pas les fils dénudés ou les fils dénudés.
79. Ne touchez pas les fils dénudés ou les fils dénudés.
80. Ne touchez pas les fils dénudés ou les fils dénudés.
81. Ne touchez pas les fils dénudés ou les fils dénudés.
82. Ne touchez pas les fils dénudés ou les fils dénudés.
83. Ne touchez pas les fils dénudés ou les fils dénudés.
84. Ne touchez pas les fils dénudés ou les fils dénudés.
85. Ne touchez pas les fils dénudés ou les fils dénudés.
86. Ne touchez pas les fils dénudés ou les fils dénudés.
87. Ne touchez pas les fils dénudés ou les fils dénudés.
88. Ne touchez pas les fils dénudés ou les fils dénudés.
89. Ne touchez pas les fils dénudés ou les fils dénudés.
90. Ne touchez pas les fils dénudés ou les fils dénudés.
91. Ne touchez pas les fils dénudés ou les fils dénudés.
92. Ne touchez pas les fils dénudés ou les fils dénudés.
93. Ne touchez pas les fils dénudés ou les fils dénudés.
94. Ne touchez pas les fils dénudés ou les fils dénudés.
95. Ne touchez pas les fils dénudés ou les fils dénudés.
96. Ne touchez pas les fils dénudés ou les fils dénudés.
97. Ne touchez pas les fils dénudés ou les fils dénudés.
98. Ne touchez pas les fils dénudés ou les fils dénudés.
99. Ne touchez pas les fils dénudés ou les fils dénudés.
100. Ne touchez pas les fils dénudés ou les fils dénudés.

CONSERVEZ CES INSTRUCTIONS

Mise en garde

Ne touchez pas les fils dénudés ou les fils dénudés.

Mise en garde

Ne touchez pas les fils dénudés ou les fils dénudés.

Mise en garde

Ne touchez pas les fils dénudés ou les fils dénudés.

Mise en garde

Ne touchez pas les fils dénudés ou les fils dénudés.

Mise en garde

Ne touchez pas les fils dénudés ou les fils dénudés.

Mise en garde

Ne touchez pas les fils dénudés ou les fils dénudés.

Mise en garde

Ne touchez pas les fils dénudés ou les fils dénudés.

Mise en garde

Ne touchez pas les fils dénudés ou les fils dénudés.

Mise en garde

Ne touchez pas les fils dénudés ou les fils dénudés.

Mise en garde

Ne touchez pas les fils dénudés ou les fils dénudés.

Mise en garde

Ne touchez pas les fils dénudés ou les fils dénudés.

Mise en garde

Ne touchez pas les fils dénudés ou les fils dénudés.

Mise en garde

Ne touchez pas les fils dénudés ou les fils dénudés.

Mise en garde

Ne touchez pas les fils dénudés ou les fils dénudés.

Mise en garde

Ne touchez pas les fils dénudés ou les fils dénudés.

LIMITED WARRANTY

What does this limited warranty cover?

The manufacturer of this Vtech Product warrants to the holder of a valid proof of purchase "Consumer" or "you" that the Product and all accessories provided in the sales package ("Product") are free from defects in material and workmanship, pursuant to the following terms and conditions, when installed and used normally and in accordance with the Product operating instructions. This limited warranty extends only to the Consumer for Products purchased and used in the United States of America and Canada.

What will Vtech do if the Product is not free from defects in materials and workmanship during the limited warranty period ("Materially Defective Product")?

During the limited warranty period, Vtech's authorized service representative will repair or replace a Vtech's option, without charge, a Materially Defective Product. If we repair the Product, we may use new or refurbished replacement parts. If we choose to replace the Product, we may replace it with a new or refurbished Product of the same or similar design. We will retain defective parts, modules, or equipment. Repair, or replacement of the Product, at Vtech's option, is your exclusive remedy. Vtech will return the repaired or replacement Product to you by working condition. You should expect the repair or replacement to take approximately 30 days.

How long is the limited warranty period?

The limited warranty period for the Product extends for ONE (1) YEAR from the date of purchase. If Vtech repairs or replaces a Materially Defective Product during the term of this limited warranty, this limited warranty also applies to the repaired or replacement Product for a period of 90 days from the date the repaired or replacement Product is shipped to you or 30 days from the date of purchase on the original one-year warranty, whichever is longer.

What is not covered by this limited warranty?

This limited warranty does not cover:

1. Product that has been subjected to misuse, accident, shipping or other physical damage, improper installation, or modification by anyone other than an authorized service representative of Vtech; or
2. Product that has been damaged due to repair, alteration or modification by anyone other than an authorized service representative of Vtech; or
3. Product whose warranty/quality stickers, product serial number plates or electronic serial numbers have been removed, altered or rendered illegible; or
4. Product to the extent that the problem is caused by use with non-Vtech accessories; or
5. Product whose warranty/quality stickers, product serial number plates or electronic serial numbers have been removed, altered or rendered illegible; or
6. Product purchased, used, serviced, or shipped for repair from outside the United States of America or Canada; or
7. Product used for commercial or institutional purposes (including but not limited to Products used for rental purposes); or
8. Products returned without valid proof of purchase (shown item 2 below); or
9. Charges for installation or set up, adjustment of customer controls, and installation or repair of systems outside the unit.

Champs électromagnétiques (EMF)

Le produit de Vtech est conforme à toutes les normes se rapportant aux champs électromagnétiques (EMF) dans le monde. Si vous le souhaitez, consultez les instructions de base du produit, qui fournissent des informations sur les niveaux de champ électromagnétique et les mesures de réduction des risques.

Champs électromagnétiques (EMF)

Le produit de Vtech est conforme à toutes les normes se rapportant aux champs électromagnétiques (EMF) dans le monde. Si vous le souhaitez, consultez les instructions de base du produit, qui fournissent des informations sur les niveaux de champ électromagnétique et les mesures de réduction des risques.

Champs électromagnétiques (EMF)

Le produit de Vtech est conforme à toutes les normes se rapportant aux champs électromagnétiques (EMF) dans le monde. Si vous le souhaitez, consultez les instructions de base du produit, qui fournissent des informations sur les niveaux de champ électromagnétique et les mesures de réduction des risques.

Champs électromagnétiques (EMF)

Le produit de Vtech est conforme à toutes les normes se rapportant aux champs électromagnétiques (EMF) dans le monde. Si vous le souhaitez, consultez les instructions de base du produit, qui fournissent des informations sur les niveaux de champ électromagnétique et les mesures de réduction des risques.

Champs électromagnétiques (EMF)

Le produit de Vtech est conforme à toutes les normes se rapportant aux champs électromagnétiques (EMF) dans le monde. Si vous le souhaitez, consultez les instructions de base du produit, qui fournissent des informations sur les niveaux de champ électromagnétique et les mesures de réduction des risques.

Champs électromagnétiques (EMF)

Le produit de Vtech est conforme à toutes les normes se rapportant aux champs électromagnétiques (EMF) dans le monde. Si vous le souhaitez, consultez les instructions de base du produit, qui fournissent des informations sur les niveaux de champ électromagnétique et les mesures de réduction des risques.

Champs électromagnétiques (EMF)

Le produit de Vtech est conforme à toutes les normes se rapportant aux champs électromagnétiques (EMF) dans le monde. Si vous le souhaitez, consultez les instructions de base du produit, qui fournissent des informations sur les niveaux de champ électromagnétique et les mesures de réduction des risques.

How do you get warranty service?