

UMTS Outdoor iBTS FCC Label

P0989533 or P0606561 labels
(EC or FCC marking)

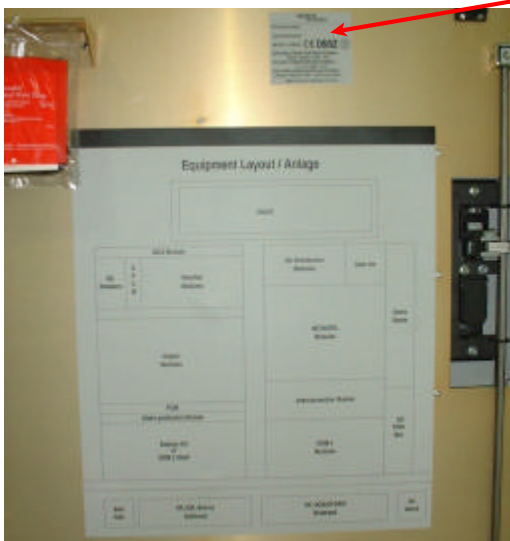

NOTES:

1. UNLESS OTHERWISE SPECIFIED, ALL DIMENSIONS ARE EXPRESSED IN MILLIMETERS. TOLERANCES SHALL BE:
1 DECIMAL PLACE = ± 0.5
2 DECIMAL PLACES = ± 0.25
3 DECIMAL PLACES = ± 0.125
ALL LABEL CORNERS SHALL HAVE A 0.75 RADIUS.
2. TO CONVERT MILLIMETERS TO INCHES:
25.40 MILLIMETERS = 1 INCH.
3. THIS DESIGN FILE WAS CREATED IN ACCORDANCE WITH NT STD 1517.20. LABEL/ARTWORKS MUST BE MANUFACTURED IN ACCORDANCE WITH NPS90942.
4. THE ARTWORK SHALL BE PLOTTED AT A MINIMUM OF 1200 DPI. THE TEXT FONT(S) SHALL BE: UNIVERS 67 CONDENSED BOLD PER NPS90942. TEXT ABOVE AND BELOW UL OR CSA SYMBOLS SHALL BE UNIVERS 57 CONDENSED PER NPS90942.
5. MATERIAL: 0.25 CLEAR POLYCARBONATE PER R0115902
FINISH: VELVET/MATTE
ADHESIVE: 0.05 PRESSURE SENSITIVE WITH PEEL OFF LINER PER R0113138
6. COLOURS SHALL CONFORM TO NORTHERN TELECOM OBSERVATIONAL STANDARD 2701.01.
BACKGROUND: BTS LIGHT GREY PER NORTHERN TELECOM STANDARD S-33470
TEXT AND GRAPHICS: NORTEL DARK GRAY PER NORTHERN TELECOM STANDARD S-33310
BACKGROUND AT TOP OF LABEL: NORTEL LIGHT GRAY PER NORTHERN TELECOM STANDARD S-33310
7. LABEL TO BE REVERSE SCREEN PRINTED PER NPS90942-2.

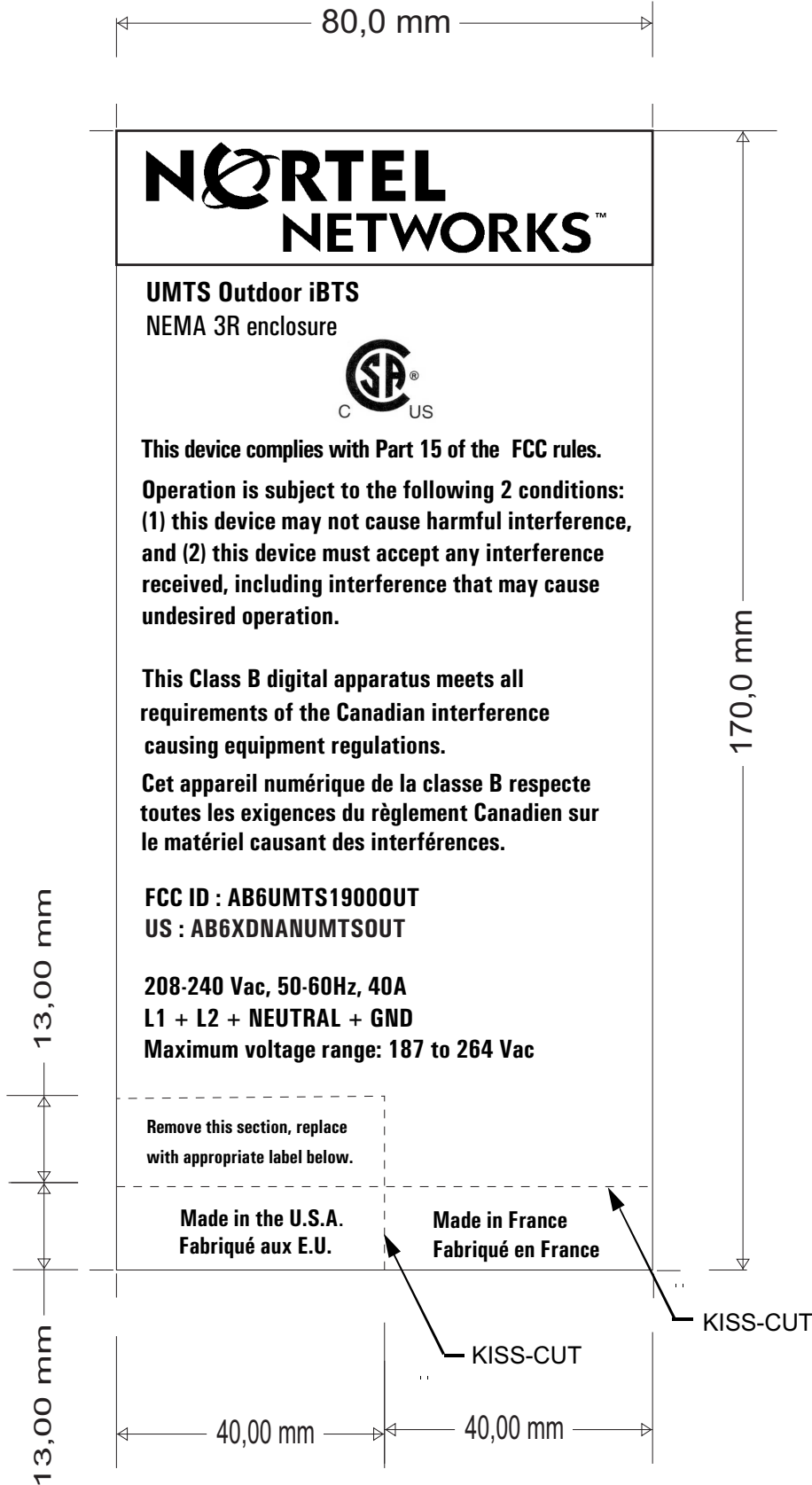

EC: 103-11908
04-07-2003

DRAWN	APPD	STREAM	ISSUE
XG	LC	01	01

PROPRIETARY INFORMATION:
THE INFORMATION CONTAINED IN THIS DOCUMENT IS THE PROPERTY OF NORTEL NETWORKS LIMITED. EXCEPT AS SPECIFICALLY AUTHORIZED IN WRITING BY NORTEL NETWORKS LIMITED, THE HOLDER OF THIS DOCUMENT: (1) SHALL KEEP ALL INFORMATION CONTAINED HEREIN CONFIDENTIAL AND SHALL PROTECT SAME IN WHOLE OR IN PART FROM DISCLOSURE AND DISSEMINATION TO ALL THIRD PARTIES AND (2) SHALL USE SAME FOR OPERATING AND MAINTENANCE PURPOSES ONLY.

INITIAL APPLICATION

TITLE

CSA/FCC MARK Regulatory Label
iBTS Outdoor

DRAWING NUMBER

P0606561

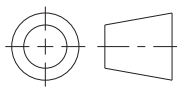

SCALE

1:1

NORTEL
NETWORKS

SIZE

C

SHEET

1 OF 1