

# peripage

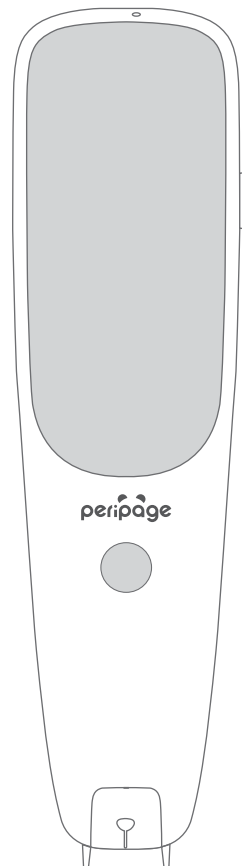

爱立熊全科学学习笔说明书  
PeriPage Translation Pen

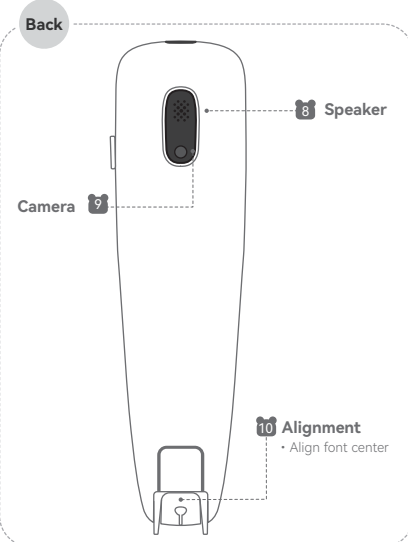
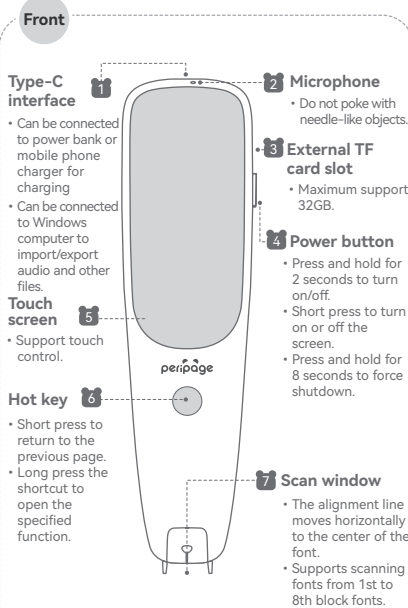

## Connect to WiFi (only 2.4G WiFi is supported)

### 1 Open [Wi-Fi] settings

- Method 1: Open the translation pen, slide down the screen to open the [Control Center].

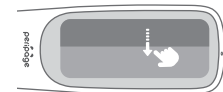

Long press [WLAN] to open the network settings.



- Method 2: Click to open the [Settings] on the home page.



Click [WLAN] to open the network settings.



### 2 Turn on WiFi first in the WLAN settings.



### 3 Select the WiFi that can connect to the Internet.



### 4 Enter the WiFi password correctly and click [✓].



## Use to Scan



- Hold the translation pen according to the picture.

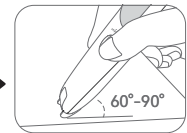

- Press the pen head obliquely on the paper surface until the light is on.

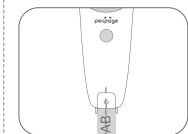

- Align the alignment line to the center of the font.

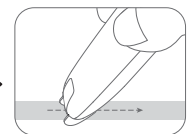

- Swipe to the right at a constant speed to scan. The recommended sliding speed is 5mm/s.

## Wireless Printing

This product is sold without a printer. If you want to use it for printing, please purchase a mini printer from the [PeriPage] brand first.

- Open the translation pen, slide down the screen to open [Control Center], and click [Bluetooth] to open it.



- Click the printer icon of the translation pen function module, and connect the printer according to the prompts to print.

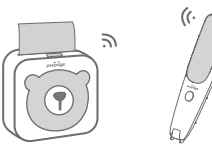

(Note: Do not search for Bluetooth connection to the printer in the Bluetooth settings)

## App Sync

- Search and download the [PeriPage] App in the mobile app store.
- Open the App, and follow the prompts in the App to enable the function of scanning the code bound to the translation pen.
- Open the translation pen [App synchronization], and follow the prompts to scan the code in the app to bind the translation pen.

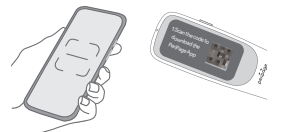

## App Download

Search for "PeriPage" in Googleplay/Apple and other app stores or scan the QR code on the right to download.



## TF Card Installation

This product is sold without TF card

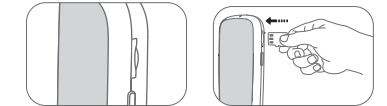

- Make sure that the card slot is not blocked by foreign objects.
- Put the gold finger of the TF card facing up and insert it into the card slot.

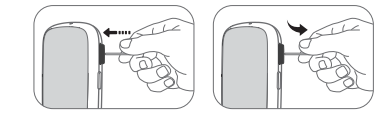

- Use a thin object to poke the TF card into the card slot for 3mm, and it will be automatically stuck.
- Take out the TF card, just press the card again, it will be automatically unlocked and ejected.

Note: Do not delete the files that come with the TF card, to avoid the TF card work abnormally.

## Charging Instructions

- 5V = 1A input charging, it is recommended to use a mobile phone charger for charging.
- It is recommended that when using it for the first time after purchase, please fully charge it first.

If it is not used for a long time, please charge it once every 3 months, so as to avoid the natural wear and tear of the lithium battery for a long time and cannot be charged.

## FAQ

### Q1 What should I do if the device cannot search for a nearby WiFi network?

- Make sure the device WiFi is turned on.
- Confirm that the nearby wireless is 2.4G WiFi signal (the device does not support 5G WiFi signal).

### Q2 What should I do if the scanning error rate is relatively high?

- Make sure the scanned content is flat and clearly visible.
- Make sure that the alignment line of the translation pen scanning window is aligned with the center of the font, and the word cannot exceed the scanning window.

### Q3 What should I do if the screen cannot be touched?

- Please press and hold the power button for 8 seconds to reset and restart the device.

### Q4 What should I do if the translation pen cannot be connected to the printer?

- Make sure the translation pen Bluetooth is turned on.
- Make sure that the printer is not connected by other Bluetooth devices.
- Please turn off the printer and then turn it on again, and try to search for the connection in the App again.

### Q5 Can the translation pen be connected to a Bluetooth headset?

- Yes. Please open [Bluetooth] in [Settings] to search for a Bluetooth headset and connect it.

### Q6 Can the translation pen be connected to a computer to import/export audio and other files?

- Yes, connect the translation pen to the computer through the original USB cable, and copy the audio files to the corresponding folder of the translation pen storage disk. You can also insert the TF card and copy the files to the corresponding folder of the TF card.

- Apple computer connection is not supported.
- Do not delete the files that come with the system, to avoid the translation pen work abnormally.

### Q7 After the translation pen is connected to the computer via USB, what should I do if the folder cannot be found on [My Computer]?

- Right-click [My Computer] -> select [Manage] -> select [Device Manager] -> select [Convenient Devices] or [Other Devices] -> right-click [MTP] to open [Update Driver] -> select [Browse Me] Find the driver on your computer -> select [Let me pick from a list of available drivers on my computer] -> select [MTP USB device] and click [Next] to install successfully.



视频教程 / Video Guide



厦门爱立得科技有限公司  
Xiamen iLead Tek Co., Ltd.

厦门市软件园三期诚毅北大街50号2101单元01室  
Room 01, Unit 2101, No.50 Chengyi North Street,  
Software Park Phase III, Xiamen, Fujian, China

www.ileadtek.com service@ileadtek.com 400-8550-520

**FCC Statement**

This device complies with part 15 of the FCC rules. Operation is subject to the following two conditions: (1) this device may not cause harmful interference, and (2) this device must accept any interference received, including interference that may cause undesired operation.

Changes or modifications not expressly approved by the party responsible for compliance could void the user's authority to operate the equipment.

NOTE: This equipment has been tested and found to comply with the limits for a Class B digital device, pursuant to part 15 of the FCC Rules. These limits are designed to provide reasonable protection against harmful interference in a residential installation. This equipment generates uses and can radiate radio frequency energy and, if not installed and used in accordance with the instructions, may cause harmful interference to radio communications. However, there is no guarantee that interference will not occur in a particular installation. If this equipment does cause harmful interference to radio or television reception, which can be determined by turning the equipment off and on, the user is encouraged to try to correct the interference by one or more of the following measures:

- Reorient or relocate the receiving antenna.
- Increase the separation between the equipment and receiver.
- Connect the equipment into an outlet on a circuit different from that to which the receiver is connected.
- Consult the dealer or an experienced radio/TV technician for help.

The device has been evaluated to meet general RF exposure requirement. The device can be used in portable exposure condition without restriction.