



Rechargeable Bluetooth Keyboard Case

User Manual

MODEL: PaulB-BTKB-L1168

INTRODUCTION

The Paul B rechargeable wireless Bluetooth keyboard case,can make you easy to work anytime and anywhere. Equipped with stable spiale support and multi-angle adjustment, make your ipad into an efficient laptop.

FEATURES

- Reliable Shell Protection
- Multi-touch Trackpad
- Universal pen holder
- Professional strong shaft support
- Portable handbag design
- 800 mAh super-large battery can keep using for 140 days
- Ergonomic thin-film keyboard
- Anti-overflow keyboard
- Special multimedia keys

COMPATIBILITY

- iPad 10.9 " (10th Gen, 2022)
- iPad 11 " (11th Gen, 2025)

SPECIFICATIONS

Bluetooth version: 5.1

Power Input: 5VDC

Power Connection:USB-C

Charge time:≈2.5 hour

Battery Capacity:3.7VDC, 250mAh

PAUKAGE UONTENTS

- Bluetooth Bluetooth Keyboard
- USB-C charge cable
- User's Manual

CASE INSTALLATION

- 1.Place your case on a flat surface.
- 2.Align your device's camera with the camera opening on the case.
- 3.Insert your device at an angle starting at the top (camera side).

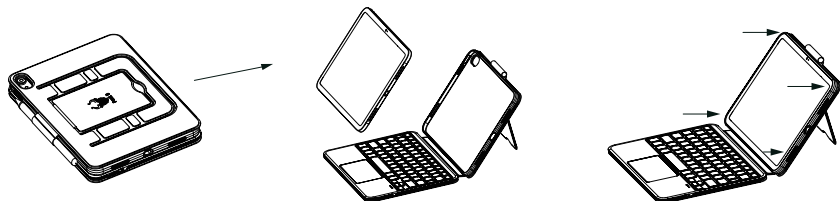

- 4.Let your device rest on the bottom of the case and gently press it down into the case.
- 5.Press around all the edges to ensure your device is installed properly in the case.
- 6.Unfold the keyboard cover and place it flat on flat surface.

CASE STORAGE

Step 1

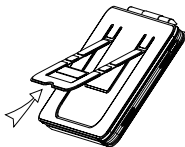

Step 2

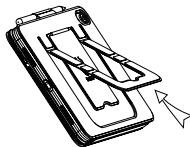

Step 3



Step 4



INDICATOR INSTRUCTION

| Keyboard indicator | Indicator Color | Indicator Color |
|------------------------------|-----------------|--|
| Power on bluetooth indicator | White | The indicator keeps on for 5 seconds and off after that. |
| Paring, bluetooth indicator | White | The indicator keeps flasing and will be off when the connection is done. |
| Charging Indicator | White | Charging status, red light keeps on and offwhen the battery is full charged. |
| Capslock Indicator | Red | Press Capslock to switch to upper letterstatus and the light keeps on. |

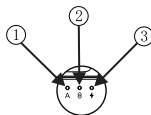

POWERING YOUR KEYBOARD

Ensure your keyboard has been charged using the included USB-C charging cable and a compatible USB-C 5V charger (not included). You can also charge your keyboard from a compatible USB-C port on a computing device.

TO POWER ON:

Turn on the keyboard, status indicator blinking 5s then off.

TO POWER OFF:

Turn off the keyboard, keyboard has been powered off.

STANDBY MODE:

Your keyboard will go into Standby mode after 40 seconds of inactivity. Press any key to wake it.

PAIRING YOUR KEYBOARD

1. Ensure your device's Bluetooth connection is enabled.
2. Press and hold the Fn+C for 3 seconds. Release the key after the LED on the Power key begins flashing rapidly. Your keyboard is now in pairing mode.
3. Go to your device Bluetooth settings and search for "Paul B Keyboard".
4. Select the appropriate keyboard on your Bluetooth device list.
5. Your Keyboard should now be paired and connected with your device.
6. Repeat the steps if the pairing process fails.

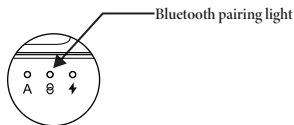

TRACKPAD

The Trackpad supports most common Multi-Touch gestures including:

- Swipe
- Tap
- Pinch
- Scroll

Function keys

- Homepage: Displays the main screen of the device .
- LOCK: Activate the lock screen mode of the device .
- ☰ Recent tasks: Display the recent task view window of the device .
- 🔍 Search: Open the device's global search function .
- ⌨ Input method switch: Switch between keyboard languages. (The device must be in active mode)
- 🎤 Microphone: Activate Siri .
- ⏮ Previous track: Jump to the previous track in the selected playlist .
- ⏸ Pause/Play: Start or pause the current playlist .
- ⏭ Next song: Jump to the next track in the selected playlist .
- 🔇 Mute: Mutes the audio of the device .
- 🔊 Decrease volume: Decrease the volume of the device .
- 🔊 Increase volume: Increase the volume of the device .
- 📶 Bluetooth: Pair and connect with your device via Bluetooth .
- ☀ Brightness reduction : Decrease the screen brightness .
- ☀ Brightness increase: Increase the screen brightness .

Warranty service

-This product has a one-year warranty. Within this time frame, repair requests can be submitted. Please refer to the manufacturer's service for specific details.

Not within the scope of after-sales service.

1. If the product is opened beyond the specified time and there are no quality issues, it is not eligible for return or exchange.
2. Failure to follow the product's instructions for use, maintenance, and storage resulting in product malfunction or damage.
3. Damages caused by unauthorized repair institutions. (Self-disassembly, repair, modification of products, etc.)
4. If it is deemed damaged, it will not be eligible for warranty service. (such as operational errors, collisions, water damage, incompatible voltage input, etc.)
5. Beyond the warranty period of the product .

Friendly reminder

1. If you need to use the keyboard frequently or do not close the keyboard when it is not needed, please do not fold or press the keyboard, as this may cause keyboard misoperation and consume keyboard power, affecting your next operation.
2. When the keyboard is not in use, it will enter sleep mode after 20 minutes and can be awakened by pressing any key .

Notice

1. Stay away from sharp objects and open flames.
2. Do not use heavy objects to press the keyboard for a long time.
3. Do not put the keyboard in the microwave.
4. The keyboard contains a lithium battery, please do not dispose of the keyboard directly.
5. The keyboard is suitable for working in an environment with a temperature of -10°C to 45°C. Please do not use the keyboard in high or low temperature environments .

6. Keep away from oil or other organic solvents.
7. Please do not use the keyboard in a damp environment for a long time.
8. It is not recommended to use a keyboard on aerospace facilities or other signal interference facilities。

Compliance statement

This product complies with the following certification standards。



NOTE: This equipment has been tested and found to comply with the limits for a Class B digital device, pursuant to part 15 of the FCC Rules. These limits are

designed to provide reasonable protection against harmful interference in a residential installation. This equipment generates, uses and can radiate radio

frequency energy and, if not installed and used in accordance with the instructions, may cause harmful interference to radio communications.

However, there is no guarantee that interference will not occur in a particular installation. If this equipment does cause harmful interference to radio or television reception, which can be determined by turning the equipment off and on, the user is encouraged to try to correct the interference by one or more of the following measures :

- Reorient or relocate the receiving antenna.
- Increase the separation between the equipment and receiver.
- Connect the equipment into an outlet on a circuit different from that to which the receiver is connected.
- Consult the dealer or an experienced radio/TV technician for help

Changes or modifications not expressly approved by the party responsible for compliance could void the user's authority to operate the equipment

This device complies with Part 15 of the FCC Rules. Operation is subject to the following two conditions:

- (1) this device may not cause harmful interference, and (2) this device must accept any interference received, including interference that may cause undesired operation