

SONOFF

RM433

User manual V1.0

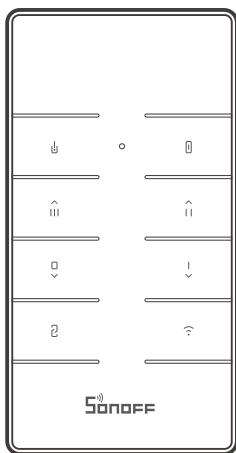

433MHz remote controller

· 中文----- 1-3

· English----- 4-6

· FCC Warning----- 7



Install batteries

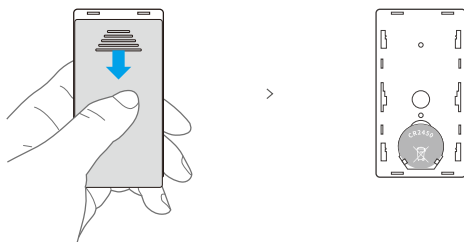

⚠ The battery is not included, please purchase it separately.

Specifications

Model	RM433R2
RF	433MHz
Remote controller size	87x45x12mm
Remote controller Base size	86x86x15mm(not included)
Power supply	3V button cell x 1 (Battery model: CR2450)
Material	PC V0

Product Introduction



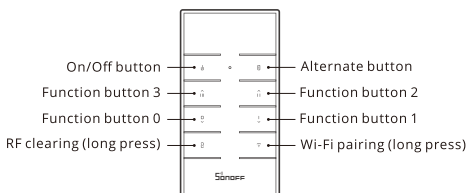





The device applies to all SONOFF products with 433MHz frequency and other devices supporting the 433MHz communication protocol.











⚠ Buttons are created with different functions when pairing with different products.

Buttons Instructions

Example 1: iFan03 Wi-Fi Fan & Light Controller

Buttons	Functions
	On/Off (light)
	Mute
	Off (fan)
	Low speed
	Medium speed
	High speed
	Long press for 5s until the ceiling fan makes two sounds "di di" to clear the code successfully. After clearing code is complete, if you need to use the product, please press any button within 5s after powering on again until the ceiling fan makes a sound "di", and pairing is successful.
	Long press for 5s until the fan makes two short and one long "bi" sound to enter the quick pairing mode (Touch),. Then you can add the light on eWeLink APP. In quick pairing mode, you can short press any button on the remote controller to exit this mode.

Example 2: D1 Wi-Fi smart dimmer

Buttons	Functions
	On
	Off
	Short press for the low brightness, long press to turn down the brightness
	Short press for the medium brightness, long press to turn down the brightness
	Short press for the higher brightness, long press to turn up the brightness
	Short press for the high brightness, long press to turn down the brightness
	Long press for 5s until you hear "Bi Bi" and release, then the remote controller is cleared successfully. If you need to use, short press any button within 5s after powering on again and you will hear "Bi", which indicates the remote controller is paired successfully.
	Long press for 5s until the connected light enters the breathing mode, which indicates the device enters quick pairing mode (Touch), then you can add the light on eWeLink APP. In quick pairing mode, you can short press any button on the remote controller to exit this mode.

Works with SONOFF devices

- RFR2
- RFR3
- 4CHPROR3
- SlampherR2
- D1 Wi-Fi smart dimmer
- TX series Wi-Fi smart switches
- iFan03 Wi-Fi Fan & Light Controller

⚠ Other devices supporting the 433MHz communication protocol

RM433R2-BASE

Installation methods 1:

Install the base on the wall with 3M adhesive tapes.

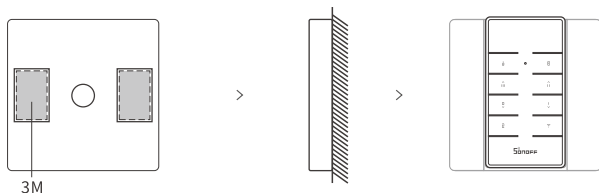

Installation methods 2:

Remove the two upper covers from both sides of the base to install with screws.

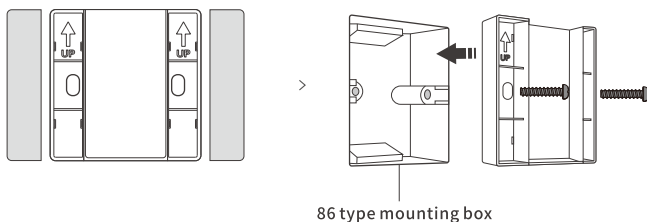

⚠ The base is not included into the package, please purchase it separately.

FCC Warning

Changes or modifications not expressly approved by the party responsible for compliance could avoid the user's authority to operate the equipment.

This device complies with part 15 of the FCC Rules. Operation is subject to the following two conditions: (1) This device may not cause harmful interference, and (2) this device must accept any interference received, including interference that may cause undesired operation.

FCC Radiation Exposure Statement:

The device has been evaluated to meet general RF exposure requirement. The device can be used in portable exposure condition without restriction.

Note:

This equipment has been tested and found to comply with the limits for a Class B digital device, pursuant to part 15 of the FCC Rules. These limits are designed to provide reasonable protection against harmful interference in a residential installation. This equipment generates, uses and can radiate radio frequency energy and, if not installed and used in accordance with the instructions, may cause harmful interference to radio communications. However, there is no guarantee that interference will not occur in a particular installation. If this equipment does cause harmful interference to radio or television reception, which can be determined by turning the equipment off and on, the user is encouraged to try to correct the interference by one or more of the following measures:

- Reorient or relocate the receiving antenna.
- Increase the separation between the equipment and receiver.
- Connect the equipment into an outlet on a circuit different from that to which the receiver is connected.
- Consult the dealer or an experienced radio/TV technician for help.

Hereby, Shenzhen Sonoff Technologies Co., Ltd. declares that the radio equipment type RM433R2 is in compliance with Directive 2014/53/EU. The full text of the EU declaration of conformity is available at the following internet address:

<https://sonoff.tech/usermanuals>



Shenzhen Sonoff Technologies Co., Ltd.

1001, BLDG8, Lianhua Industrial Park, shenzhen, GD, China
ZIP code: 518000 Website: sonoff.tech

MADE IN CHINA

