

QUICK GUIDE

Outdoor Smart Wi-Fi Camera

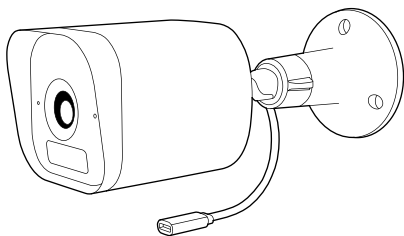

Email: support@arenti.com

Phone: 1-866-999-7868, Mon-Fri 9AM-5PM (PT)

Toll free for USA&Canada, subject to charges for other regions

Phone Service Language only available in English



Quick start guide

1. Packing list
2. Product description
3. Installation
4. Product configuration
5. Specifications
6. Legal notice

1. Packing list

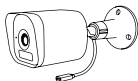

Camera X1



Screw package X1



Power adapter X1



Power cable X1



Silicone cover X1
(for power cable)



Quick guide X1

2. Product description

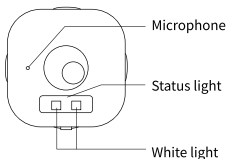
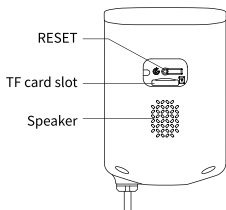

Status light	Description
Flashing red light (slow)	Wait for network configuration
Flashing red light (fast)	Connecting the network
Fixed red light	Network is malfunctional
Fixed blue light	Camera is working correctly

Note: To reset the device, press and hold the reset button for 5 seconds.
The camera beeps when the operation is complete.

3. Installation

1. Find a position where the field of view meets your need.

Consider the below factors:

- Avoid direct sunlight.
- Keep it in range of your router Wi-Fi.
- Avoid the front of the lens facing the plant or porch light;
Avoid facing a busy road.

2. Use screws and bracket to install the camera.
3. (Optional) You can loosen the screw to adjust the angle horizontally or vertically by manual. After adjusting, please tighten the screw.

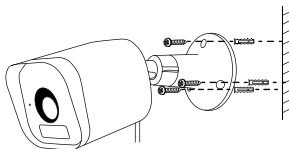

4. Product configuration

Scan QR code to download and install the Arenti App. Or you can search "Arenti" on App Store (iOS) or Google Play (Android).



Registration

Open the App. If you are a new user, tap to create a new account and follow the prompts to complete account setup.

Note: Before creating a new account, please read the Privacy Policy and Terms of Use carefully.



Powering on the device

Power on the camera. Status light flashing red indicates that the camera is ready for pairing.

Pairing method 1: pairing via QR code on device

Open App home page, click "+" >> "Scan Code", then scan the QR code pasted on the device casing with the App of your phone, and add the camera to the App.

Note: When pairing, please put the camera and phone close to the router. If camera is not in the red slow blinking after 30 seconds of powering on, press and hold the reset button for 5 seconds to reset, and then restart to pair the camera with the App.

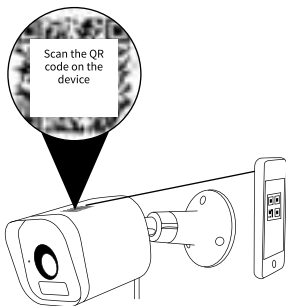
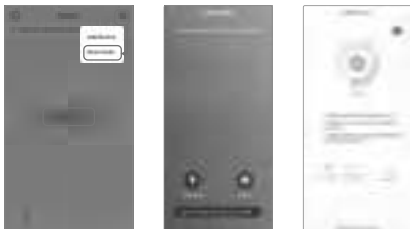

Pairing method 2: pairing via bluetooth

Turn on your phone's bluetooth.

Open App home page, click "+" >> "Add Device" or "Add",

the device will be searched for by bluetooth and appears on the page. Click the device and follow the notes to pair the camera with App.



If no device is found and the pairing process is not successful, please check below instructions:

- **Make sure the camera is in pairing mode.**
- Ensure that the Wi-Fi network is set to 2.4GHz.
- Verify that the entered Wi-Fi password is correct and that the mobile device is connected to the same Wi-Fi network.
- Check for network activity on your Wi-Fi.

If none of the solutions works or you have any other problems, please call **1-866-999-7868** (Mon-Fri 9AM-5PM (PT), toll free for USA&Canada, subject to charges for other regions, Phone Service Language only available in English) or contact **support@arenti.com** to get help.

Note: If you have multiple cameras, please follow steps again to add devices one by one. To change Wi-Fi network, please restore the camera to factory settings and follow steps to add the camera.

5. Specifications

Product name	O3
Resolution	2560 x 1440
Angle of view	100°
IR Distance	Up to 10m
Working temp	-20°C to 50°C
Local storage	TF card (up to 256GB)
Power input	DC 5V / 1A
Consumption	Up to 2.5W
Supported phone OS	iOS 9/Android 5.0 or later
2.4GHz Wi-Fi	2412-2462MHz (Max. power < 30dBm)
Bluetooth	2400-2483.5MHz (Max. power < 20dBm)

6. Legal notice

Support www.arenti.com

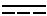
Symbols  Direct current (DC)



Don't throw batteries or out of order products with the household waste (garbage). The dangerous substances that they are likely to include may harm health or the environment. Make your retailer take back the products or use selective collect of garbage proposed by your city.



Hereby, we declare that the radio equipment type 'O3' is in compliance with the Directive 2014/53/EU. The full test of the EU declaration of conformity is available at the following Internet address: www.arenti.com

FCC Statement

This equipment has been tested and found to comply with the limits for a Class B digital device, pursuant to part 15 of the FCC Rules. These limits are designed to provide reasonable protection against harmful interference in a residential installation. This equipment generates, uses and can radiate radio frequency energy and, if not installed and used in accordance with the instructions, may cause harmful interference to radio communications. However, there is no guarantee that interference will not occur in a particular installation. If this equipment does cause harmful interference to radio or television reception, which can be determined by turning the equipment off and on, the user is encouraged to try to correct the interference by one or more of the following measures:

- Reorient or relocate the receiving antenna.
- Increase the separation between the equipment and receiver.
- Connect the equipment into an outlet on a circuit different from that to which the receiver is connected.
- Consult the dealer or an experienced radio/TV technician for help.

FCC Radiation Exposure Statement

This device complies with FCC radiation exposure limits set forth for an uncontrolled environment and it also complies with Part 15 of the FCC RF Rules. This equipment must be installed and operated in accordance with provided instructions and the antenna(s) used for this transmitter must be installed to provide a separation distance of at least 20 cm from all persons and must not be co-located or operating in conjunction with any other antenna or transmitter. End-users and installers must be provide with antenna installation instructions and consider removing the no-collocation statement.

This device complies with Part 15 of the FCC Rules. Operation is subject to the following two conditions: (1) this device may not cause harmful interference, and (2) this device must accept any interference received, including interference that may cause undesired operation.

Caution!

Any changes or modifications not expressly approved by the party responsible for compliance could void the user's authority to operate the equipment.

Industry Canada (ISED) Compliance Statement

This device complies with Industry Canada's licence-exempt RSS(s).

Operation is subject to the following two conditions:

- (1) This device may not cause interference; and
- (2) This device must accept any interference, including interference that may cause undesired operation of the device.

Le présent appareil est conforme aux CNR d' Industrie Canada applicables aux appareils radio exempts de licence. L' exploitation est autorisée aux deux conditions suivantes :

- (1) l' appareil ne doit pas produire de brouillage;
- (2) l' utilisateur de l' appareil doit accepter tout brouillage radioélectrique subi, même si le brouillage est susceptible d' en compromettre le fonctionnement.

The device meets the exemption from the routine evaluation limits in section 2.5 of RSS 102 and compliance with RSS-102 RF exposure, users can obtain Canadian information on RF exposure and compliance.

Le dispositif rencontre l'exemption des limites courantes d'évaluation dans la section 2.5 de RSS 102 et la conformité à l'exposition de RSS-102 rf, utilisateurs peut obtenir l'information canadienne sur l'exposition et la conformité de rf.

This transmitter must not be co-located or operating in conjunction with any other antenna or transmitter. This equipment should be installed and operated with a minimum distance of 20 centimeters between the radiator and your body.

Cet émetteur ne doit pas être Co-placé ou ne fonctionnant en même temps qu'aucune autre antenne ou émetteur. Cet équipement devrait être installé et actionné avec une distance minimum de 20 centimètres entre le radiateur et votre corps.

Safety Information

Power Adapter Safety

- The power plug is intended to serve as a disconnect device. Do not drop or cause an impact to the power adapter.
- If the power cable is damaged (for example, the cord is exposed or broken), or the plug loosens, stop using it at once. Continued use may lead to electric shocks, short circuits, or fire.
- Do not touch the device or the power adapter with wet hands. Doing so may lead to short circuits, malfunctions, or electric shocks.

Child's safety

- Comply with all precautions with regard to child's safety. Letting children play with the device or its accessories may be dangerous.
- The device and its accessories are not intended for use by children. Children should only use the device with adult supervision.

Operation Requirements

- Use the device under allowed humidity and temperature conditions.
- Do not aim the device at strong light sources (such as lamplight, and sunlight) when focusing it, to avoid reducing the lifespan of the CMOS sensor, and causing overbrightness and flickering.
- Observe local laws and regulations, and respect the privacy and legal rights of others.

© 2024. All rights reserved. All trade names are registered trademarks of respective companies Apple, the Apple logo, iPhone are trademarks of Apple Inc. registered in the U.S. and other countries. Google, the Google logo, Android are trademarks of Google Inc. App Store is a service mark of Apple Inc. Google Play is a service mark of Google Inc.