

FRONT LIGHT

During power up, the light will blink for about a minute.

Light color + behavior	Description
Solid white	Router: device is connected to the internet Extender: device is connected to the router
Solid amber	Extender has a poor connection to the router
Blinking white	Device is powering up
Blinking cyan	Router: device is attempting to connect to the internet Extender: device is attempting to connect to the router or the router has no internet access
Rapidly blinking cyan	Updating firmware OR factory reset
Blinking blue	WPS is in discovery mode

27834-EL-A





LIMITED WARRANTY

MTRLC LLC warrants this product against defects in material and workmanship for a warranty period of 2 years. To read the full warranty, please visit: motorolanetwork.com/warranty.

SAFETY NOTICES

- Device is intended to be placed indoors in an environment that’s between 32° and 104° F (0-40° C)
- Avoid water and spills
- Leave room for airflow around the device, do not block the vents on the top or bottom
- Marking information is located on the bottom of the product
- The power adapter plug is used as the disconnect device. The connected DC power outlet must be located near the equipment and be easily accessible

LABEL SYMBOLS

Symbol	Indicates
	DC voltage
	AC voltage
	For indoor use only
	Class II equipment
	Energy efficient marking

FCC STATEMENT

This device complies with Class B Part 15 of the FCC Rules. Operation is subject to the following two conditions: (1) this device may not cause harmful interference, and (2) this device must accept any interference received, including interference that may cause undesired operation. Additional FCC and Regulatory Compliance information can be found at motorolanetwork.com/Q14.

© Motorola Mobility LLC 2022. MOTOROLA, the Stylized Motorola Logo, and the Stylized M Logo are trademarks or registered trademarks of Motorola Trademark Holdings, LLC and are used under license. Minim is a registered trademark of Minim, Inc. All other trademarks are the property of their respective owners. All rights reserved. Produced by MTRLC LLC, official licensee for this product.



HELLO THERE

Set up your device with the **motosync** app:

motorolanetwork.com/sync



NEED HELP?

Web motorolanetwork.com/support **Email** support@motorolanetwork.com **Phone** 1-800-753-0797

LET'S GET STARTED



Step 1
Download the free **motosync** app for iOS or Android

On your mobile phone, download the **motosync** app, available on the Apple App Store and Google Play.



Step 3
Manage, personalize, and secure your home WiFi

With **motosync**, you can easily run a speed test, protect all connected devices, set parental controls, share WiFi with guests, and much more!



Step 2
Set up your Motorola device

Create or sign into your **motosync** account and follow the guided instructions to set up your router and extenders, if applicable.

IN THIS PACKAGE



Q14 router / extender
1st device set up will be the router



Power adapter
1 per device



Ethernet cable
1 per package

Q14 BUTTONS AND PORTS



WPS button
Press to automatically connect wireless devices, without needing to enter the network password

WAN/LAN port
• Router: connect the Ethernet cable from this port to your internet device (e.g. modem)
• Extender: second LAN port to connect wired devices

LAN port
Connect wired devices

Power port
Connect to the supplied power adapter

Reset button
Using a paperclip or similar object, press for 10 seconds to reset the Q14 device to factory defaults

PLACEMENT TIPS

We recommend placing your extender midway between the router and the desired WiFi coverage area. If you have multiple extenders, evenly space them throughout your home. See the example below.

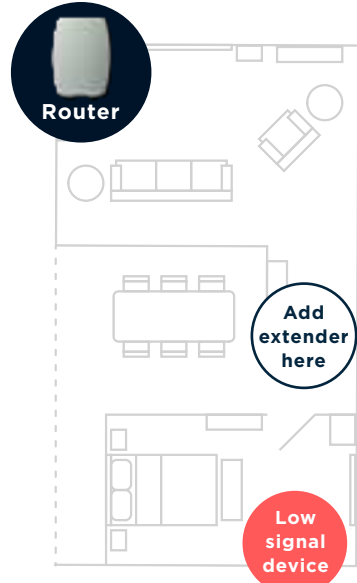

Avoid placement near large electronics like TVs and microwaves

Choose an elevated, uncovered location

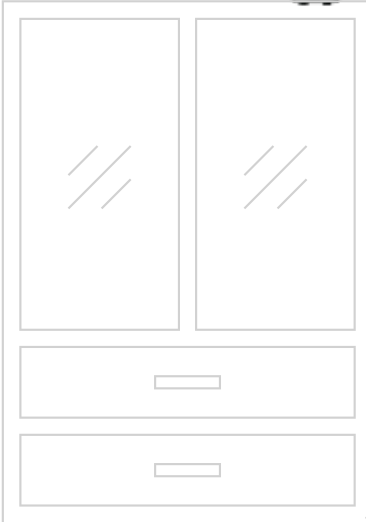

Q14 - Additional Regulatory Compliance Information

Federal Communication Commission Interference Statement

This equipment has been tested and found to comply with the limits for a Class B digital device, pursuant to Part 15 of the FCC Rules. These limits are designed to provide reasonable protection against harmful interference in a residential installation. This equipment generates, uses and can radiate radio frequency energy and, if not installed and used in accordance with the instructions, may cause harmful interference to radio communications. However, there is no guarantee that interference will not occur in a particular installation. If this equipment does cause harmful interference to radio or television reception, which can be determined by turning the equipment off and on, the user is encouraged to try to correct the interference by one of the following measures:

- Reorient or relocate the receiving antenna.
- Increase the separation between the equipment and receiver.
- Connect the equipment into an outlet on a circuit different from that to which the receiver is connected.
- Consult the dealer or an experienced radio/TV technician for help.

FCC Caution: Any changes or modifications not expressly approved by the party responsible for compliance could void the user's authority to operate this equipment.

FCC regulations restrict the operation of this device to indoor use only.



The operation of this device is prohibited on oil platforms, cars, trains, boats, and aircraft, except that operation of this device is permitted in large aircraft while flying above 10,000 feet.

Operation of transmitters in the 5.925-7.125 GHz band is prohibited for control of or communications with unmanned aircraft systems.

IMPORTANT NOTE:

FCC Radiation Exposure Statement:

This equipment complies with FCC radiation exposure limits set forth for an uncontrolled environment. This equipment should be installed and operated with minimum distance 41cm between the radiator & your body.

Let's stay in touch   

Shop

[Cable Modems](#)
[Cable Modem Routers](#)
[Mesh WiFi Systems](#)
[MoCA Adapters](#)
[Partner Solutions](#)
[motosync app](#)
[Deals](#)

Support

[Help Center](#)
[Contact Us](#)
[Warranty](#)
[Shipping and Returns](#)

About

[About Us](#)
[Blog](#)
[Privacy Policy](#)
[Terms of Use](#)

stay up to speed

[Sign up for the latest news and promotions](#)