

SYLVANIA



BLUETOOTH CD FM PLL RADIO MICRO SYSTEM

MODEL NO.: SRCD2732BT-BLACK

INSTRUCTION MANUAL

**Please read these instructions thoroughly
before use and retain for future reference**

SYLVANIA is a registered trademark of OSRAM Sylvania Inc. used under license.

SAFETY WARNINGS

Follow the instructions below to ensure the product is used safely and correctly.

1. Do not disassemble the product.
2. To reduce the risk of electric shock, do not remove screws. The unit does not contain any user-serviceable parts. Please leave all maintenance work to qualified personnel.
3. Avoid extreme degrees of temperature, either hot or cold. Place the unit well away from heat sources such as radiators or gas/electric fires.
4. To prevent the risk of electric shock or fire hazard due to overheating, ensure that curtains and other materials do not obstruct the ventilation vents.
5. Do not install or place this unit in a bookcase, built-in cabinet or in another confined space. Ensure the unit is well ventilated.
6. Never place any type of candle or naked flame on the top of or near the unit.
7. To reduce the risk of fire, electric shock or product damage, do not expose this unit to rain, moisture, dripping or splashing. No objects filled with liquids, such as vases, should be placed on the unit.
8. Do not use the product if you see any battery liquid leakage.
9. The battery (not included) used in this device may present a risk of fire or chemical burn if mistreated.
10. This equipment complies with FCC radiation exposure limits set forth for an uncontrolled environment. This equipment should be installed and operated with minimum distance 20cm between the radiator & your body.

IMPORTANT SAFETY INSTRUCTION



The **CAUTION** marking is located on the unit.



The lightning flash with arrowhead symbol, within an equilateral triangle, is intended to alert the user to the presence of uninsulated "dangerous voltage" within the unit's enclosure that may be of sufficient magnitude to constitute a risk of electric shock.



The exclamation point within an equilateral triangle is intended to alert the user to the presence of important operating and maintenance (servicing) instructions in the manual accompanying the unit.



DANGER:
Invisible and hazardous laser radiation when open and interlock failed or defeated. Avoid direct exposure to beam.



This symbol means that this unit is double insulated. An earth connection is not required.

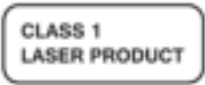

This compact disc player is classified as a CLASS 1 LASER PRODUCT. The CLASS I LASER PRODUCT label is located on the bottom exterior.

This unit is designed to operate on an AC 100-240VN 50/60Hz supply only. Connecting it to other power sources may damage it. Ensure that the supply corresponds to the information on the rating label on the unit.

Getting Started

- Remove the product from the box.
- Remove any packaging from the product.
- Please retain all packaging after you have checked and counted all the parts and the contents against the list.

Package Contents

- Unit
- Speaker box x 2
- Remote control
- Instruction manual
- AC/DC adapter

Description Of parts:

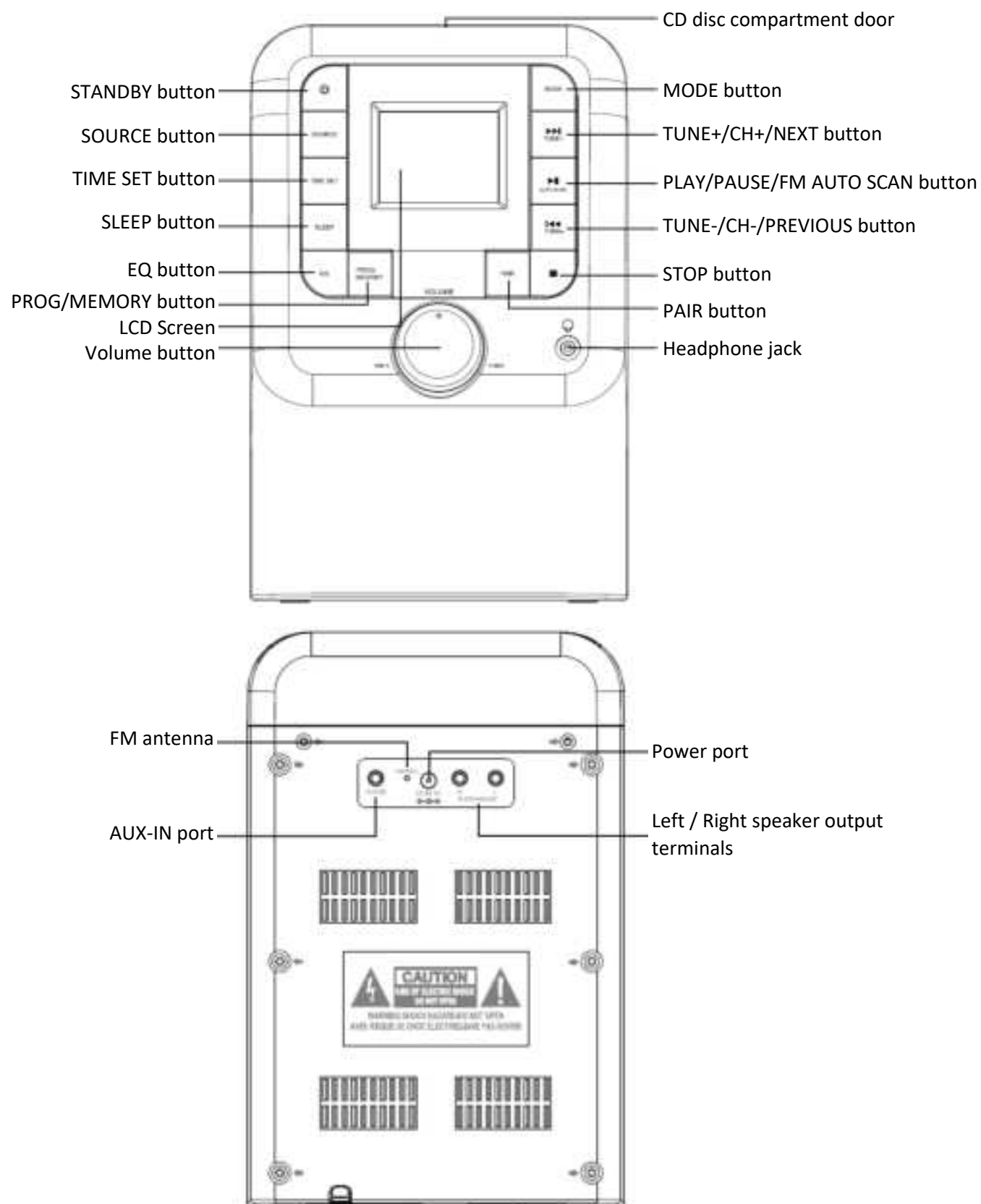

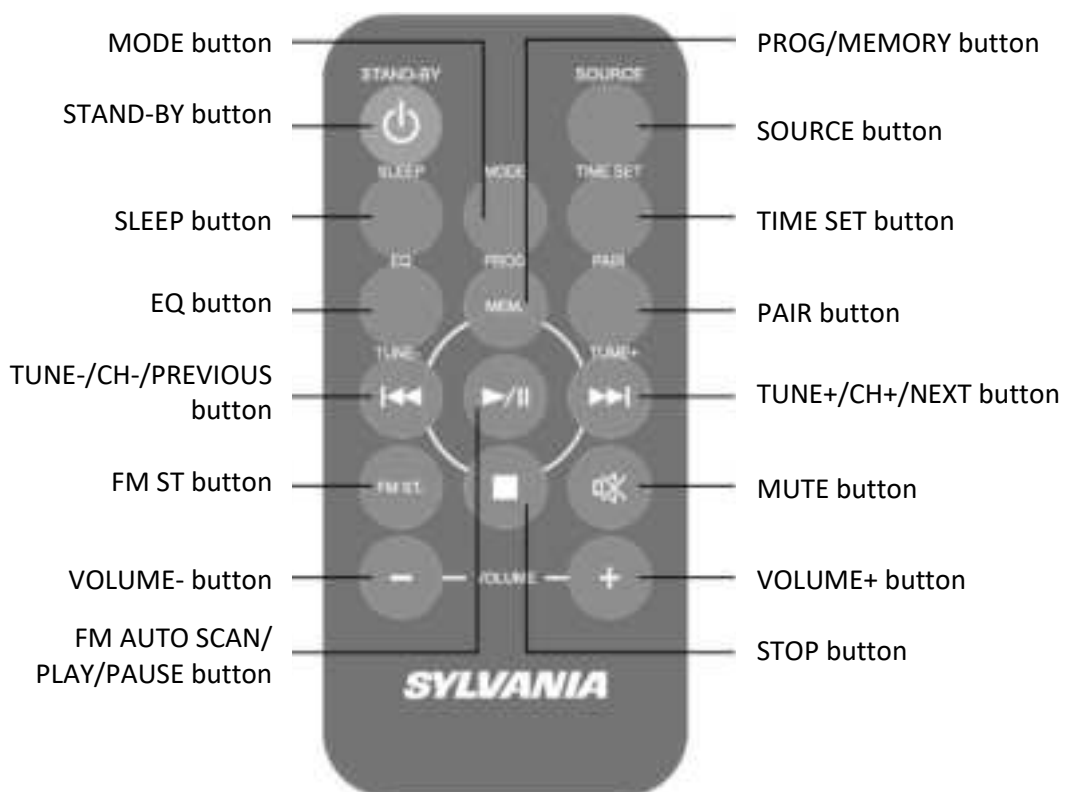

Connecting the Speakers to the Unit

Plug the speaker wires into the unit's rear panel "SPEAKER" terminals. Left and right speaker should be inserted into the "SPEAKER" terminal L and R respectively. Ensure that the speaker wires polarity are correctly inserted.

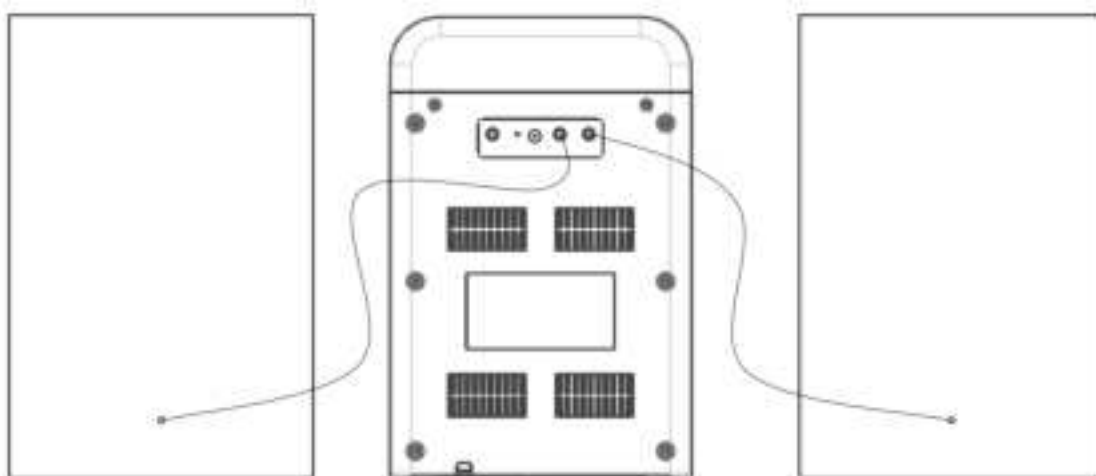

Using the Remote Control

A CR2025 battery is already installed in the remote control unit. Before using it, pull out the battery insulation sheet as shown below.

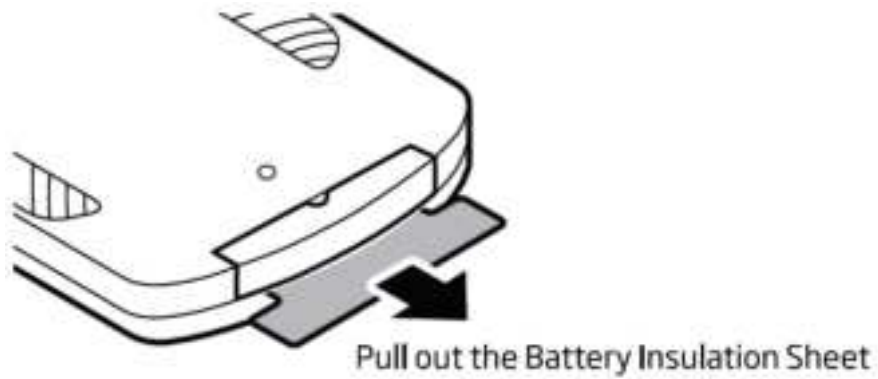

Replacing the Remote Control Battery

Remove the remote control battery case as shown in the figure below.

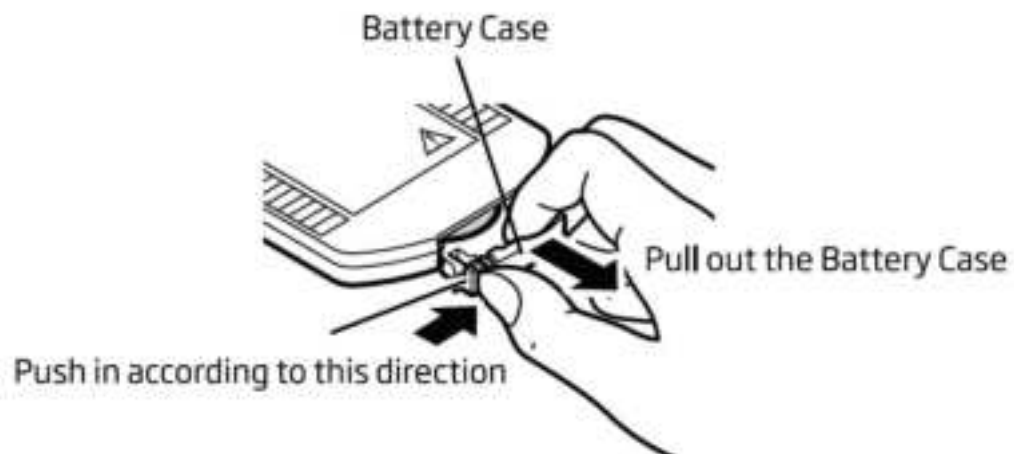

Replace the battery by a new CR2025 size battery. When inserting the battery, be sure to do so in the proper direction as shown below.

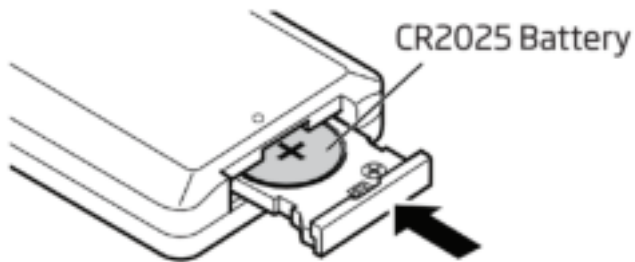

Install back the battery case.

Connecting to the Power Supply

Plug the AC/DC adapter into the AC wall socket.



Basic Operation

Press the **STANDBY** button to turn on the unit. To turn off the unit, press the **STANDBY** button again.

CD / FM / BT / AUX IN

Press the **SOURCE** button to select from the different modes.

Volume Control

Turn the **VOLUME** control or press the **VOL-** / **VOL+** buttons on the remote control to change the volume.

Adjusting the Antenna

The wire antenna at the rear panel of the unit should be extended to ensure a good FM reception. Alter the wire antenna position for the best reception.

FM Radio Operation

Auto Scan

1. Turn on the unit in FM mode.
2. Press and hold the **SCAN** button to start auto-scanning the available stations.

Manual Scan

1. Press the **TUNE-** or **TUNE+** button repeatedly to tune to a different frequency.
2. Alternatively press and hold the **TUNE-** or **TUNE+** button to automatically search to the next available station.

Storing FM Presets

You can save up to 20 FM stations.

1. Tune to the station you wish to store.
2. Press and hold the **PROG/MEMORY** button to access the menu control. Flashing "P01" is displayed
3. Press the **TUNE-** or **TUNE+** button on the unit to preset number that you want to store. Then press and hold the **PROG/MEMORY** button to save.

Recall FM Presets

Press the **PROG/MEMORY** button once to recall the preset channel, press it repeatedly to change to next preset channel.

CD Operation

Loading and Playing CD Disc

Open the CD door. Install a disc with the CD graphic side facing up. Close the CD door. After reading the disc the total number of tracks will be shown on the display. It will play the first track automatically.

Play/Pause Control

To pause playback press the **PLAY/PAUSE** button once. Press the **PLAY/PAUSE** button again to resume playback.

Stop Control

To stop playback press the **STOP** button.

Skip Track

During playback press the **PREVIOUS** or **NEXT** button to skip to the next or previous tracks.

Random Play

While you are playing CD, press the **MODE** button to play music in random order. The display will show "RANDOM". Press the **MODE** button again to resume normal playback.

High-Speed Music Search

During CD playback press & hold the **PREVIOUS** or **NEXT** button to start high-speed skipping. When you release the **PREVIOUS** or **NEXT** button normal speed playback will resume.

Repeat Playing

During playback press the **MODE** button once the display shows a flashing "REPEAT". The current track will be played repeatedly. Press the **MODE** button again the display shows a steady "REPEAT ALL". All tracks will be played repeatedly. Press the **MODE** button again to resume normal playback.

Bluetooth Audio

Please follow the pairing instructions below to link the unit to your Bluetooth device.

1. Press the **SOURCE** button repeatedly to enter the Bluetooth mode. The display will show "**bt**" and start searching.
2. If the unit has never been paired with a Bluetooth device before or cannot find the last
3. paired device, the display and the Bluetooth status indicator will keep on flashing.
4. Turn on the Bluetooth function of your device and enable the search until "**Sylvania SRCD2732BT**" is found. Select "**Sylvania SRCD2732BT**" on the Bluetooth device to make connection. Enter the pass code "0000" if required.
5. After successfully paired the unit will display "**bt**".
6. You can now start playing music from your smartphone wirelessly to the speaker.
7. You can press the **PLAY/PAUSE** button to pause or resume the playback.
8. You can press the **PREVIOUS** or **NEXT** button to skip to the next song or go back to the previous song.

AUX In

This allows you to connect an external player's sound through your unit.

1. Plug a 3.5mm audio cable (not included) into your external player's line out and the other end into the AUX IN jack at the front of the unit.
2. Press the **SOURCE** button to enter AUX mode. Display shows "AUX"
3. Start your external player to play music.
4. The unit will output the sound.

EQ Operation

You can enjoy different EQ sound effect modes.

Press the **EQ** button will change to different sound effects:

FLAT / POPS / CLASSIC / JAZZ / ROCK

Sleep Function

1. When the unit is switched on, press the **SLEEP** button repeatedly to select a sleep duration from either 120, 90, 60, 45, 30, 15 minutes or sleep off. The sleep icon will show on the display.
2. When the sleep timer is zero, the unit will turn off automatically.
3. To cancel the sleep function, press the **STANDBY** button to turn off the unit. Or press the **SLEEP** button repeatedly to select "sleep off".

Clock Setup

1. Turn off the unit in Standby mode.
2. Press and hold the **TIME SET** button to access the setup menu.
3. Press the **TUNE-** or **TUNE+** button to adjust the hour. Press the **TIME SET** button to confirm and it will go to the next menu.
4. Press the **TUNE-** or **TUNE+** button to adjust the minute. Press the **TIME SET** button to save and finish the set up.

Note:

- The time set may automatically be overridden by the FM station real time information.
- When the unit is turned on in any mode of operation, pressing the **TIME SET** button will display the time on the display for a few seconds.

Maintenance

Handling CD

Treat the disc carefully and handle it only by its edges. Avoid touching the shiny, unprinted side of the disc with your fingers. Do not expose discs to direct sunlight, high humidity, high temperatures, dust, etc. Do not stick or write anything on either side of the disc. Sharp writing instruments or ink may damage the surface.



Cleaning CD

If the CD skips does not play it may need cleaning. Wipe the disc in straight lines from the center of the disc to the outer edge of the disc with a soft lint-free dry cloth. Never use detergents or abrasive cleaners.



Cleaning CD Lens

If the CD lens is dirty the player may skip or may not play a CD. Clean it with a blower/brush to remove the dust. To remove fingerprints use a dry cotton swab and wipe from the middle towards the outer edge of the lens.

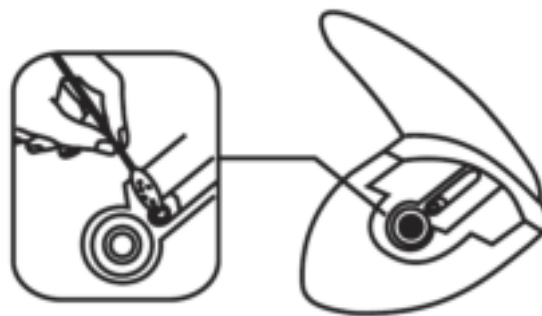

Cleaning the Unit

To prevent fire or electric shock hazard disconnect your unit from the AC power source when cleaning. Wipe off any dust and stains with a soft cloth moistened with a mild soap and water solution. Do not use benzene, thinner or similar chemicals to clean the casing.

TECHNICAL SPECIFICATIONS

| | |
|------------------------|-------------------|
| AC/DC Adapter | 100-240V 50/60Hz |
| Power Consumption | 20W |
| FM Frequency Range | 87.5 -108MHz |
| Bluetooth Version | 5.0 |
| Aux In | 3.5mm stereo jack |
| Headphone Out | 3.5mm stereo jack |
| Speaker Output Power | 2x3W RMS |
| Remote Control Battery | CR2025 |

Note: Due to continuing improvements, technical specifications are subject to change without notice.

To make a warranty claim, do not return this product to the store. Please email support@curtiscs.com or call 1-800-968-9853.

90 day Warranty

This product is warranted to be free from defects in material and workmanship for a period of ninety (90) days from the date of original purchase. During this period, your exclusive remedy is repair or replacement of this product or component found to be defective, at our option; however, you are responsible for all costs associated with returning the product to us. If the product or component is no longer available, we will replace with a similar one of equal or greater value. Prior to a replacement being sent, the product must be rendered inoperable or returned to us.

This warranty does not cover glass, filters, wear from normal use, use not in conformity with the printed directions., or damage to the product resulting from accident, alteration, abuse, or misuse. This warranty extends only to the original consumer purchaser or gift recipient. Keep the original sales receipt, as proof of purchase is required to make a warranty claim. This warranty is void if the product is used for other than single-family household use or subjected to any voltage and waveform other than as on the specified rating on the label (e.g., 120V~60Hz).

We exclude all claims for special, incidental, and consequential damages caused by breach of express or implied warranty. All liability is limited to the amount of the purchase price. Every implied warranty, including any statutory warranty or condition of merchantability or fitness for a particular purpose, is disclaimed except to the extent prohibited by law, in which case such warranty or condition is limited to the duration of this written warranty. This warranty gives you specific legal rights. You may have other legal rights that vary depending on where you live. Some states or provinces do not allow limitations on implied warranties or special, incidental, or consequential damages, so the foregoing limitations may not apply to you.

For faster service, locate the model, type, and serial numbers on your appliance.

NOTE: This equipment has been tested and found to comply with the limits for a Class B digital device, pursuant to part 15 of the FCC Rules. These limits are designed to provide reasonable protection against harmful interference in a residential installation. This equipment generates uses and can radiate radio frequency energy and, if not installed and used in accordance with the instructions, may cause harmful interference to radio communications. However, there is no guarantee that interference will not occur in a particular installation. If this equipment does cause harmful interference to radio or television reception, which can be determined by turning the equipment off and on, the user is encouraged to try to correct the interference by one or more of the following measures:

- Reorient or relocate the receiving antenna.
- Increase the separation between the equipment and receiver.
- Connect the equipment into an outlet on a circuit different from that to which the receiver is connected.
- Consult the dealer or an experienced radio/TV technician for help

Changes or modifications not expressly approved by the party responsible for compliance could void the user's authority to operate the equipment.

This device complies with Part 15 of the FCC Rules. Operation is subject to the following two conditions:

- (1) this device may not cause harmful interference, and
- (2) this device must accept any interference received, including interference that may cause undesired operation.

For service assistance and product information, please call: 1-800-968-9853.

Curtis International Ltd.

7045 BECKETT DRIVE, UNIT 15, MISSISSAUGA, ON, L5S 2A3

www.curtisint.com